

BM. 150.59 S.E. Cor. Conc. Porch Ho. #1233 Christine

NOTE: Stationing is on base line 15' S. of N.R.

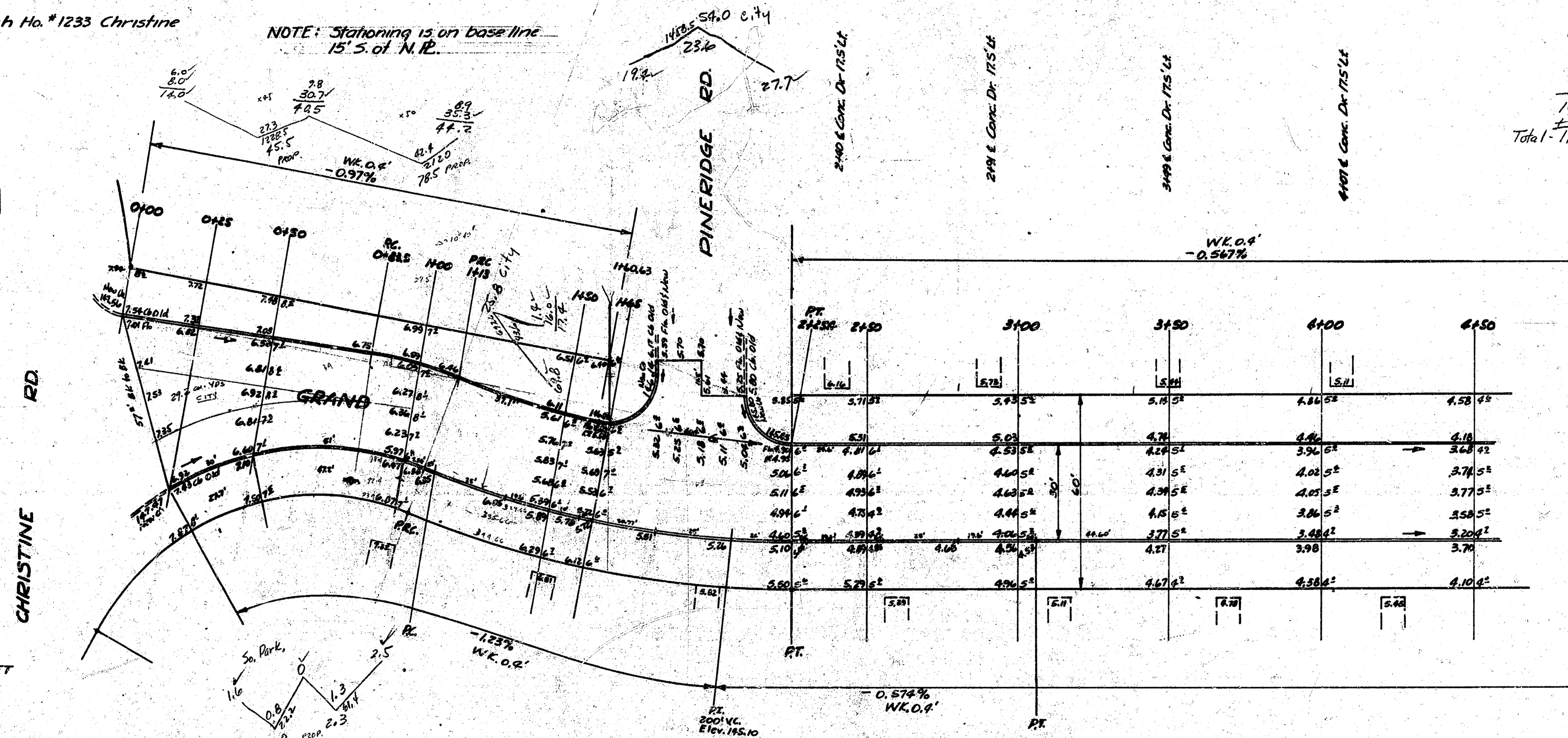

CURVE DATA FOR CURVE FROM CHRISTINE RD. TO REC. 9' OFFSET FROM S.R.L.  
 E = 32.4'  
 Δ = 81° 15'  
 L = 131.03'  
 D = 63° 0' 19"  
 Deflect. for 1' Arc = 18.605"

CURVE DATA FOR CURVE FROM R.R.C. TO RT. 9' OFFSET FROM S.R.L.  
 E = 335.66'  
 Δ = 21° 28'  
 L = 125.76'  
 D = 107° 04' 07"  
 Deflect. for 1' Arc = 5.121"

NOTE: Vert. curve is on cb distances. P.I. is 20' W. of curve RT.

City	Prop.
54.0	0.8
25.8	2.3
29.2	27.4
109.0	30.5
+10.97	136.7
Total - 119.9 Cu. Yds.	32.3
	70.6
	50.2
	104.4
	119.1
	121.7
	132.0
	747.4
+10% 99.7	
Total 1042.1 Cu. Yds.	

City	Prop.
119.9 Cu. Yds	1042.1
	988.1
Total	2030.7

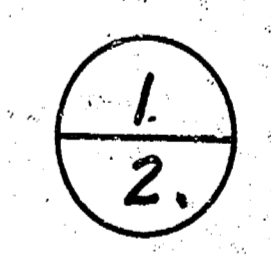

**GRAND**  
 E.L. CHRISTINE TO W.L. WAVERLY  
 30' CONC. & CB.  
 CITY OF WICHITA, KANS.  
 L.K. WHITE CITY ENGINEER  
 MARCH 1951 PROJ. NO. CH-49

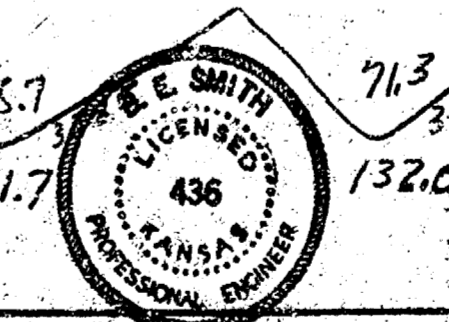

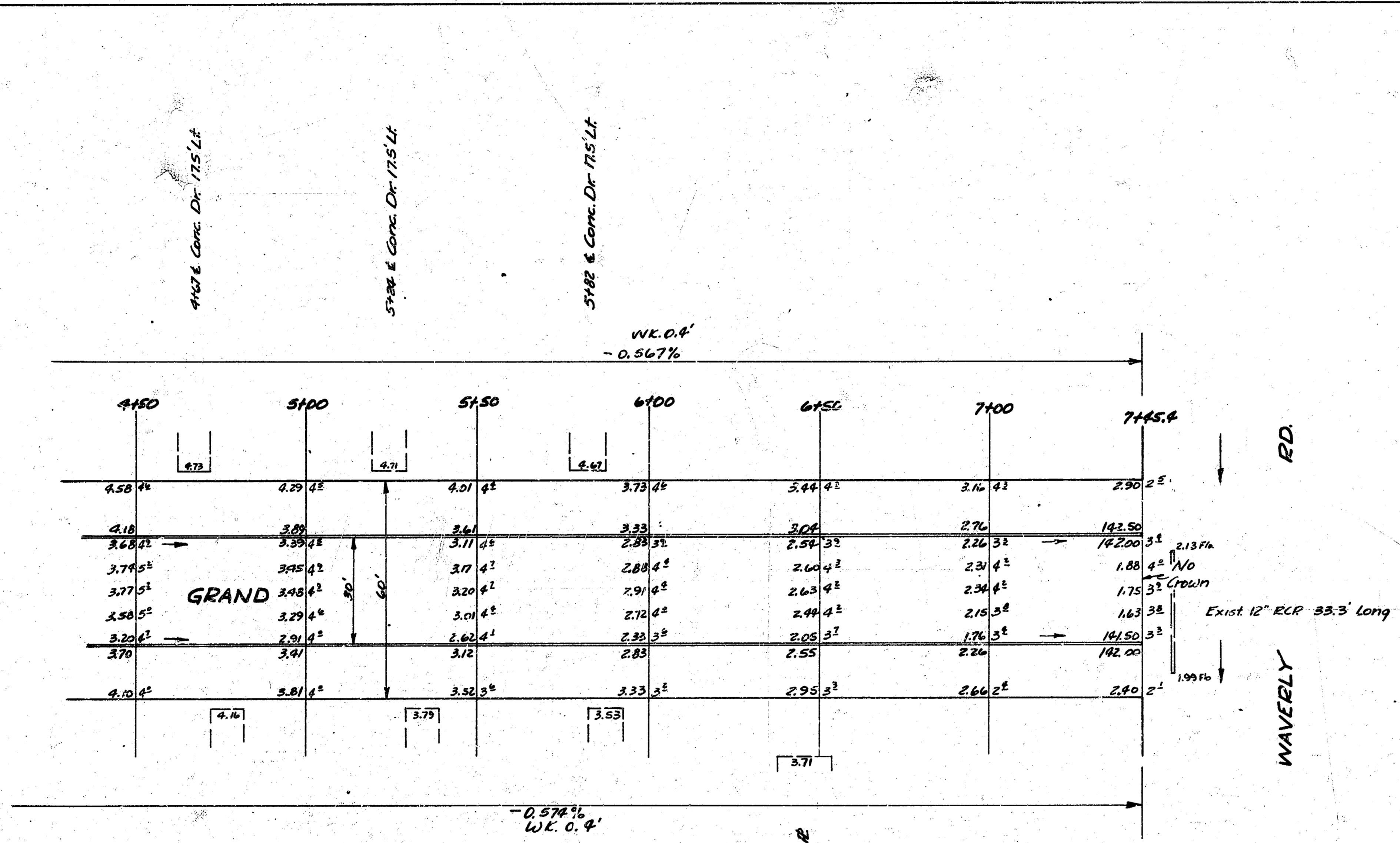

Excav.	
City	Prop
0	130.1
	138.7
	144.1
	153.7
	167.2
	155.9
	878.7
+1070	87.9
Total 983.6 Cu Yds	

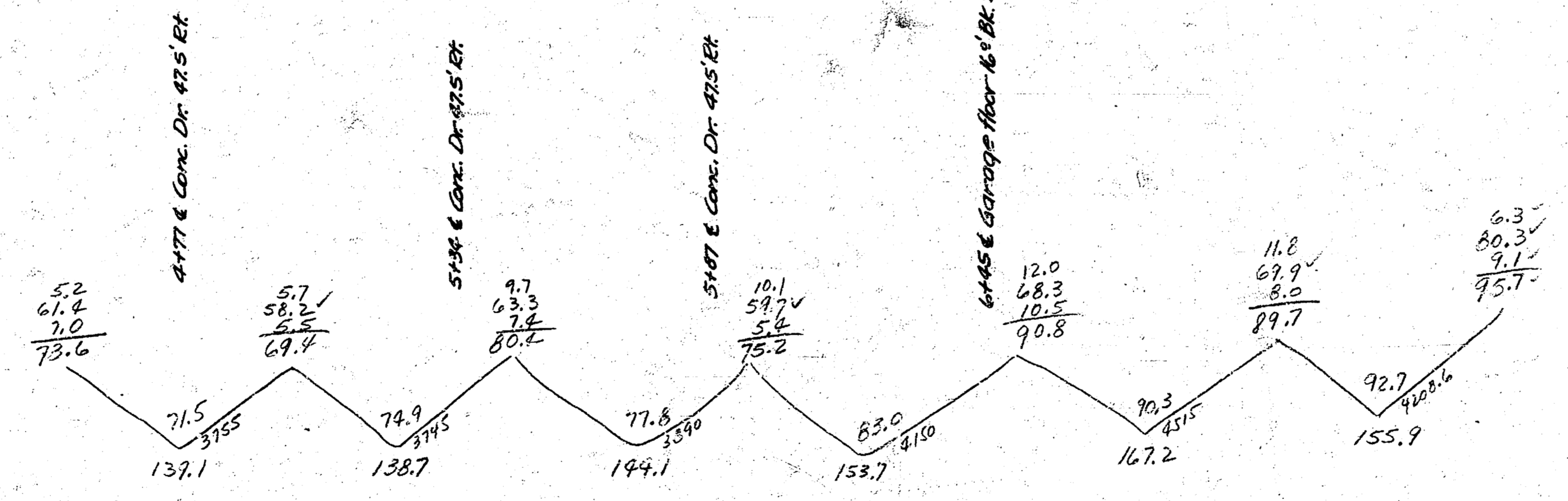

2  
2