

Survey of Green St. by
 E. E. Smith
 Checked 5/7/55

2302
 2303
 2314
 2320

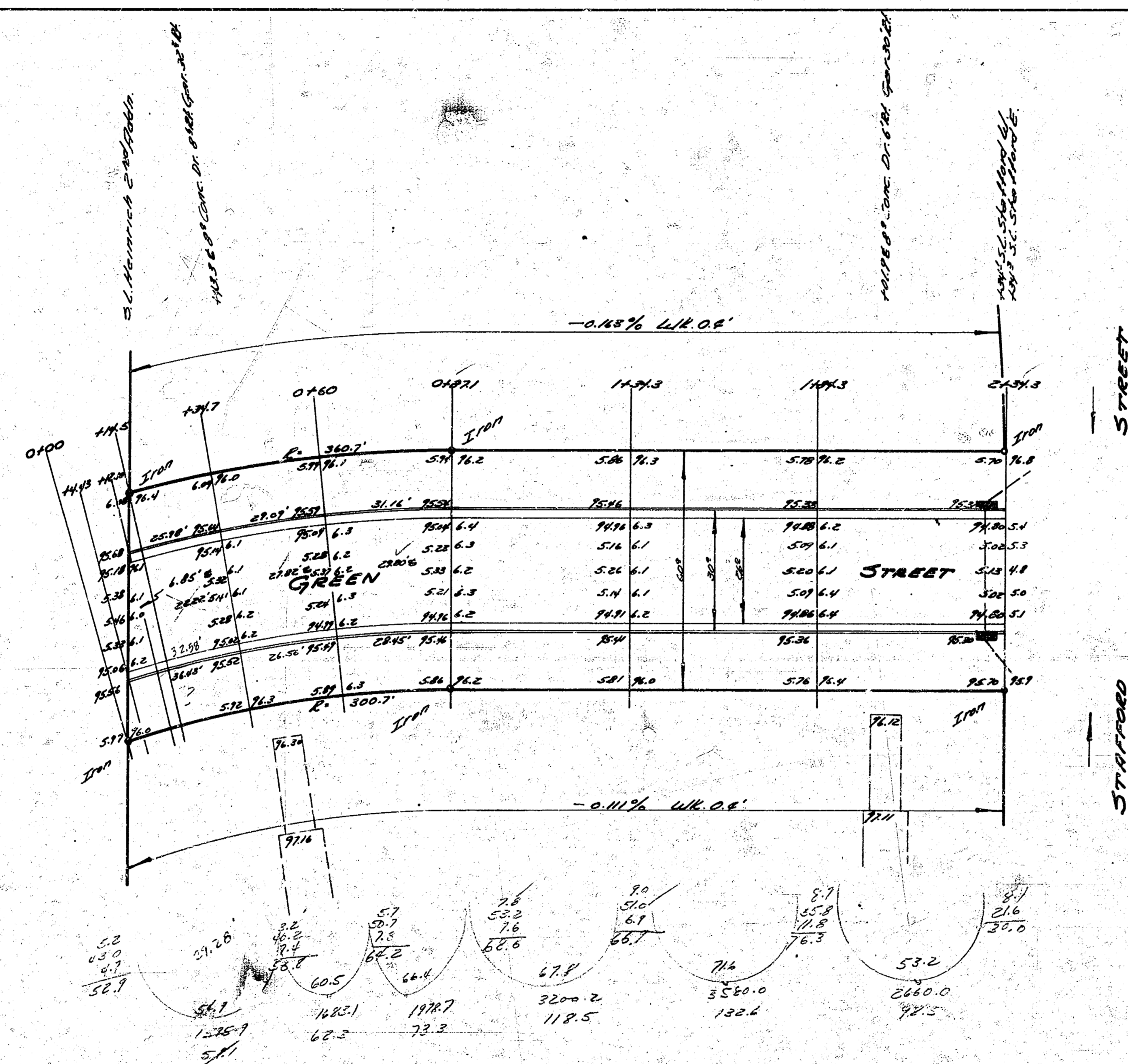

B.M. 1832 - S.W. Cor. Con. Corp. Shop No. 2220 S. Green

NOTE - Preliminary Survey Run N. to S. on E.R.

Curve Data for 6' Offset from C.C. of C.B. D.R. 16454 (P. 300)

Station	Arch'd E.R.	Chord E.R.	Chord Elev. @ 6'	Chord Elev. @ C.C.	Def'n. Δ	Total Def'n.
0+00						
0+14.3	44.8	44.8	5.18	4.58	0°25'19"	0°25'19"
0+21.3	24.7	24.7	8.27	7.20	0°42'50"	1°08'10"
0+27.3	24.0	24.0	2.81	2.47	0°13'40"	1°22'50"
0+37.3	20.20	20.20	23.13	20.84	1°55'20"	3°18'10"
0+40	25.30	25.29	27.59	24.05	2°29'37"	5°47'57"
0+47.1	22.10	22.09	31.67	27.10	2°29'55"	8°17'52"

Total Excav.
 City Prop
 None All cut
 None 544.3
 11% 517.7 cu yds.

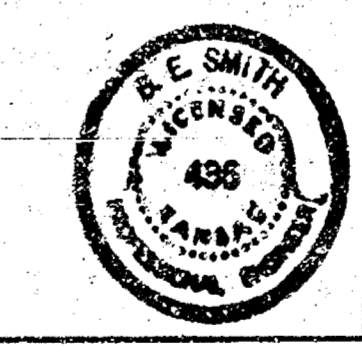

GREEN STREET
 S.L. Stafford to S.L. Heinrich
 26' E-50' P.C.
 CITY OF WICHITA, KANS.
 E. E. Smith City Engineer
 5/19/55 Proj. No. C-18-75