

B.M. 90.65 Top Iron in Flood Control R/W Marker 200 N. 1:75' W  
W. of N. End Big Ar. River Bridge & Hydraulic

Base line for X-Sections on N. Co. line 15' S. of N.R.



Grand Total			
Excav.		Fill	
Prop.	City	Prop.	City
1119.6	154.0	117.9	77.8
1107.1	111.9	117.1	77.8
Total	1231.0 cu. yd.	Total	194.9 cu. yd.

  

Excav.		Fill	
Prop.	City	Prop.	City
76.1 cu. yd.	74.7 cu. yd.	44.2 cu. yd.	27.7 cu. yd.

Survey by  
B. M. R. Y.  
1. min. D.C.C.  
2. inc. D.C.C.  
3. Engineer

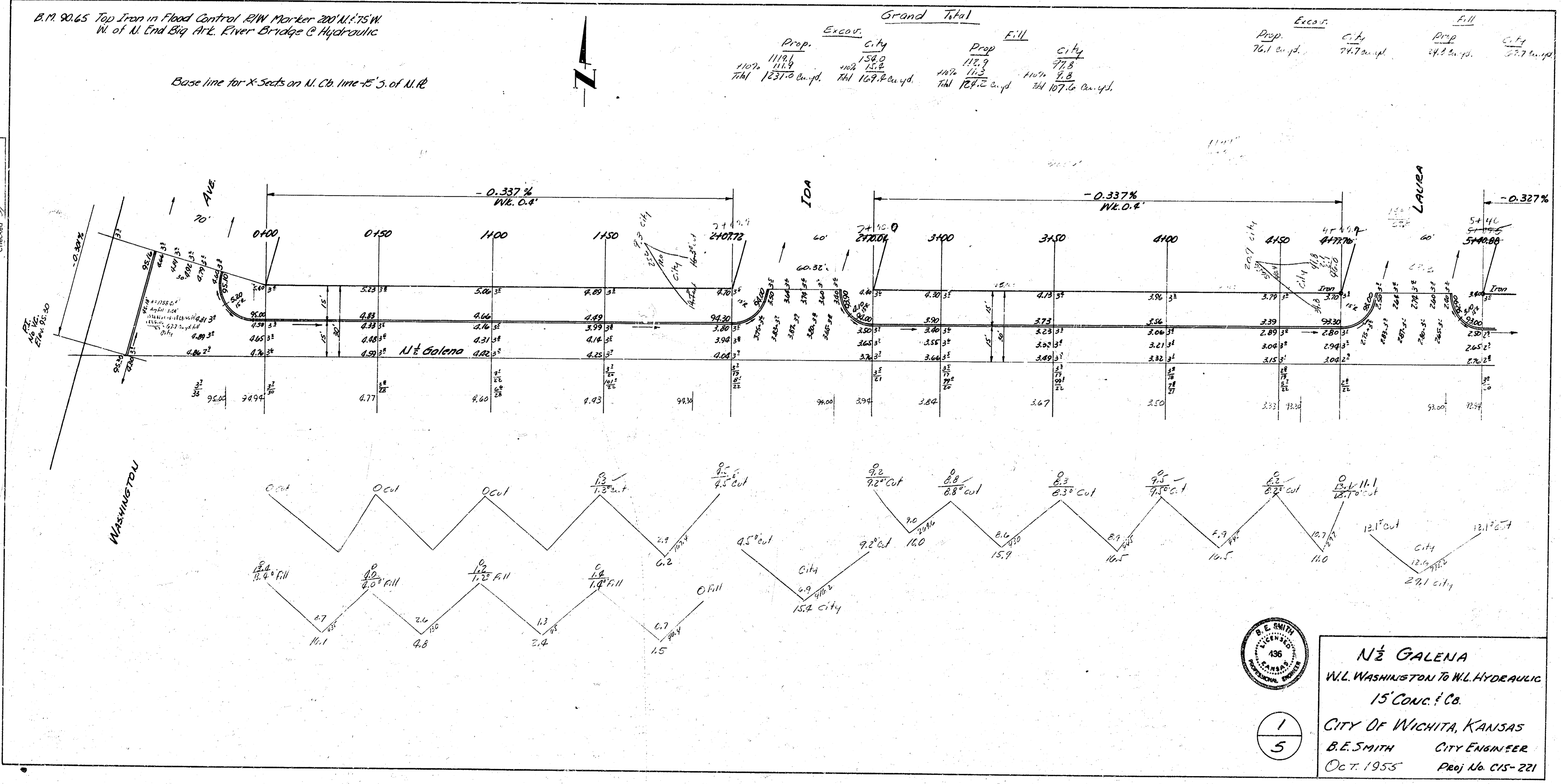

WASHINGTON

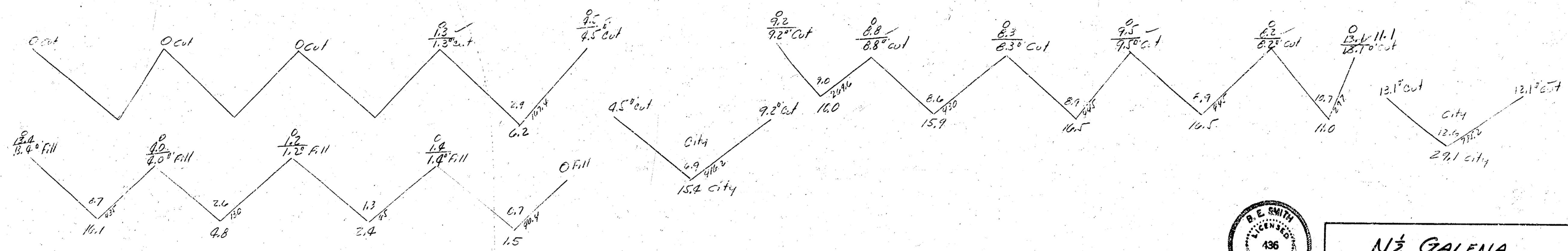

**N 1/2 GALENA**  
W.L. WASHINGTON TO W.L. HYDRAULIC  
15' CONC. & CO.  
CITY OF WICHITA, KANSAS  
B.E. SMITH CITY ENGINEER  
Oct. 1955 Proj. No. C15-221

1  
5

ELEV  
 Prop 257.3 on rd  
 City 0  
 ELEV  
 Prop 0  
 City 0

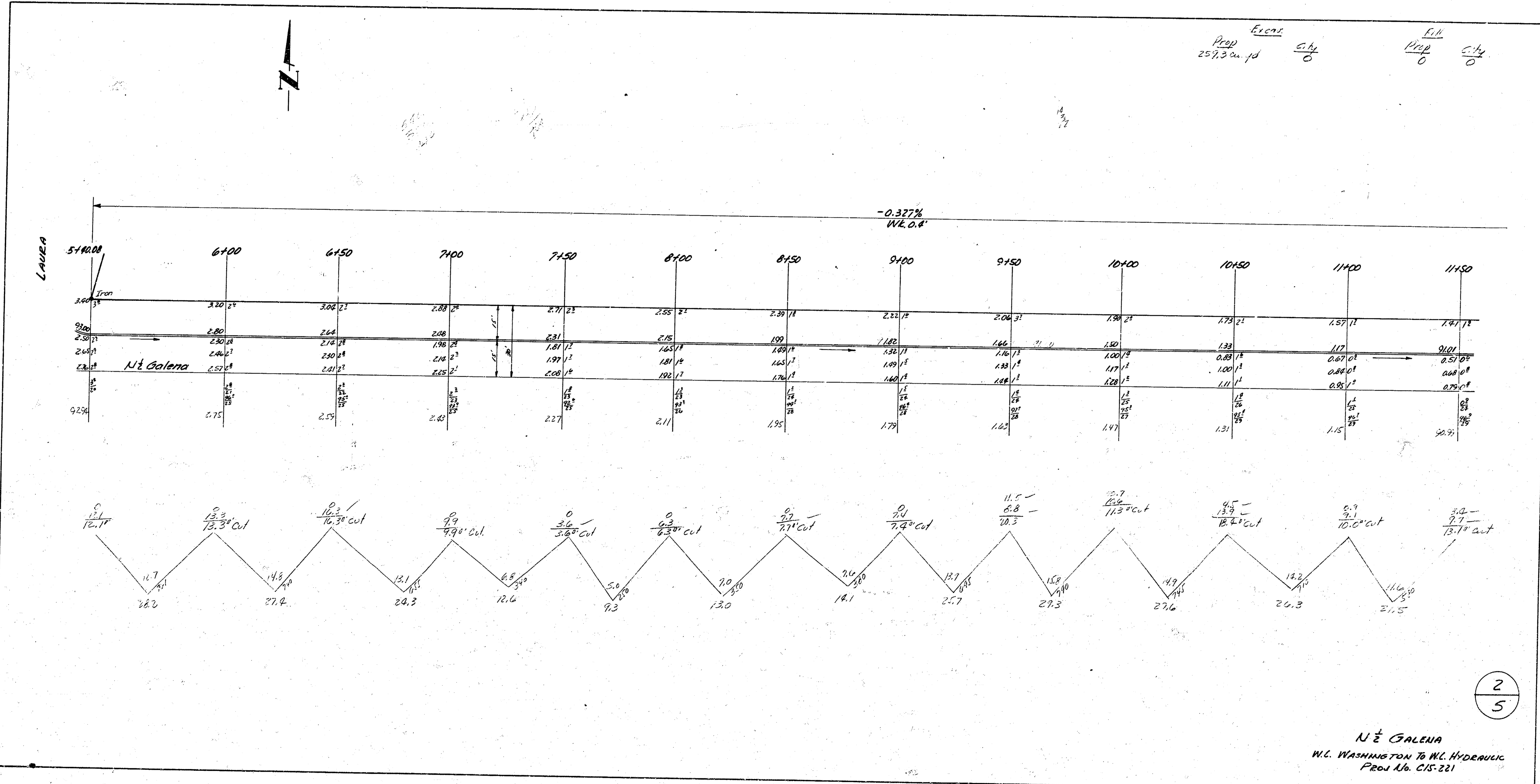



Excav.		Fill	
Prop	City	Prop	City
147.6 cu. yd.	0.16 cu. yd.	88.1 cu. yd.	30.1 cu. yd.

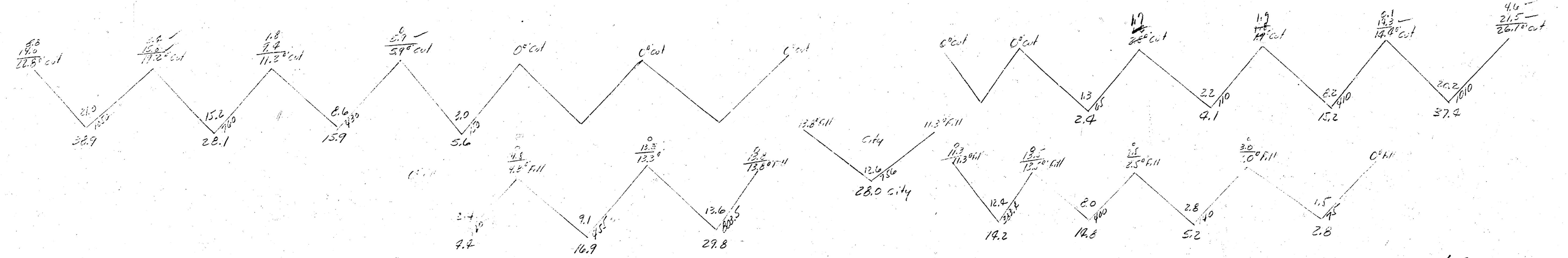
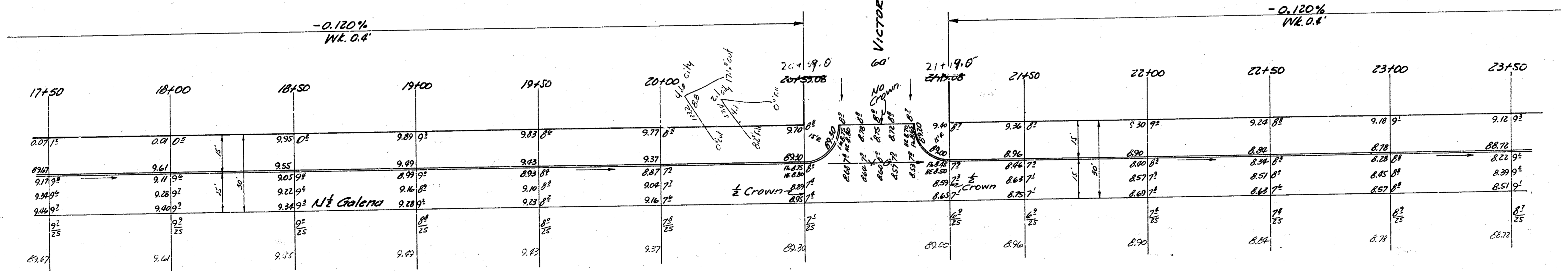

4  
5

N.E. GALENA  
N.L. WASHINGTON TO M.L. HYDRAULIC  
P. 200. No. C15-221

