

GREENWAY BLVD.  
N.L. LEVY TO S.L. CLARK  
(Mt. Vernon)

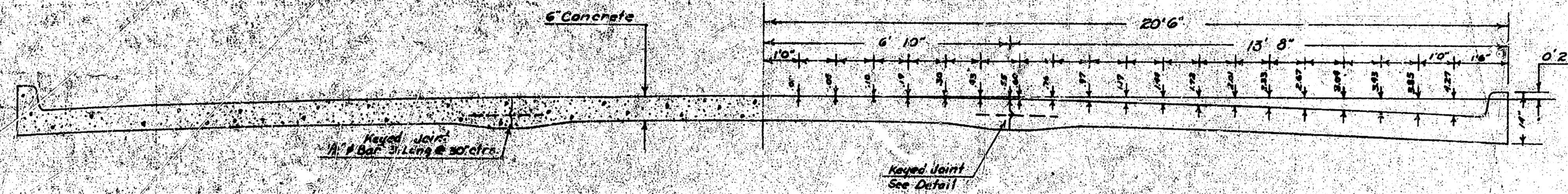

TYPICAL SECTION  
No Scale



Detail of Keyed Joint

No Scale

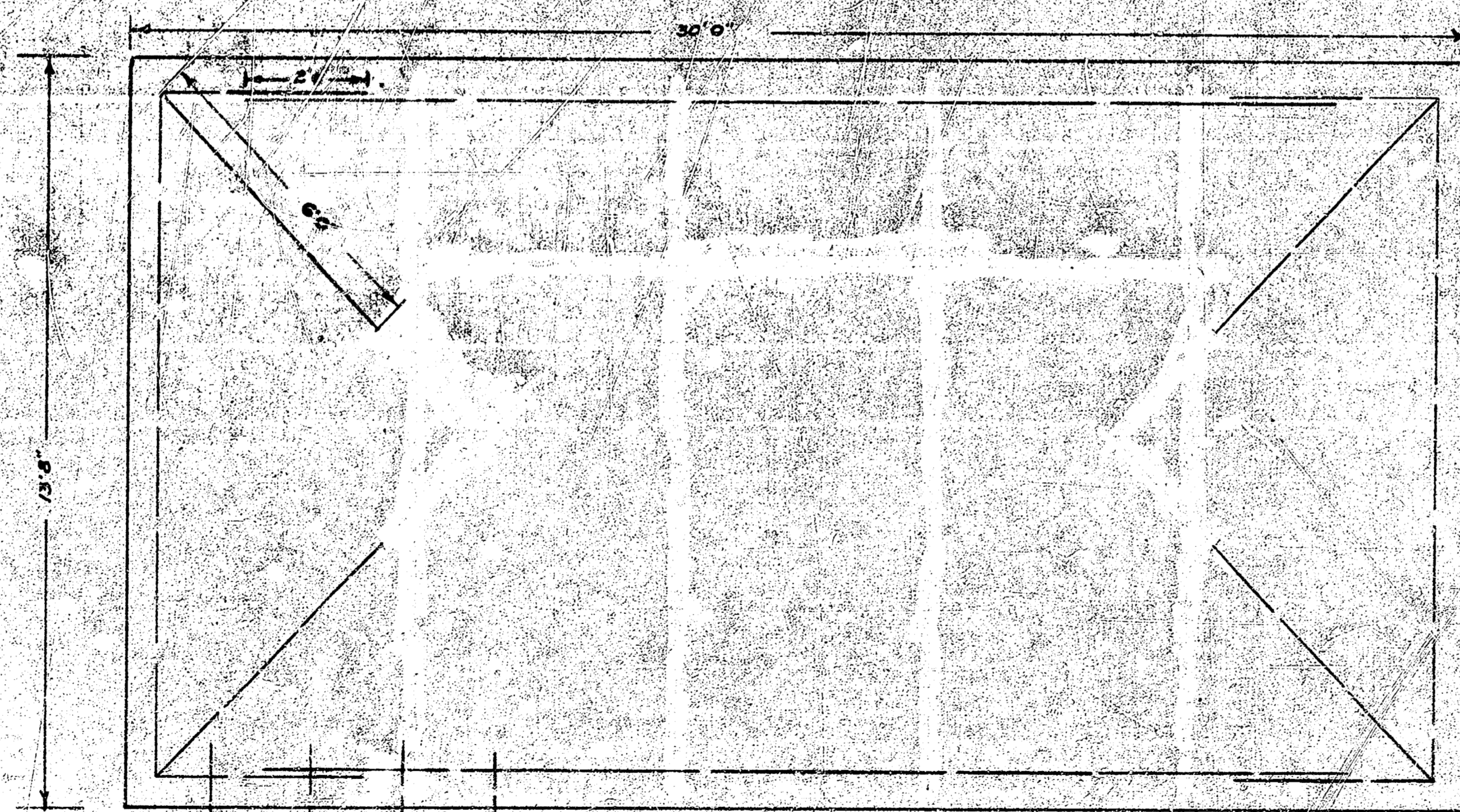

STEEL PATTERN  
No Scale

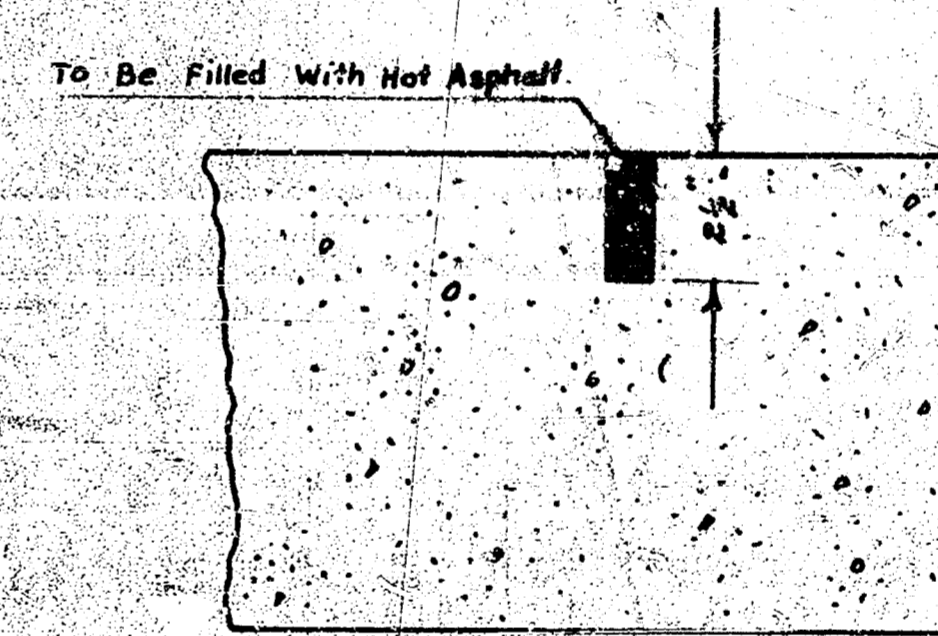

Detail of Contraction Joints  
No Scale

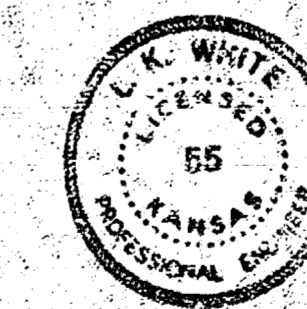

3/20 4/19 10-10-1915

B.M. 110.03 "X" Top Co. N.S. KIMCAD NEAR E.L. GREENWAY  
 B.M. 105.59 "60 SPIKE IN E.S. ELM W.S. GREENWAY 30' N. OF N.L. GREENWAY Cr.  
 STATIONING IS ON  $\mathcal{E}$ .

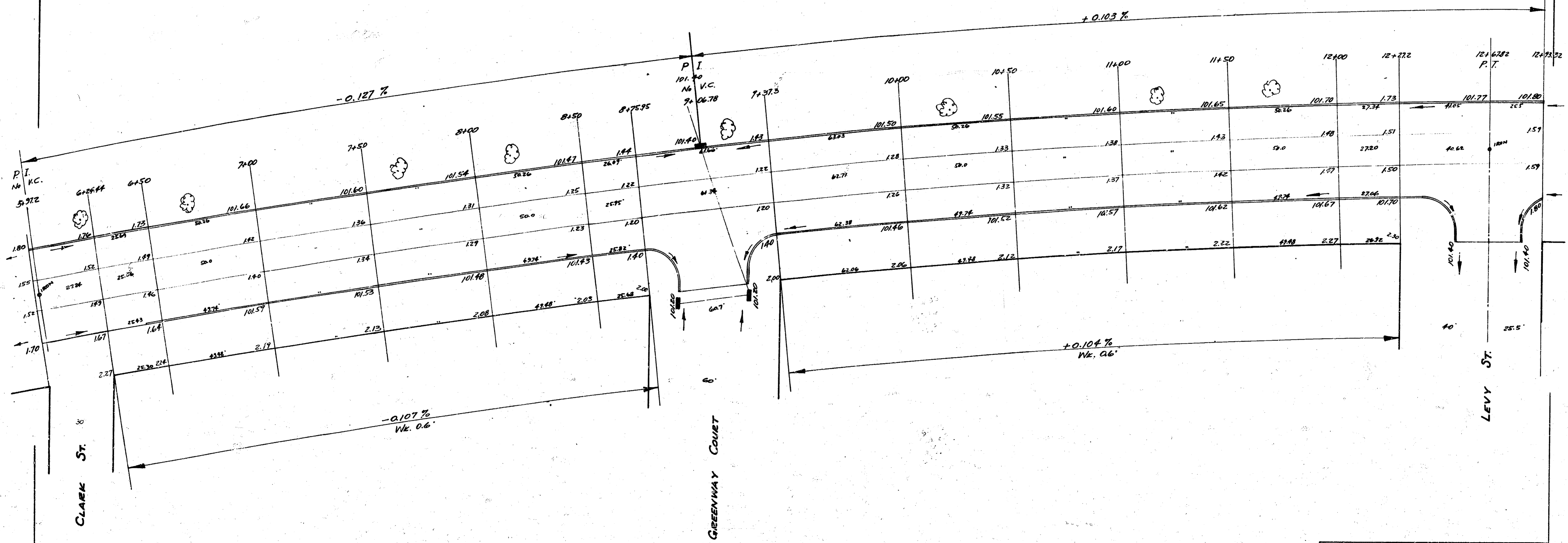
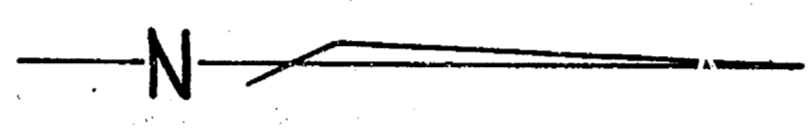

$\mathcal{E}$  CURVE DATA:  
 RADIUS = 3859.6'  
 $\Delta = 9^{\circ} 57' 18''$   
 CURVE LENGTH = 670.62'  
 LONG CHORD = 659.8'  
 DEGREE OF CURVE =  $1^{\circ} 29' 04''$

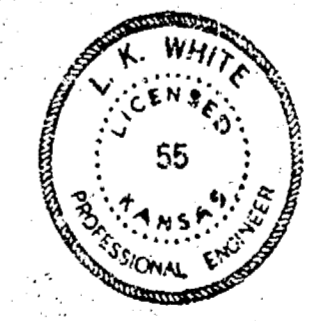

GREENWAY BLVD.  
 S.L. CLARK TO N.L. LEVY  
 30' CONC. & CB. - WIDEN TO 40'  
 CITY OF WICHITA, KANSAS  
 L. K. WHITE CITY ENGINEER  
 JULY, 1952 PROJ. CII-313, CII-314

