

B.M. 100.03 "x" Top Co. N.S. KIRKLAND NEAR E.L. GREENWAY BLVD.

STATIONING ON 7' OFFSET W. OF W. CO. LINE.

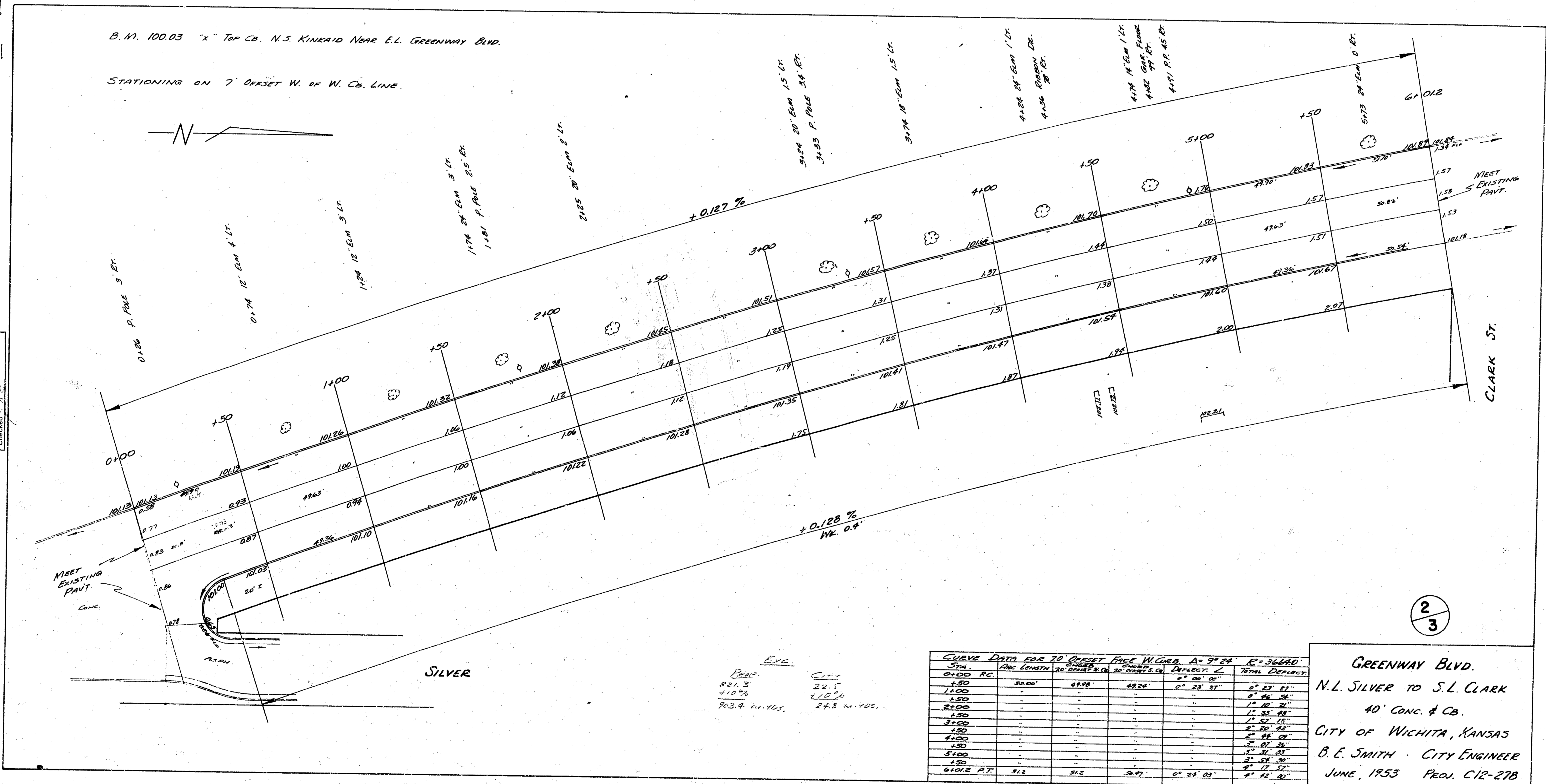
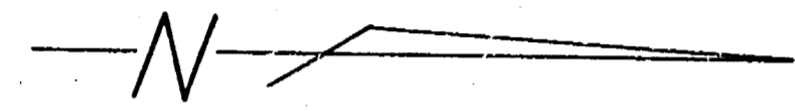

Survey
 Plan
 Exc.
 Checked

P.C. 221.3
 P.T. 210.7
 702.9 W. YDS.
 E.V.C.
 C.L. 22.5
 212.0
 24.8 W. YDS.

CURVE DATA FOR 70' OFFSET FROM CURVE Δ = 9° 24' R = 366.0'

STATION	LONG. DISTANCE TO CURVE B.L.	CHORD BEG. TO CURVE E.C.	CHORD END. TO CURVE P.C.	DEFLECT. ANGLE	TOTAL DEFLECT.
0+00	38.0'	48.98'	48.26'	0° 23' 31"	0° 23' 31"
1+00	"	"	"	"	0° 46' 58"
2+00	"	"	"	"	1° 10' 25"
3+00	"	"	"	"	1° 33' 52"
4+00	"	"	"	"	1° 57' 19"
5+00	"	"	"	"	2° 20' 46"
6+00	"	"	"	"	2° 44' 13"
6+12	51.2'	51.6'	50.9'	0° 28' 03"	4° 12' 30"

2
3

GREENWAY BLVD.
 N.L. SILVER TO S.L. CLARK
 40' CONC. & CB.
 CITY OF WICHITA, KANSAS
 B. E. SMITH - CITY ENGINEER
 JUNE, 1953 PROJ. C12-27B