

B.M. 130.52 8" in globe on Wk S.S. drive @ 2002 N. Grove
 B.M. 131.07 "X" Ch. rod. S.E. Grove & Shadybrook
 B.M. 133.71 36" Cor. conc. porch No. 2334 E. 20th

NOTE: Catch basins at intersection of 19th & Grove
 to be located according to S.W.S. Plan.

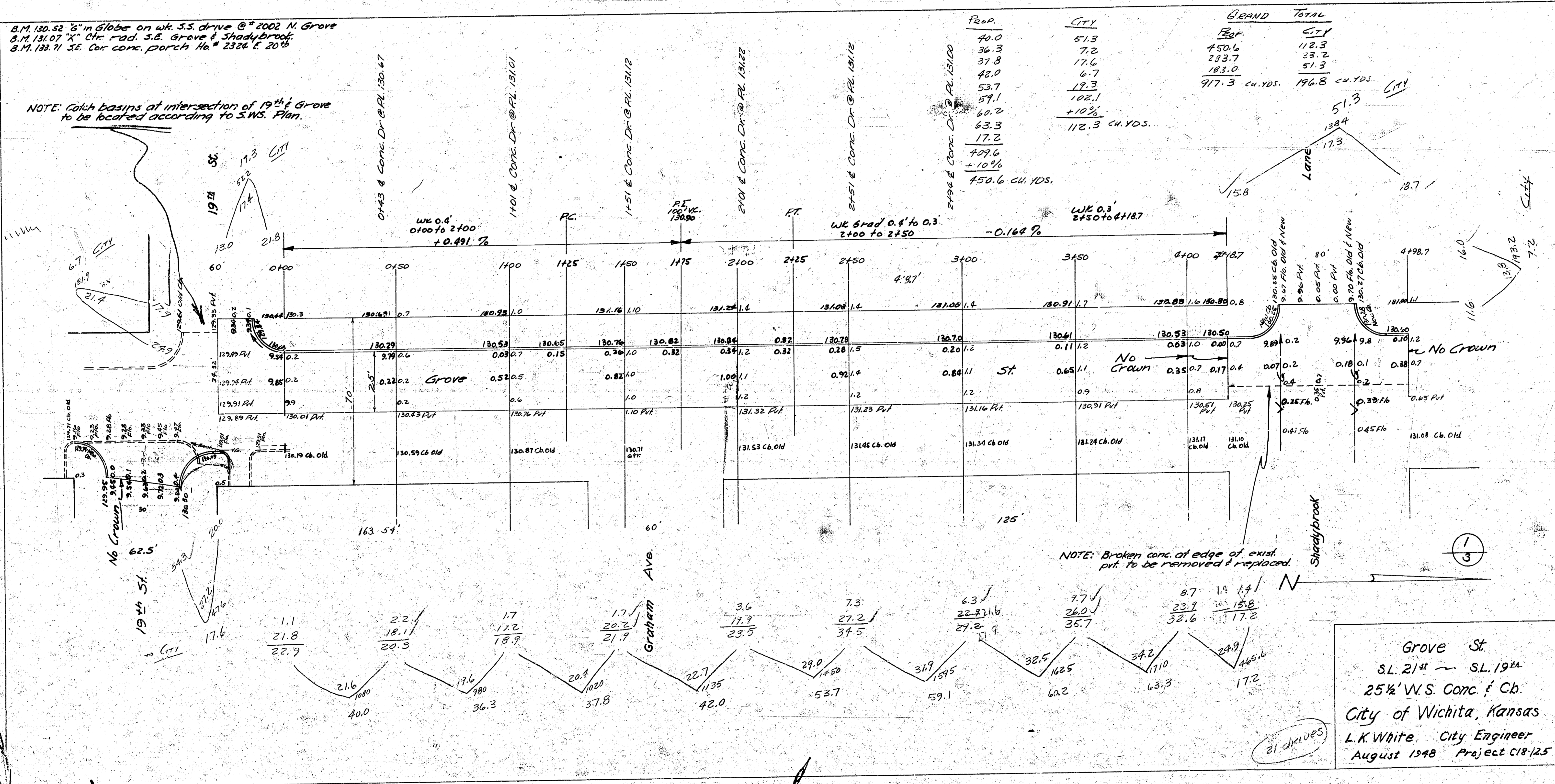

Prop.	CITY
40.0	51.3
36.3	7.2
37.8	17.6
42.0	6.7
53.7	17.3
57.1	102.1
60.2	+10%
63.3	112.3 cu. yds.
17.2	
409.6	
+10%	
450.6	

GRAND TOTAL	CITY
450.6	112.3
233.7	33.2
183.0	51.3
717.3	196.8

Grove St
 S.L. 21st ~ S.L. 19th
 25 1/2" W.S. Conc. & Cb.
 City of Wichita, Kansas
 L.K. White City Engineer
 August 1948 Project C18-125

NOTE: Broken conc. of edge of exist
 pit. to be removed & replaced.

21 drives

PROP	CITY
15.2	10.8
53.1	35.8
42.6	46.6
23.1	+10%
32.4	51.3
166.4	
+10%	
183.0	ca. 145.

