

PAVING PLAN-----1945.

GROVE AVENUE N.L. FIFTEENTH - S.L. SIXTEENTH

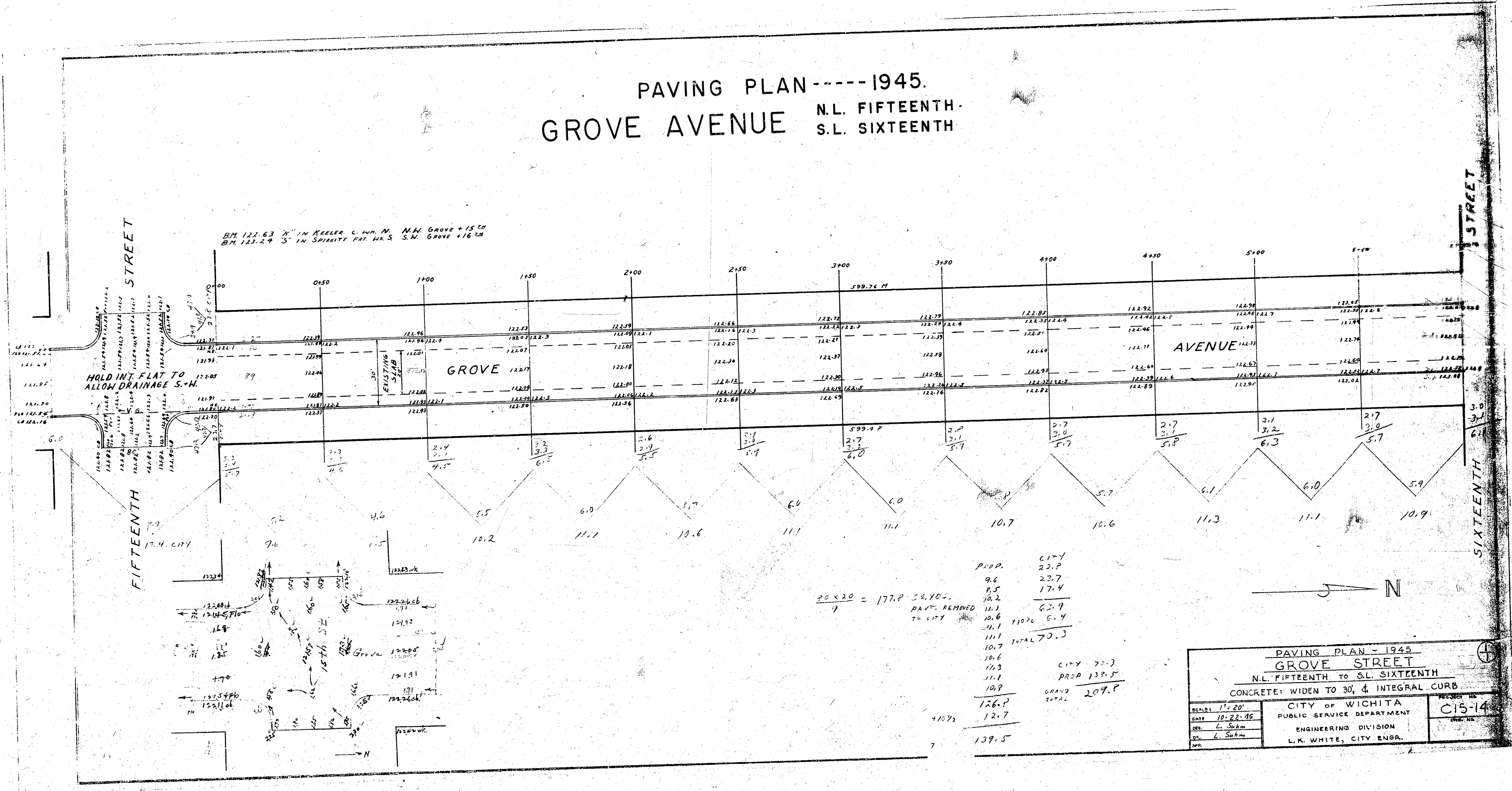

HOLD INT. FLAT TO ALLOW DRAINAGE S.W.

B.M. 122.63 "4" IN KEELER C. NW. N. N.W. GROVE +15.24
 B.M. 123.29 "5" IN SPIRITZ PAT. NW. S. S.W. GROVE +16.24

20 x 20 = 177.8 SQ. YDS.
 PAVT. REMOVED TO CITY

PROP.	CITY
9.6	22.8
8.5	22.7
10.2	17.4
11.1	62.9
10.6	110.6
11.1	6.4
10.7	TOTAL 70.3
10.6	
11.3	
11.1	
10.8	
126.8	CITY 70.3
12.7	PROP 139.5
139.5	GRAND TOTAL 209.8

PAVING PLAN - 1945
GROVE STREET
 N.L. FIFTEENTH TO S.L. SIXTEENTH
 CONCRETE: WIDEN TO 30', & INTEGRAL CURB

SCALE: 1" = 20'	CITY OF WICHITA PUBLIC SERVICE DEPARTMENT ENGINEERING DIVISION L. K. WHITE, CITY ENGR.	PROJECT NO. C15-14
DATE: 10-22-45 DES: L. Summ SUP: L. Summ APP:		