

B.M. 93.74 S.W. Cor. CONC. PAVEN HD. ON N.E. Cor. OF 35TH ST & HANDLEY APPROX 100' N. OF NL 35TH
 B.M. 94.535 N.W. Cor. CONC. PAVEN HD. # 017 34TH ST. ON S.E. Cor. 34TH & HANDLEY
 STATIONING & BASE LINE 6' OFFSET FROM FACE OF WEST CB

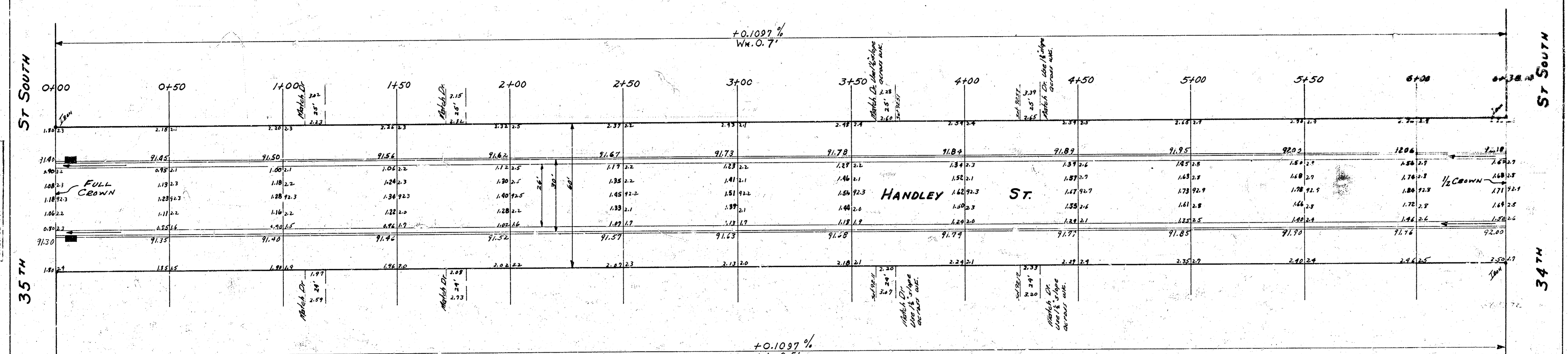
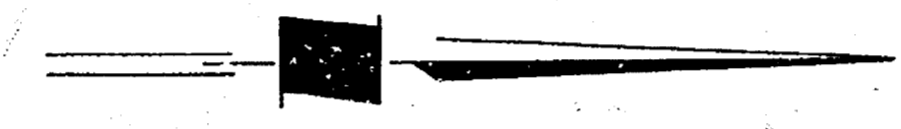

Survey
 Exc.
 Checked

35TH

ST SOUTH

34TH

+0.1097%
 Wk. 0.5'

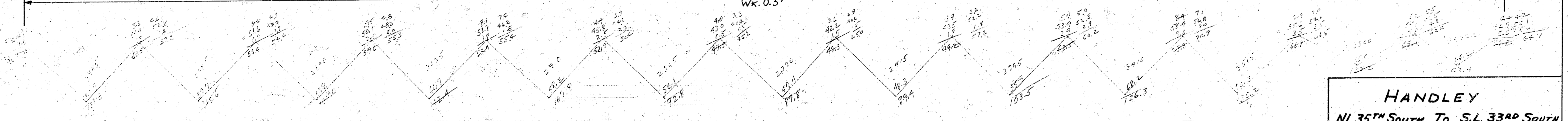

PROPERTY
 2-3-61-4
 4.10% 2.96.8
 2.94 4.5 CU. YDS. CUT



1/2

HANDLEY
 NL 35TH SOUTH TO S.L. 33RD SOUTH
 26-2-30-AC.
 CITY OF WICHITA KAN.
 BE SMITH, CITY ENGINEER
 SEPT. 1956 Proj. No. C14-19

