

B.M. 17299 SW Cor Stone Slab on Brick Monument, N.E. Hampton & 10' S. of S.L. Cresthill Manor Addn
 Baseline & Stationing on West Property Line.

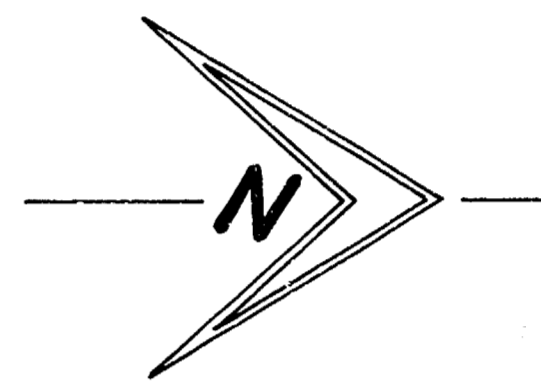
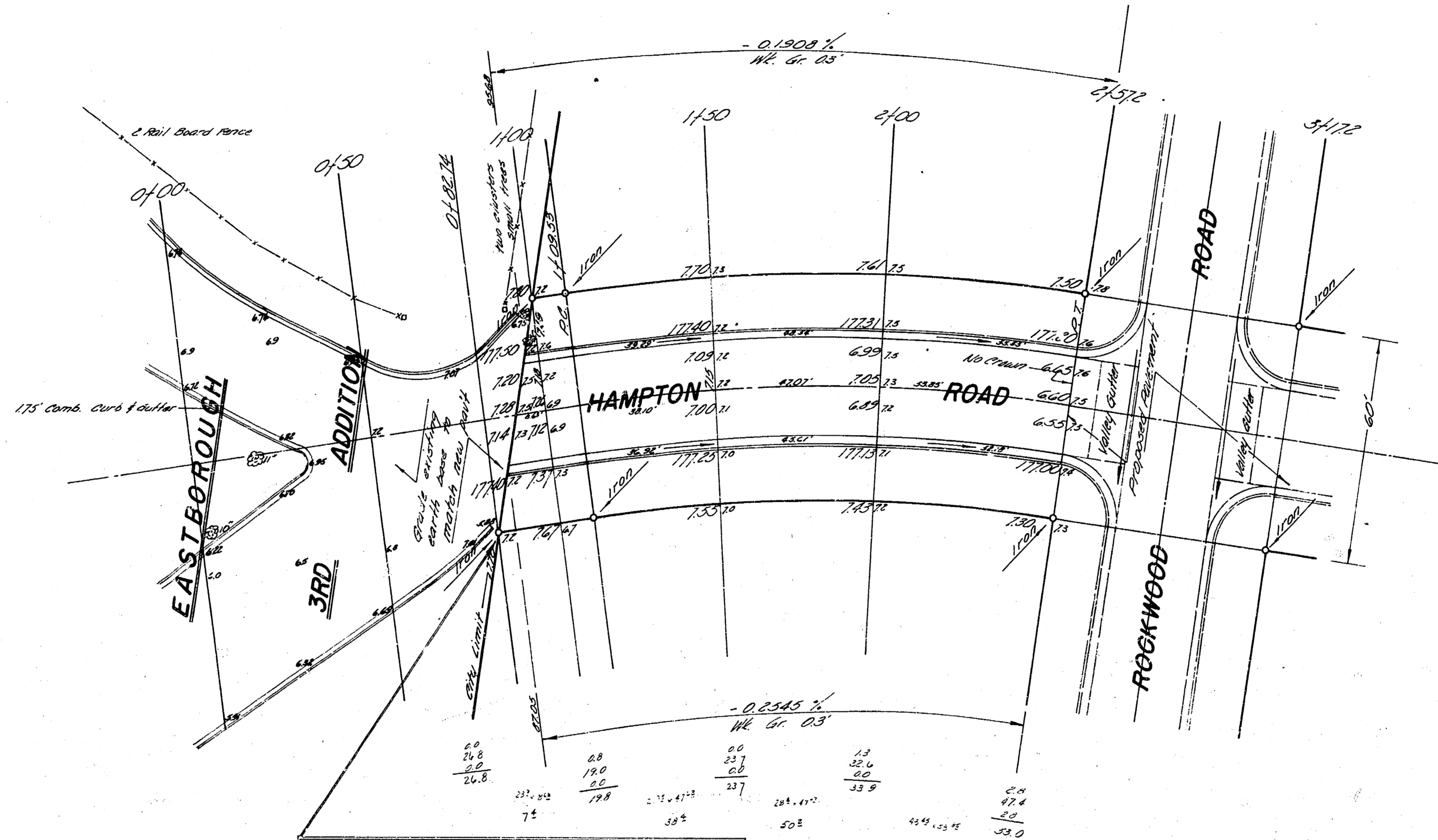

SOURCE
 6-10-10
 175' Comb. curb & gutter
 3rd

Curve Data on N. E.

Sta	ARC	CHORD	CHORD'S DISTANCE	DEFLECTION	TOTAL DEF.
17293					
1725	1507	1567	1507	1506	0° 30' 30"
1730	2500	2495	2242	2166	1° 23' 40"
1735	-	-	-	-	3° 09' 30"
1740	-	-	-	-	5° 03' 15"
1745	-	-	-	-	6° 51' 00"
1750	2500	2495	2242	2166	1° 23' 40"
17572	730	720	676	710	0° 34' 0"

Note to Field Engineer
 This plot is uncorrected. It is located & shall not be used when setting stakes for the project. If you desire to re-locate iron, see Bl. 175.50, page 53 & the original plot of Cresthill Manor.

Elevation
 18.3
 2010 cu. yd.

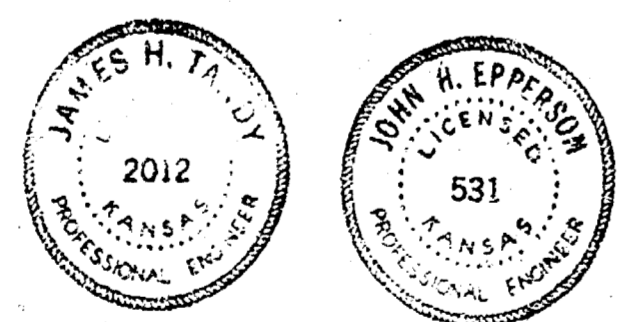

HAMPTON RD.
 S.L. LOT 1, BLK. 6, CRESTHILL MANOR
 ADDN. TO S.L. ROCKWOOD
26'-2"-30' AC.
 CITY OF WICHITA, KANSAS
 B.E. SMITH CITY ENGINEER
 DATE: JULY 1960, PROJ. NO. CIO-49