

HARRY ST.
 E.L. ERIE TO W.L. GEO. WASHINGTON DR.
 PROJ. C11-215 & C11-216

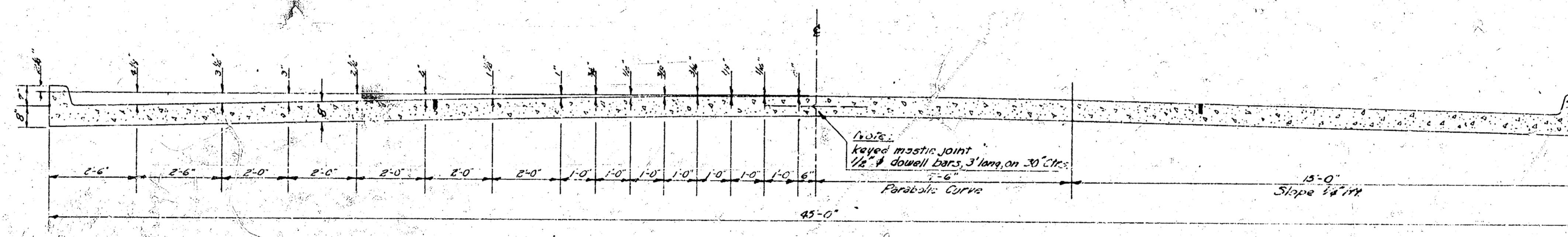

TYPICAL SECTION
 NO SCALE

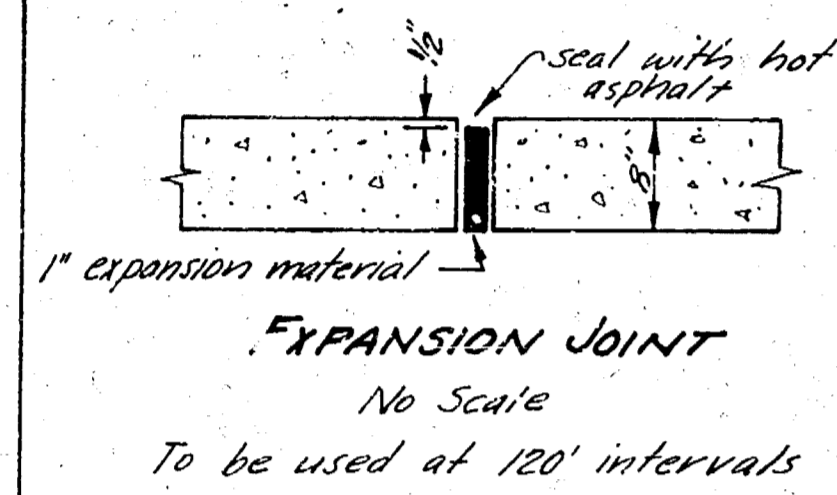
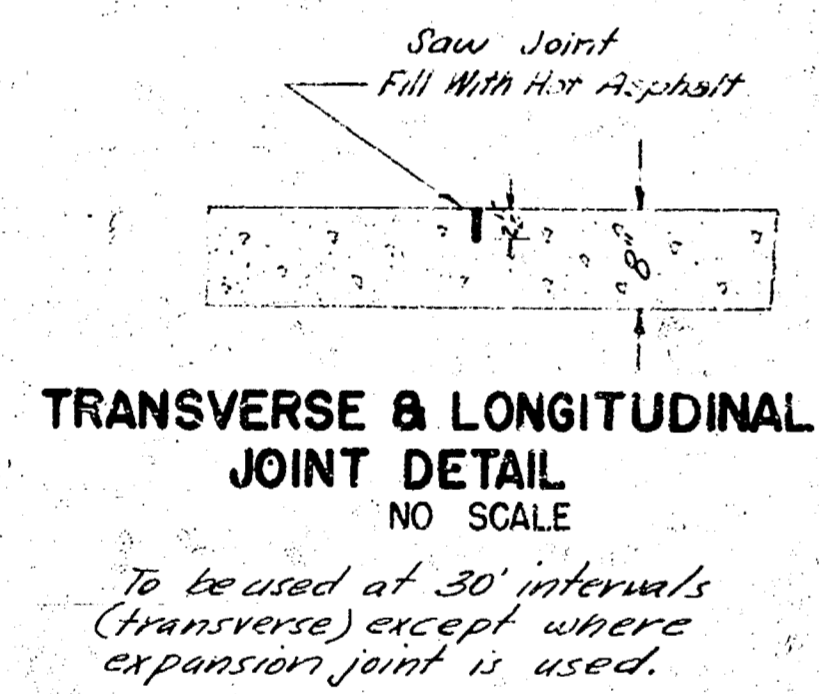

NOTE -
 WHERE CURBS IN THE SAME SECTION ARE AT DIFFERENT ELEVATIONS USE ELEVATION SHOWN ON PLAN FOR CONSTRUCTION JOINT.

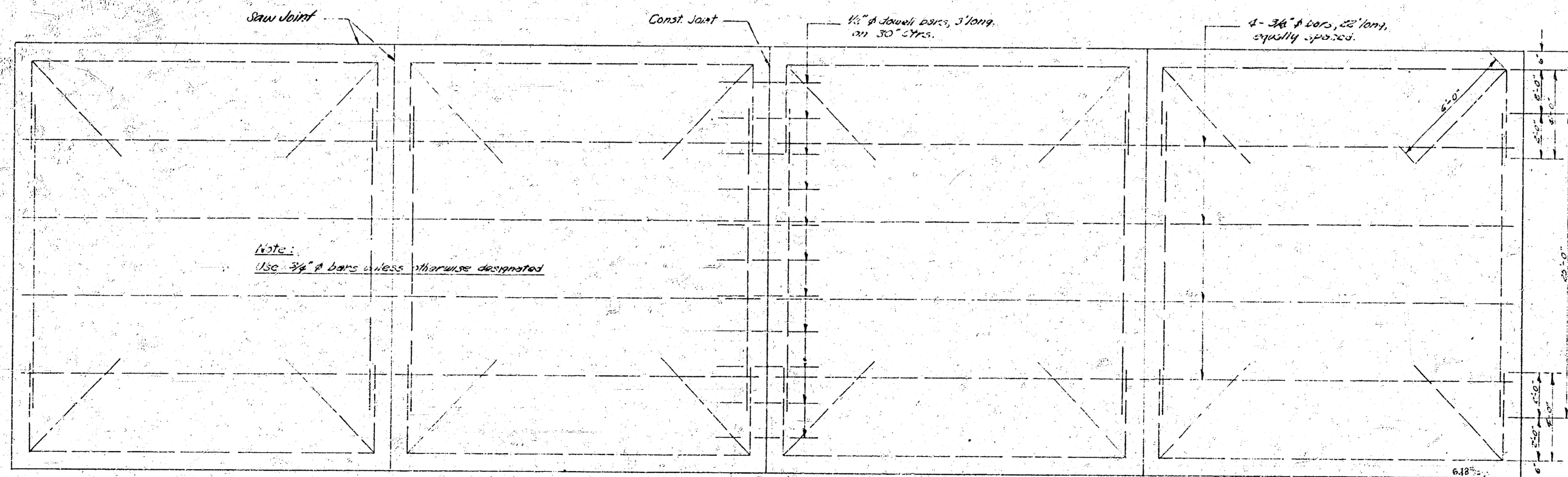

STEEL PATTERN
 NO SCALE

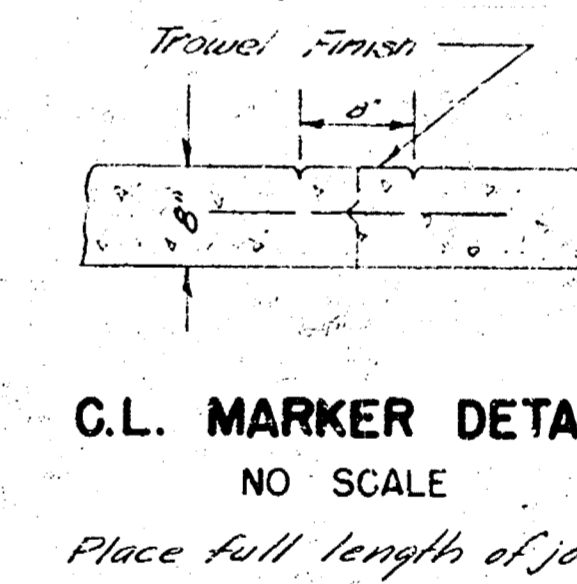

B.M. 10153 'M' in Markin App. W. of W. Ch. Erie, S.E. Harry
 B.M. 10845 N.E. Cor. Conc. base signal 1/4 mi. S.E. Cor. G. W. Blvd. & Harry
 B.M. 10392 'X' on S. end W. coping conc. Culvert 200' N. of Harry, W.S. G.W. Blvd.



Prop.	4.1	102.4
Asst.	4.1	102.4
Check.	4.1	102.4
Appr.	4.1	102.4
Dist.	4.1	102.4

Survey
 Plan
 Checked

NOTE: Remove part of drive as shown to hook up.

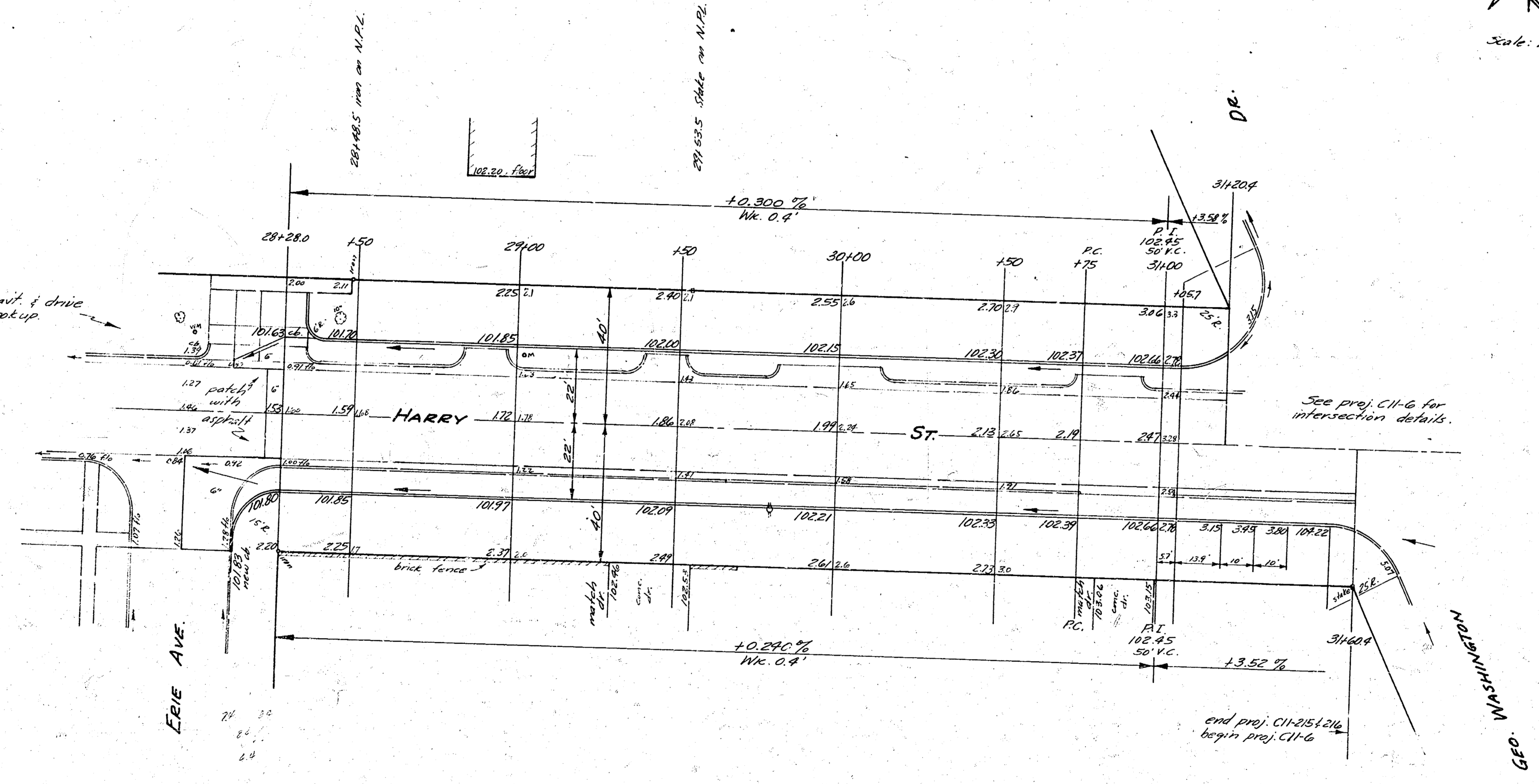

NOTE: Penetration mat & gravel driveway to be included in common excavation.

See proj. C11-6 for intersection details.

end proj. C11-215 & 216
 begin proj. C11-6

HARRY ST.
 E.L. ERIE TO W.L. GEO. WASH. DR.
 30' CONC. & CB. - 8" THICK
 WIDEN TO 44' CONC. - 8"
 CITY OF WICHITA, KANSAS
 B.E. SMITH - CITY ENGINEER
 AUG, 1957 Proj. C11-215 & C11-216



2
 3

