

Date: 4/15/64
 Drawn: S.M.

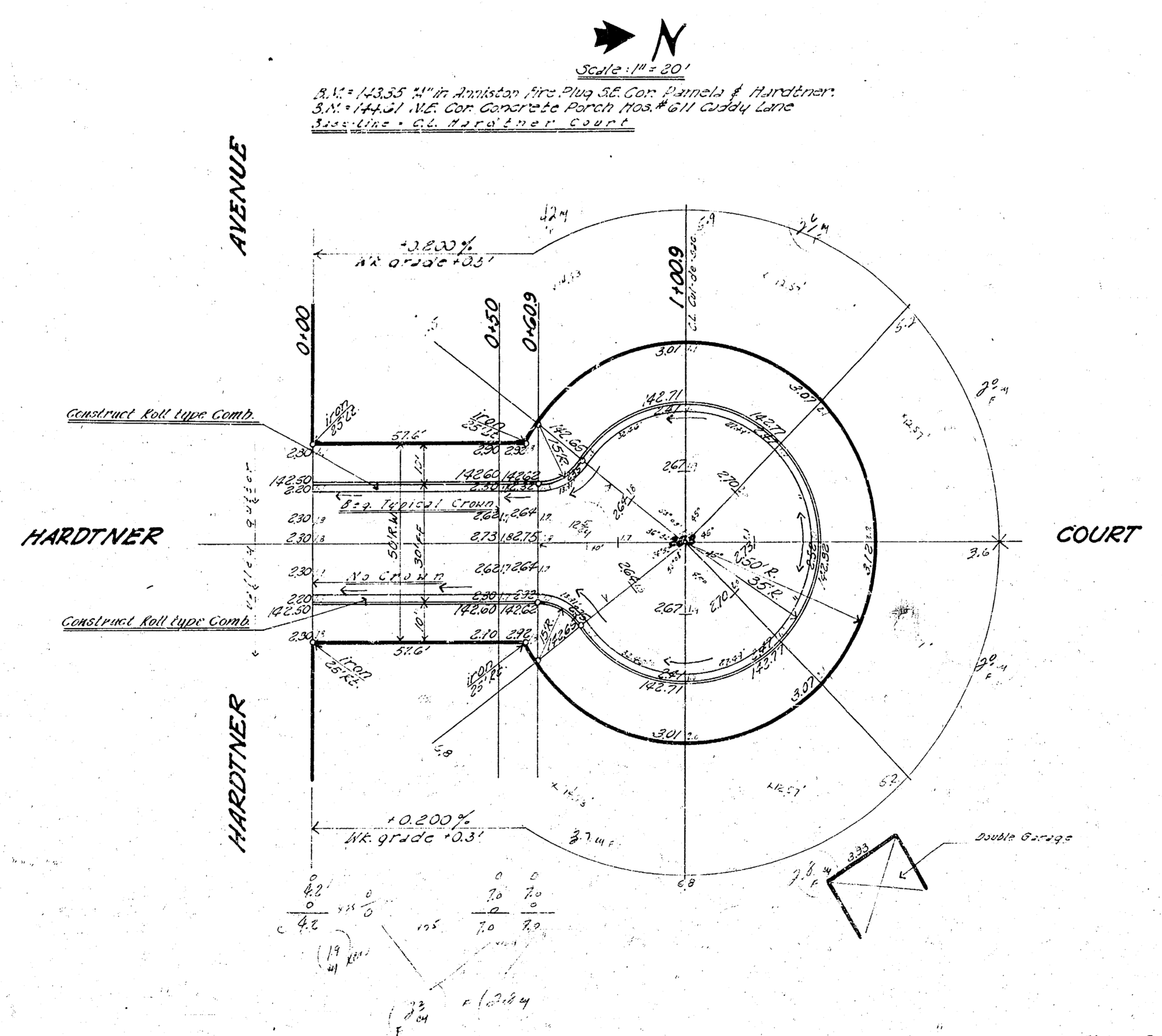
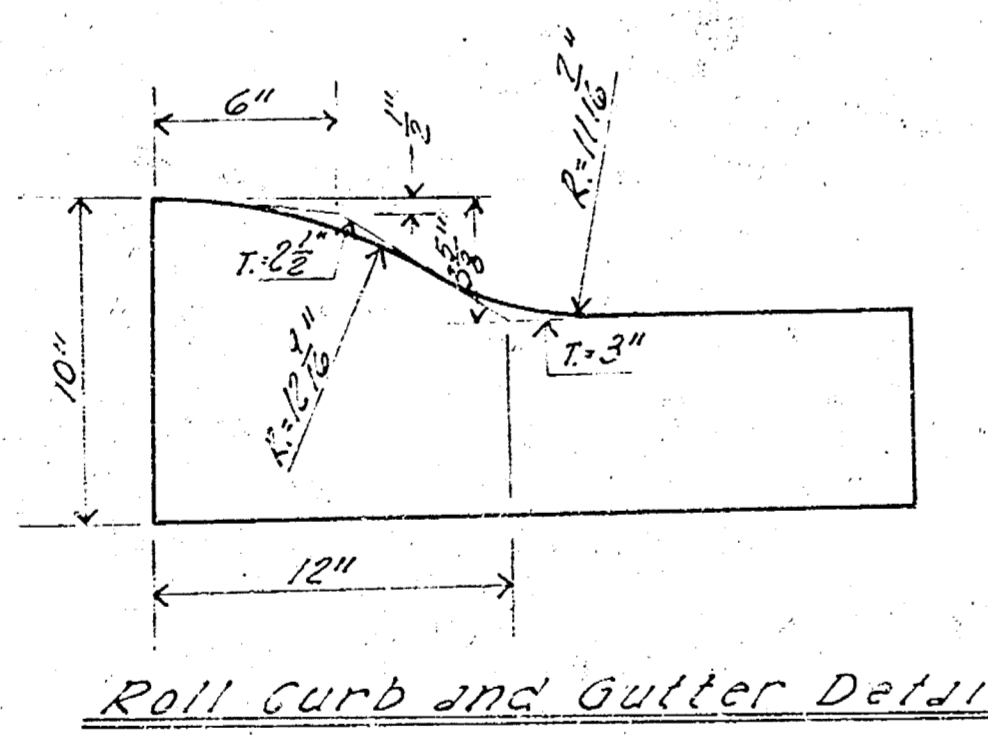

Comp. Fill	Excav.
35.3	27.05
36.10%	0.240%
39.704	21.04

HARDTNER COURT

142 Hardtner Avenue to 2nd existing Cul-de-sac.

26'-2'-50' Asphaltic Concrete

City of Wichita, Kansas

B.E. Smith City Engineer
 Date: APRIL 1964 Project Number CM-5

