

B.M. 107.96 "a" on S.W. cor. Lane Dm. catch basin NE cor. Harry & Edwards.
 B.M. 106.74 Standard N.W. cor. Harry & Meridian

Sta. on E

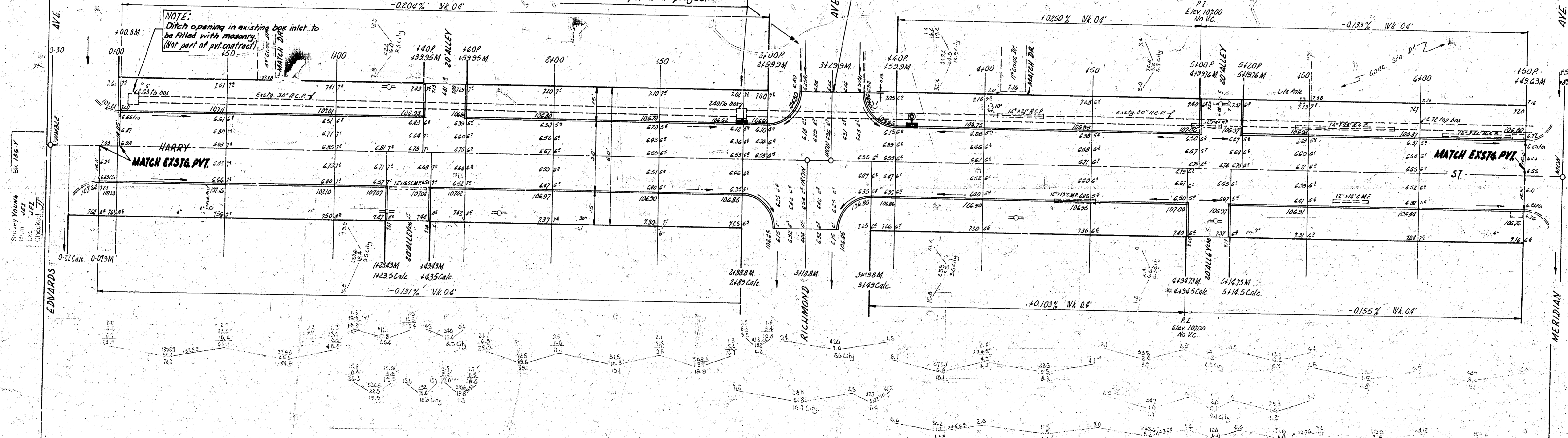

NOTE:
 Install 2'-2.5' C.B.s & 1'-M.M. together with
 necessary pipe. Installation of same is
 to be a separate item and is not to be
 apart of the pavement project.



TOTAL EXCAV.		TOTAL FILL	
PROP.	CITY	PROP.	CITY
328.8	80.3	31.2	4.6
+10%	30.2	+10%	1.0
361.7 Cu Yds.	110.5 Cu Yds.	32.5 Cu Yds.	4.8 Cu Yds.

HARRY ST.
 E.L. EDWARDS - W.L. MERIDIAN
 30' CONC. & C.B.
 CITY OF WICHITA, KANS.
 B.E. SMITH CITY ENGINEER
 JULY 1956 PROJ. C16-56