

B. M. 101.942 City Std. at Pawnee & Glenn & W. of 2' South of Southeast cor.  
 B. M. 101.55 1/2" bridge spike on S. E. side of wood street light pole at NW cor. Haskell & Millwood

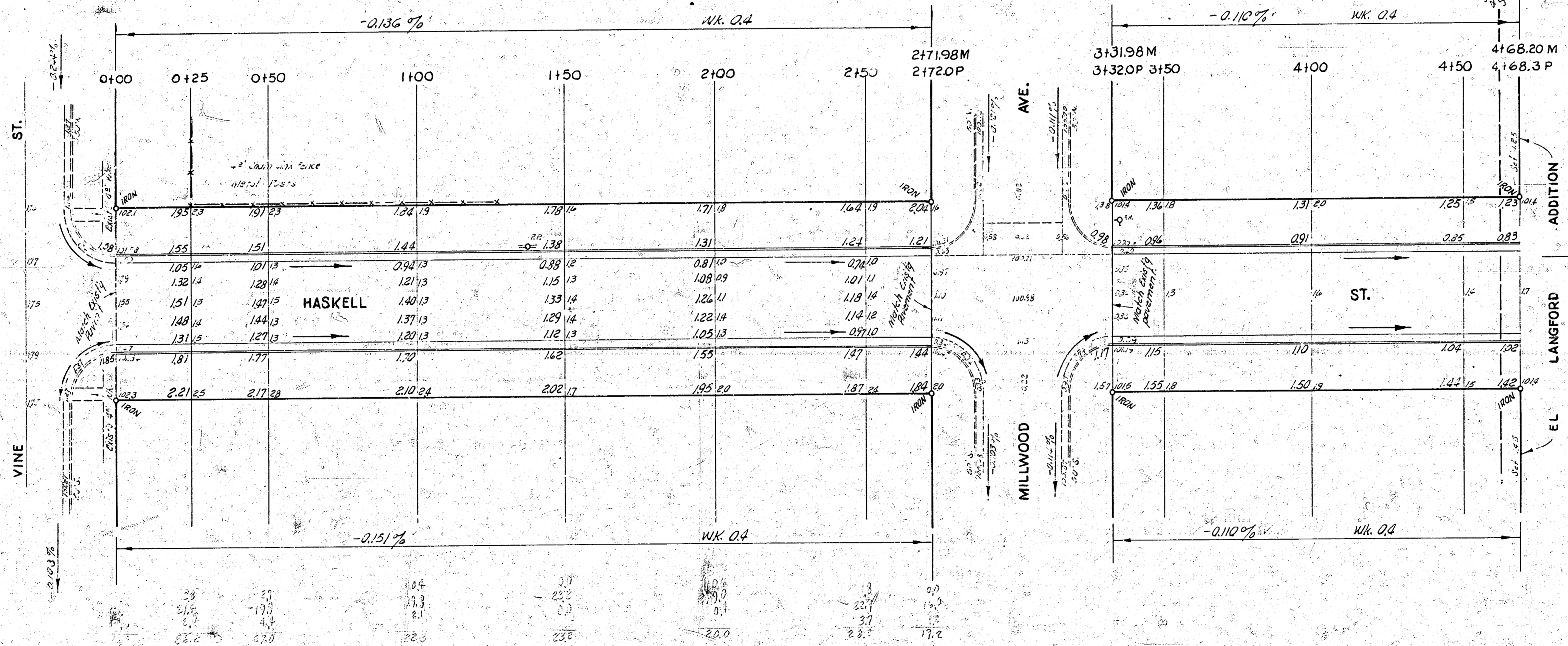

Shown by  
 Plan  
 Exc  
 Proposed

PROP.  
 Excavation  
 232.3 cu yds  
 141.9  
 433.6  
 +10%  
 173.8 cu yds

City  
 0

**HASKELL ST.**  
 EL VINE TO EL LANGFORD ADDN.  
 26-2-30 A.C.  
 CITY OF WICHITA, KANSAS  
 B. E. SMITH CITY ENGINEER  
 MAY 1957 PROJ. NO. C15-72