

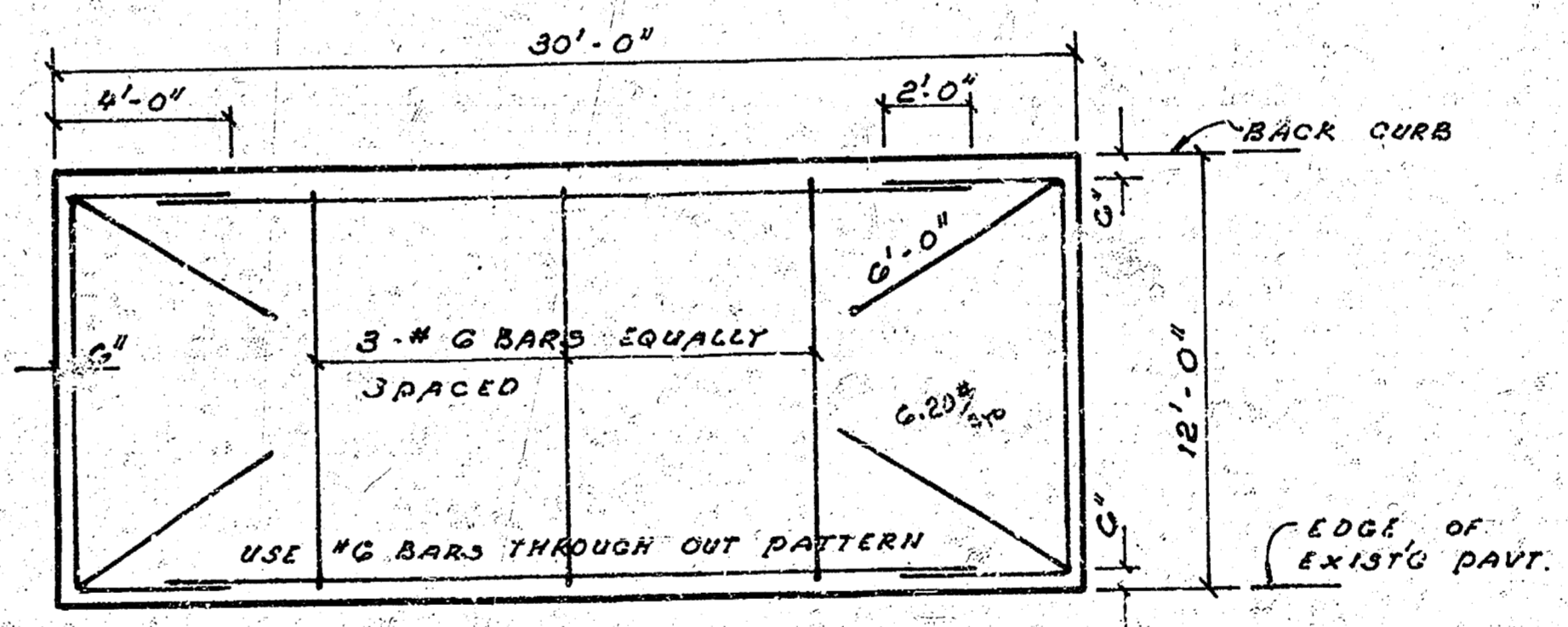

"SIDEWALK"  
Grade parking and clear R of W for proposed sidewalk. Compact fill in wall area. Walk to be constructed by "OTHERS".

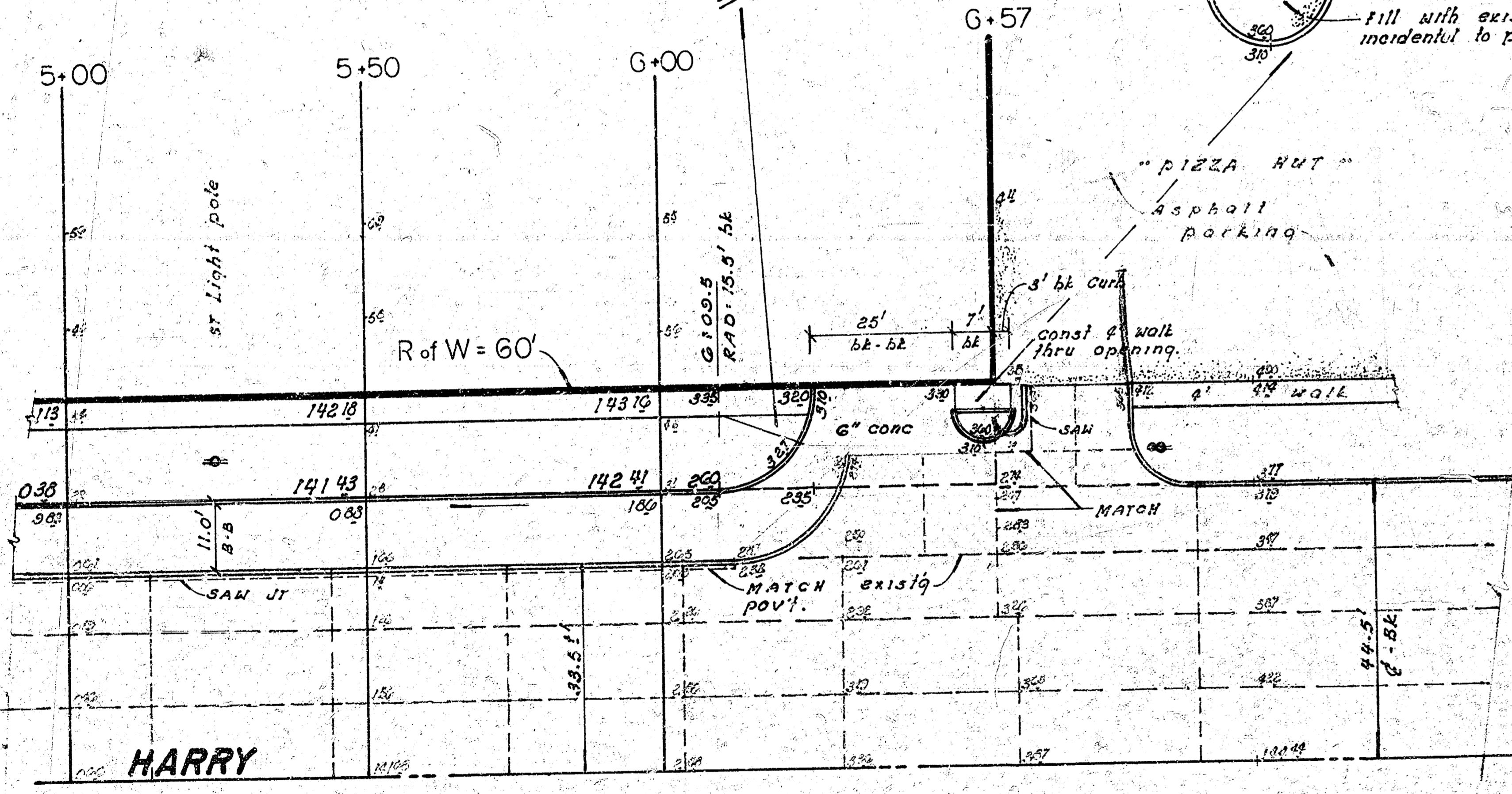
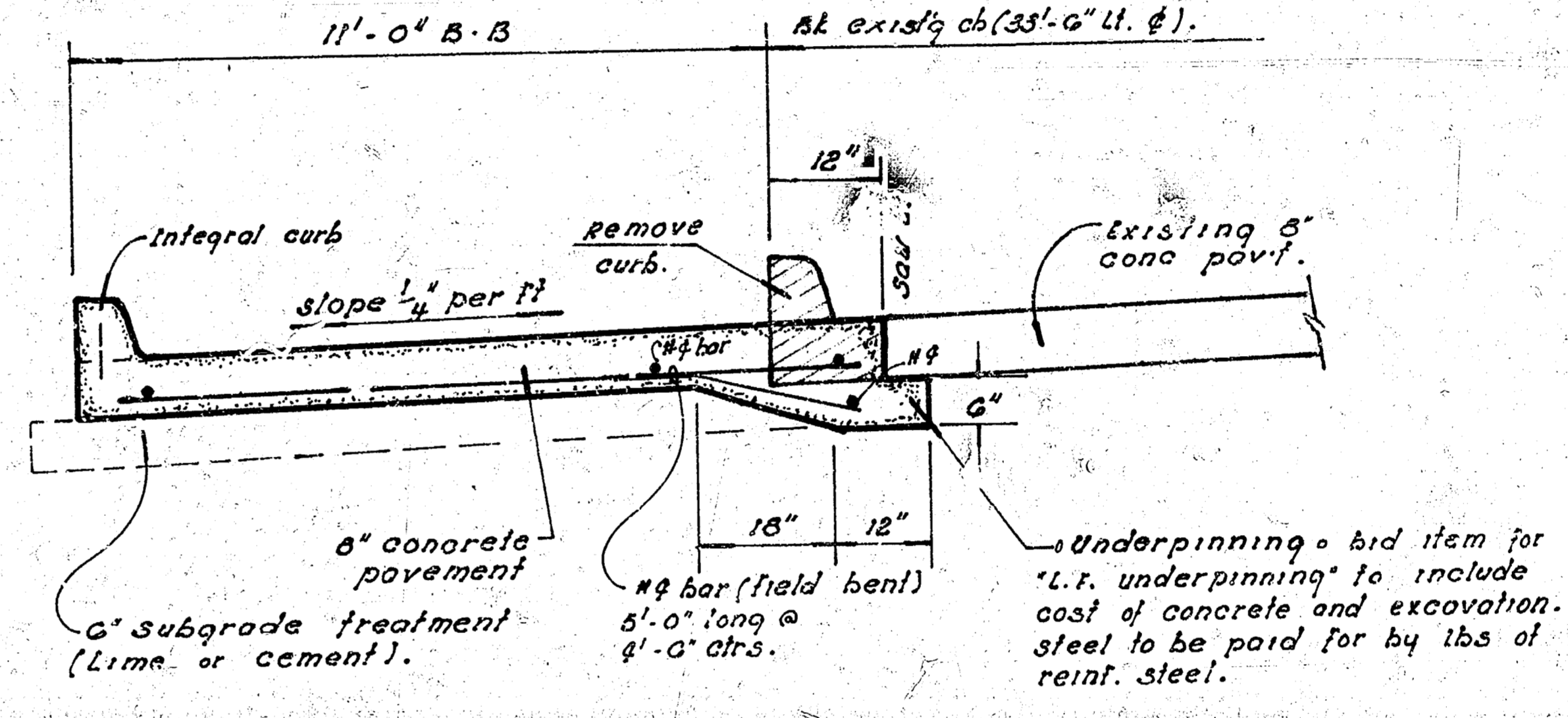
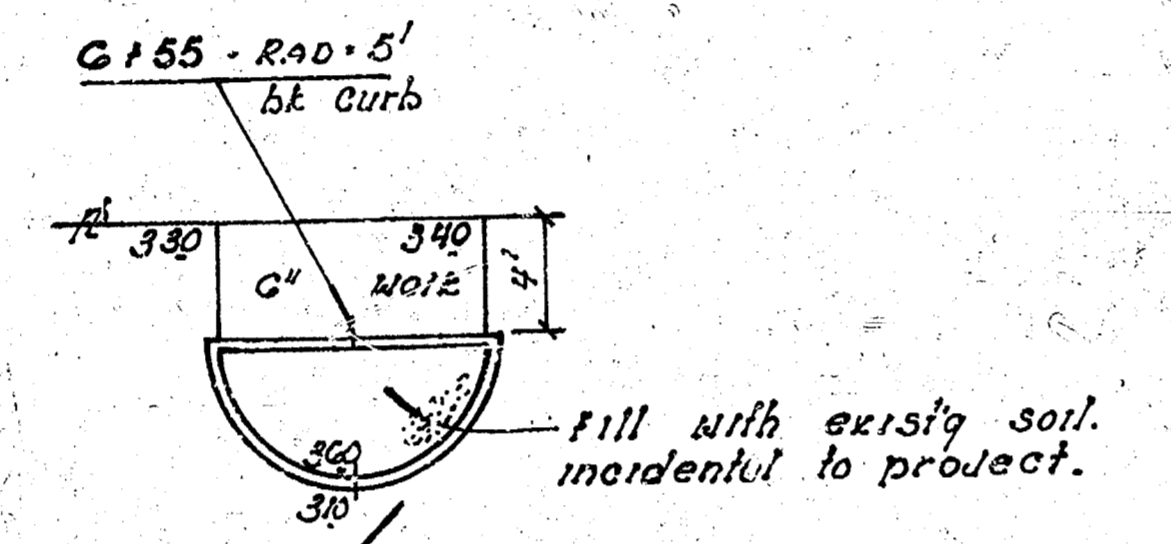
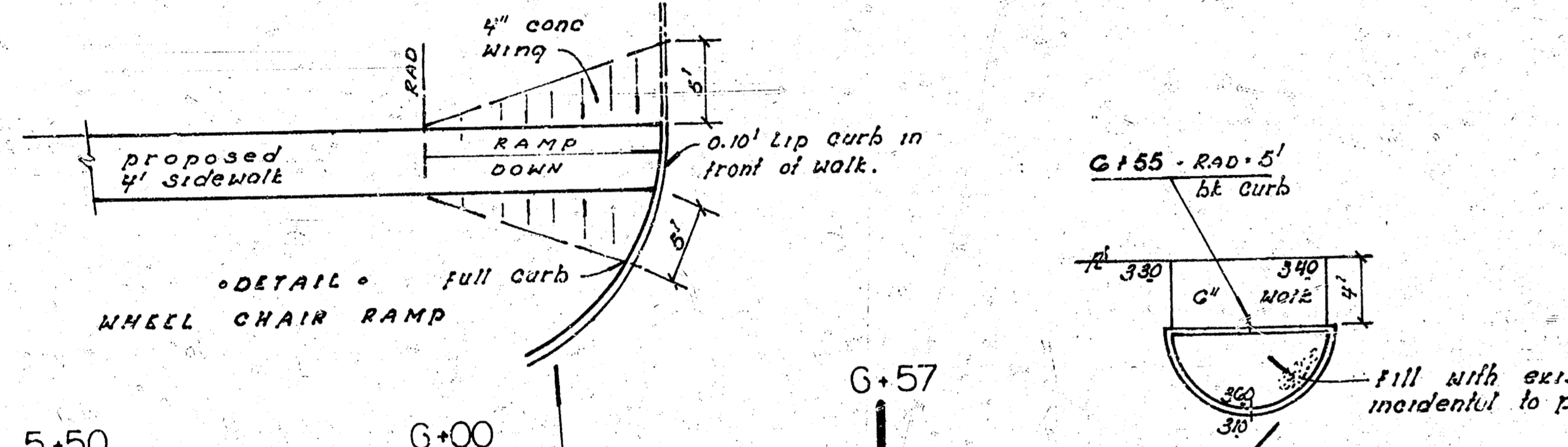
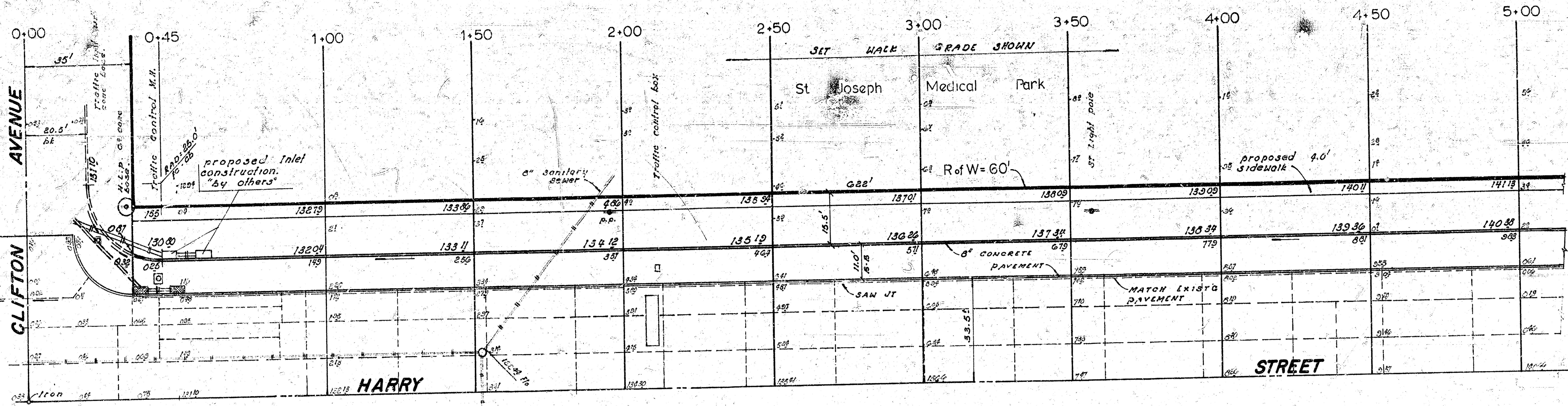

EARTHWORK		QUANTITIES	
EXCAVATION	635.1 CU YDS	COMP FILL	30.0 CU YDS
10%	63.5 "	10%	3.0 "
	698.6 CU YDS		33.0 CU YDS

DECLARATION LANE  
N. Side HARRY STREET  
E.L. CLIFTON AVE to a point  
622' E. of E.L. CLIFTON AVE.  
CITY of WICHITA, KAN.  
R.W. LINN CITY ENGINEER  
DATE MAY 1974 Proj No. DAKS 573

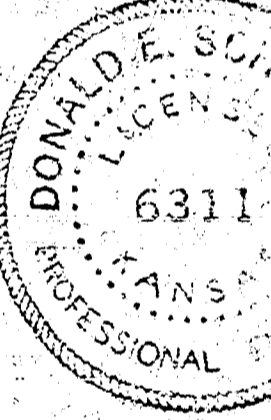

"IRON - & HARRY and BLUEVIEW"