

BM: 125.448 Standard NW cor 13th & Sheridan
 BM: 126.12 "x" in E Wk North at SW cor church @ 13th & High
 BM: 127.22 NE cor conc. porch Ho# 1557 N. High

NOTICE TO CONTRACTOR:
 All entrance pipes are to be disposed of in
 accordance with instructions of City Ditch Checker.

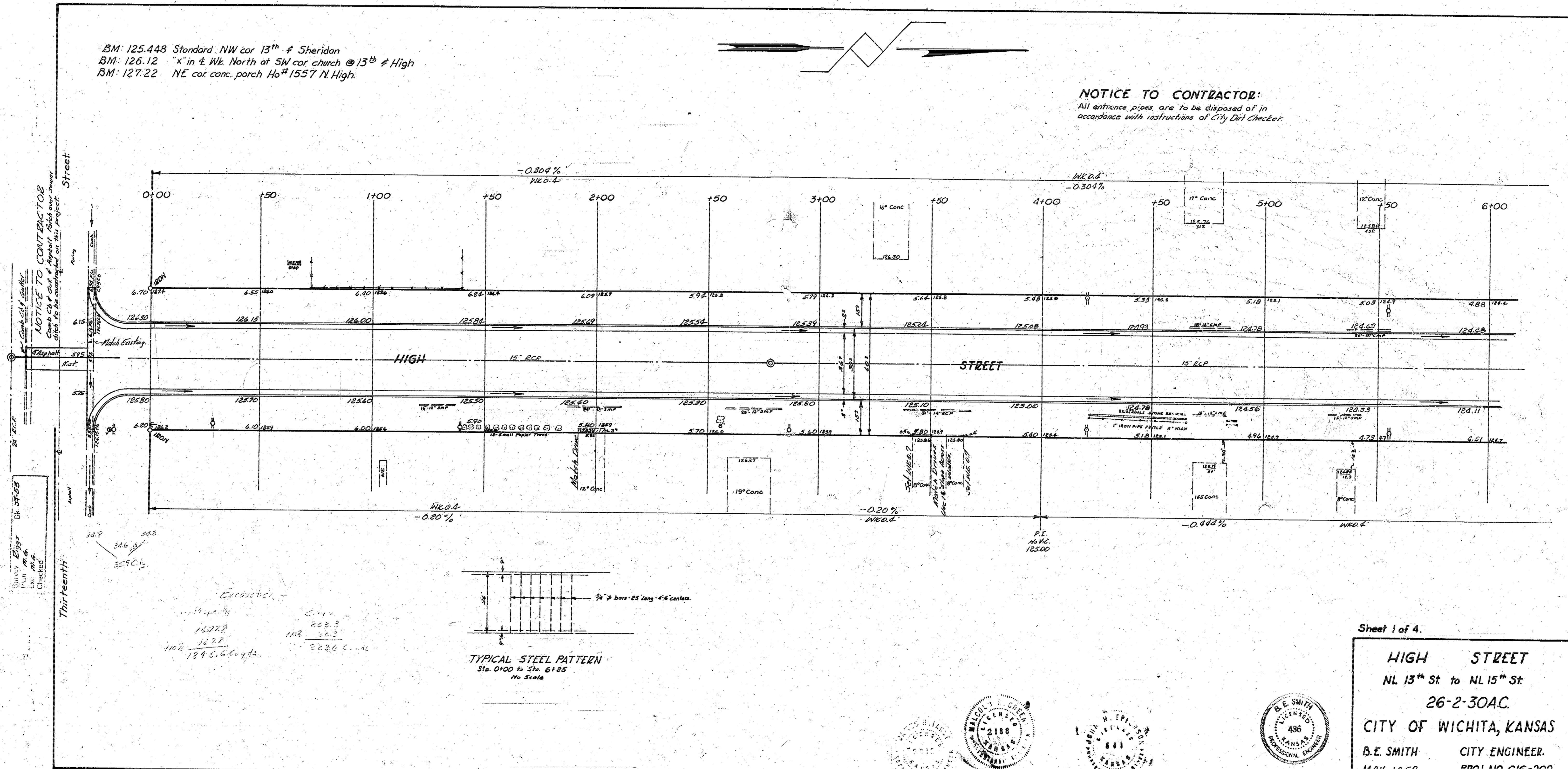

Sheet 1 of 4.

HIGH STREET
 NL 13th St to NL 15th St
 26-2-30AC.
 CITY OF WICHITA, KANSAS
 B.E. SMITH CITY ENGINEER.
 MAY 1957 PROJ NO. C16-209.



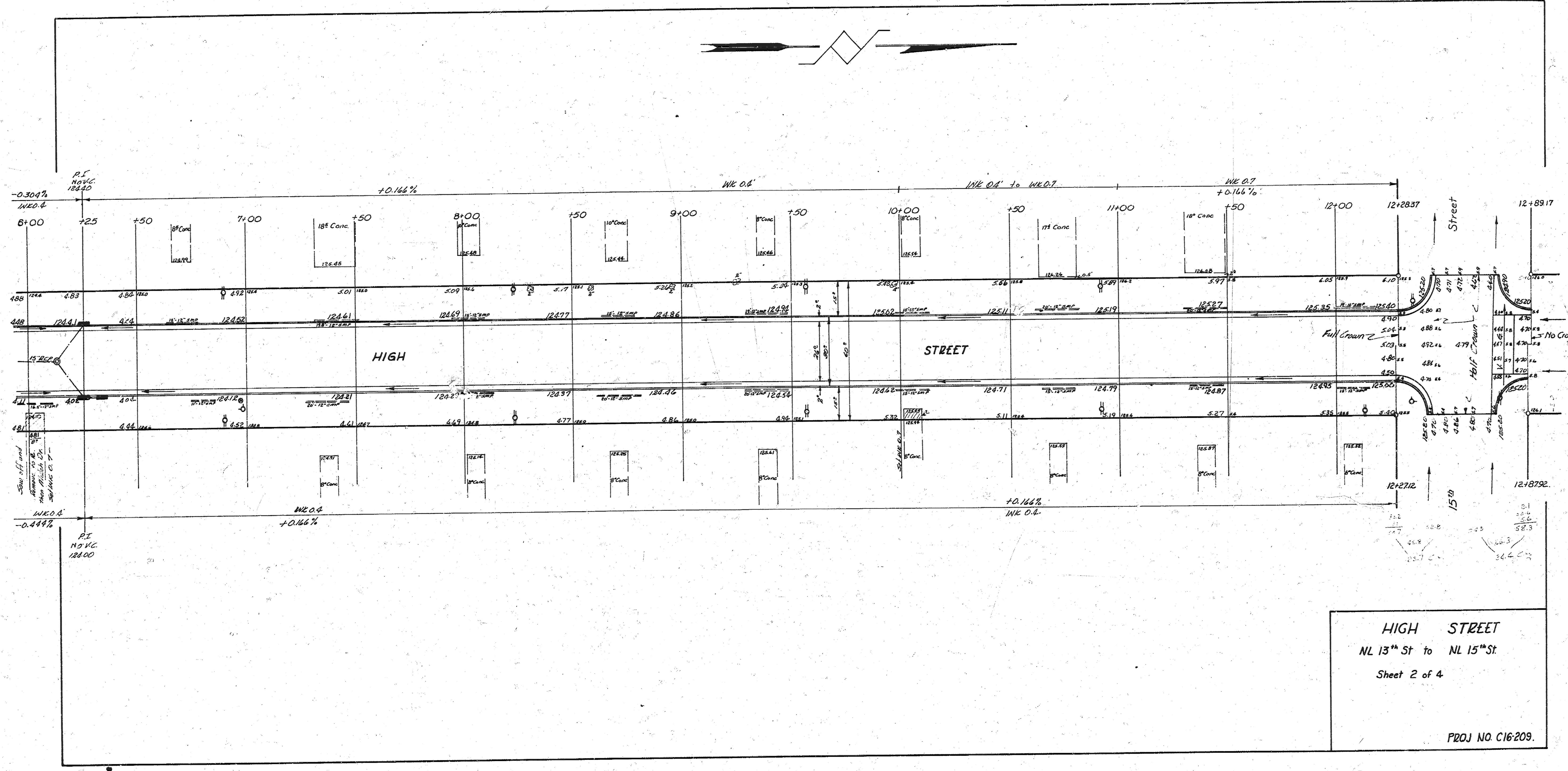
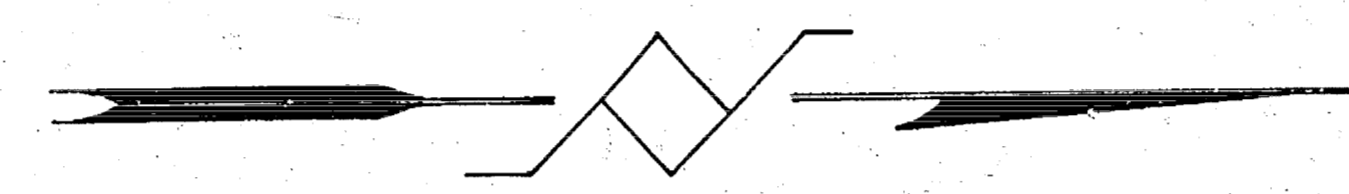

HIGH STREET
NL 13th St to NL 15th St
Sheet 2 of 4
PROJ NO. C16209.



Scale: 1" = 40'

