

B. M. 96.30 "a" on top NE wing conc. bridge on 33rd St. W.S. Meridian.
 B. M. 98.85 SW cor. conc. porch to #3410 S. Meridian
 B. M. 95.65 "b" in 58' cir. of SW Rad. St. Clair Ave. & Heuett Ave.
 Base = & Heuett Ave.

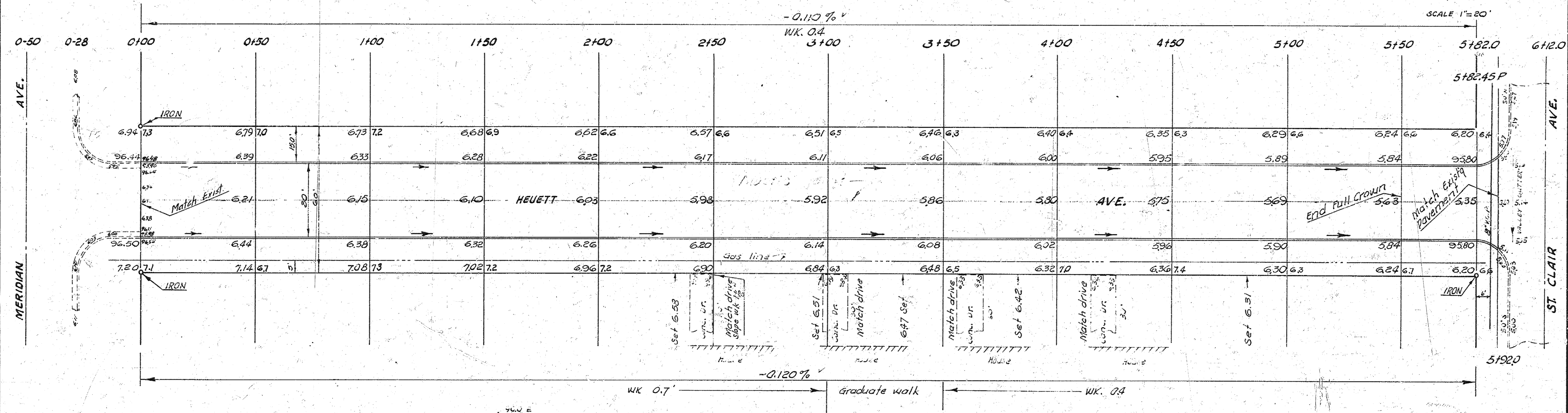
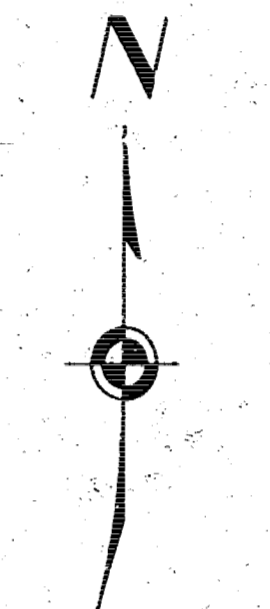

Checked by
 Drawn by
 B.E. Smith

*See yds extra conc. for 1/2" dia. and
 match joint to adjacent.*

EARTH WORK
 EXCAVATION

CITY	PROP.
10.0	1077.4
1.0	107.7
11.0 Cu. Yds.	1,185.1 Cu. Yds.

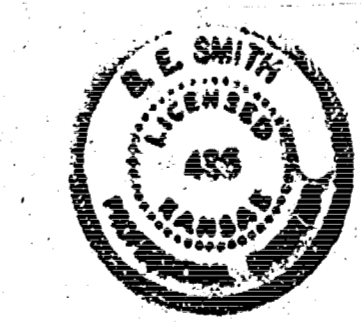
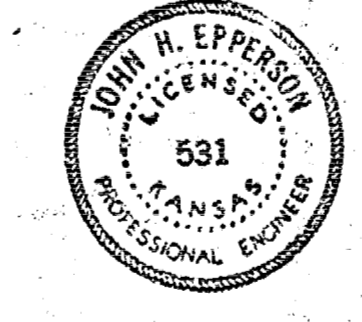

HEUETT AVE.
 EL MERIDIAN AVE. TO WL ST. CLAIR AVE.
 30' CONC. & CB.
 CITY OF WICHITA, KANSAS
 B. E. SMITH CITY ENGINEER
 APRIL 1962, PROJ. NO. C13-19