

E.M. 130.85 1" CUT TOP 4. CURB 17' ST. @ W.L. ILLINOIS.
 E.M. 128.05 S.W. COR. CONC. WK. @ S.W. COR. GARAGE HOUSE NO. 1614 ILLINOIS.
 E.M. 127.85 S.W. COR. CONC. STEP HOUSE NO. 1710 ILLINOIS.
 BACK LINE ON EAST FE.

*J. Kringle Says
 Fence Remnant & Shrubbery
 No Trees Remain
 M.L.A. 2/7/70*

SCALE: 1" = 20'

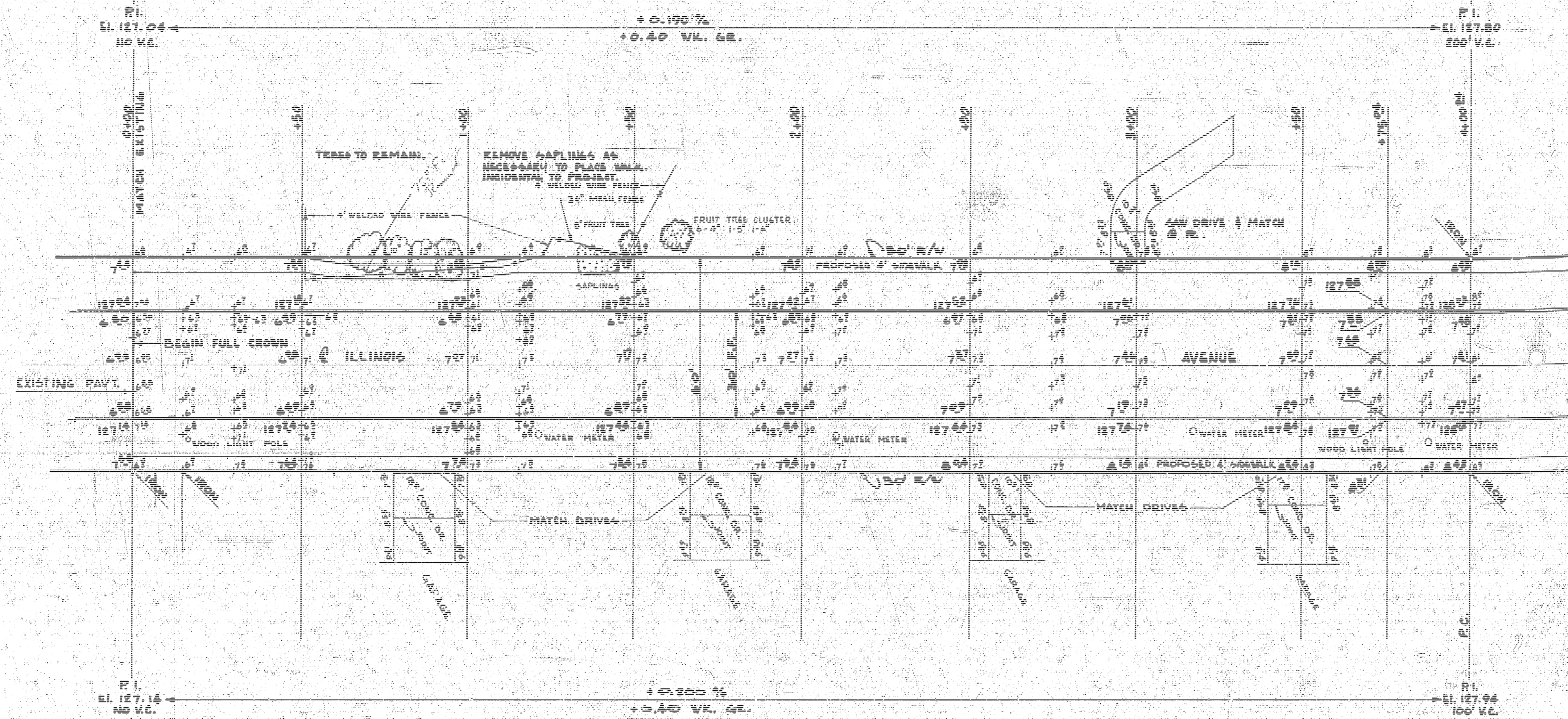

EARTHWORK		
EXCAVATION:	COMPACTED FILL:	
CITY	PROPERTY	PROPERTY
56' 04"	628' 04"	37' 04"
05'	428'	32'
61' 04"	671' 04"	40' 04"

GENERAL NOTE:
 CONTRACTOR SHALL CLEAR RIGHT OF WAY AND GRADE
 PAVEMENT FOR PROPOSED SIDEWALK.
 SIDEWALK TO BE CONSTRUCTED UNDER SEPARATE CONTRACT.

ILLINOIS AVENUE, N.E. 1/4 LOT 1, BLK. 3, WESTBRIAR
 ADD. TO THE S.E. 1/4 17TH ST.

CONCRETE PAVEMENT - 30' WIDE

CITY OF VICTORIA, KANSAS

E. E. SMITH, CITY ENGINEER

DATE: AUGUST, 1948

PROJECT No. C 18-57 SHEET 1 of 5

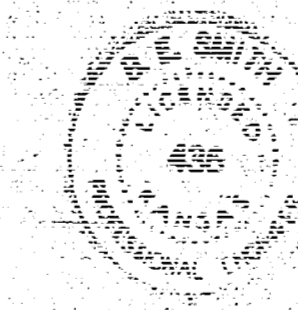
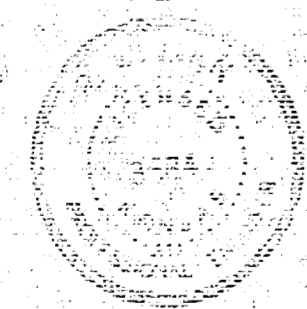

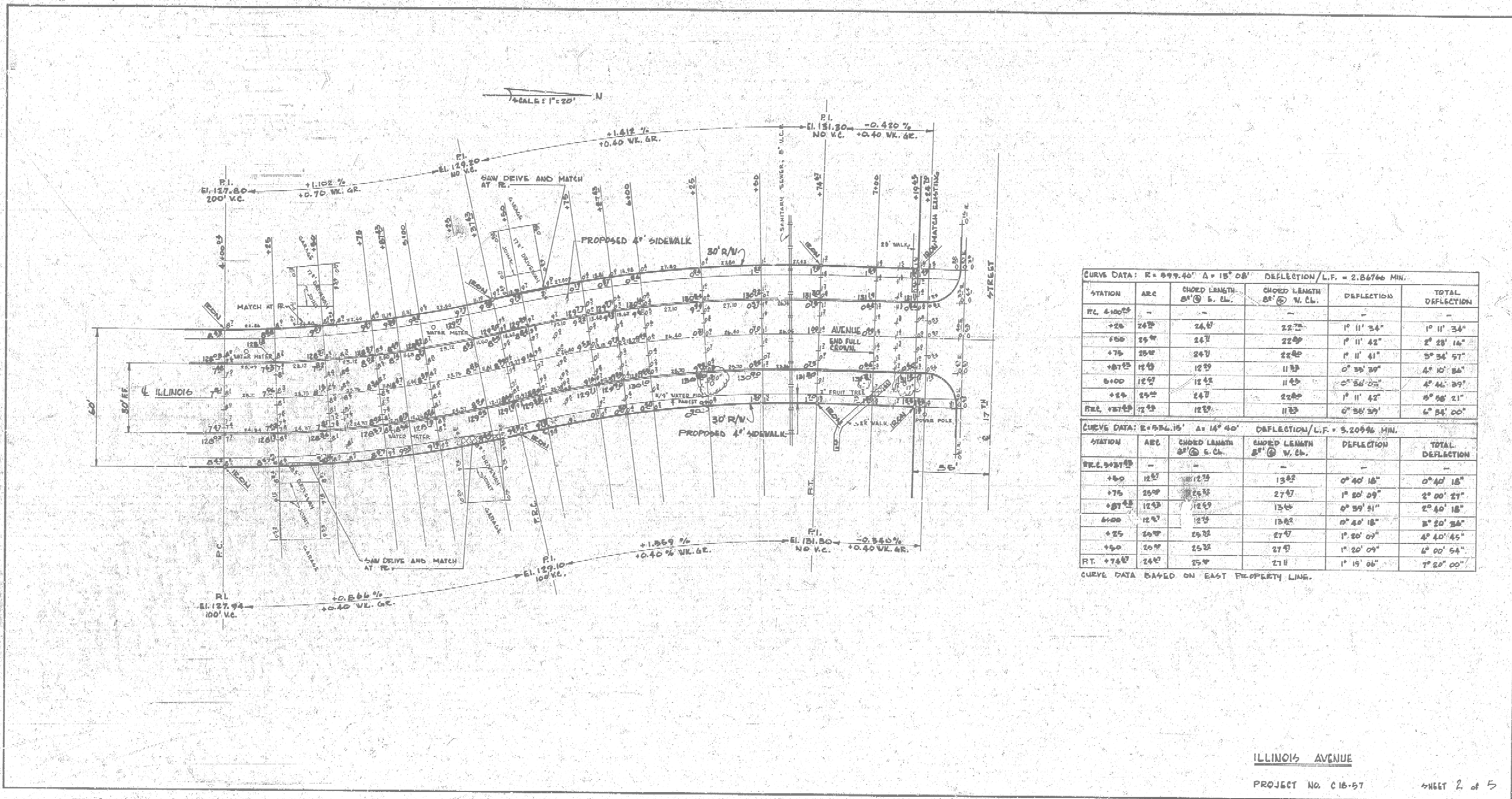

CURVE DATA: R = 999.40' A = 15° 08' DEFLECTION/L.P. = 2.86766 MIN.

STATION	ARC	CHORD LENGTH S' @ E. CL.	CHORD LENGTH S' @ W. CL.	DEFLECTION	TOTAL DEFLECTION
PC. 4+00.00	-	-	-	-	-
+25	26.7	26.7	22.75	1° 11' 34"	1° 11' 34"
+50	53.4	53.4	22.8	1° 11' 42"	2° 23' 16"
+75	80.1	80.1	22.8	1° 11' 41"	3° 34' 57"
+100	106.8	106.8	11.8	0° 55' 39"	4° 30' 56"
+125	133.5	133.5	11.8	0° 55' 39"	5° 26' 35"
+150	160.2	160.2	11.8	1° 11' 42"	6° 38' 17"
PT. 4+75.00	186.9	186.9	11.8	0° 55' 39"	7° 33' 00"

CURVE DATA: R = 544.70' A = 14° 40' DEFLECTION/L.P. = 3.20926 MIN.

STATION	ARC	CHORD LENGTH S' @ E. CL.	CHORD LENGTH S' @ W. CL.	DEFLECTION	TOTAL DEFLECTION
PC. 5+25.00	-	-	-	-	-
+50	12.5	12.5	13.25	0° 40' 18"	0° 40' 18"
+75	25.0	25.0	27.47	1° 20' 09"	2° 00' 27"
+100	37.5	37.5	27.47	0° 59' 51"	3° 00' 18"
+125	50.0	50.0	15.82	0° 40' 18"	3° 20' 36"
+150	62.5	62.5	27.47	1° 20' 09"	4° 40' 45"
+175	75.0	75.0	27.47	1° 20' 09"	6° 00' 54"
PT. 5+75.00	87.5	87.5	27.47	1° 19' 08"	7° 20' 00"

CURVE DATA BASED ON EAST PROPERTY LINE.