

B.M. 133.26 "M" in Muller S.E. cor. 19th & Westridge.
 B.M. 130.61 S.E. cor. conc. porch No. 1951 Joann.

Note: Contractor to clear right of way, grade parking and compact fill where necessary for 2 inch sidewalk which will be constructed by the contractor.

CURVE DATA BASED ON LT. R, R=241.82' Δ = 46°

| Station | Arc | 8" LI CB Chord Length | 8" PI CB Chord Length | Deflection | Total Deflection |
|--------------|--------|-----------------------|-----------------------|------------|------------------|
| 2172.99 P.C. | - | - | - | 0° 00' 00" | 0° 00' 00" |
| 3100 | 27.01' | 26.03' | 20.85' | 3° 10' 47" | 3° 10' 47" |
| 125 | 25' | 24.10' | 19.29' | 2° 57' 4" | 6° 08' 29" |
| 150 | - | - | - | - | 9° 06' 12" |
| 175 | - | - | - | - | 12° 03' 33" |
| 4100 | - | - | - | - | 15° 01' 35" |
| 125 | - | - | - | - | 17° 59' 17" |
| 150 | 25' | 24.10' | 19.29' | 2° 57' 41" | 20° 56' 59" |
| 4167.30 P.T. | 17.30' | 16.67' | 13.35' | 2° 02' 59" | 23° 00' 00" |

Deflection: 7.1080 Min. per foot arc.

CURVE DATA:
 P.I. Sta 3175.72 LI 3150.26 RI
 Δ = 46°
 R = 241.82 LI + 191.97 RI
 D = 53° 40' 22" LI 53° 39' 40" RI
 T = 102.93 LI 77.27 RI
 L = 194.91 LI + 146.14 RI

Note: Contractor to install pre-cast expansion joint as shown on plans. Contractor to install keyed joints in pavement & dowels in drives as per specifications. Contractor to install pre-cast expansion joint as shown on plans.

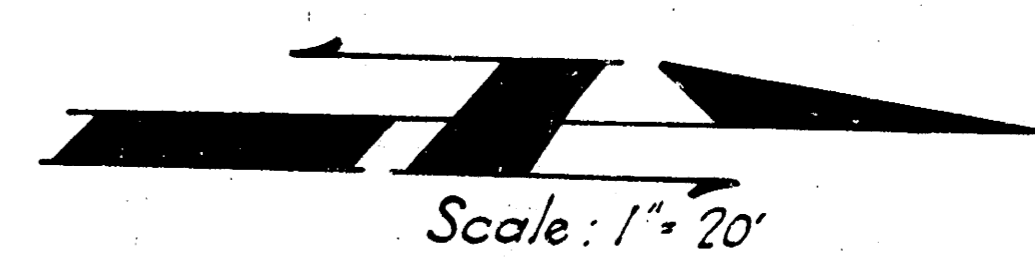

Survey by J. H. Smith
 Checked by J. H. Smith

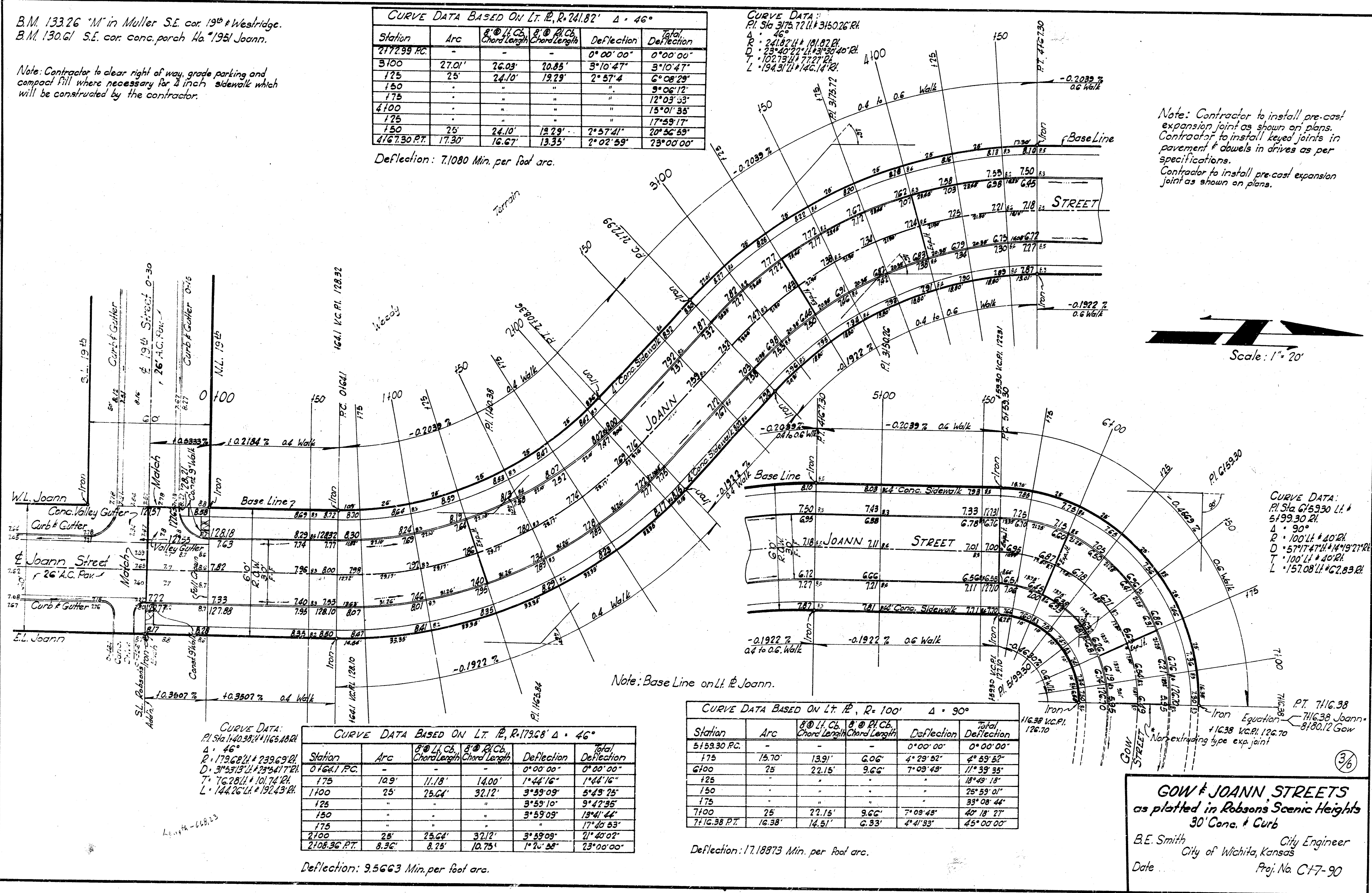

CURVE DATA:
 P.I. Sta 140.38 LI 116.10 RI
 Δ = 46°
 R = 179.62 LI + 239.63 RI
 D = 3° 53' 15" LI 3° 54' 17" RI
 T = 76.28 LI + 101.74 RI
 L = 144.26 LI + 192.43 RI

CURVE DATA BASED ON LT. R, R=179.68' Δ = 46°

| Station | Arc | 8" LI CB Chord Length | 8" PI CB Chord Length | Deflection | Total Deflection |
|--------------|-------|-----------------------|-----------------------|------------|------------------|
| 0766.1 P.C. | - | - | - | 0° 00' 00" | 0° 00' 00" |
| 175 | 12.9' | 11.18' | 14.00' | 1° 44' 16" | 1° 44' 16" |
| 1100 | 25' | 25.64' | 32.12' | 3° 59' 09" | 5° 43' 25" |
| 125 | - | - | - | - | 9° 42' 35" |
| 150 | - | - | - | - | 13° 41' 44" |
| 175 | - | - | - | - | 17° 40' 53" |
| 2100 | 25' | 25.64' | 32.12' | 3° 59' 09" | 21° 40' 02" |
| 2108.36 P.T. | 8.36' | 8.28' | 10.75' | 1° 21' 38" | 23° 00' 00" |

Deflection: 9.5663 Min. per foot arc.

CURVE DATA BASED ON LT. R, R=100' Δ = 90°

| Station | Arc | 8" LI CB Chord Length | 8" PI CB Chord Length | Deflection | Total Deflection |
|--------------|--------|-----------------------|-----------------------|------------|------------------|
| 5153.30 P.C. | - | - | - | 0° 00' 00" | 0° 00' 00" |
| 175 | 15.70' | 15.91' | 14.00' | 4° 29' 52" | 4° 29' 52" |
| 6100 | 25' | 22.15' | 9.66' | 7° 09' 43" | 11° 39' 35" |
| 125 | - | - | - | - | 18° 49' 18" |
| 150 | - | - | - | - | 25° 59' 01" |
| 175 | - | - | - | - | 33° 08' 44" |
| 7100 | 25' | 22.15' | 9.66' | 7° 09' 43" | 40° 18' 27" |
| 7115.38 P.T. | 16.38' | 14.51' | 6.33' | 4° 41' 33" | 45° 00' 00" |

Deflection: 17.18873 Min. per foot arc.

GOW & JOANN STREETS
 as platted in Robson's Scenic Heights
 30' Conc. & Curb
 B.E. Smith City Engineer
 City of Wichita, Kansas
 Date _____ Proj. No. C17-90

