

BM 96.10 SE Cor. Conc. Porch Ho. No. 2869 LAURA
 BM 96.15 SW Cor. Conc. Porch Ho. No. 1302 JUMP
 BM 96.83 SE Cor. Conc. Porch Ho. No. 1526 JUMP

Surveyed
 Plan
 Checked
 BK & WAG

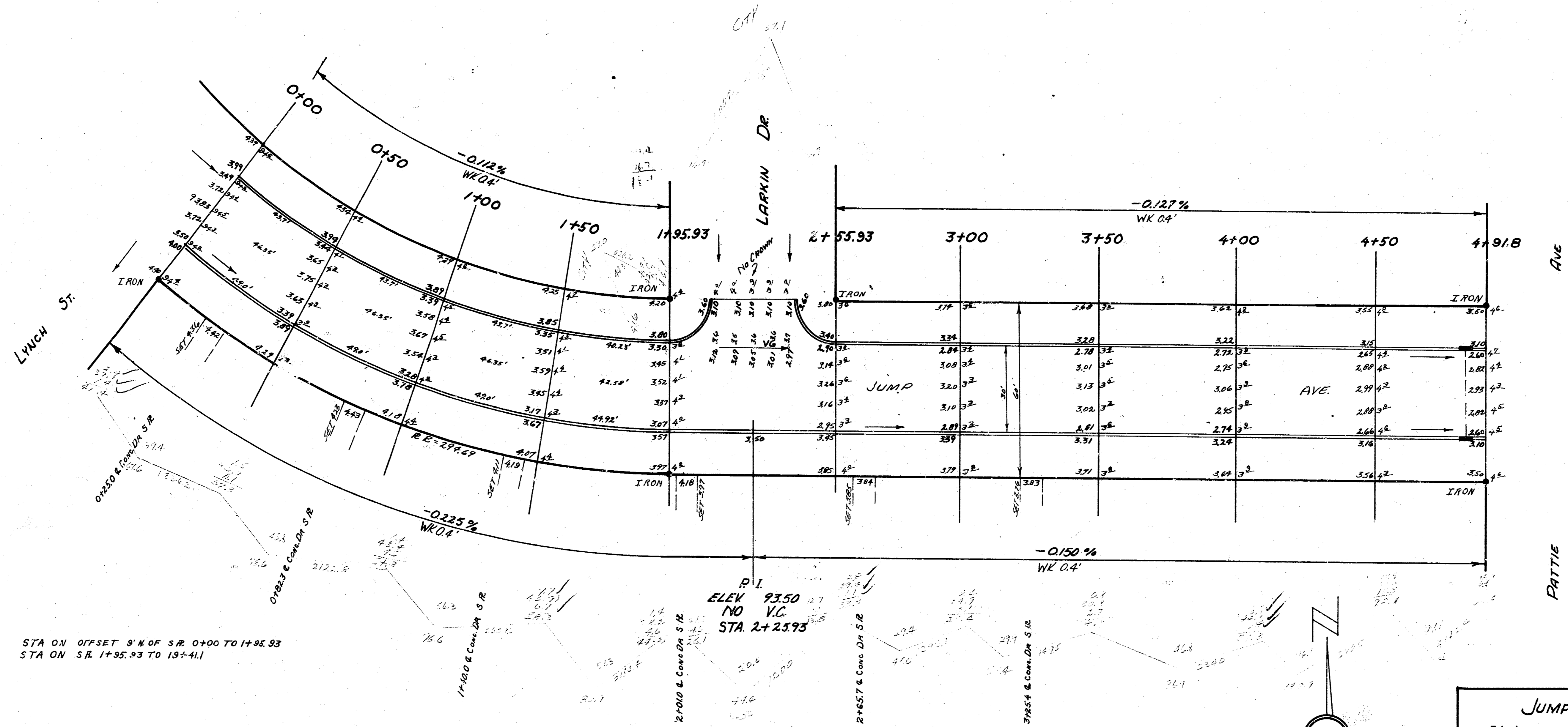

STA ON OFFSET S' N OF S.R. 0+00 TO 1+95.93
 STA ON S.R. 1+95.93 TO 19+411

JUMP AVE
 EL. LYNCH TO WL HYDRAULIC
 30' CONC+CB
 CITY OF WICHITA, KANSAS
 B.E. SMITH CITY ENGINEER
 JAN. 8, 1953 Proj. No. C12-128

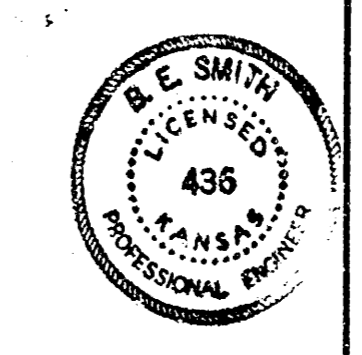

Station
CUM
to
Next
Station
BR

