

394

B.M. 116.39 - 4 in Mueller fire hyd. NW corner Hydraulic & 11th

NOTE: Any fill under pavement other than in sewer ditch is to be stabilized by means of sand with 1/2 inch of curbing with sheetpiled walls.

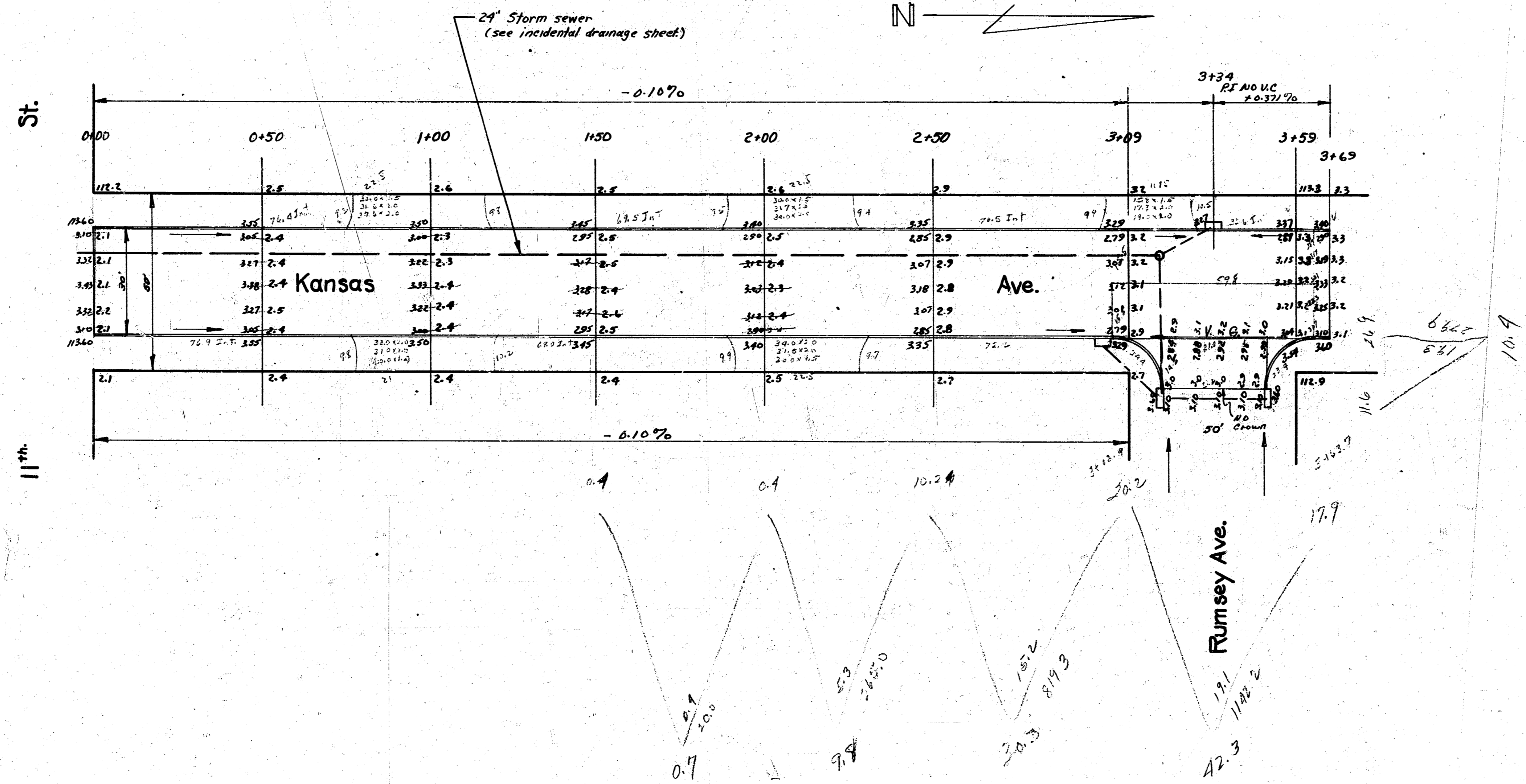

B.M. 116.39 - Min Mueller, Fire Hydr., N.W. corner Hydraulic & 11th

N 399

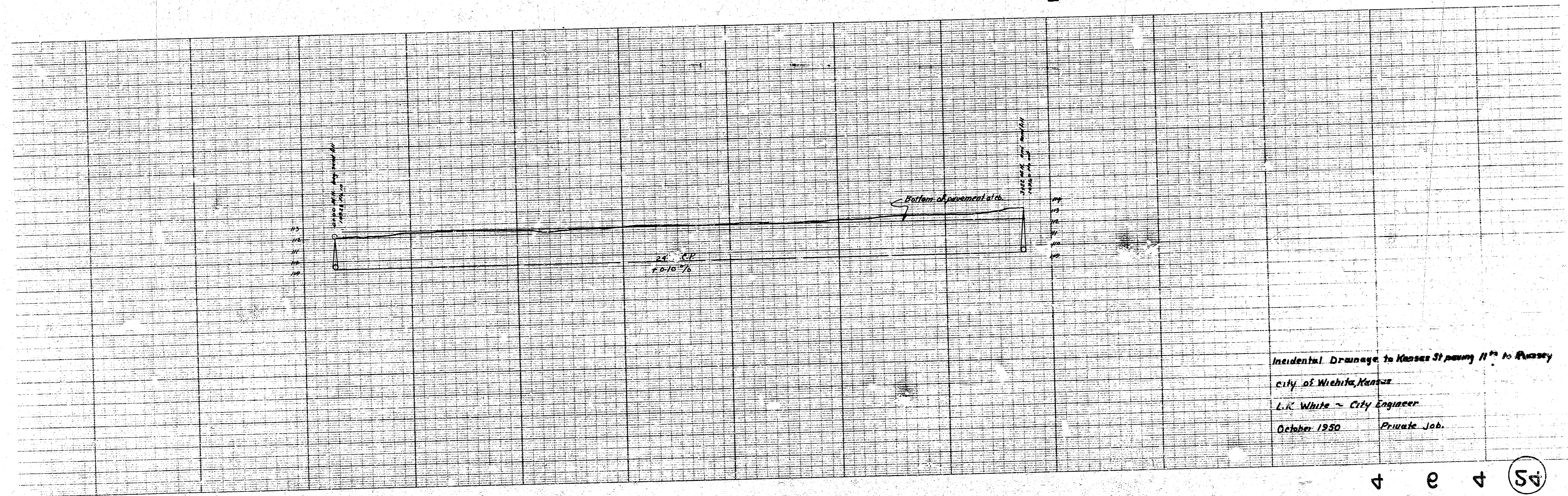
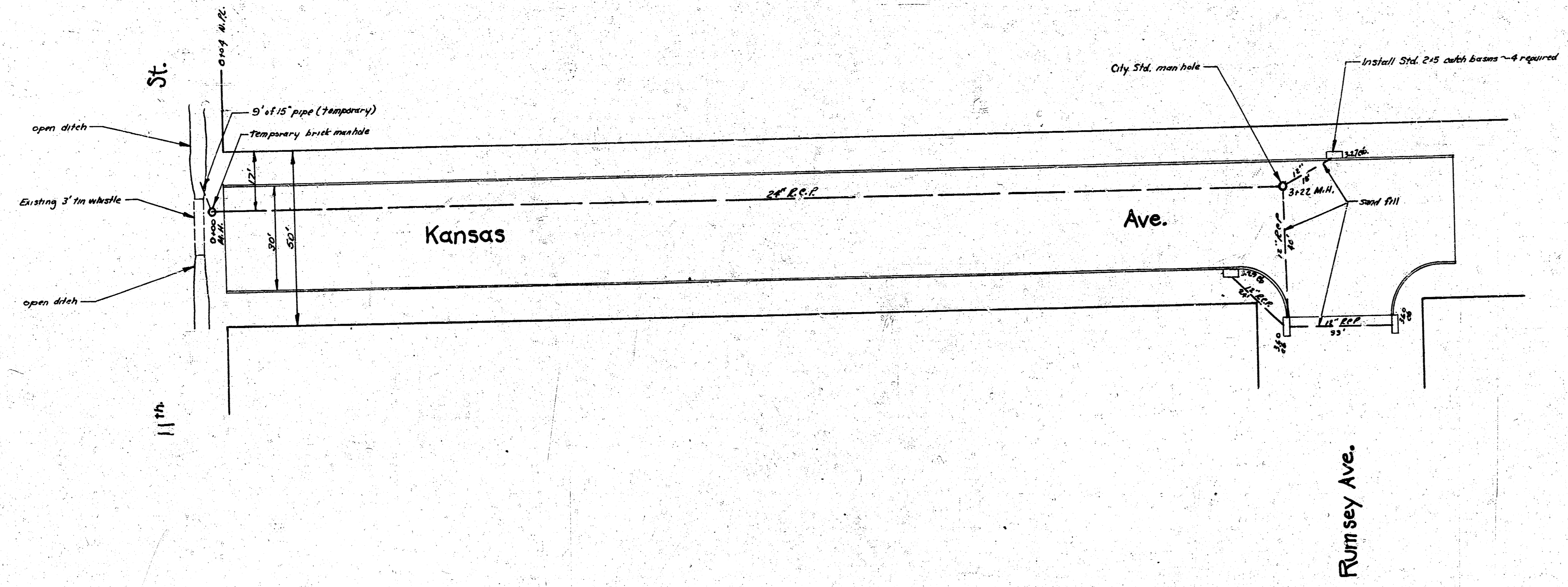

4 e 4 (54)