

Jennette - 24th to 26th

Tentative Grades Do not set until Blk north is laid for grade

26-2-30 Conc.

Blk. E. on 1145' D. in Municipal District No. 10. on 14th & Burnt
1172' E. in Municip. C. of W.K. 11. 1111 on 14th & Jennette

A. 1153.0
1125.0

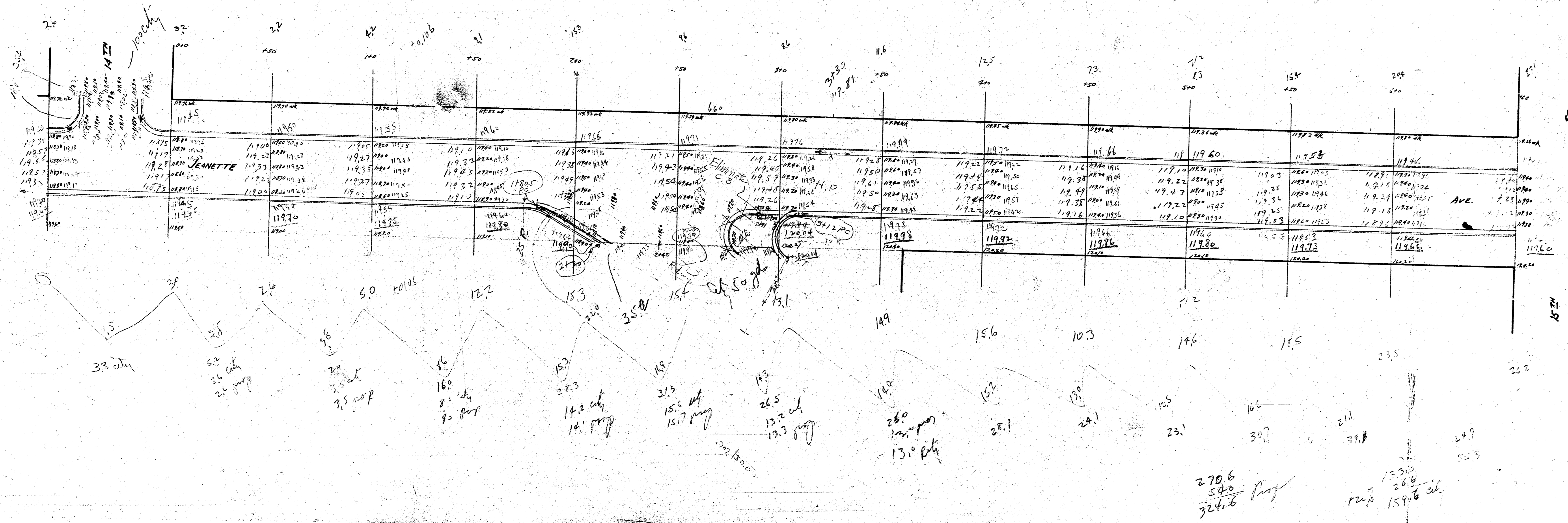

270.6
54.0
324.6 Proj

133.0
26.6
120.7
159.6 sh