

B.M. 162.27 "X" On N Headwall Conc Culv. N.S. Kellogg 75' East Of Woodlawn
 B.M. 155.465 "X" On W. Co. Woodlawn S End Rd. S.S. Orme
 B.M. 156.05 "X" In Riffchre E. Co. Fabrique S.L. Orme
 B.M. 163.01 "X" On N.W. Cor. W. End Conc Culv. On Kellogg 50' E. Of Fabrique
 Stationing & Base Line S.P.L.

Surveyed by BK
 Checked by Z

COURTLEIGH

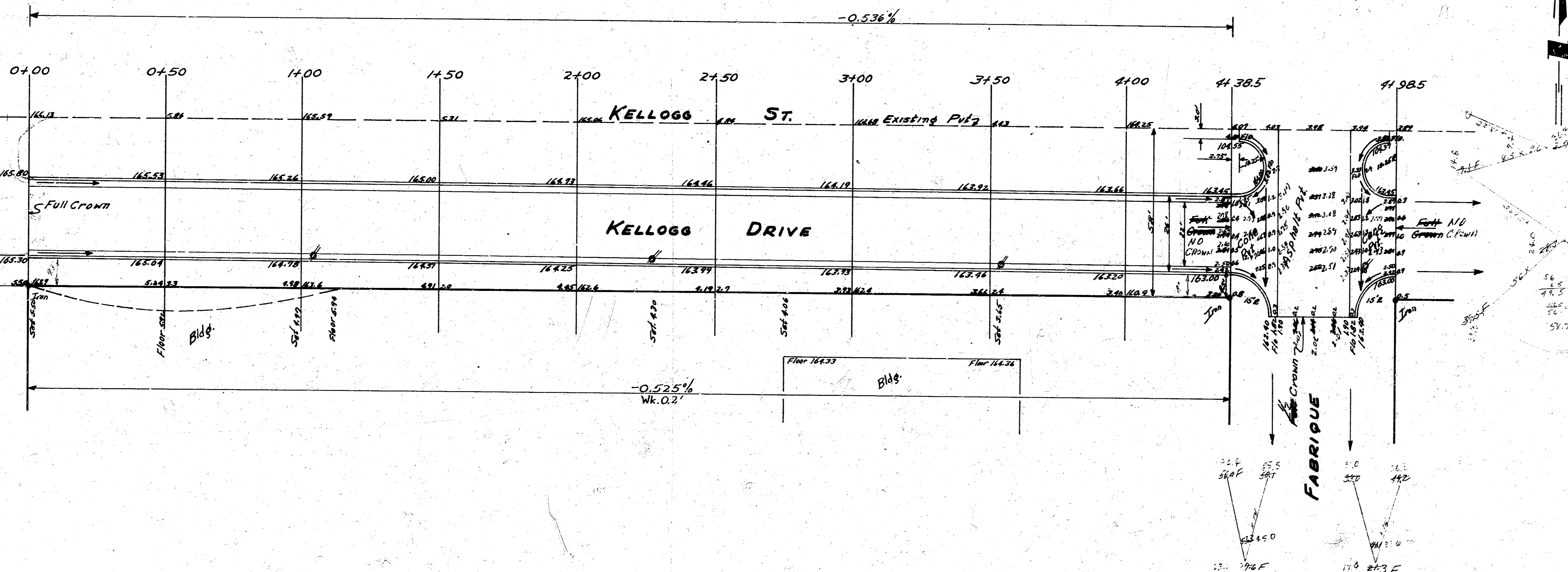

(1/2)

PROPERTY FILL 625.9
 11% 63.6
 688.500105 FILL

CITY FILL 103.5
 11% 10.4
 113.900105 FILL

22.5%
 Estimated on Courtleigh backup
 174.2



KELLOGG DRIVE South Side
 EL COURTLEIGH To EL FABRIQUE
 22-2-26-AC
 CITY OF WICHITA KAN
 BE SMITH CITY ENGINEER
 SEPT. 1955 Prot No C15-136