

D.M. BOTTOM R.R. SPIKE 6.6. K&E. POLE 250'E. EDGEMOOR & N.S. KELLOGG ELEV. 16724

NOTE TO FIELD ENGINEER

OBTAIN TIES TO IRONS ON S.E. COR EDGEMOOR & KELLOGG DR &
ON S.W. COR. CHRISTINE & KELLOGG DR. PRIOR TO CONSTR. &
RESET AFTER CONSTR.

NOTE

END CONC. AT STA. 2+29.75 & CONSTR. A
TEMP CONC. HOOKUP, BET. STA. 2+29.75 & STA. 2+44.2

NOTE
SAW OFF CURB ON EDGEMOOR
TO CONSTR. RETURN

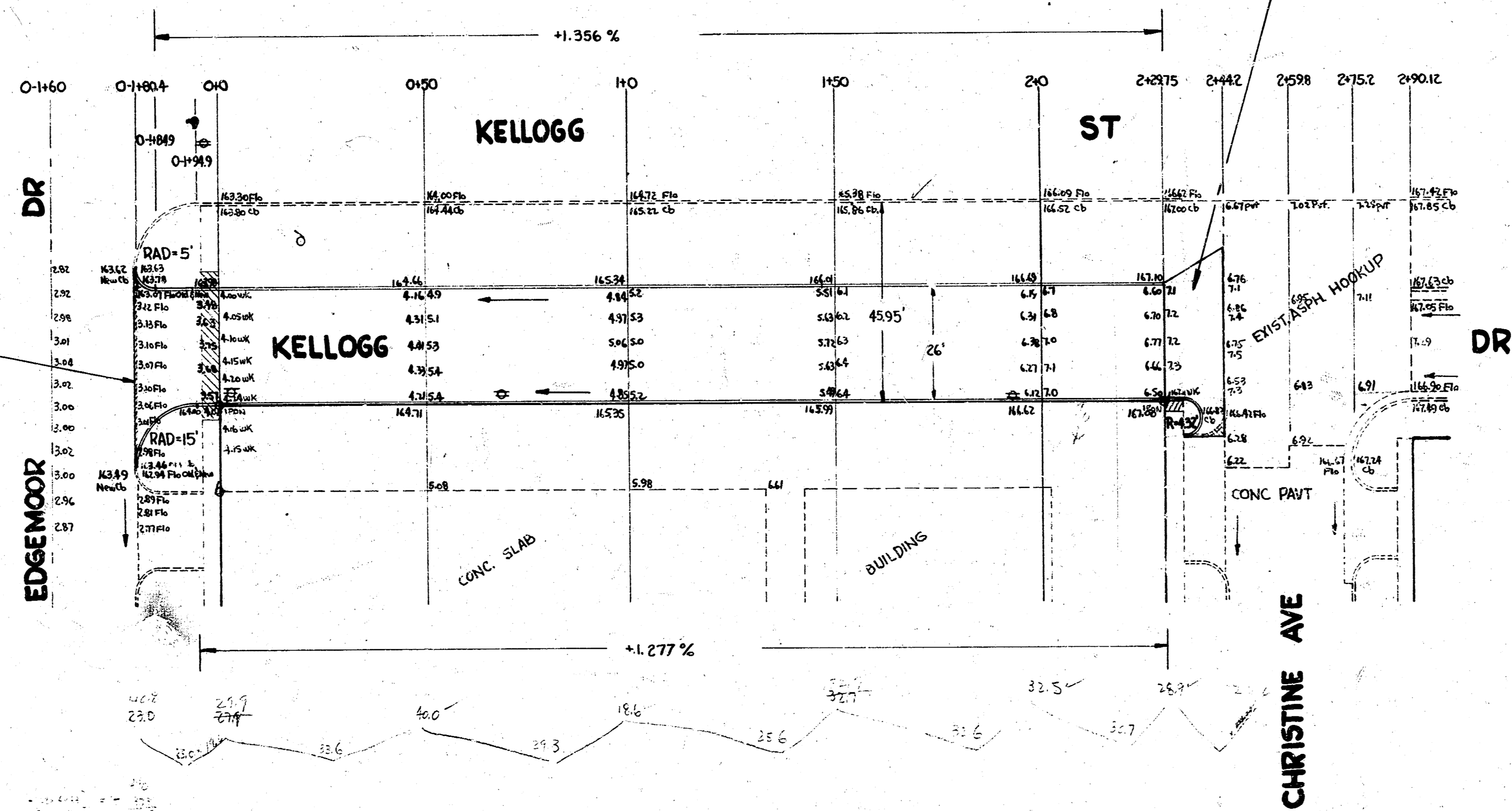

401.31
31' 40" 29' 34"
34 x 12 = 408

Prop
256.1
160
243 7/16

KELLOGG DR.
E. EDGEMOOR TO W. CHRISTINE
26' CONC. & CURB
CITY OF WICHITA, KANSAS
B.E. SMITH JULY 1955 CITY ENGINEER PROJ. NO. C15-160



N