

466 8" TREE 25' LT
 491 8" TREE 26' LT
 4085 END Wk R/LT Beg 2.5 Wk R/LT
 42025 Wk ALLEY
 430 M.H. 105 LT
 4385 P POLE 24 RT
 44025 ALLEY Beg 12' Wk R/LT
 44025 ALLEY Beg 12' Wk R/LT
 44025 ALLEY Beg 12' Wk R/LT
 44025 ALLEY Beg 12' Wk R/LT
 44025 ALLEY Beg 12' Wk R/LT
 452.8 END 12" CB Beg 2' R FOR DR
 468.2 END 2" R OR DR Beg 12" CB
 473 10" TREE 25' LT 18' FROM 24 RT
 492 8" TREE 25' LT
 431 8" TREE 24 RT
 443 E 3" AM Wk Mtn Front 11.7 10' LT
 474 10" TREE 24' LT
 48025 Beg Existing Wk Beg 18' LT 123 RT
 48150 Wk PATTIE

NOTE TIES TO ALLEY IRONS
 IRON AT STA 5+20.25 38.8 TO BK 4' Wk E. SIDE ALLEY SOUTH
 55.4 TO NW COR. HOUSE #1217 E ORME 10' TO COR. STEEL FC.
 E SIDE ALLEY NORTH
 IRON AT STA 5+40.25 36.7 TO COR FC. E. SIDE ALLEY NORTH
 35' TO BK 4' Wk E. SIDE ALLEY SOUTH
 15.2 TO N.W. COR. HOUSE #1217 E. ORME.

2/4
 ORME
 Proj No. C13-267

B.M. 107.44 IRON IN THIMBLE &
ORME & IDA
CHAINING ON &

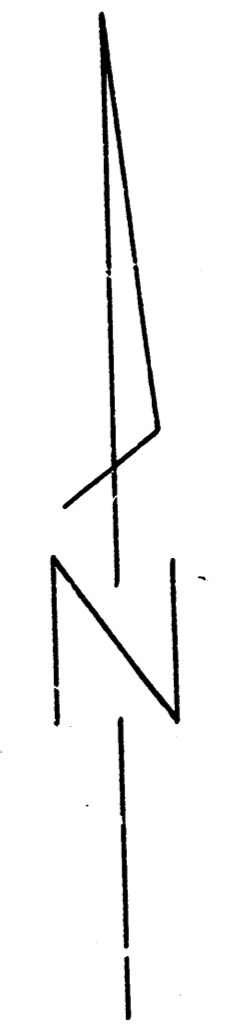
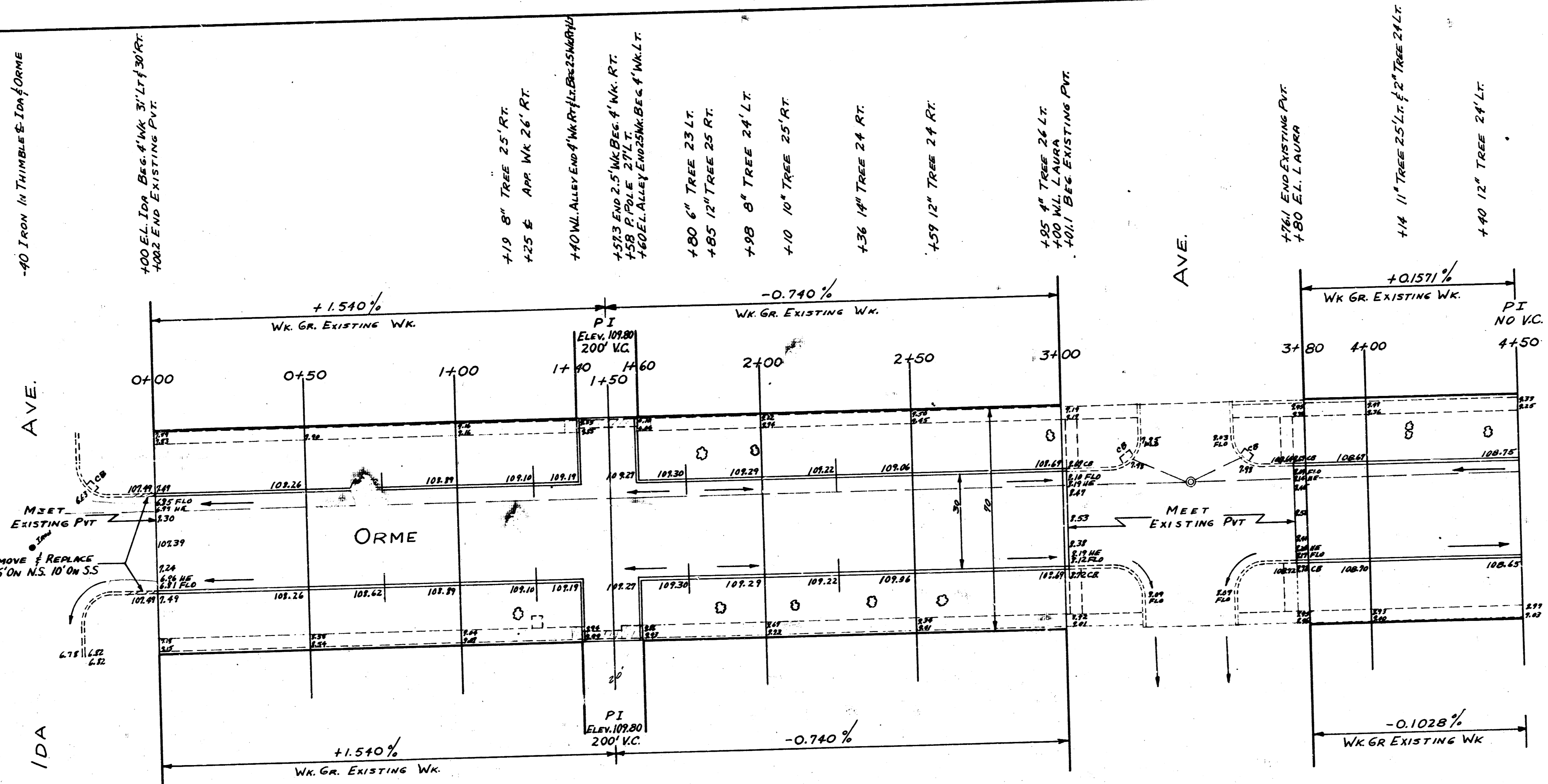

Survey
Plan
Date
Discussed

1/4



ORME
EL. IDA TO WL. PATTIE
30' CONC. CB.
CITY OF WICHITA KAN.
B.E. SMITH CITY ENGINEER
APRIL 1954 Proj. No. C13-267