

B. M. 109.35 NE Cor. lower Conc. Step East Ent. to Skelly Oil Company Bldg. 1/2 Blk. West of Washington.
 Stationing on 1/2 Trm. West to East.

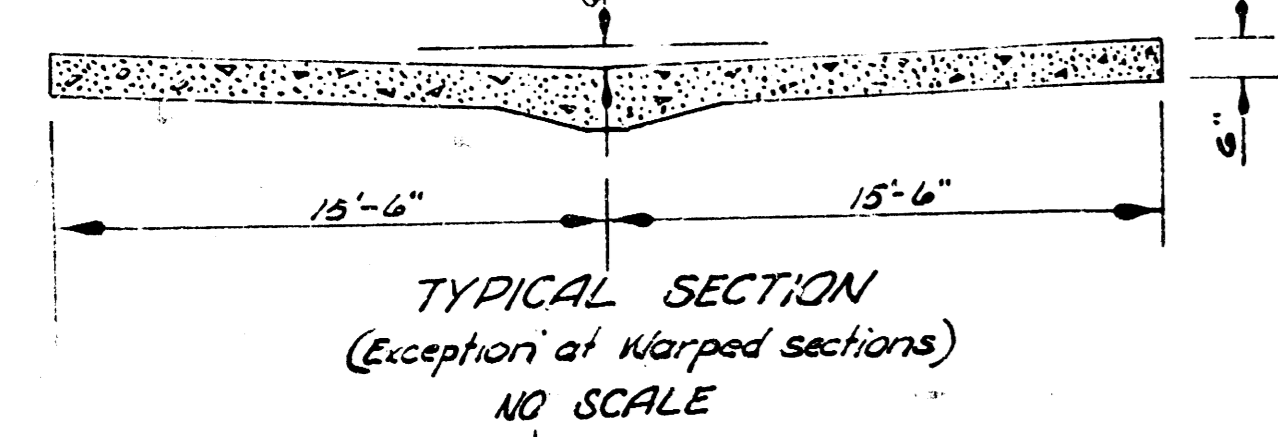

NOTE:
 Construct Header at
 Sta. 3+04.0 and Sta 3+02.3

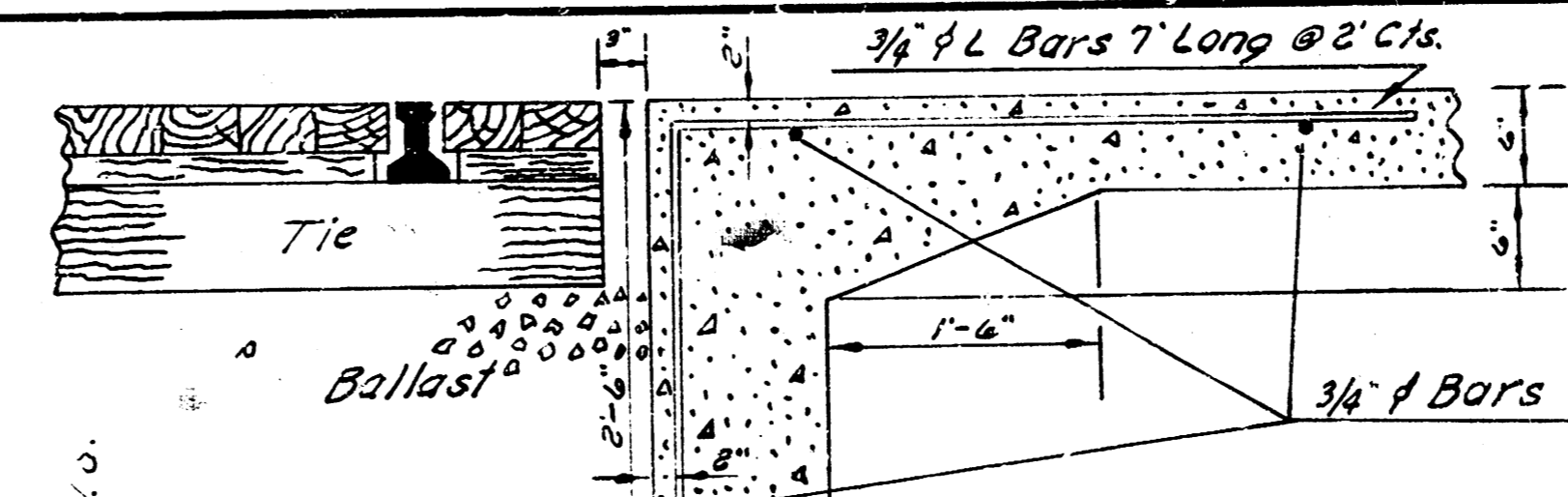

SCALE 1"=20'

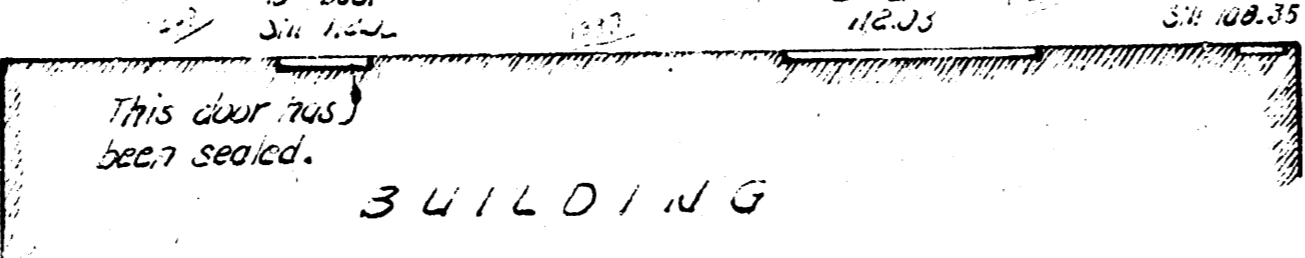
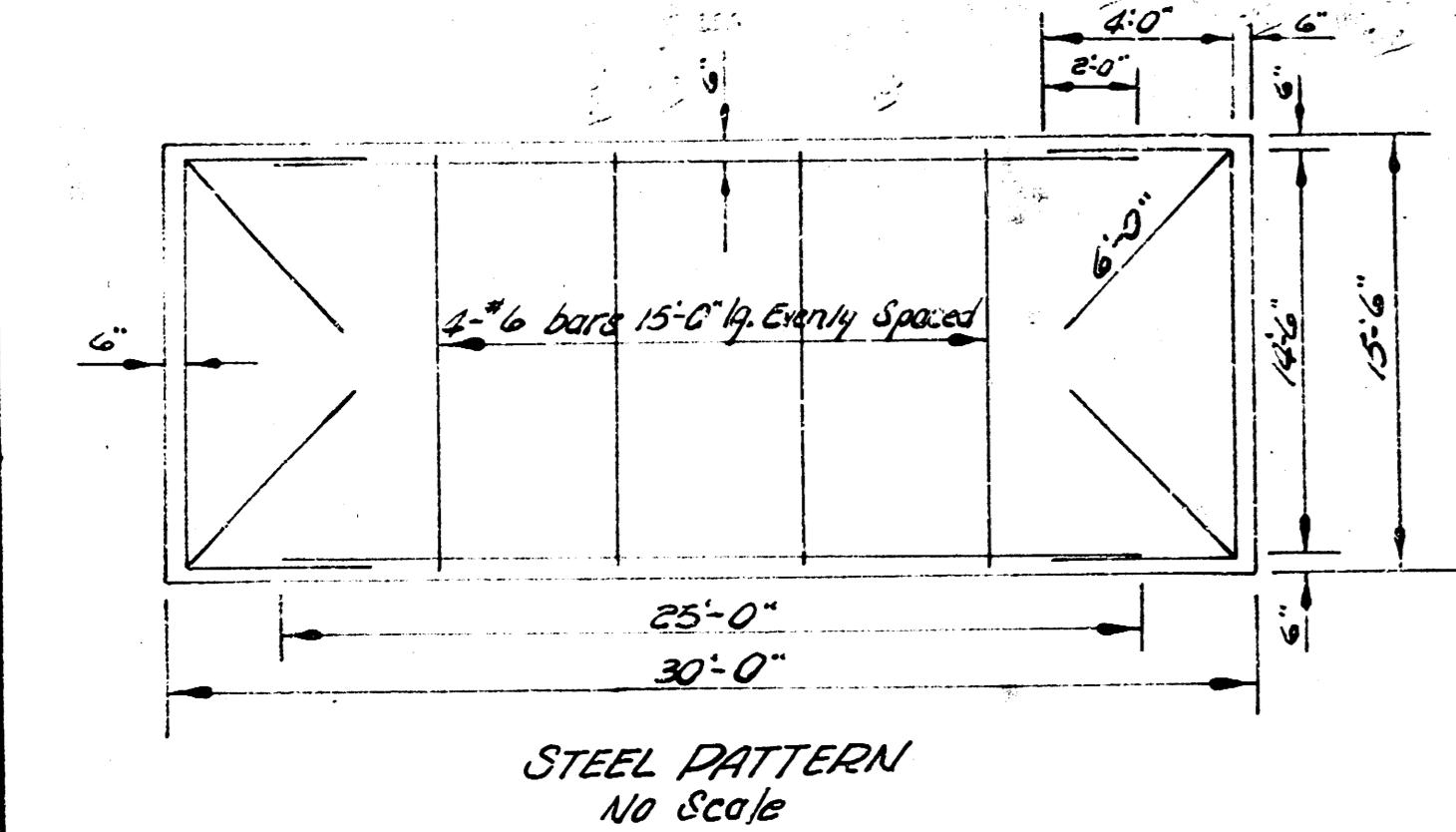
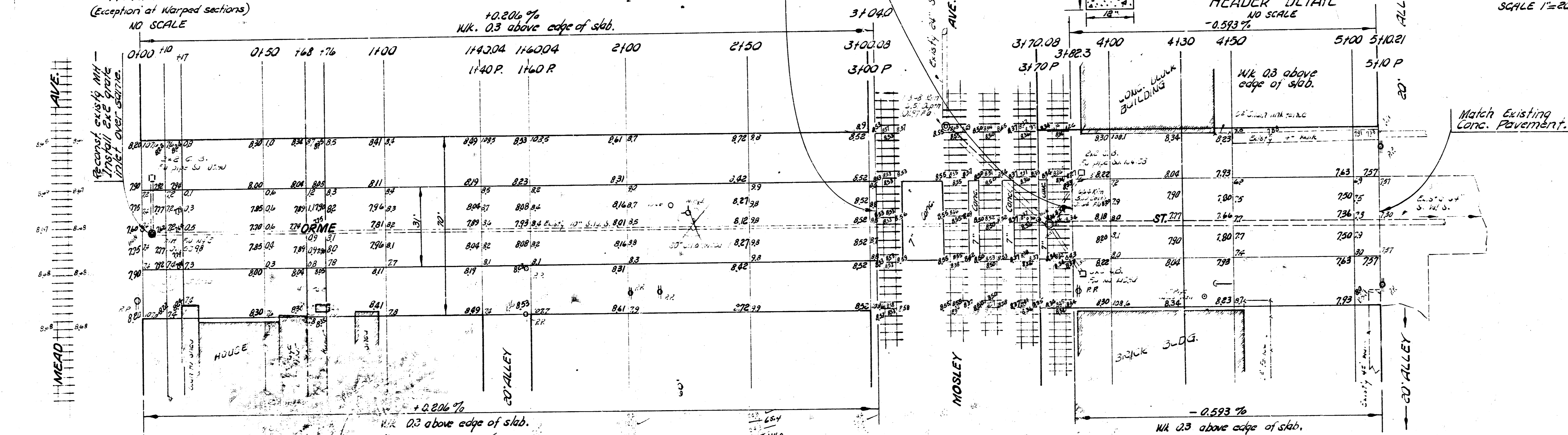

NOTE:
 Construct 7" Conc.
 Pavement between
 R. R. Tracks.

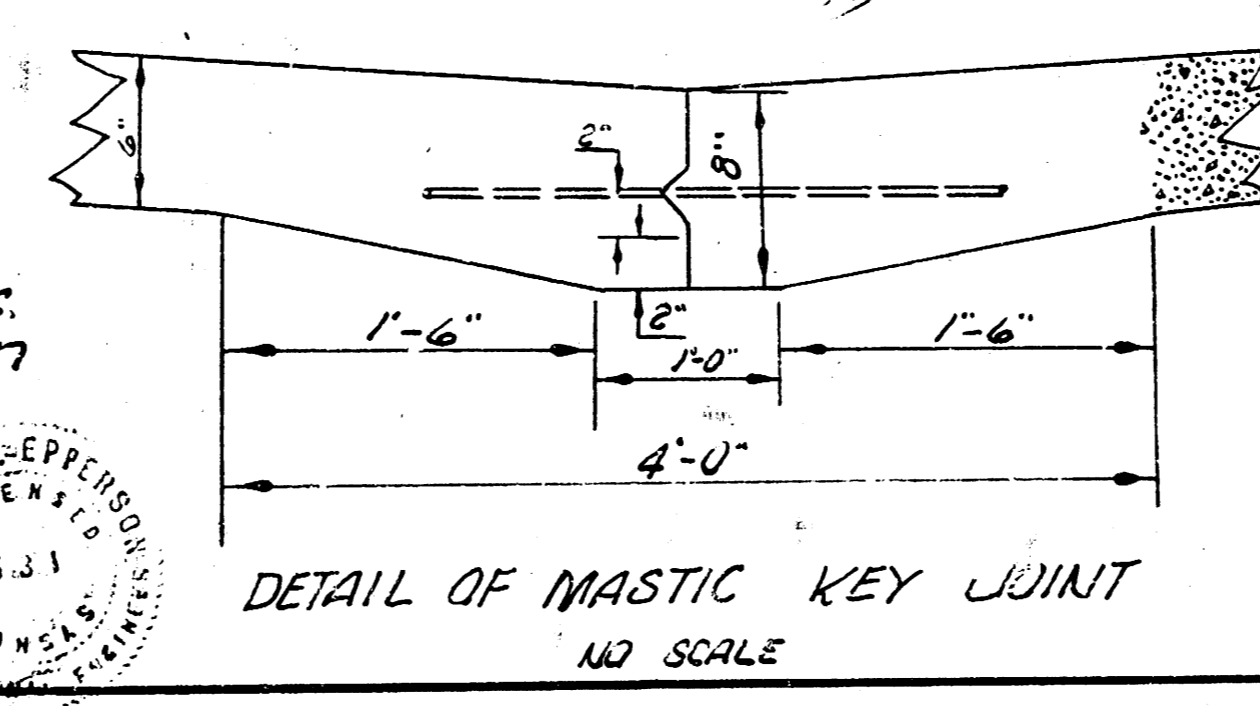

ORME ST.
 EL MEAD TO WL ALLEY W. OF WASHINGTON
31' CONCRETE
 6" THICK
 CITY OF WICHITA, KANSAS
 B. E. SMITH CITY ENGINEER
 DEC. 1957 PROJ. NO. C17-116

