

BM 153.11 6" IN GLOBE 3. CB. ON ORME
 BM 157.00 7" IN RICHIE W. END CO. RETURN NS ORME WL. BEVERLY
 BM 126.00 7" IN RICHIE W. CA. BEVERLY & S.L. KELLOGG

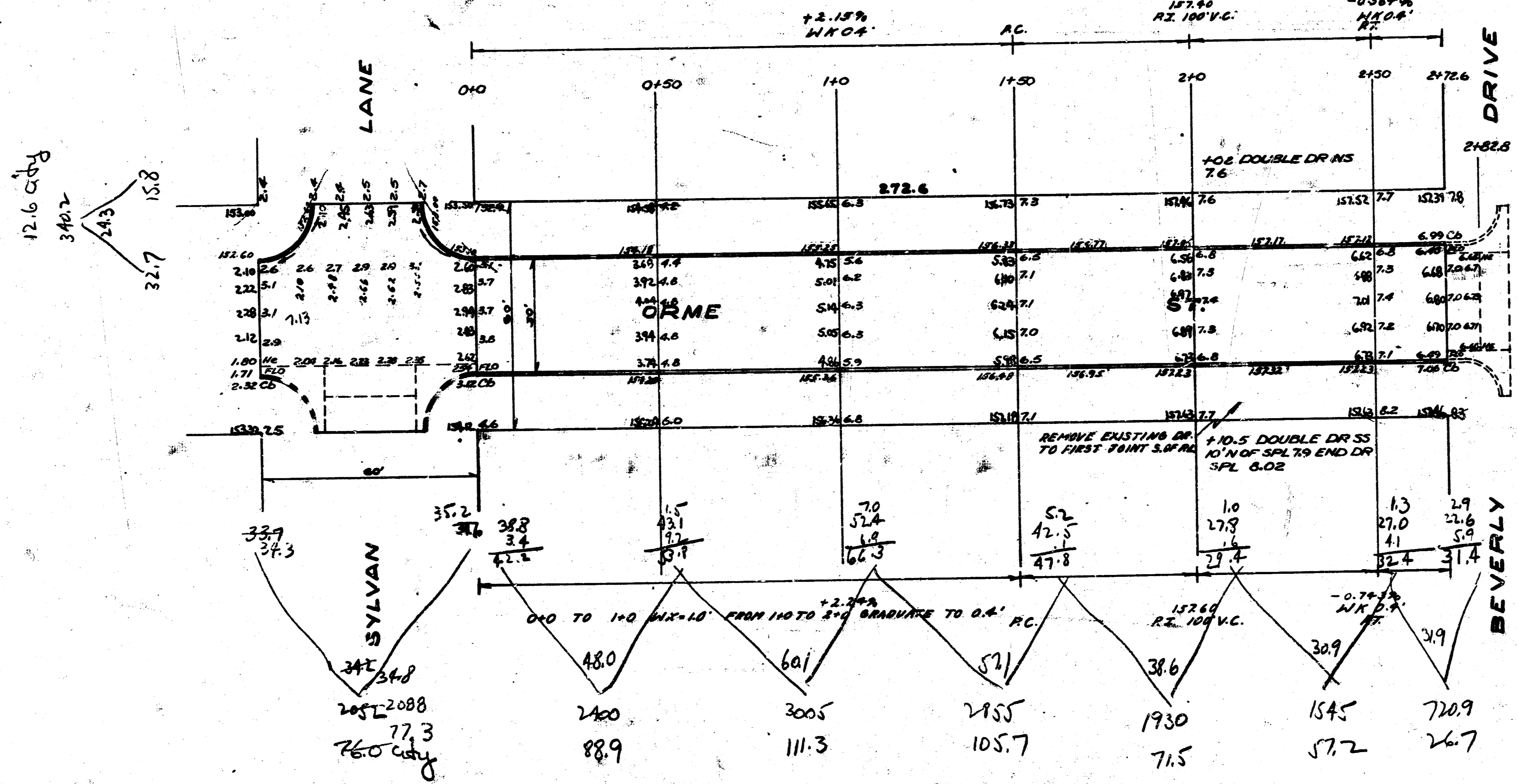
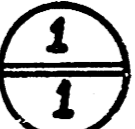

Prop Elevation	City Elevation
88.9	76.0
111.3	12.6
105.7	88.6
71.5	+10%
57.2	
26.7	
461.3	97.5 ctyds
+10%	
507.4 ctyds	

ORME ST.
 WL. SYLVAN WL. BEVERLY
30" CONC. f. CB.
CITY OF WICHITA, KANSAS
L.K. WHITE CITY ENGINEER
JULY 1947

41145