

B.M. 10167 S.E. Cor. Conc. Pa. Ho. On NW. Cor. Osage & 29th So.

NOTE TO CONTRACTOR & FIELD ENG:
 Paving will be excavated to 11 1/2 ft.
 as shown on Plans. Set Drive Grooves
 at R as shown. All Backfill behind
 East Curb will be Mechanically Tamped to
 Bottom of Walk. (No Poly Item)
 Sidewalk to be constructed both sides Sep. Contract.

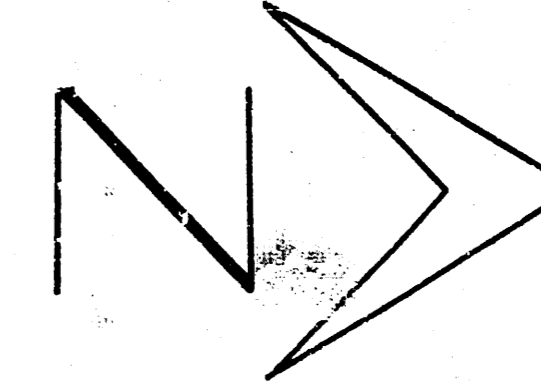

Scale 1" = 20'

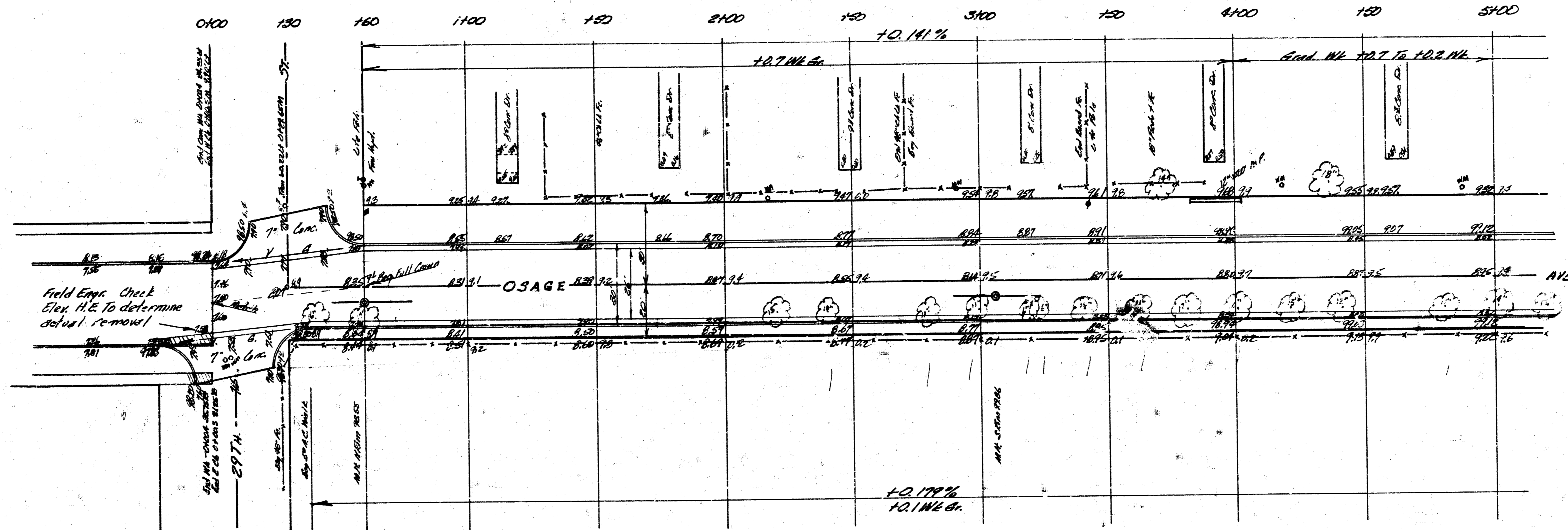

| Excavation Prop. | City |
|------------------|---------------|
| 2082 CY | 2116 CY |
| 2082 + 10% | 2121 + 10% |
| 2290.2 CY Total | 2328 CY Total |

OSAGE AVE.
 SL 29th So. To SL 27th So.

26' - 2' - 30" A.C.

CITY OF WICHITA, KANSAS
 B.E. SMITH CITY ENGINEER
 DATE JULY 1965 PROJ. C-15-71

Surveyed by
 Checked by
 Date

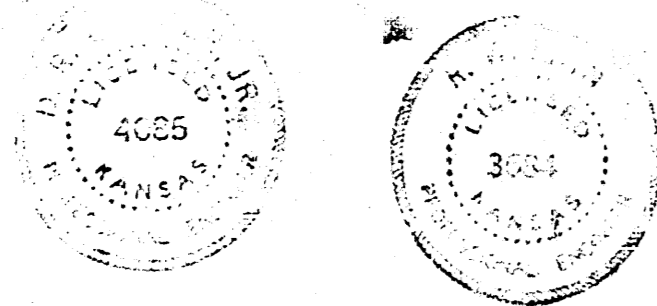

1/6

B.M. 99.13 R.R. Sp. E. side R.R. S.W. Cor. Barbara & Osage

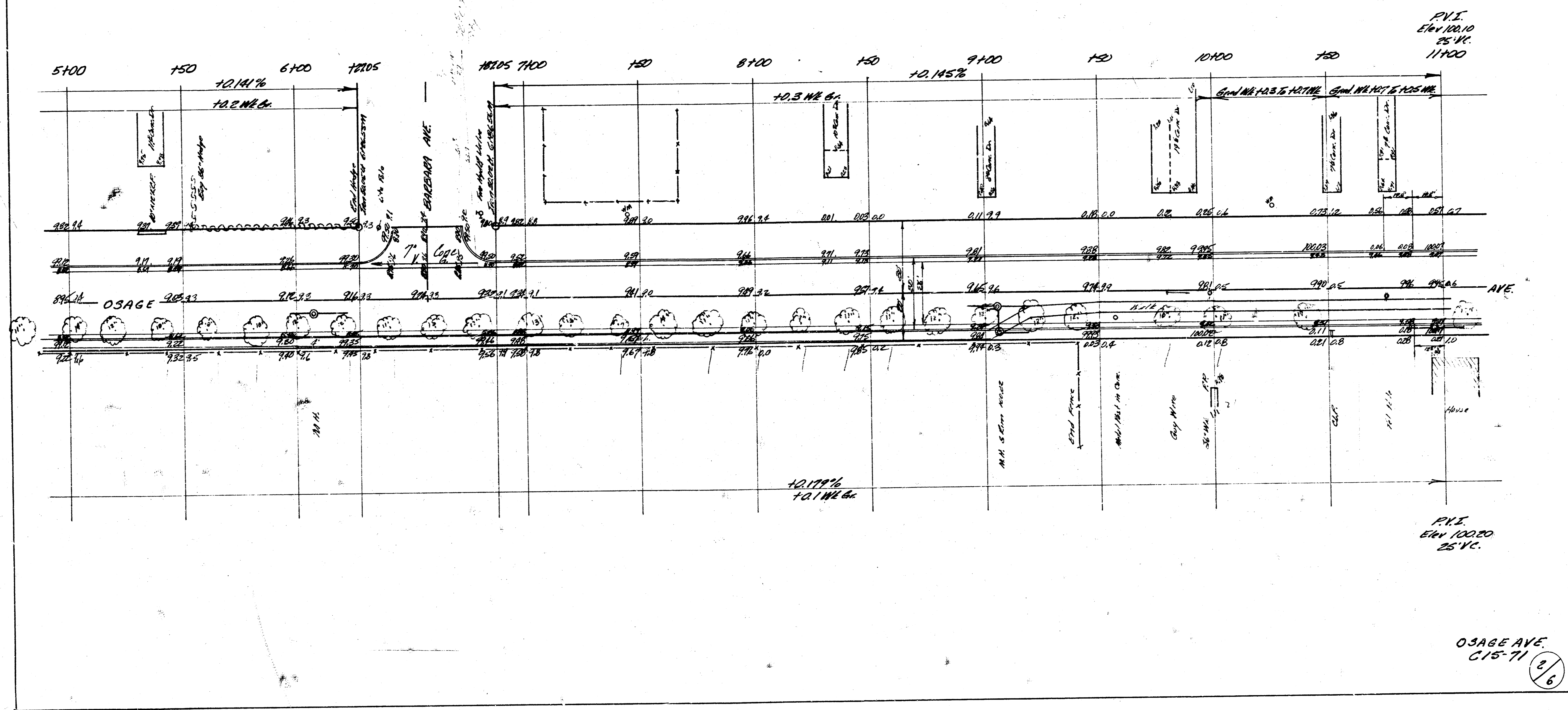

OSAGE AVE.
C15-71
2/6

BM 98.57 R.R. Spt. W. side P.P. S.E. cor. 27th & Osage

