

B.M. 100.425 "M" IN MUELLER FIRE PLUG NW. COR OSAGE & MAXWELL  
 B.M. 101.17 SW. COR PORCH HO<sup>m</sup> 2510 S. OSAGE  
 BASE LINE ON E. PROP. LINE

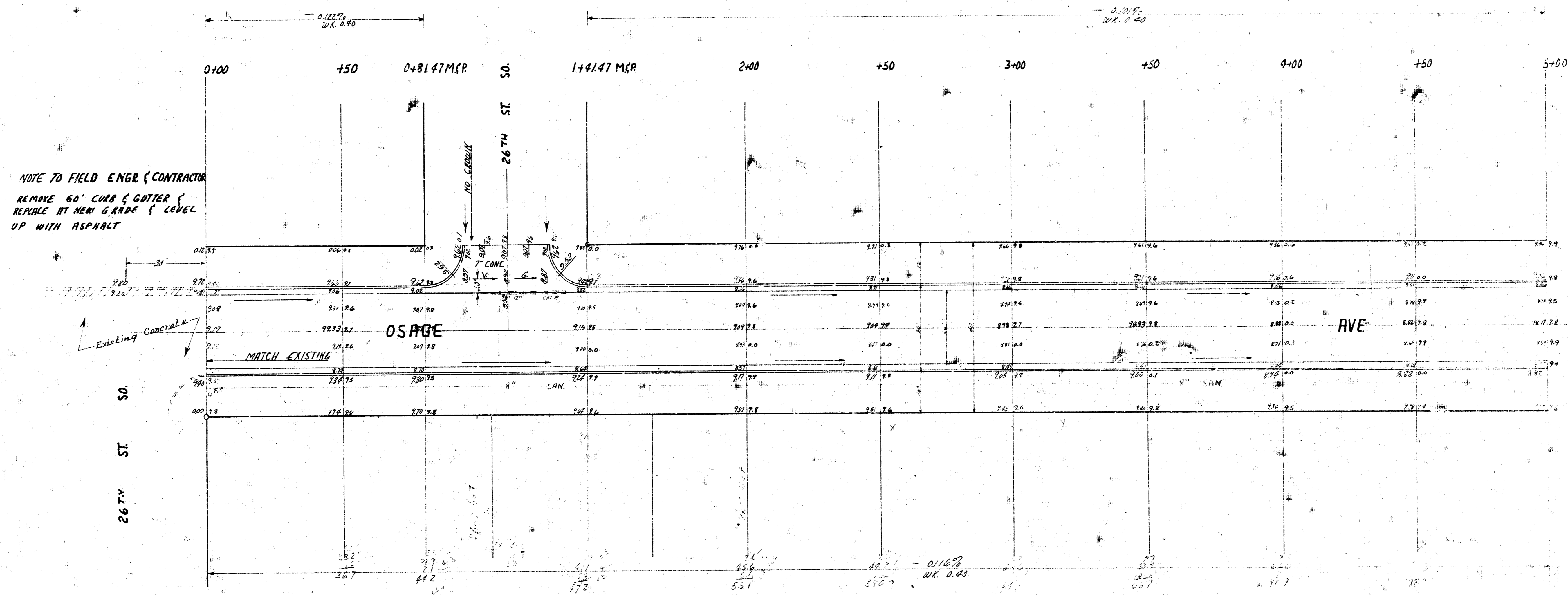
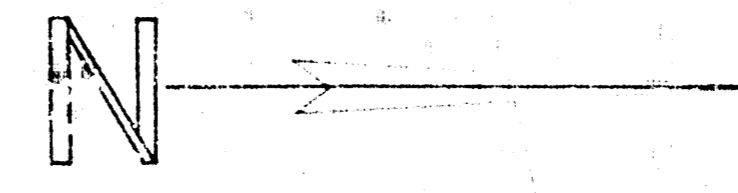

NOTE TO FIELD ENGR & CONTRACTOR  
 REMOVE 60' CURB & GUTTER &  
 REPAIR AT NEW GRADE & LEVEL  
 UP WITH ASPHALT

26<sup>TH</sup> ST

OSAGE

AVE

NOTICE TO CONTRACTOR:  
 ALL ENTRANCE PIPES ARE TO BE DISPOSED OF IN  
 ACCORDANCE WITH INSTRUCTIONS OF CITY DIRT CHECKER

OSAGE AVE  
 NL 26<sup>TH</sup> ST SAVANNAH  
 26-2-30 AC  
 CITY OF WICHITA KANS  
 BE SMITH CITY ENGINEER  
 DATE 1/27/20 PROJ NO. 0176

(1/2)

