

B.M. "Y" ON WEND NO. HUBGUARD LINCOLN ST. BRIDGE OVER ARK. RIVER ELEV. 108.30
 B.M. "G" IN GLOBE BK. OF WK. NO. E.L. OSAGE & N.L. LINCOLN ELEV. 106.27

TIES TO MON. E. OSAGE & E. IRVING W.
 40.15' E.S.E. TO 1ST STEEL POST SO. OF E. IRVING
 40.32' E.N.E. TO 1ST STEEL POST NO. OF E. IRVING
 34.45' S.W. TO FACE OF K.G.E. POLE
 99.49' N.W. TO S.W. COR. HD.

Survey
 Plan
 Checked

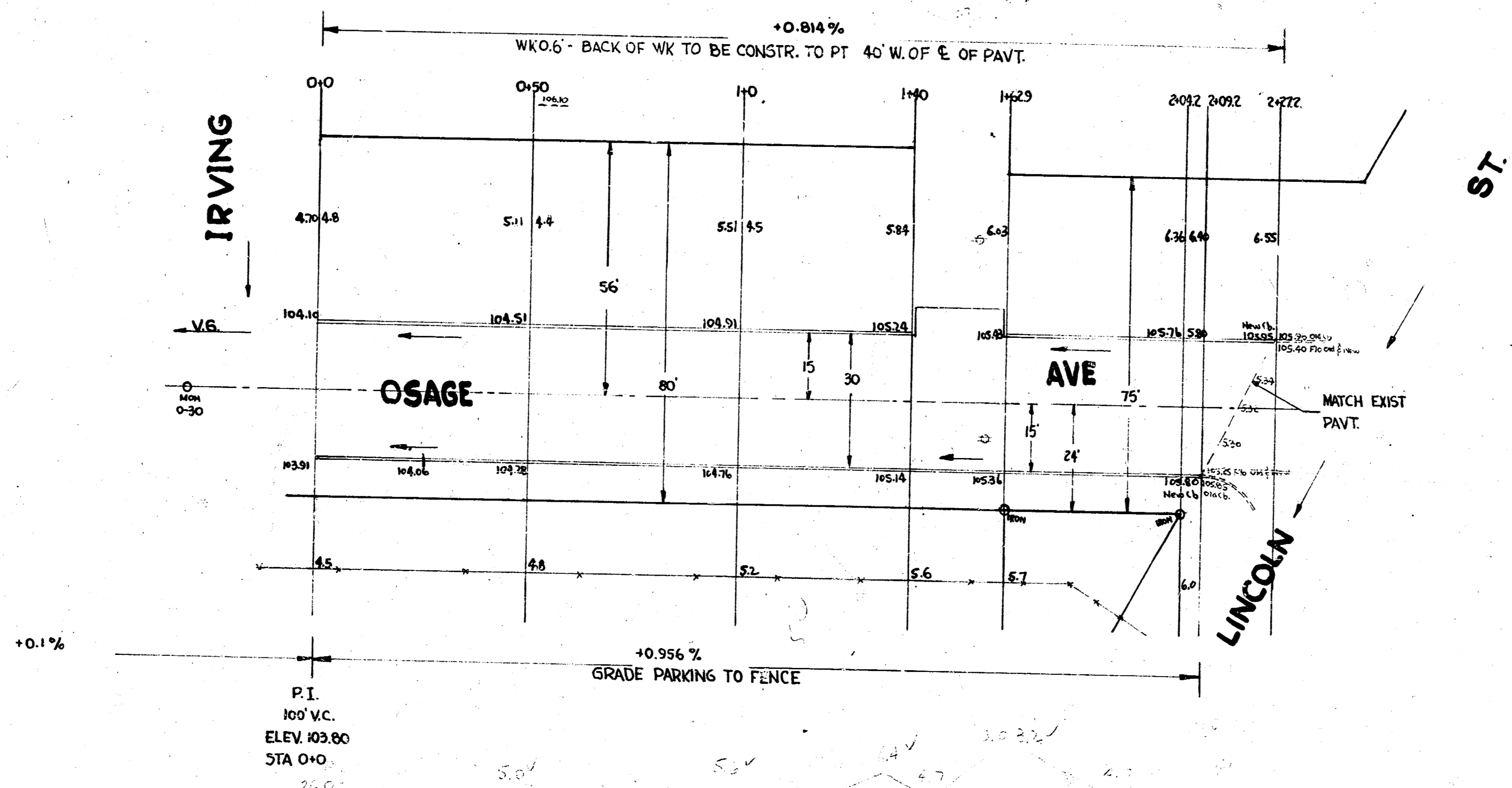

1/2



OSAGE AVE
 N.L. IRVING TO S.L. LINCOLN
30' CONC. & CURB
CITY OF WICHITA, KANSAS
 B.E. SMITH CITY ENGINEER
 JULY-1955 PROJ. NO. C15 '59