

B.M. 142.84 NW cor. porch, House # 1788 - 3 Clinton  
Stationing on N.R.

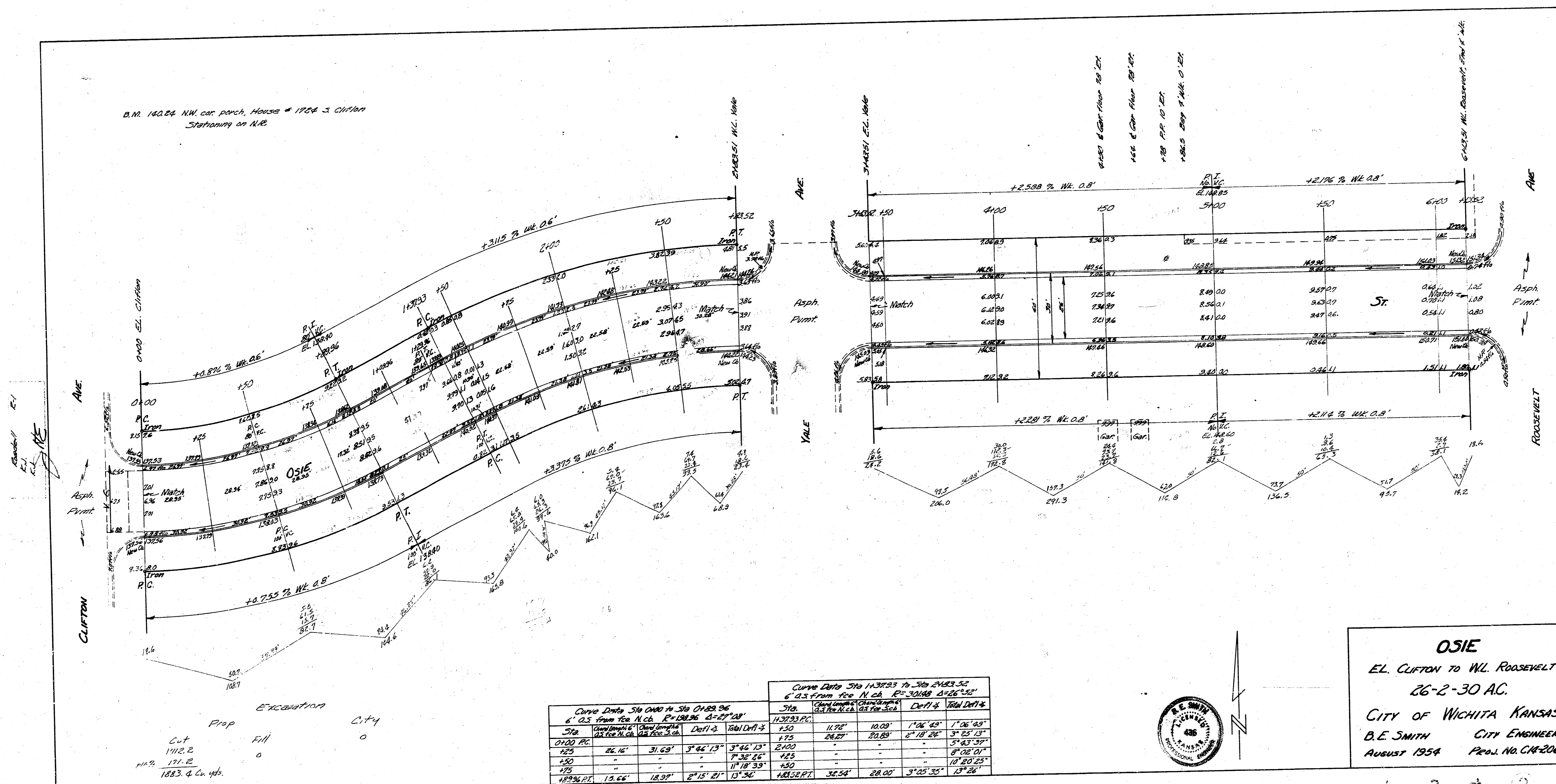

Excavation  
Prop. 0  
Fill 0  
Cut 1112.2  
171.2  
1883.4 Cu. Yds.

Curve Data Sta 0+00 to Sta 0+129.96 6' D.S. from Top N.C. R=198.96 Δ=27°28'		Curve Data Sta 1+378.33 to Sta 1+423.52 6' D.S. from Top N.C. R=301.68 Δ=26°35'					
Sta.	Chord Length 100' from N.C.	Defl. ∠	Tan Dist ∠	Sta.	Chord Length 100' from N.C.	Defl. ∠	Tan Dist ∠
0+00 P.C.	26.16'	31.63'	3°46'13"	1+378.33 P.C.	11.72'	10.09'	1°06'45"
1+25	-	-	-	1+50	26.87'	22.89'	6°18'26"
1+50	-	-	-	2+00	-	-	-
1+75	-	-	-	1+25	-	-	-
1+25	-	-	-	1+50	-	-	-
1+50 P.T.	13.66'	18.97'	2°15'21"	1+30	18.52 P.T.	32.54'	28.00'
							3°25'35"
							13°26'



**OSIE**  
EL. CLIFTON TO WIL. ROOSEVELT  
26-2-30 AC.  
CITY OF WICHITA KANSAS  
B.E. SMITH CITY ENGINEER  
AUGUST 1954 PROJ. NO. CH-206