

S.M. 17097 "R" in Ritchie Top W. Co. Post Oak Rd @ N. Export Cr.

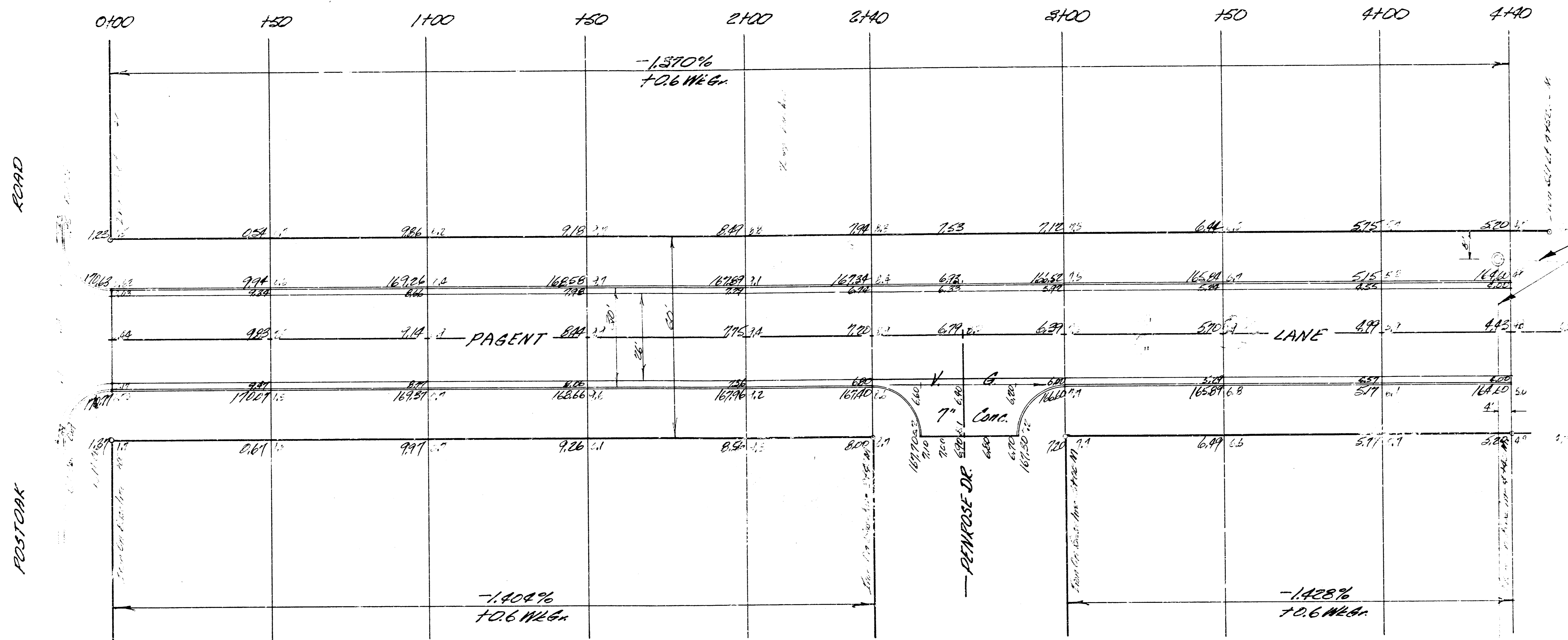
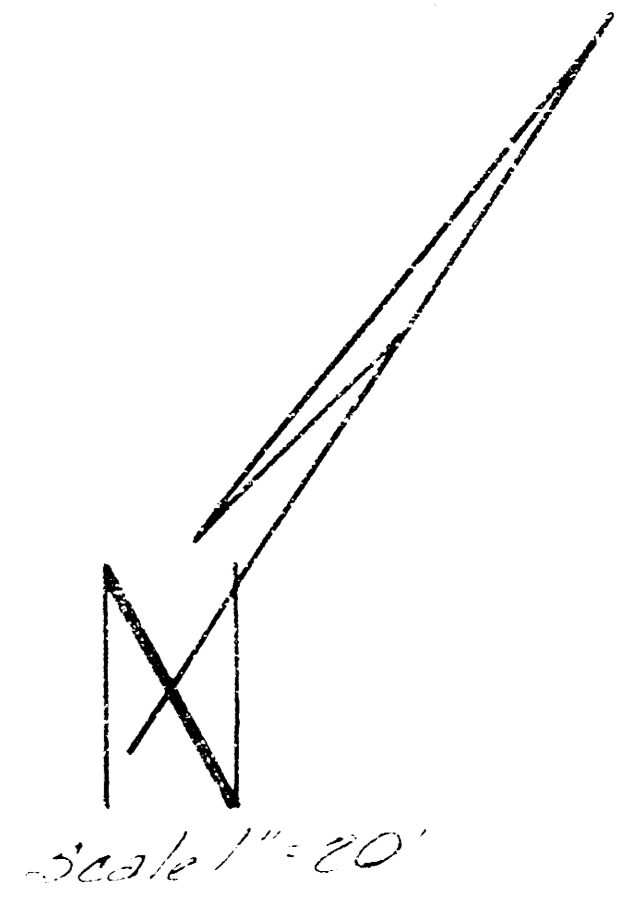

Excavation	
Prop.	City
1237.0 CY	144.501
122.7 f/c	14.5 f/c
1359.7 CY Total	159.0 f/c

PAGENT LANE
 EL. POST OAK ROAD TO EL. 1011
 BLK. 2, ROCKWOOD 5TH ADDN
 26'-2"-30' AC.
 CITY OF WICHITA, KANSAS
 B.E. SMITH CITY ENGINEER
 DATE MAY 1966 PROJ. C15-66

1/2

165
4140

165
4160

165
5150

165
5160 EL. REMOVE

165
2182

165
2195

165
2170 @

165
2185

165
2155

165
2140 HI. REMOVE

170
2100

170
1150

170
1100

170
0150

First Box
0100

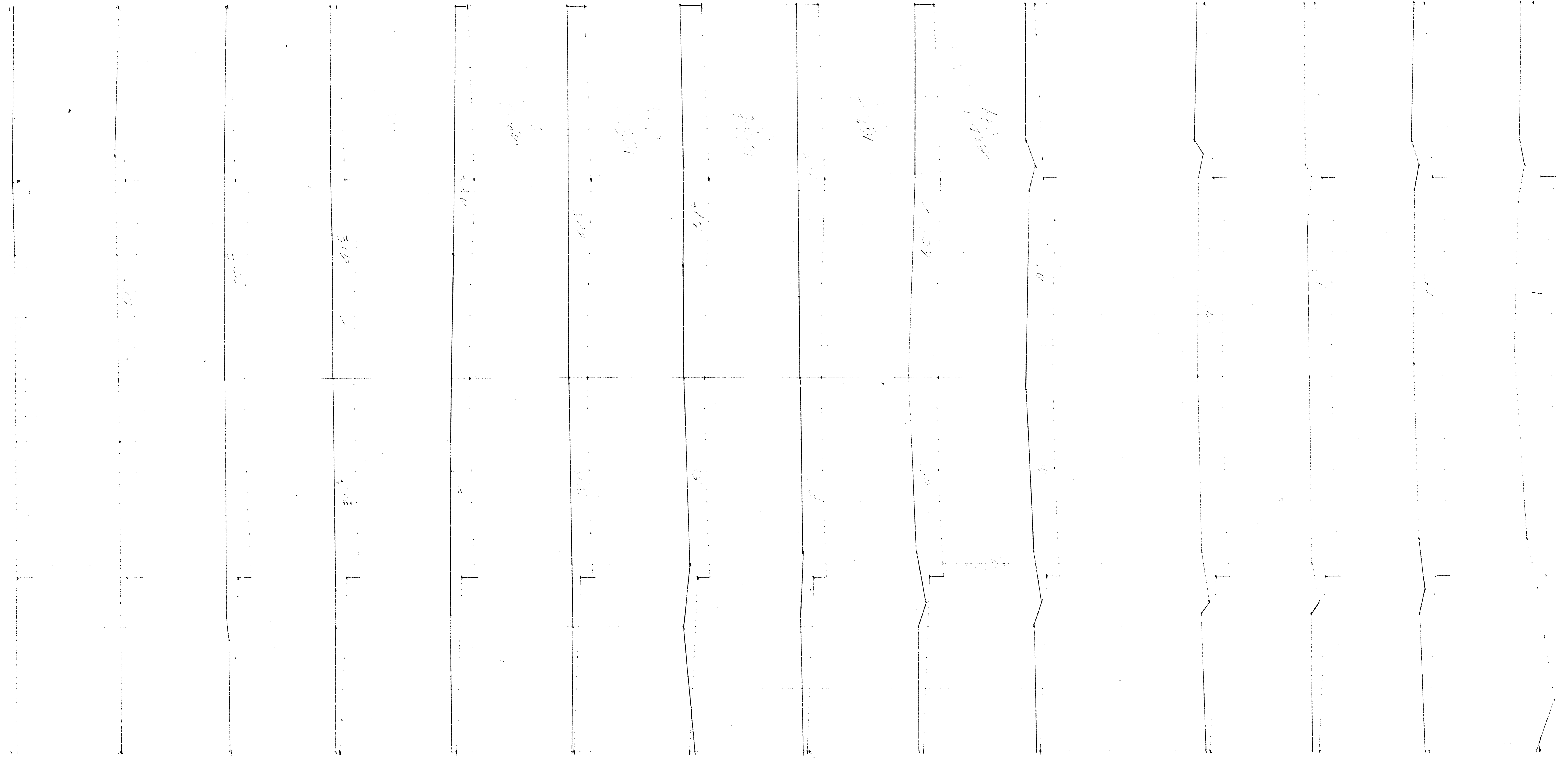

60 50 40 30 20 10 0

Base line = 3 1/2

PAGENT LANE
EL. FRONT RD TO EL.
LOT 1512 E. KENTWOOD ST
11/15/08