

**STREET IMPROVEMENTS FOR**

**PATTIE**

**S. L. OAT (NOW KEMPER) TO S. L. MACARTHUR**

**PROJECT NO.  
472-76-245-30668-000-000-001**

- INDEX
- 1 Title and Benefit District
  - 2 Typical Section
  - 3-4 Street Improvement Plans
  - 5-6 Earthwork Sections

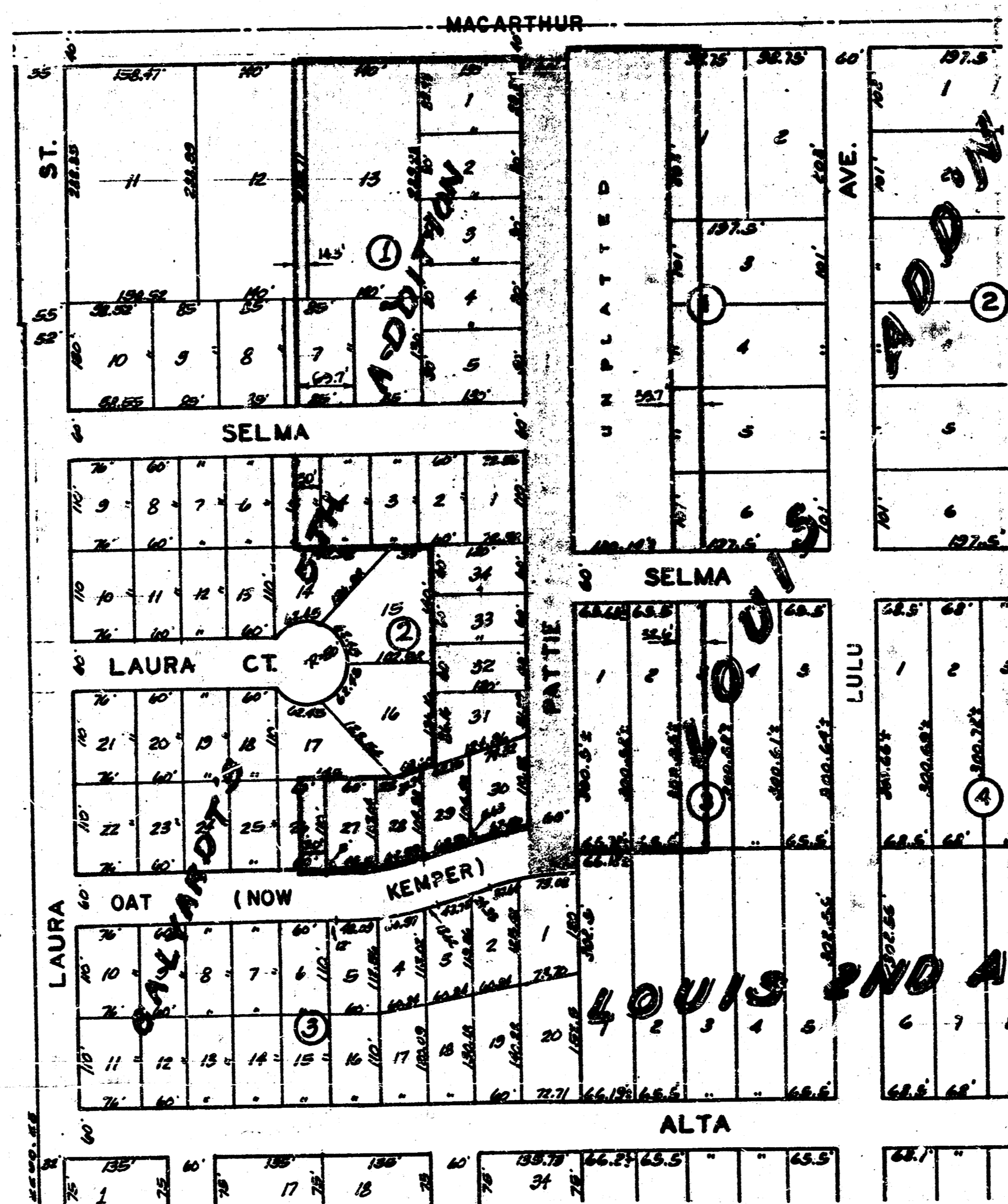
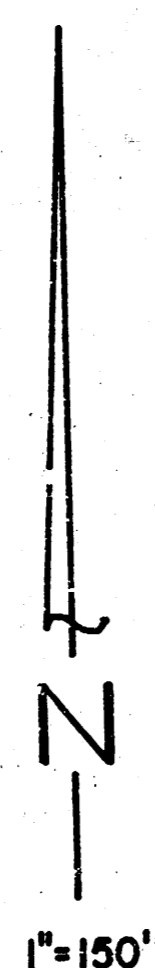

— BENEFIT DISTRICT —

**CITY OF WICHITA, KANSAS**  
**MICHAEL E. LINDEBAK**  
**CITY ENGINEER**

GENERAL NOTES

The Contractor shall be responsible for preserving property irons. The Contractor shall be required to re-establish any property irons which are destroyed or damaged by his construction operations. Such irons shall be re-established by a licensed land surveyor or a licensed professional engineer in accordance with state laws.

The Contractor shall contact the utility companies for location of underground lines prior to any excavation:

Kansas One Call 1-800-344-7233  
Bell Telephone 571-2115  
Continental Pipeline 1-800-231-2551  
Northwest Cent. Pipeline 1-918-588-4200

Contractor shall remove mailboxes, re-establish them in a location acceptable for service during the construction period, and replace in the proper locations as per codes after construction is completed.

Curb on this project is to be (monolithic) roll-type except where noted otherwise on the plans. Curb shall be depressed to 1 1/2" across driveways.

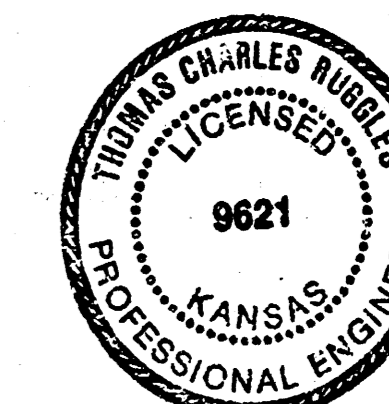

**NO MORE THAN 4 - 16' DRIVES OR EQUIVALENT  
TO BE CONSTRUCTED ON THIS PROJECT.**

**BAUGHMAN COMPANY, P.A.**  
SURVEYING & ENGINEERING  
316/262-7271 • 330 LAURA • WICHITA, KANSAS 67211

# TYPICAL 31' PAYEMENT DETAILS

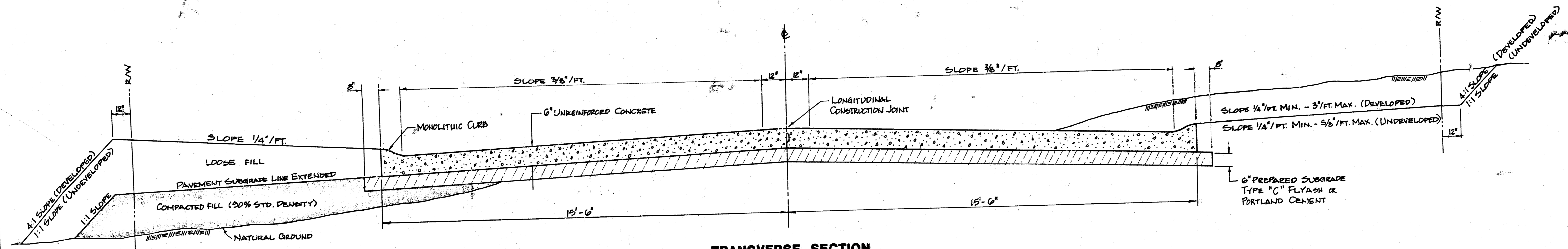

TRANSVERSE SECTION

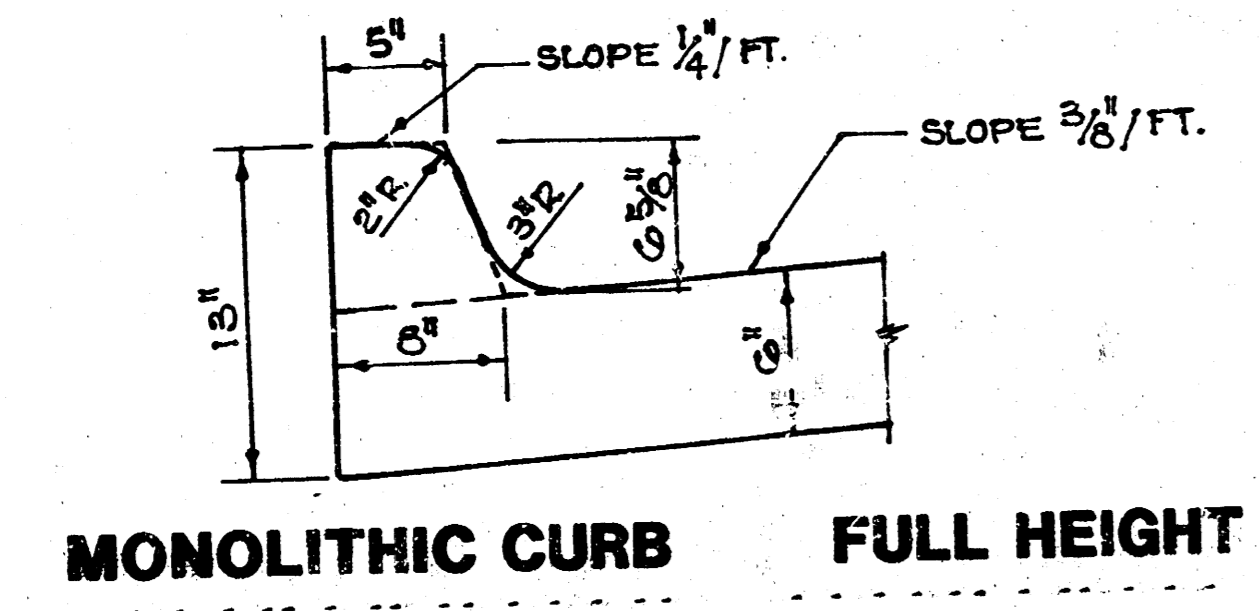

MONOLITHIC CURB FULL HEIGHT

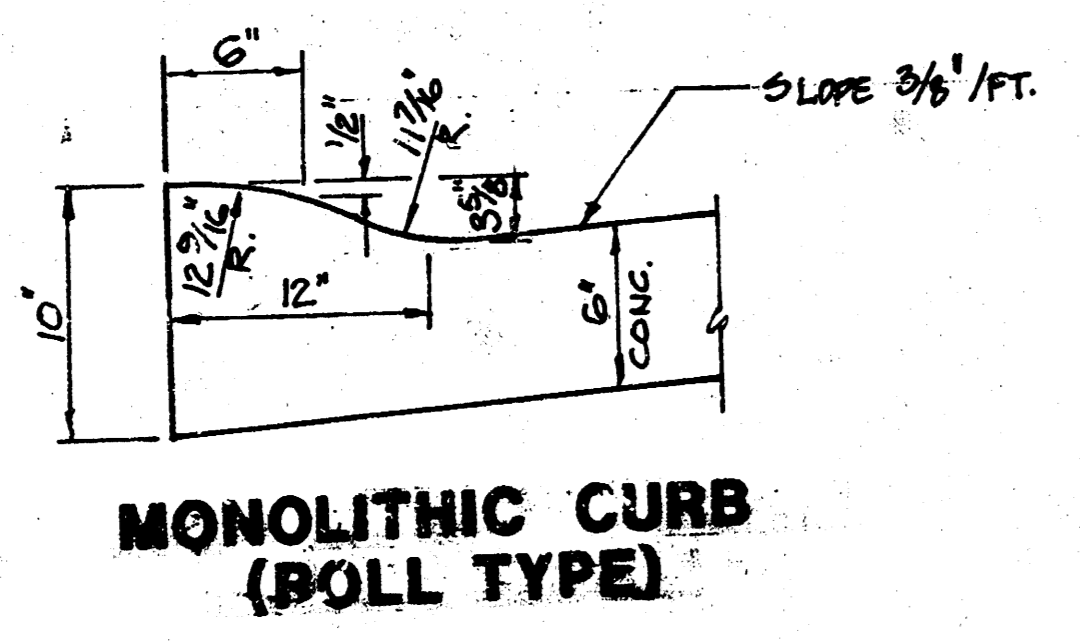

MONOLITHIC CURB (ROLL TYPE)

NOTE: TRANSITION FROM FULL HEIGHT CURB (6 5/8" TO MONOLITHIC EDGE CURB (3 3/8" ROLL) IS TO BE PAID AS BID FOR L.F. MONOLITHIC EDGE CURB (3 3/8" ROLL @ 1 1/2").

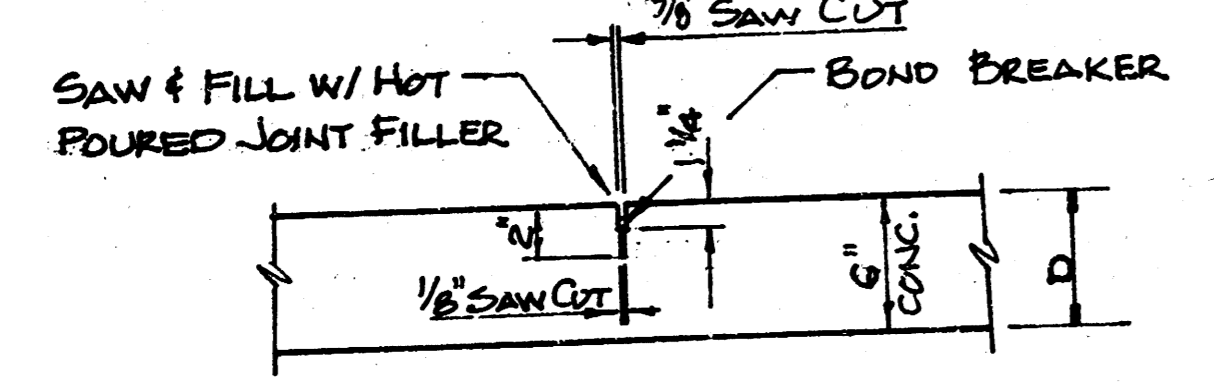

CONTRACTION JOINT

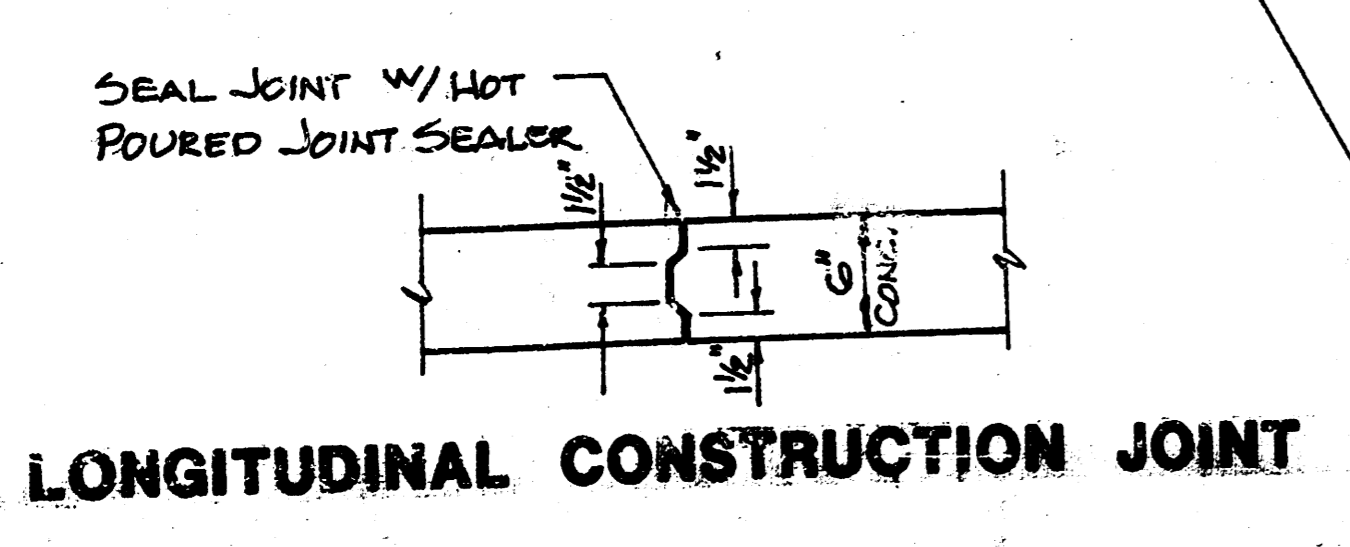

LONGITUDINAL CONSTRUCTION JOINT

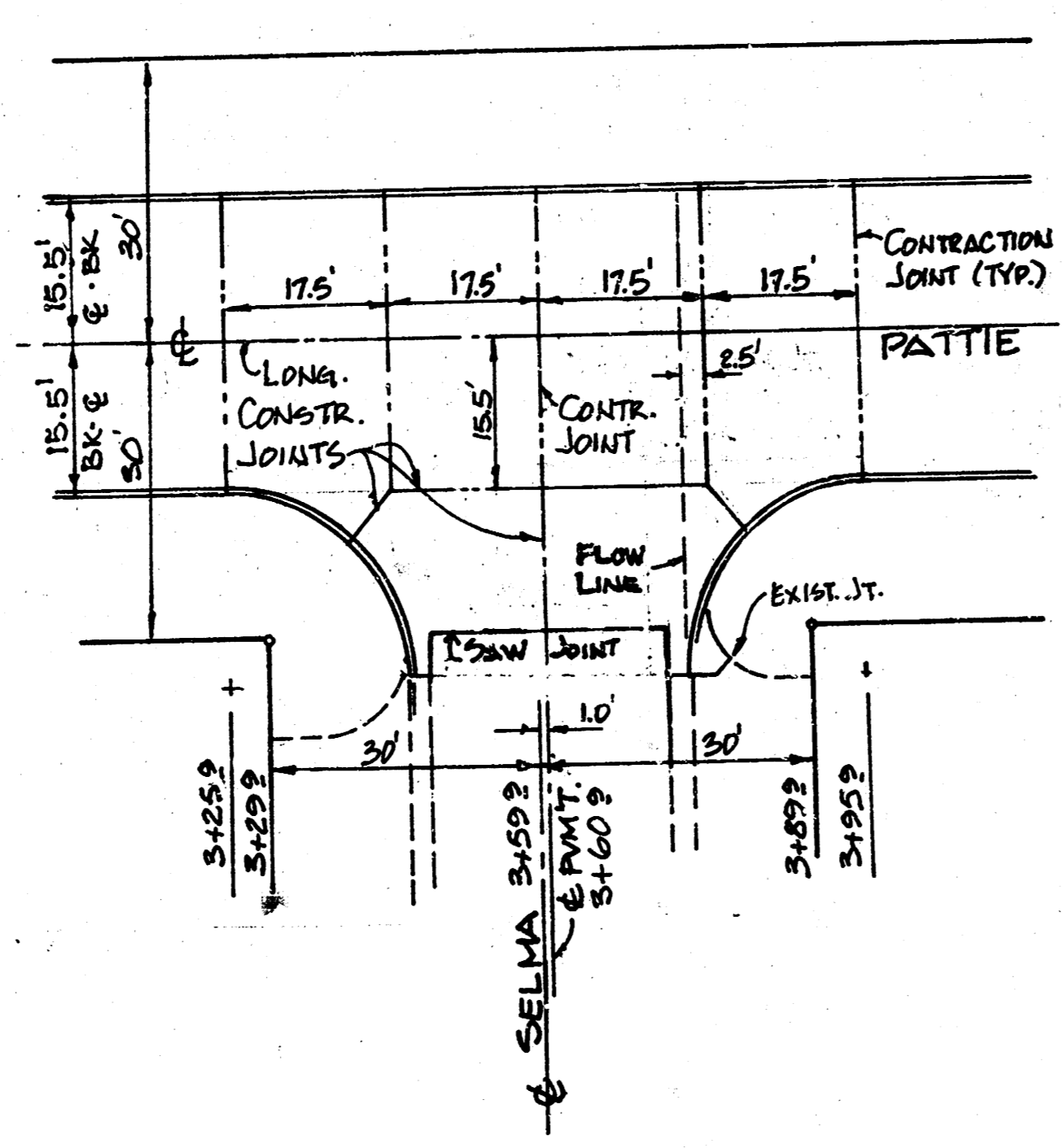

JOINT PLAN

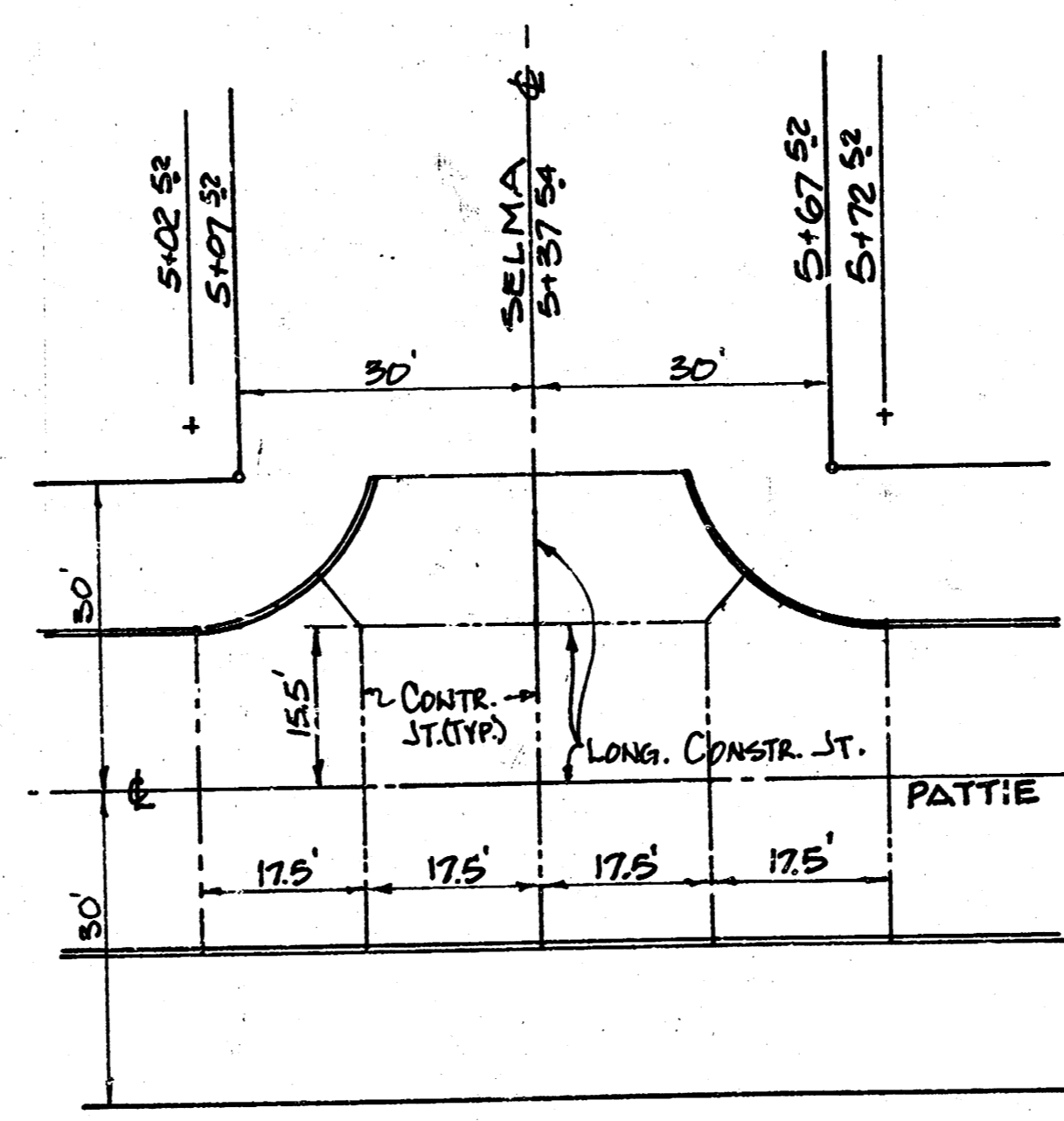

JOINT PLAN

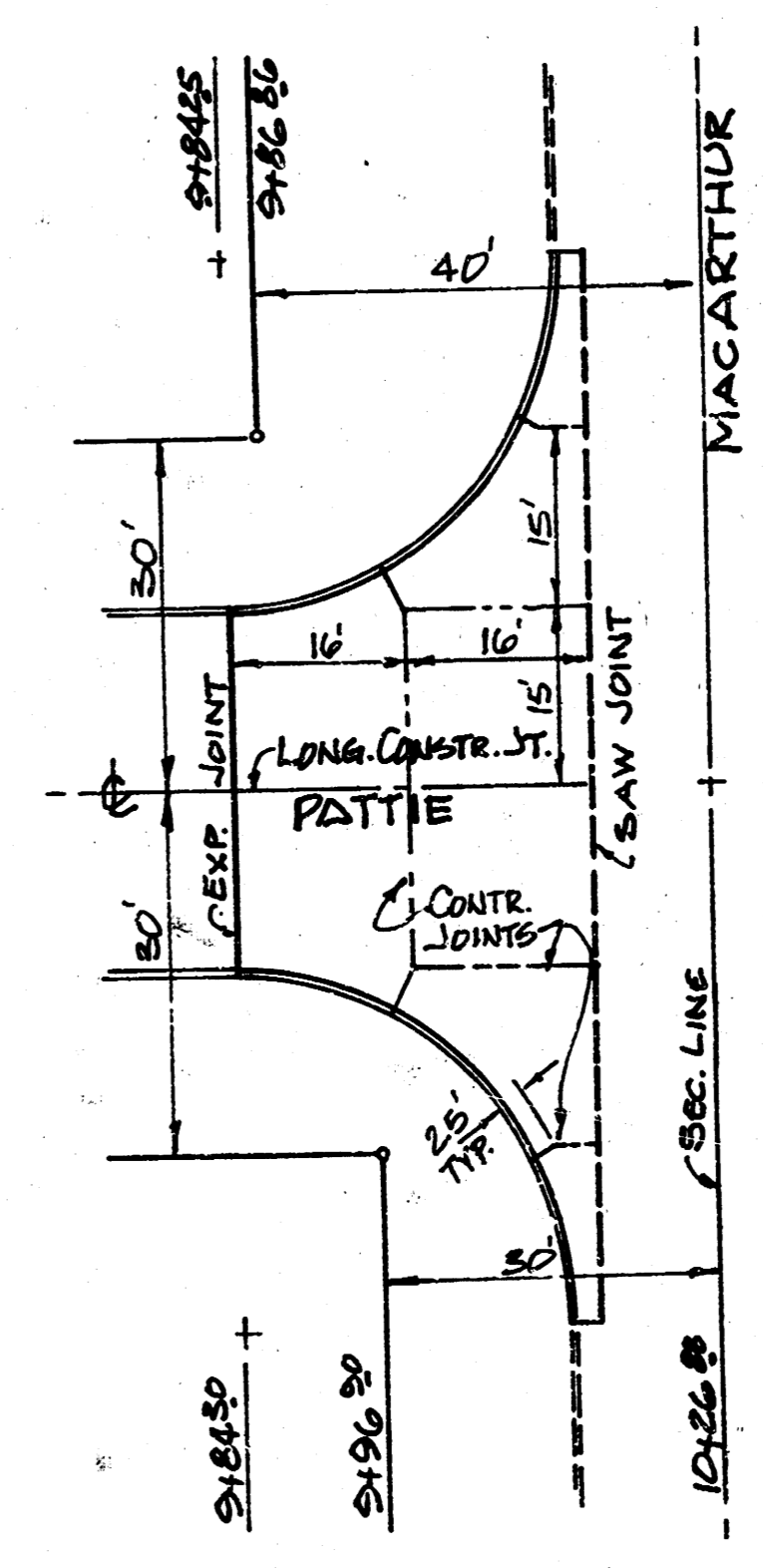

JOINT PLAN MacArthur

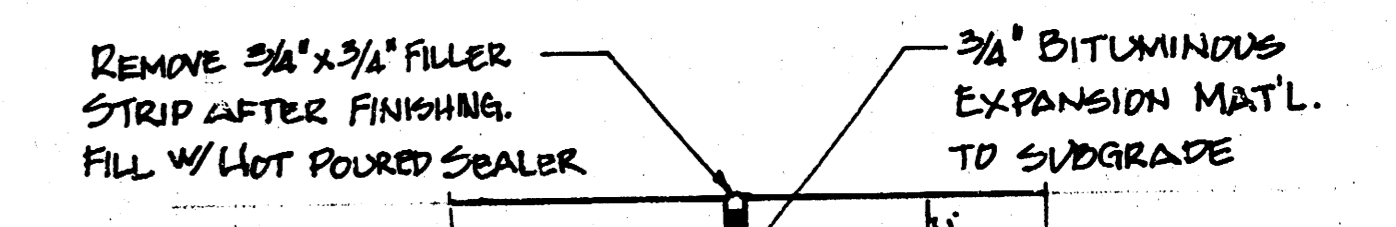

EXPANSION JOINT

**6 INCH RESIDENTIAL UNREINFORCED CONCRETE PAVEMENT**  
**CITY OF WICHITA, KANSAS**

Project number 472-76-245-80868-000-000-001

**BAUGHMAN COMPANY, P.A.**  
 SURVEYING & ENGINEERING  
 316/262-7271 • 330 LAURA • WICHITA, KANSAS 67211

2/6

B.M. - N.E. COR. CONCRETE PORCH,  
HOUSE #1429 SELMA (S.W. COR.  
SELMA & EWS) ELEV. 89.47

N  
1" = 20'

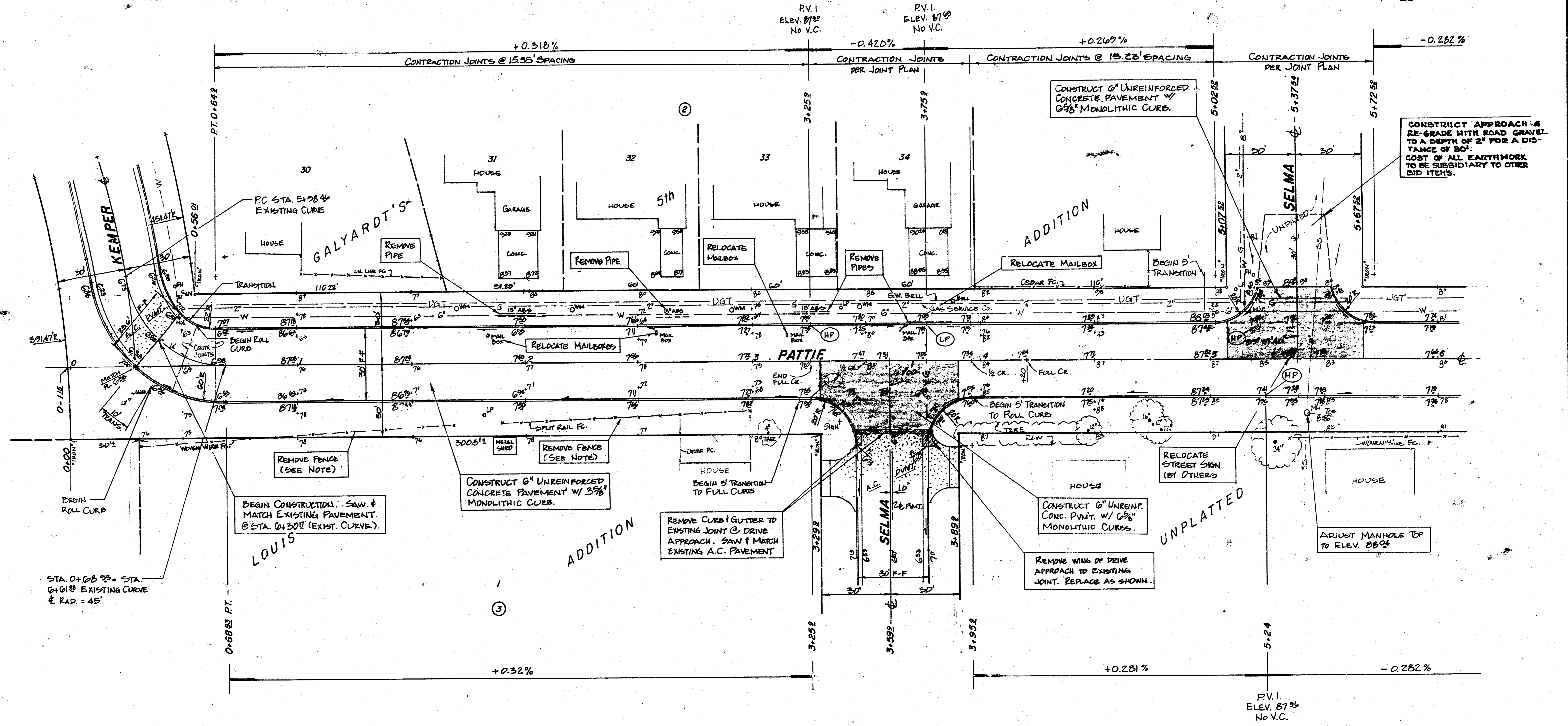

NOTE: REMOVAL OF DEBRIS WITHIN STREET RIGHT OF WAY IS TO BE SUBSIDIARY TO BID ITEM CU. YDS EXCAVATION.

NOTE:  
FENCE WITHIN STREET R/W SHALL BE REMOVED BY THE CONTRACTOR AT THE DIRECTION OF THE ENGINEER. THE PROPERTY OWNER SHALL HAVE THE RIGHT TO SALVAGE FENCE MATERIALS. ANY MATERIALS NOT CLAIMED SHALL BE REMOVED BY THE CONTRACTOR AT NO COST TO THE CITY.

(SELMA EAST) INTERSECTION QUANTITIES

170.95 Y.	6" Concrete Pavement
- S.Y.	Asphaltic Conc. Pavement ( " Bituminous Base)
- S.Y.	Bituminous Base
- L.F.	Combined Curb & Gutter
42.6 L.F.	MONOLITHIC EDGE CURB 0.5%
- S.F.	4" Wheelchair Ramp
- S.F.	4" Walk
22.6 C.Y.	Excavation
- C.Y.	Compacted Fill
- Lbs.	Reinforcing Steel
17.2 S.Y.	Manipulation
- Tons	Lime or Cement
- S.Y. V.G.	Concrete & " Asphaltic Concrete Base

(SELMA WEST) INTERSECTION QUANTITIES

170.95 Y.	6" Concrete Pavement
- S.Y.	Asphaltic Conc. Pavement ( " Bituminous Base)
- S.Y.	Bituminous Base
- L.F.	Combined Curb & Gutter
42.6 L.F.	MONOLITHIC EDGE CURB 0.5%
- S.F.	4" Wheelchair Ramp
- S.F.	4" Walk
22.6 C.Y.	Excavation
- C.Y.	Compacted Fill
- Lbs.	Reinforcing Steel
17.2 S.Y.	Manipulation
- Tons	Lime or Cement
- S.Y. V.G.	Concrete & " Asphaltic Concrete Base

Note: Curb on this project is to be Roll-Type except where noted otherwise.

EARTHWORK QUANTITIES EXCAVATION

	CITY	PROPERTY
10%	163.3 CU YDS	1102.7 CU YDS
TOTAL	160.2 CU YDS	1103.3 "

3812 SQ YDS. SUBGRADE STABILIZATION MANIPULATION.

PATTIE  
Proj. no. 472-76-245-80868-000-001

B.M. - 4" IN CONC. F.V.M.T. @  
 C. PATTIE & SEC. LINE  
 (MACARTHUR) ELEV. 86.18

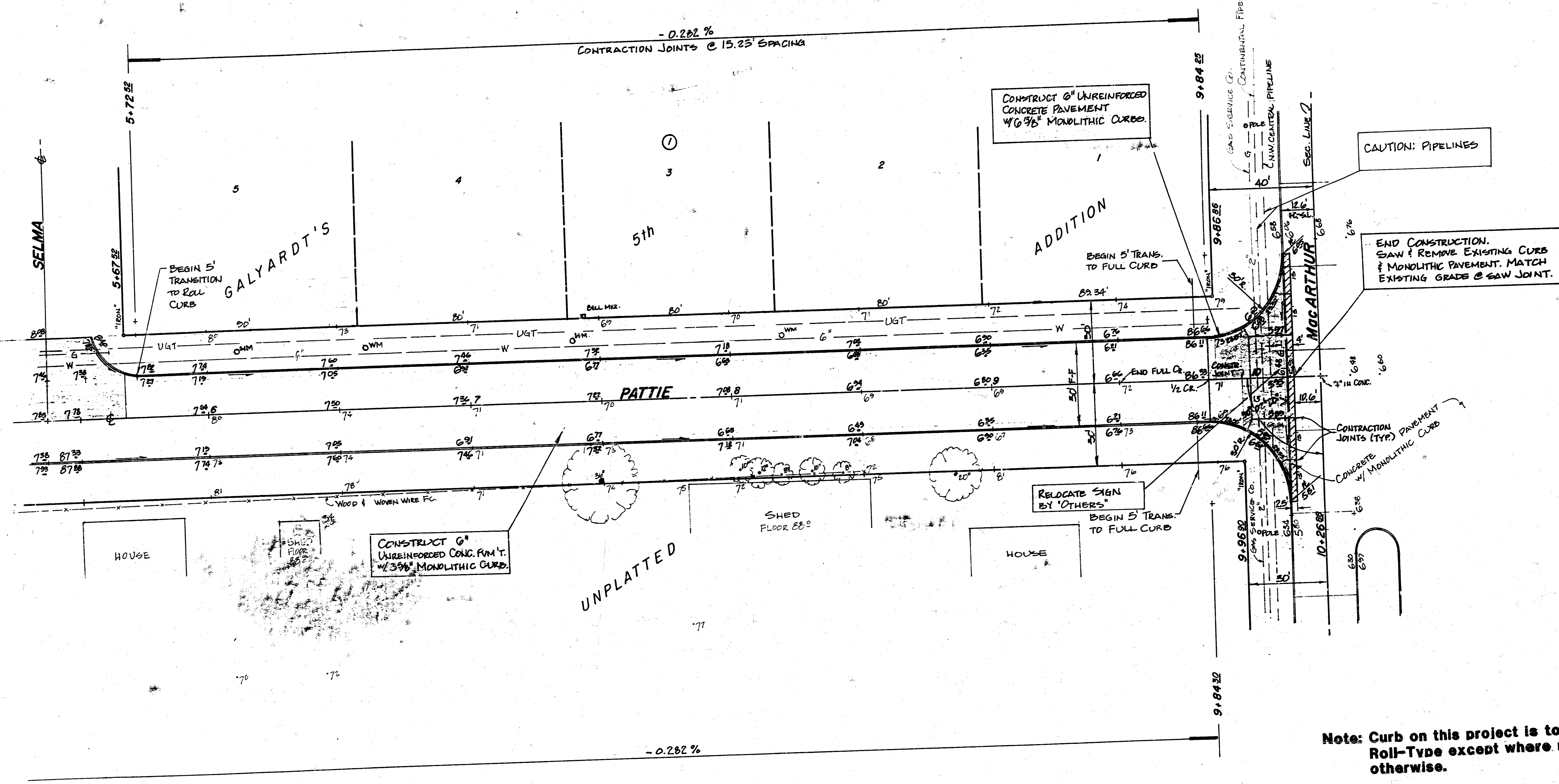
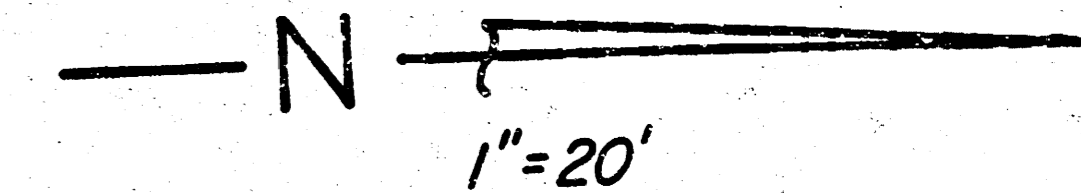

Note: Curb on this project is to be Roll-Type except where noted otherwise.

INTERSECTION QUANTITIES

142	S.Y.	6"	Concrete Pavement
—	S.Y.	—	Asphaltic Conc. Pavement ( — " Bituminous Base)
25	S.Y.	—	PAVEMENT REMOVED
25	L.F.	—	Saw Joint
124	L.F.	—	MONOLITHIC EDGE CURB @ 5/8"
—	S.F.	—	4" Wheelchair Ramp
—	S.F.	—	4" Walk
50	C.Y.	—	Excavation
—	C.Y.	—	Compacted Fill
—	Lbs.	—	Reinforcing Steel
146	S.Y.	—	Manipulation
—	Tons	—	Lime or Cement
—	S.Y.	V.G.	Concrete & — " Asphaltic Concrete Base

PATTIE  
 Proj. no. 472-76-245-80668-000-000-001

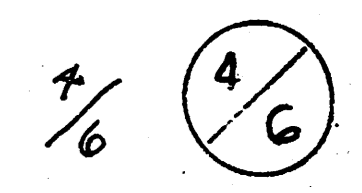

BA 17

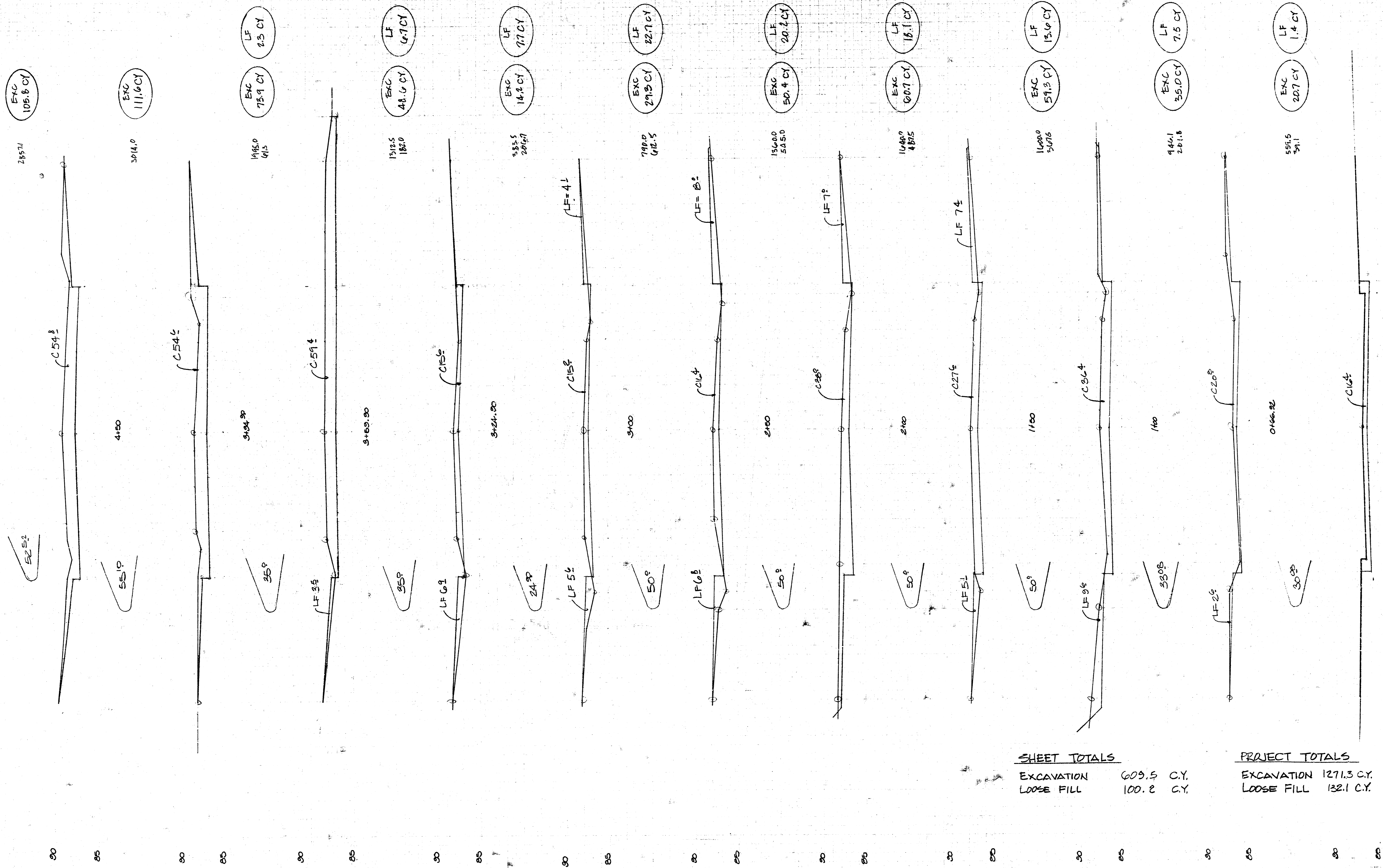

**SHEET TOTALS**  
 EXCAVATION 609.5 C.Y.  
 LOOSE FILL 100.2 C.Y.

**PROJECT TOTALS**  
 EXCAVATION 1271.3 C.Y.  
 LOOSE FILL 132.1 C.Y.

