

PAWNEE

W.L. AT. & S.F. RR. R/W TO W.L. MINNEAPOLIS

44'-2'-48" ASPH. CONC.

C10-62

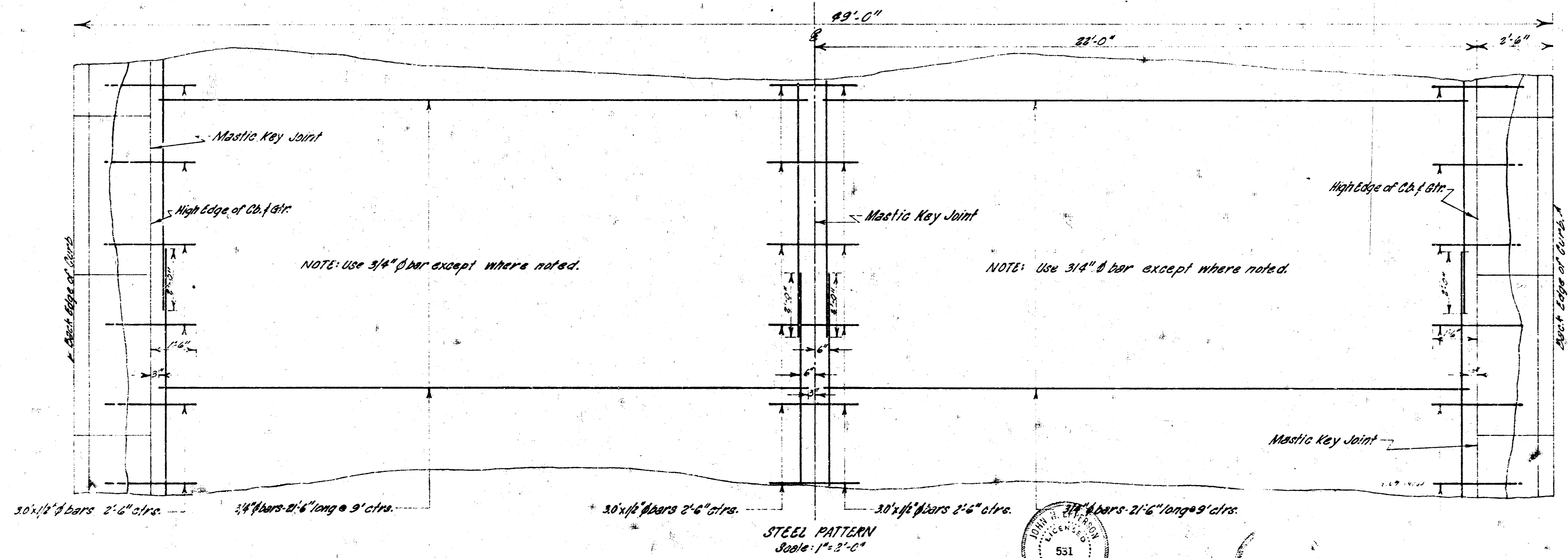
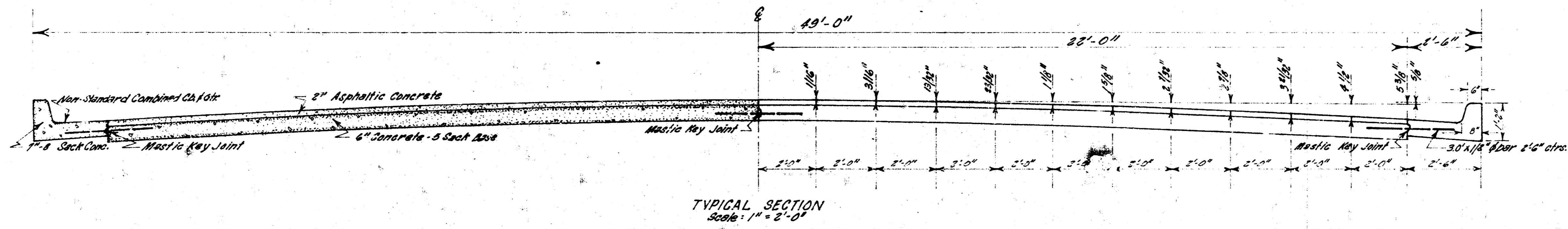

B.M. 98.73 11'-cur S.E. Cor Conc Base Sincain Sign, S.S. Re wire

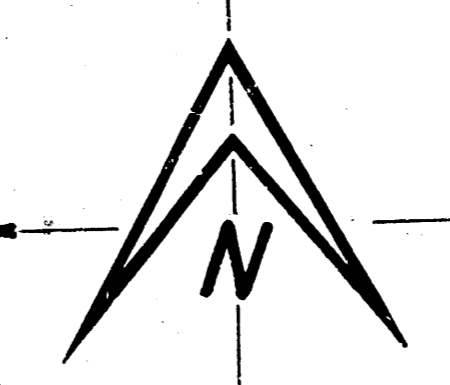
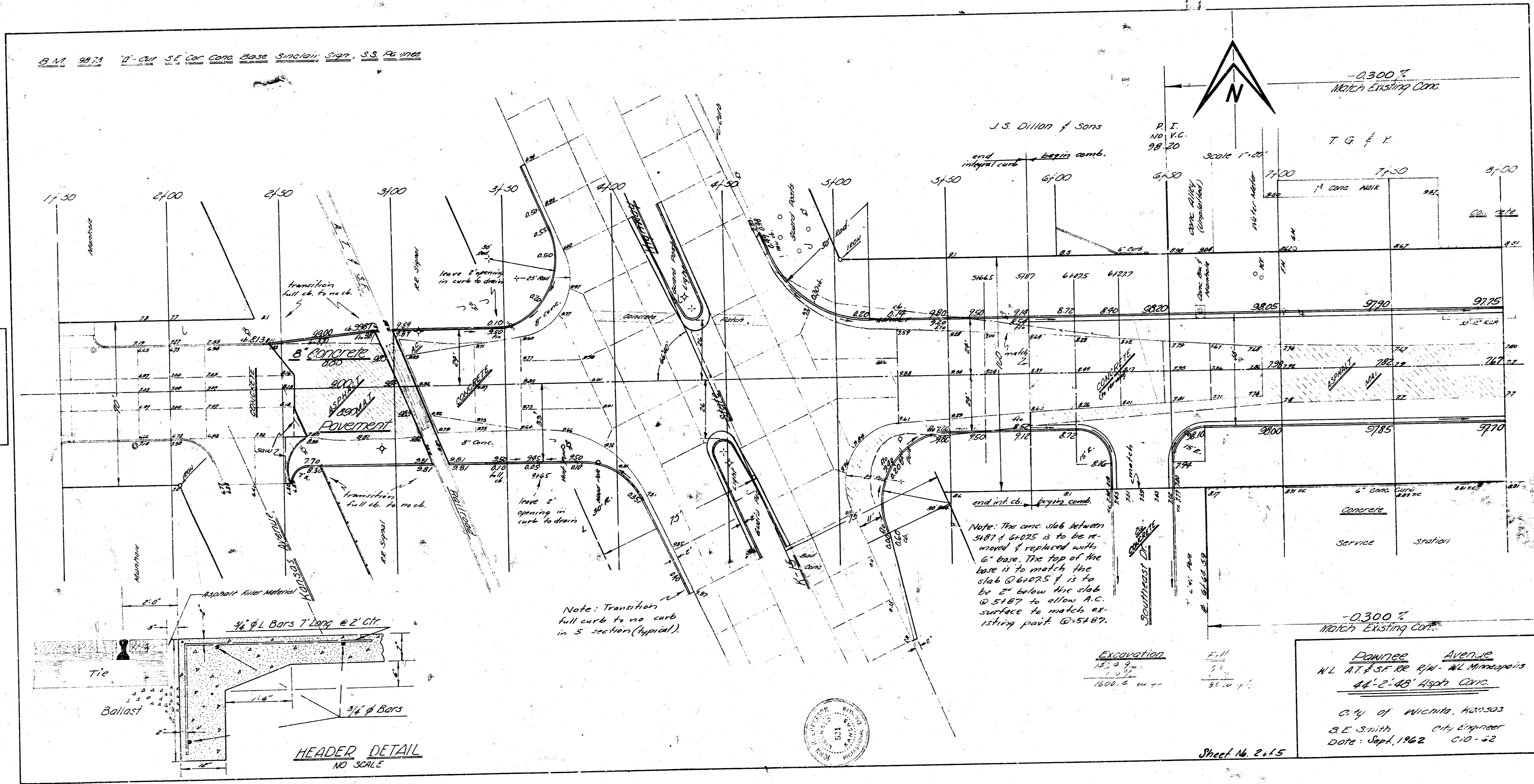

Note: The conc slab between 5187 & 61025 is to be removed & replaced with 6" base. The top of the base is to match the slab @ 61025 & is to be 2" below the slab @ 5187 to allow A.C. surface to match existing part @ 5187.

Note: Transition full curb to no curb in S section (typical).

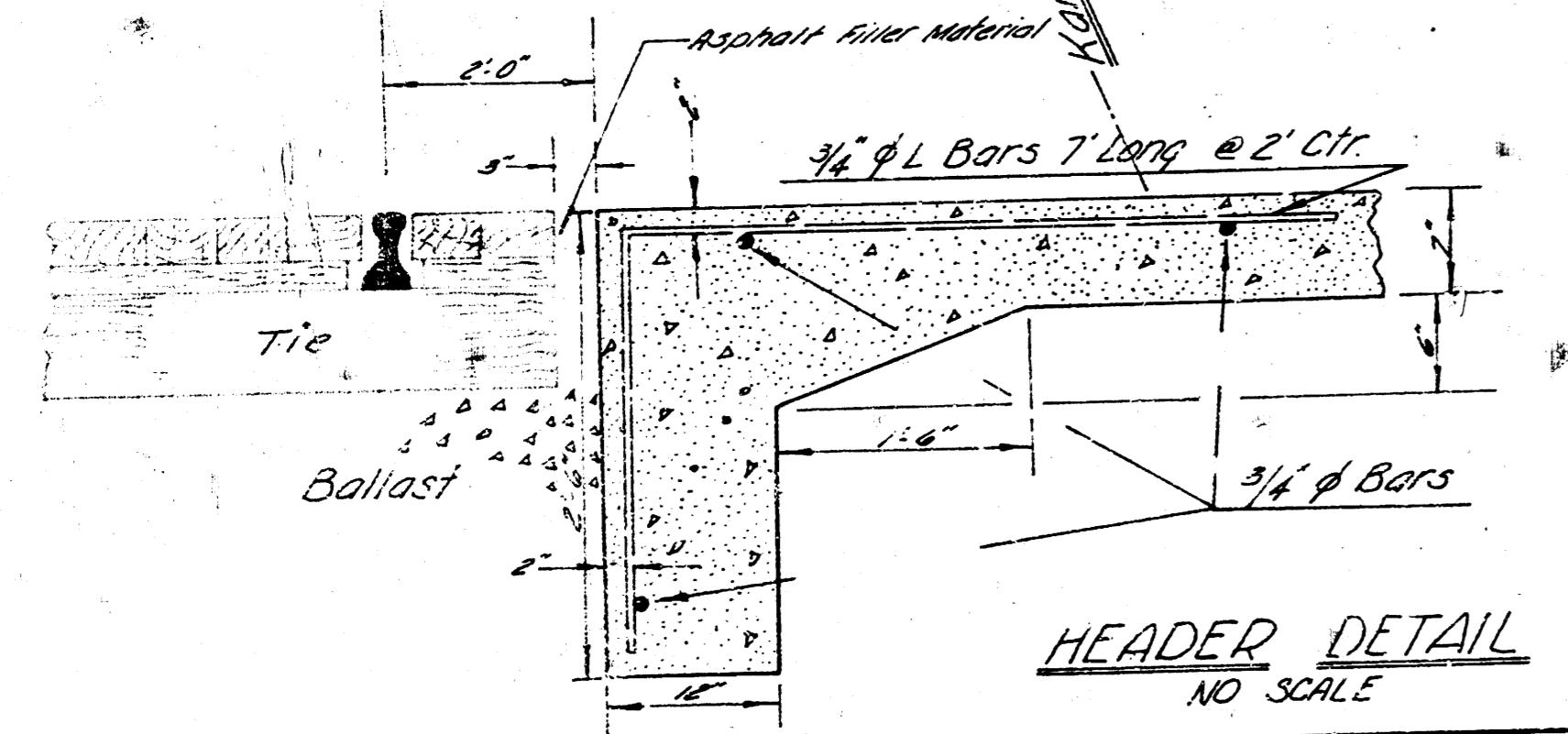

Excavation
12.0' x 7.0'
1000.0 cu ft

F.I.
7.0'
81.00 yd

POWEE AVENUE
N.L. AT S.E. COR 4th - W.L. Minneapolis
44'-2'-00" High Conc.
City of Wichita, Kan-303
B.E. Smith City Engineer
Date: Sept. 1962 C-10-52

Sheet No. 2 of 5

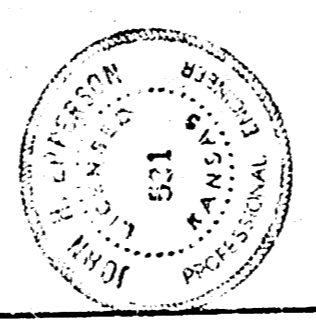

Note to Contractor:
 Between sta 81.50 & sta 134.50 there is a 4" x 5" conc. patch over
 the water line at the north edge of existing asphalt mat. This conc.
 is to be removed & paid as 3" x 4" conc. pavement removal.
 Quantity = approx. 370 sq yd.

The asphaltic conc. mat on this project is from 1" to 4" inches
 thick. It will be paid as 3" x 4" asphalt surface material rem.
 Quantity = approx. 2630 sq yd.

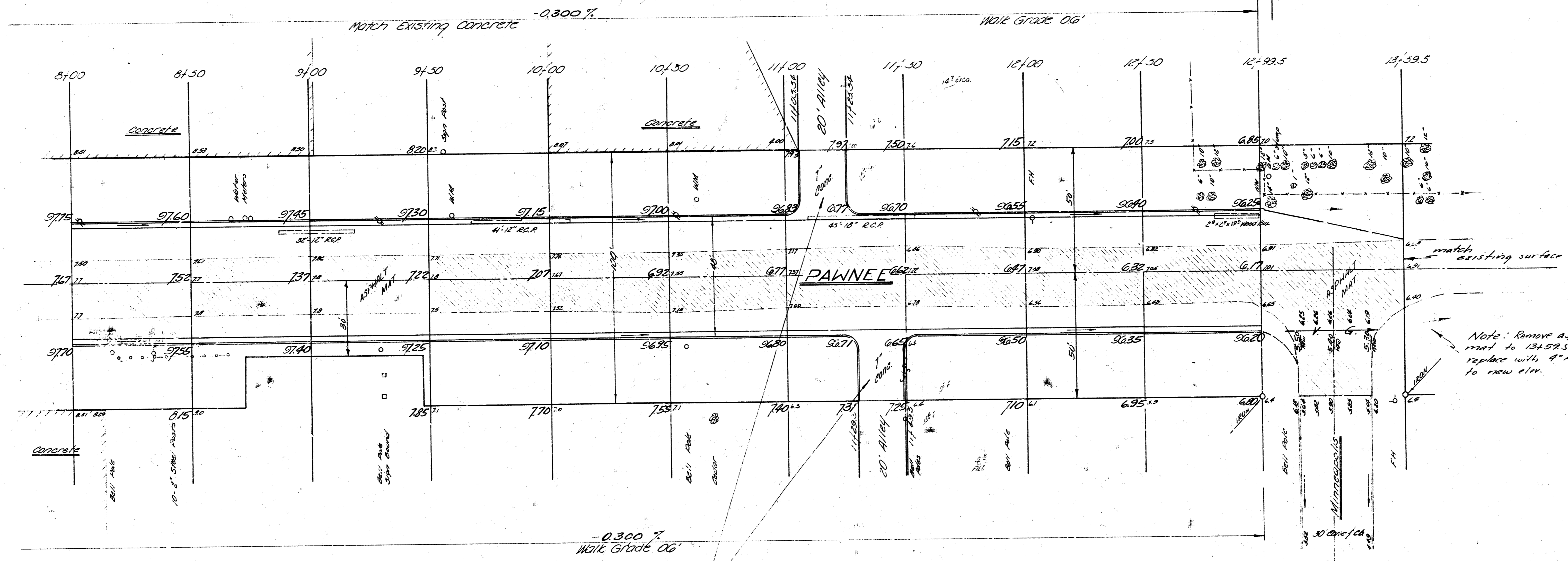

Note: Remove asphalt
 mat to 134.50 S. &
 replace with 4" A.C.
 to new elev.

Note: Alley returns shall not be poured without
 approval of city field engineer.

PAWNEE AVENUE
 Sheet 10 of 15
 210-62