

PAVING PLAN
 PERSHING AVENUE
 BAYLEY STREET TO HARRY STREET
 24' CONCRETE PAVEMENT

NOTE: Profile grades are designed to fit existing paving. However, a slight overall vertical adjustment may be necessary in the field.

B.M. Elev. 157.16' in Globe sec. 6, Lincoln St. at W. Oliver St.

HILLTOP MANOR
 WICHITA, KANSAS
 1943

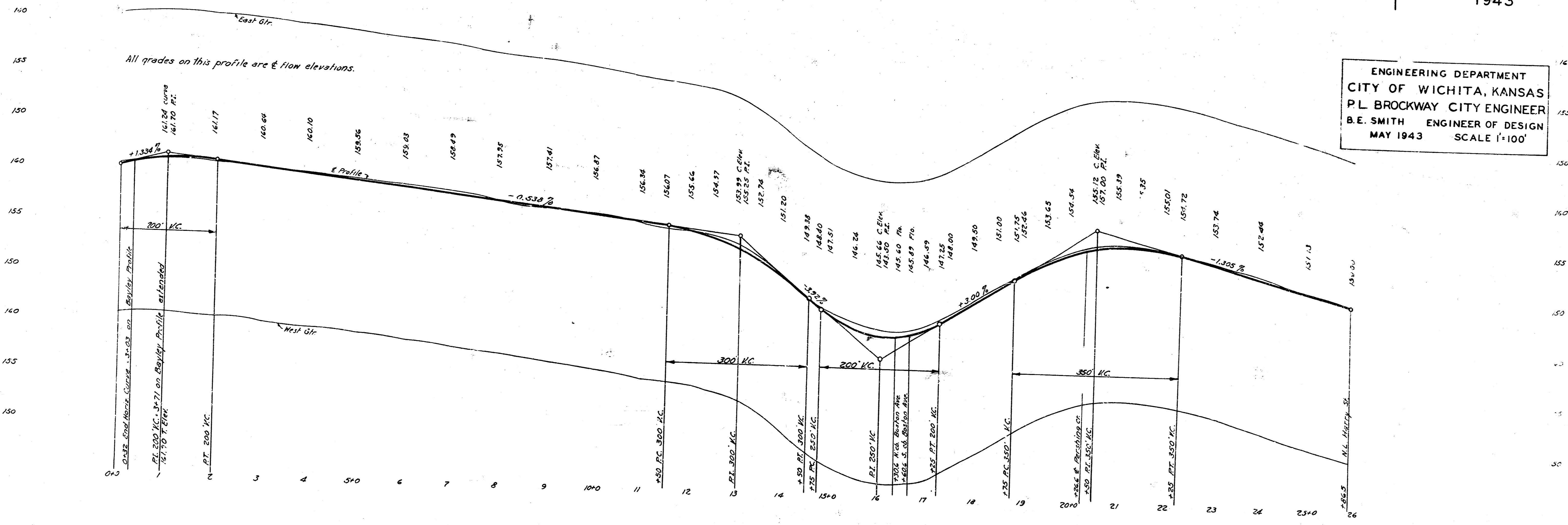

ENGINEERING DEPARTMENT
 CITY OF WICHITA, KANSAS
 P.L. BROCKWAY CITY ENGINEER
 B.E. SMITH ENGINEER OF DESIGN
 MAY 1943 SCALE 1"=100'

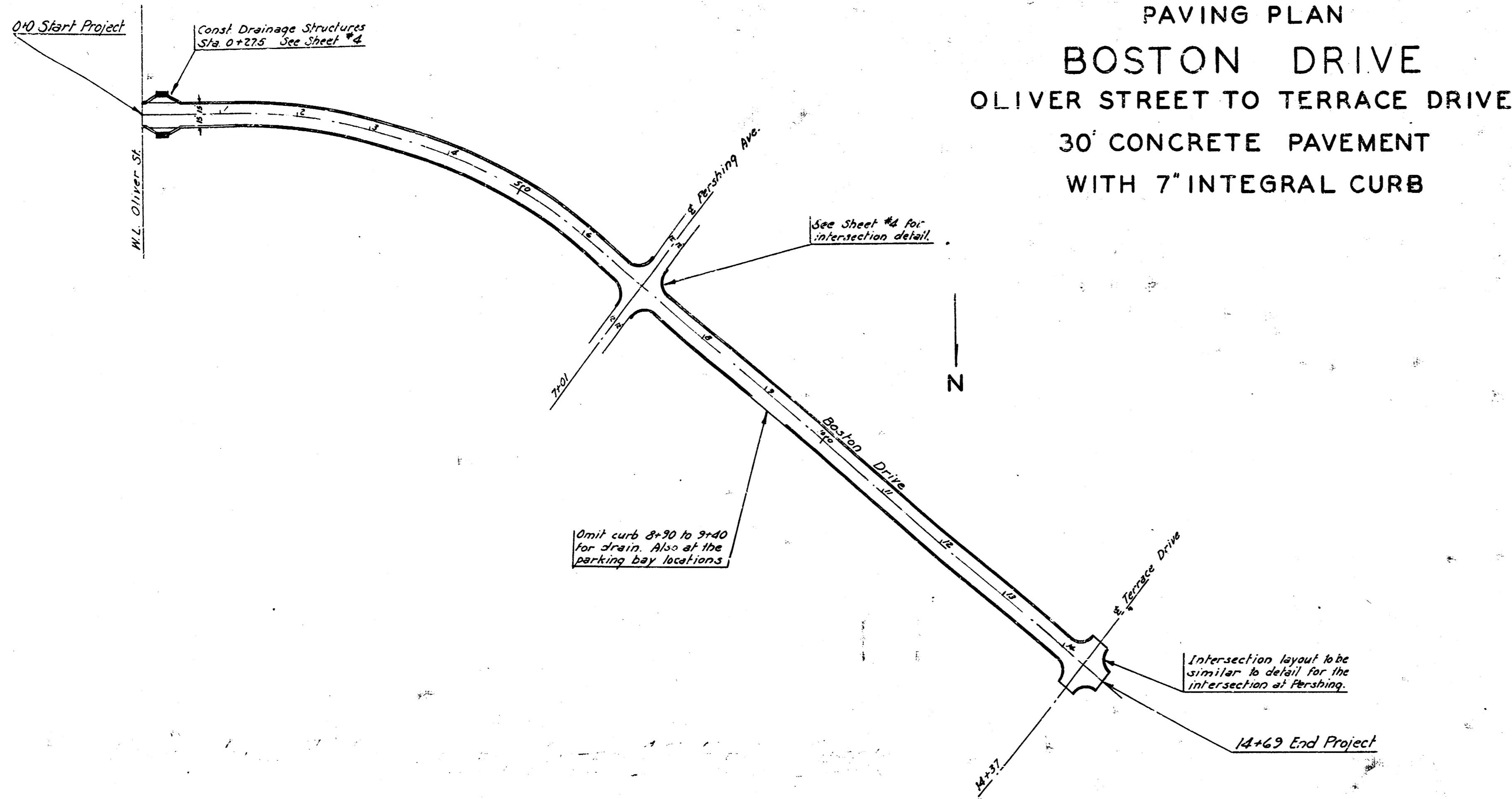

B.M. Elev 141.28 "x" E end N. coping on culvert at Oliver

Note: All grades on Boston profile are curb grades.

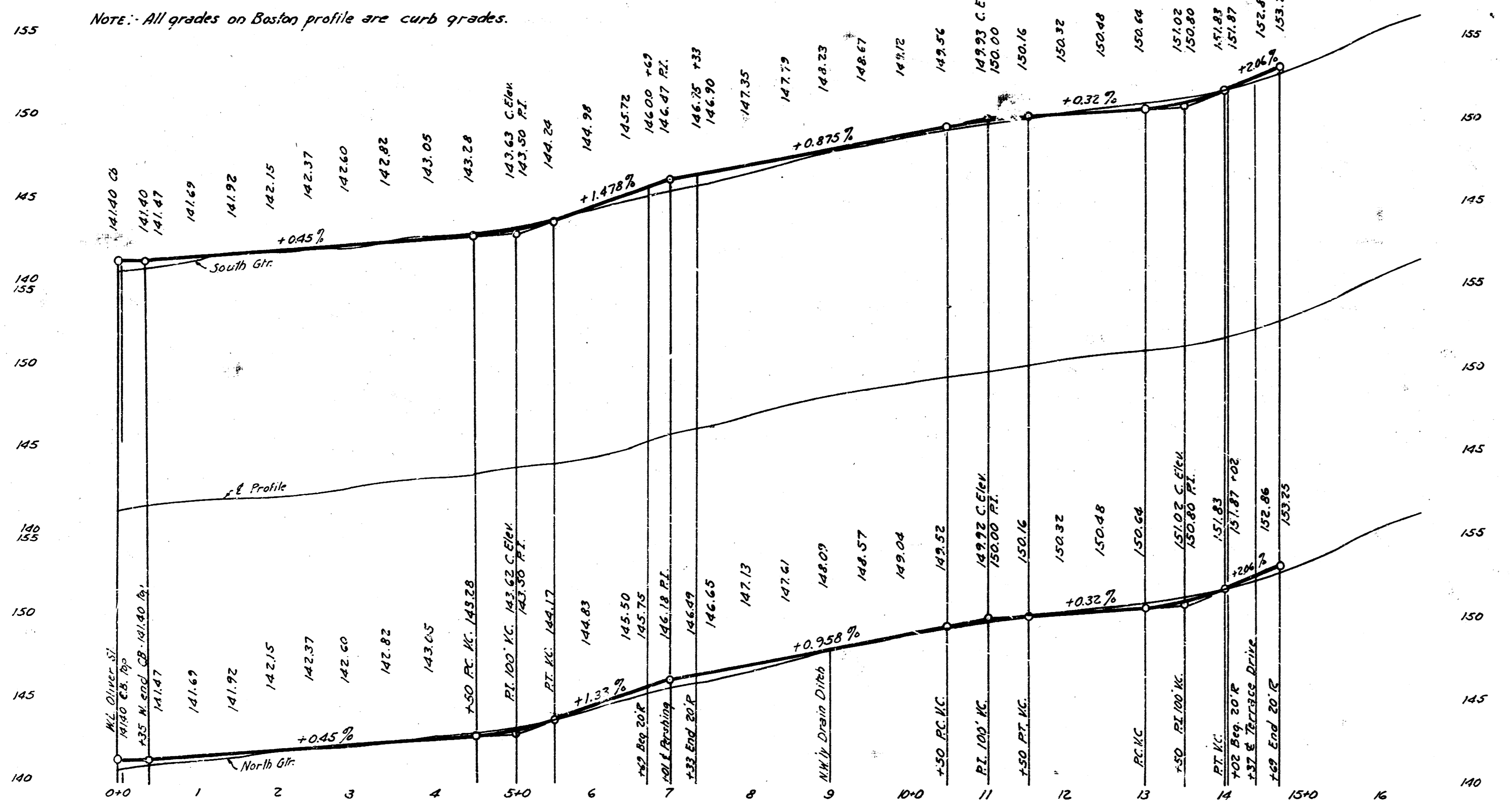

**PAVING PLAN
BLUFFVIEW DRIVE
24' CONCRETE PAVEMENT**

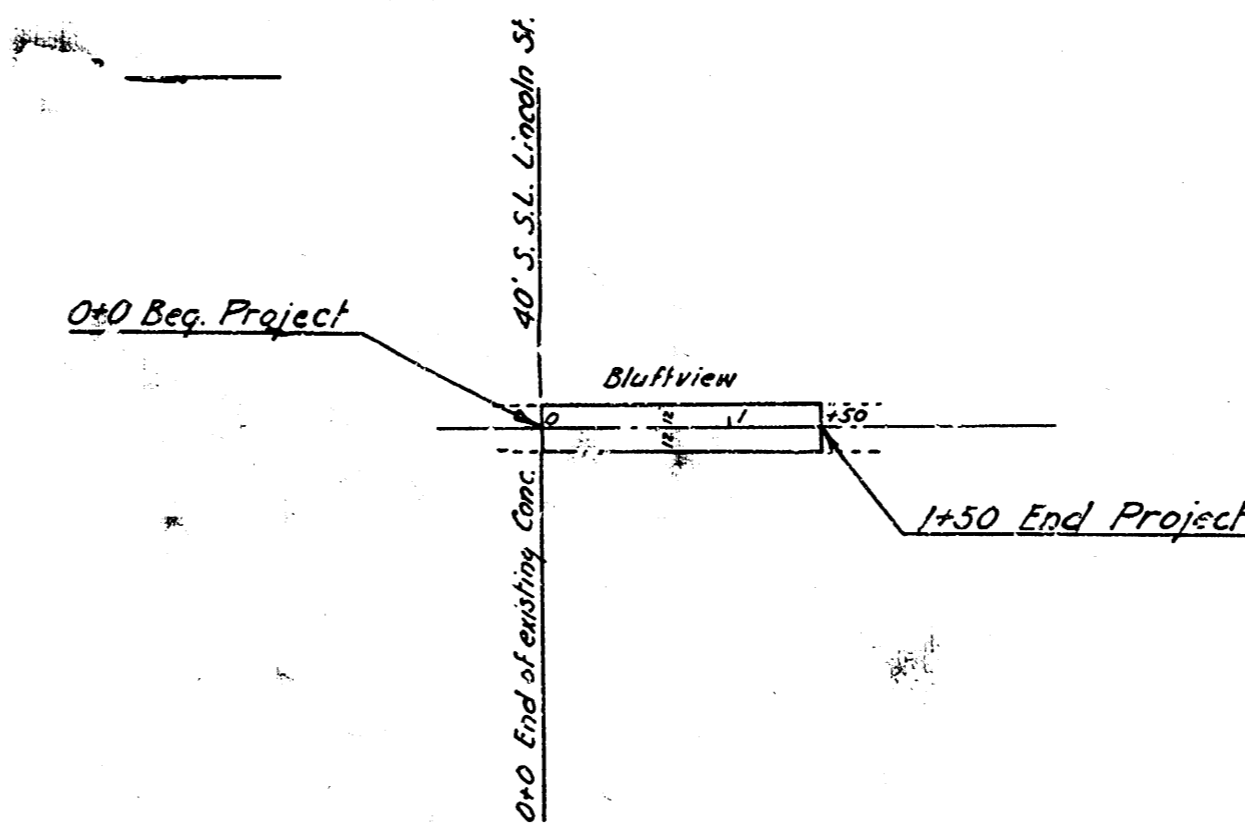

B.M. Elev 143.14 "x" in Globe N. ch. Lincoln at E.L. Broadview

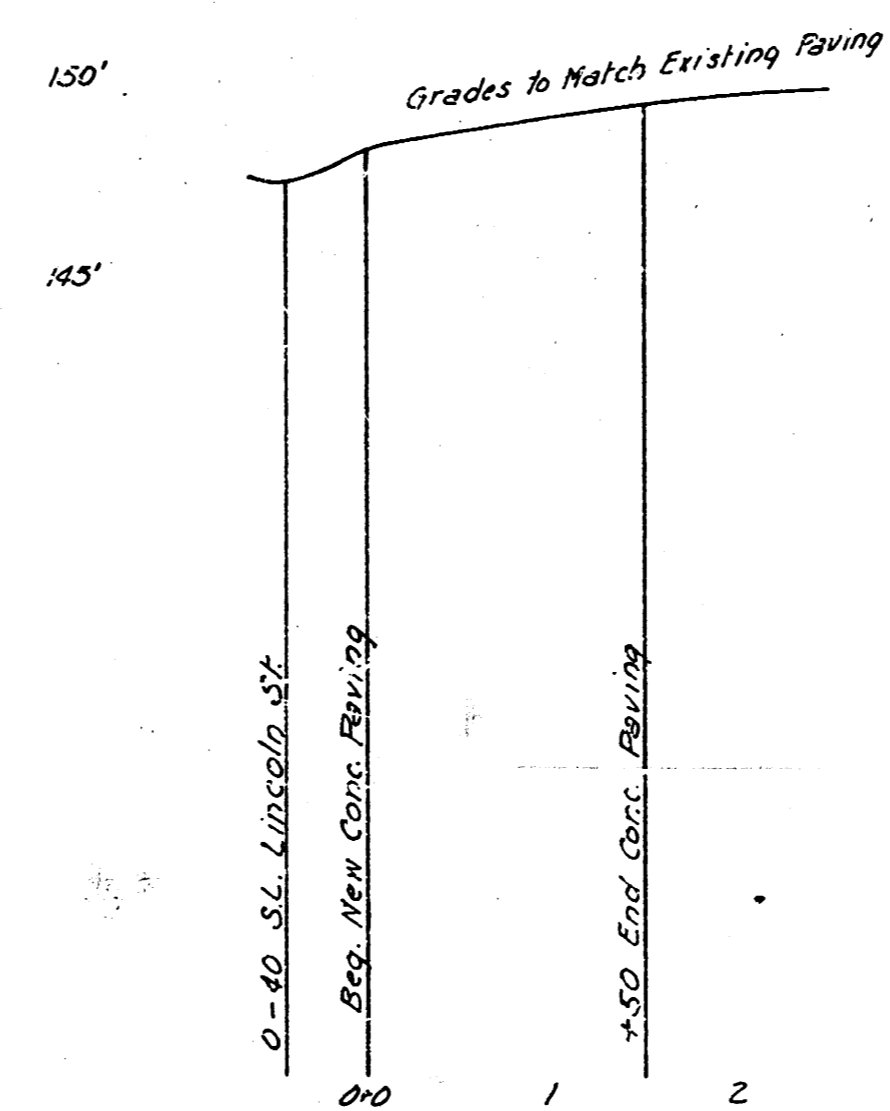

**PAVING PLAN
BAYLEY STREET
OLIVER ST. TO PERSHING AVE.
24' CONCRETE PAVEMENT**

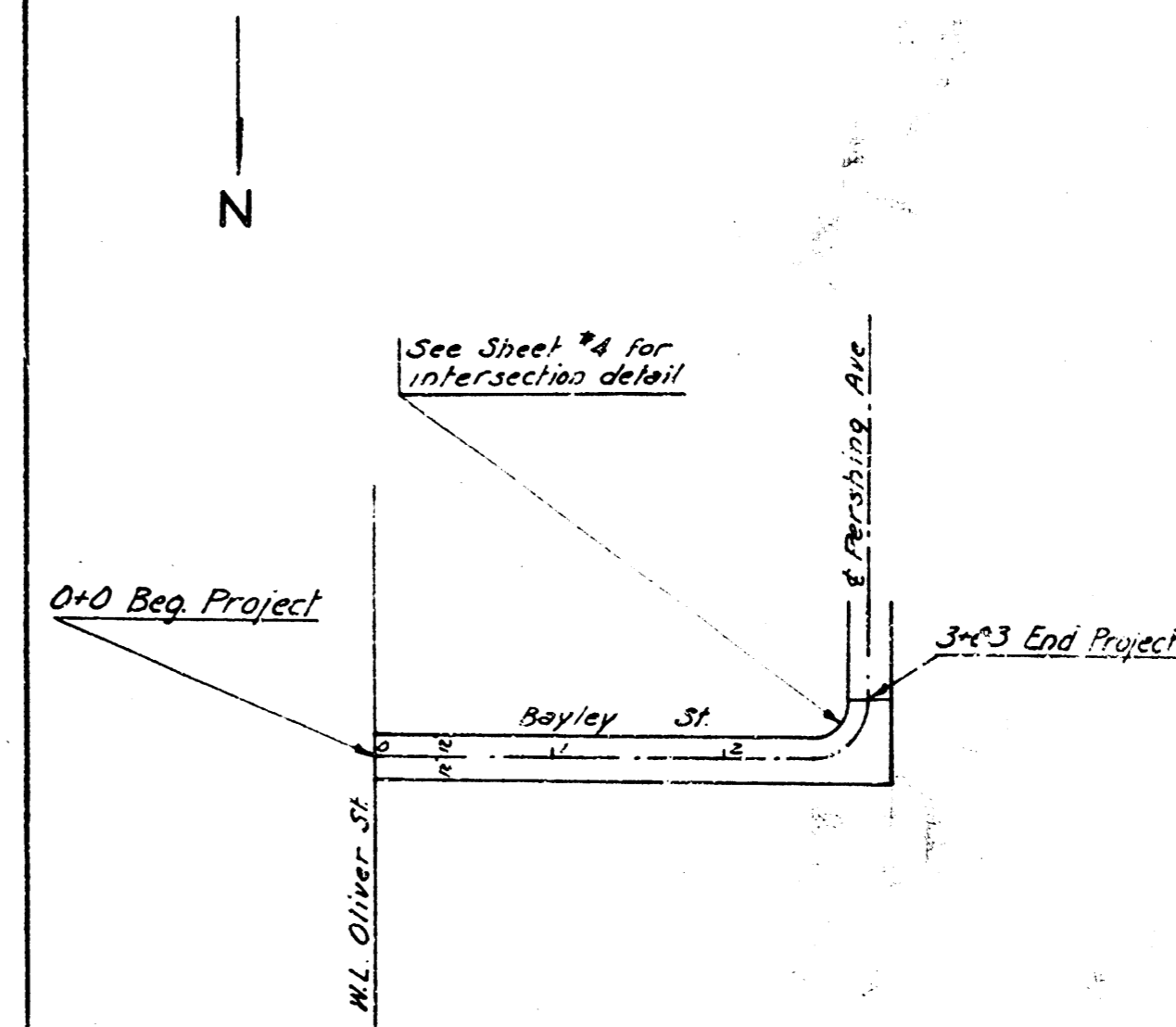

NOTE: All grades on Bayley are 0.11%

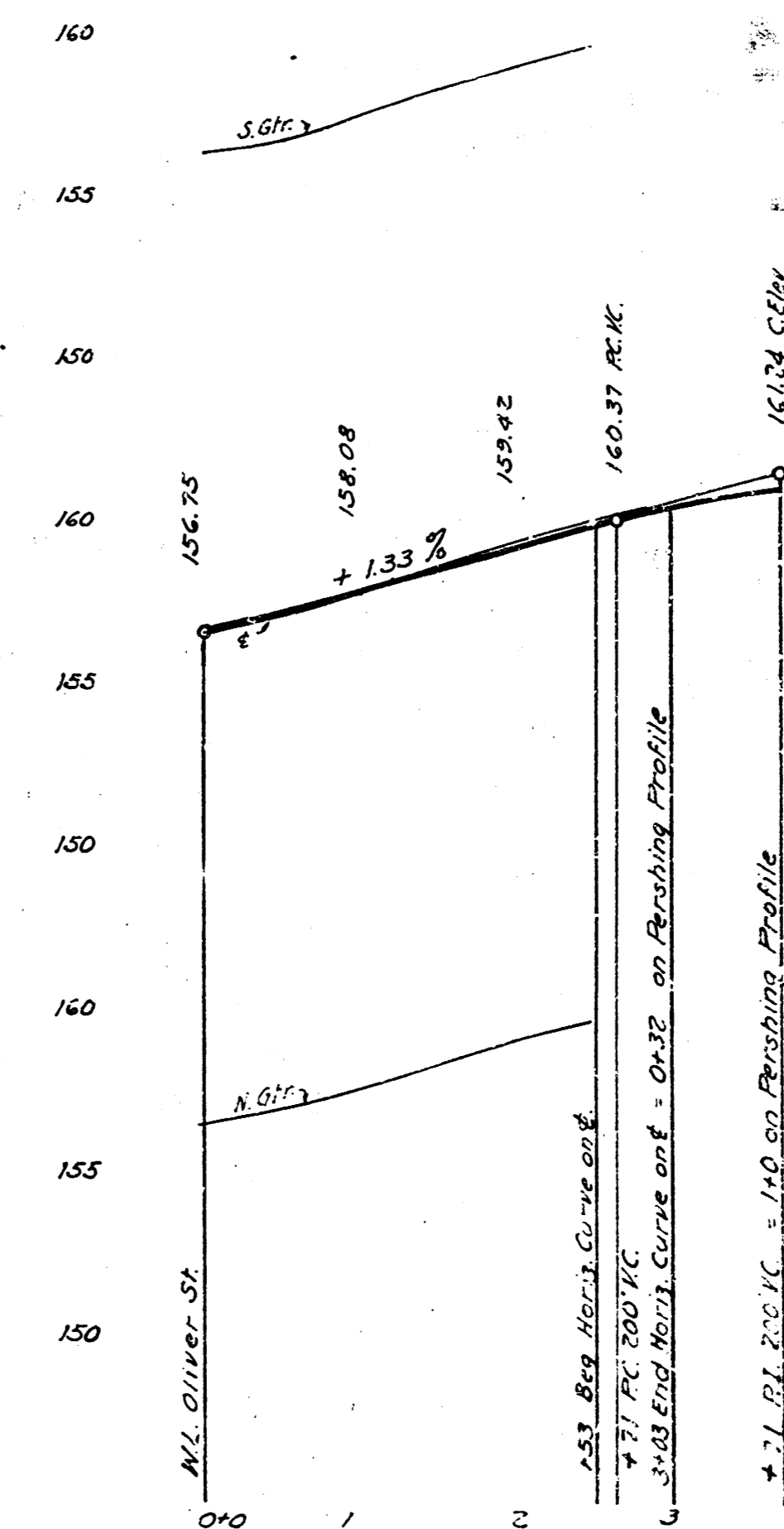

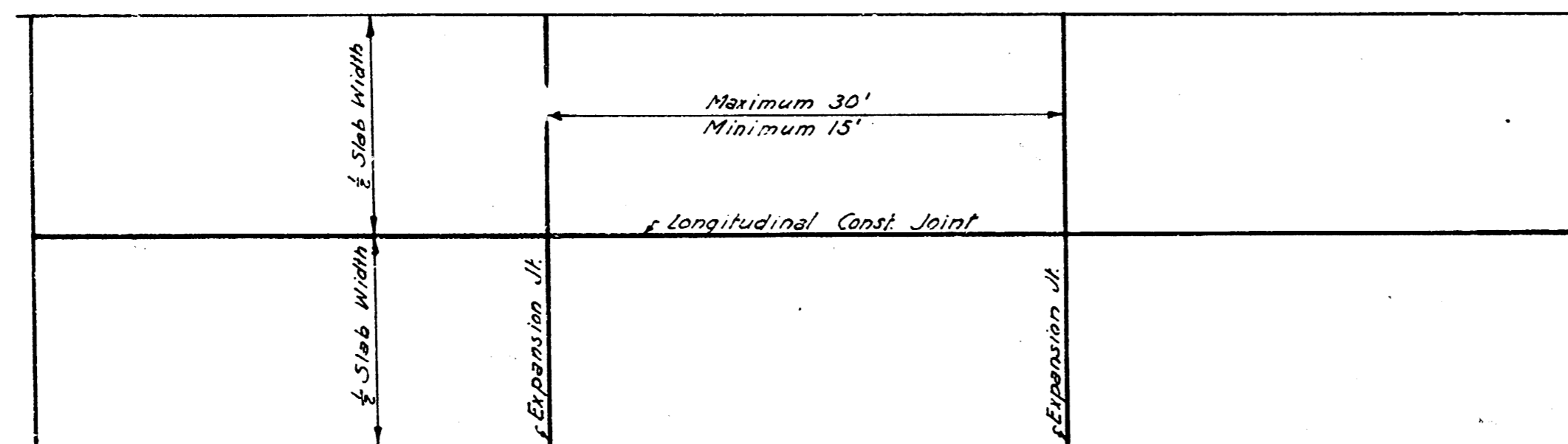

PLAN SHOWING JOINT PATTERN IN CONCRETE SLAB
SCALE $\frac{1}{4}''=1'-0''$

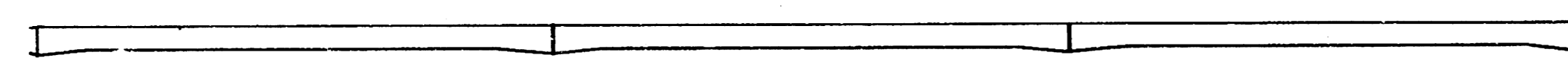

LONGITUDINAL SECTION OF CONCRETE SLAB
HORIZ $\frac{1}{4}''=1'-0''$
VERT $\frac{1}{4}''=1'-0''$

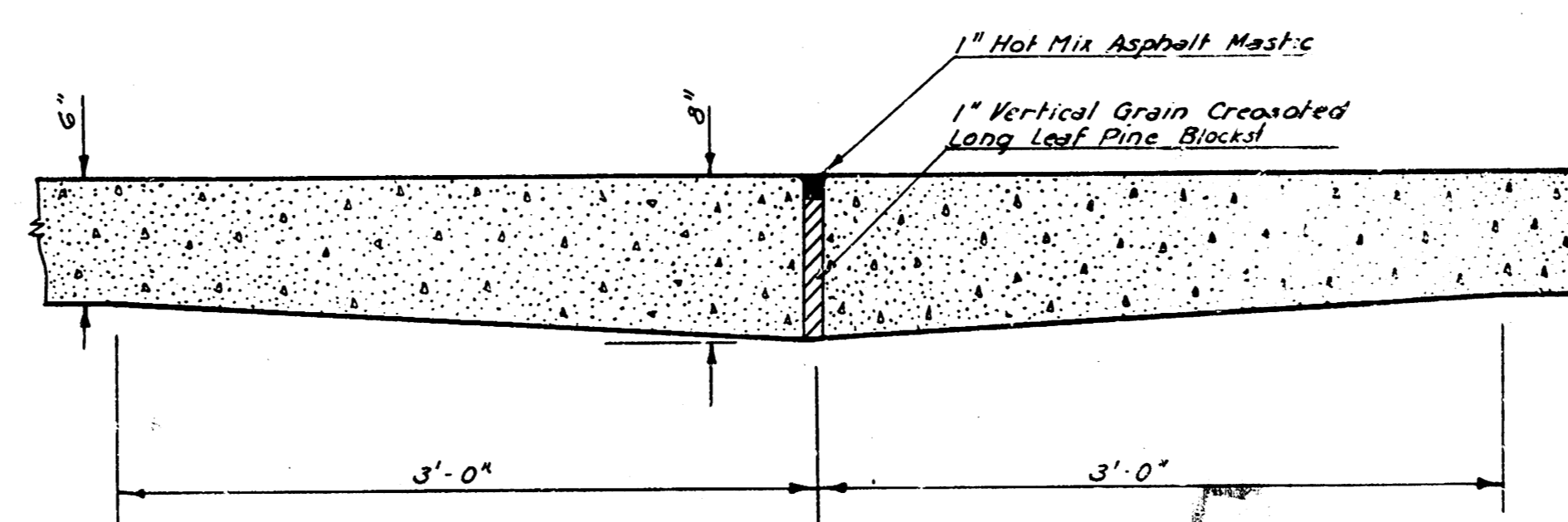

DETAIL SECTION
EXPANSION JOINT
SCALE $\frac{1}{2}''=1'-0''$

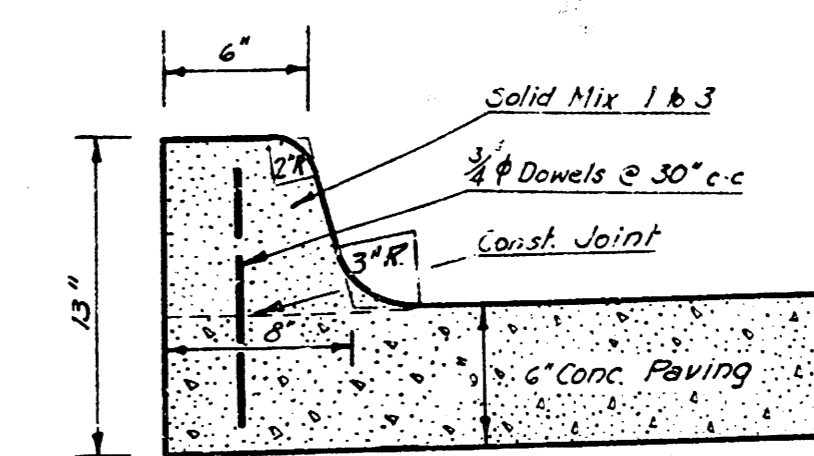

DETAIL SECTION
7" INTEGRAL CURB
SCALE $\frac{1}{2}''=1'-0''$

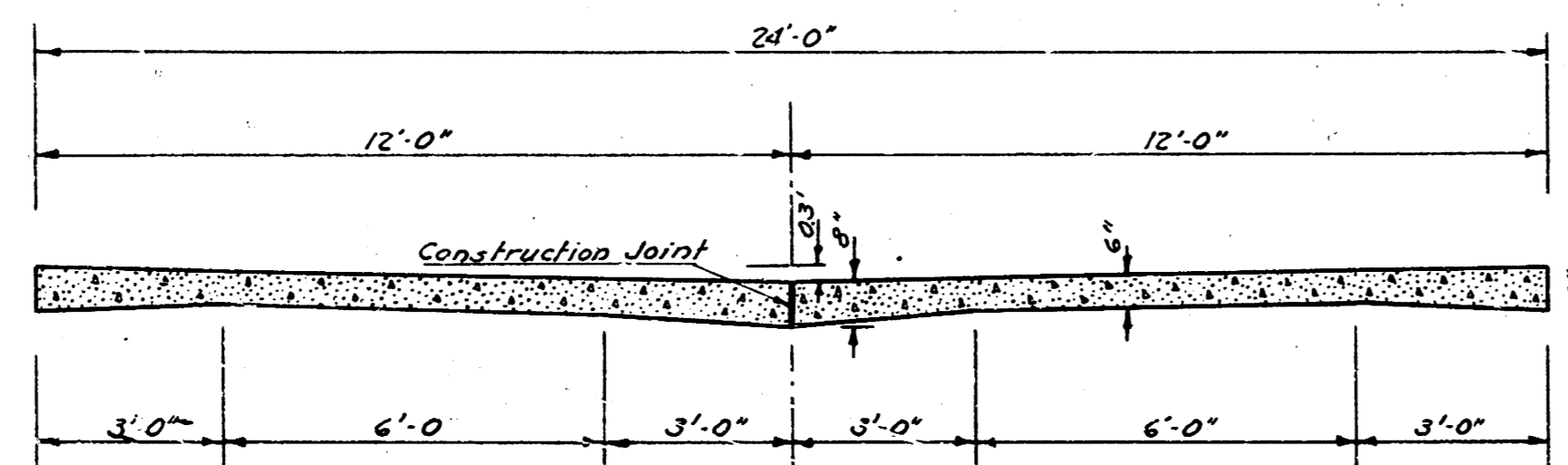

TYPICAL SECTION
24' CONCRETE PAVEMENT
TO BE CONSTRUCTED ON PERSHING AVE.
SCALE $\frac{3}{8}''=1'-0''$
TO BE CONSTRUCTED ON BLUFFVIEW DR
WITH A 0.2' CROWN INSTEAD OF $\frac{1}{4}$ FLOW

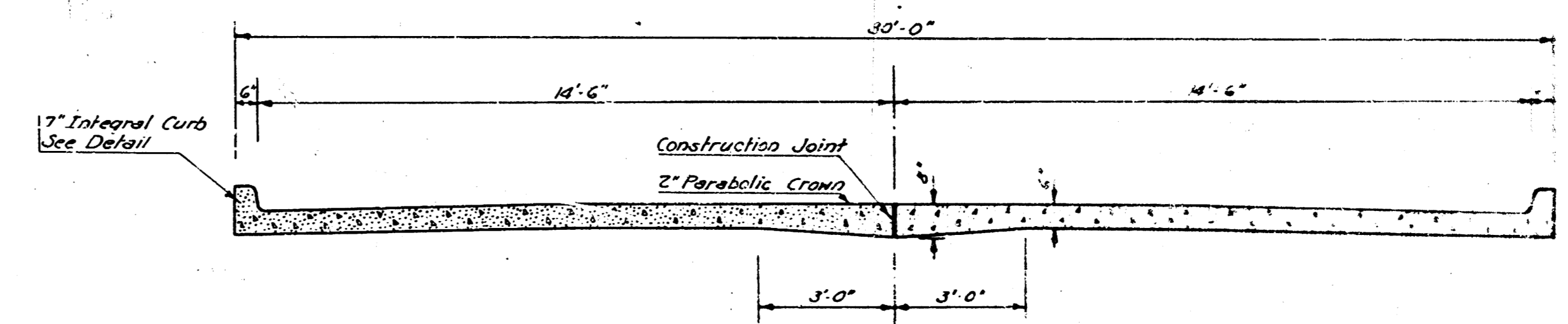

TYPICAL SECTION
30' CONCRETE PAVEMENT WITH INTEGRAL CURB
TO BE CONSTRUCTED ON BOSTON AVE.
SCALE $\frac{3}{8}''=1'-0''$

