

PERSHING AVE. FR. S.L. KELLOGG TO N.L. ORME, C&G E.S.

3M. Elev. 165.97 NE. W.L. Delrose N.L. Orme
169.13 " in Levee in Drive 507 S. Pershing

Tentative Grades

East side should be held higher than
the west side and run on
straight grade. The west side
has settled.

VC To Follow West Side

For final grades check curb grades on West side
at closer intervals than 100' as was done on preliminary

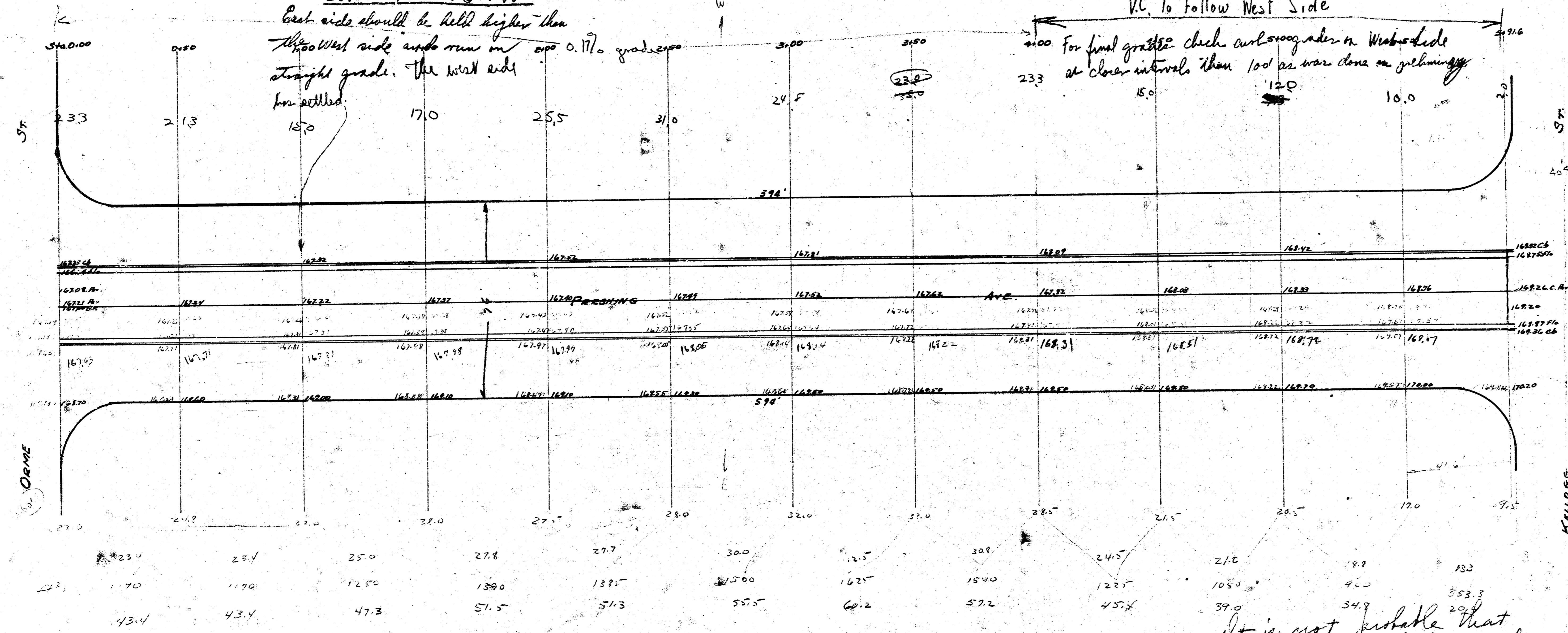

It is not probable that
excavation will be made
more than 5' from the gutter
into the street. Present street
surface being well established.

Paving Plan
Pershing Ave.
S.L. Kellogg
to
N.L. Orme
1290