

B.M. 11441 "G" IN GLOBE S END ROAD PINE & SANTA FE.
 B.M. 11563 "N" COR "X" ING. ST. & N.S. MURDOCK E.S. SANTA FE.

STA ON N.E.

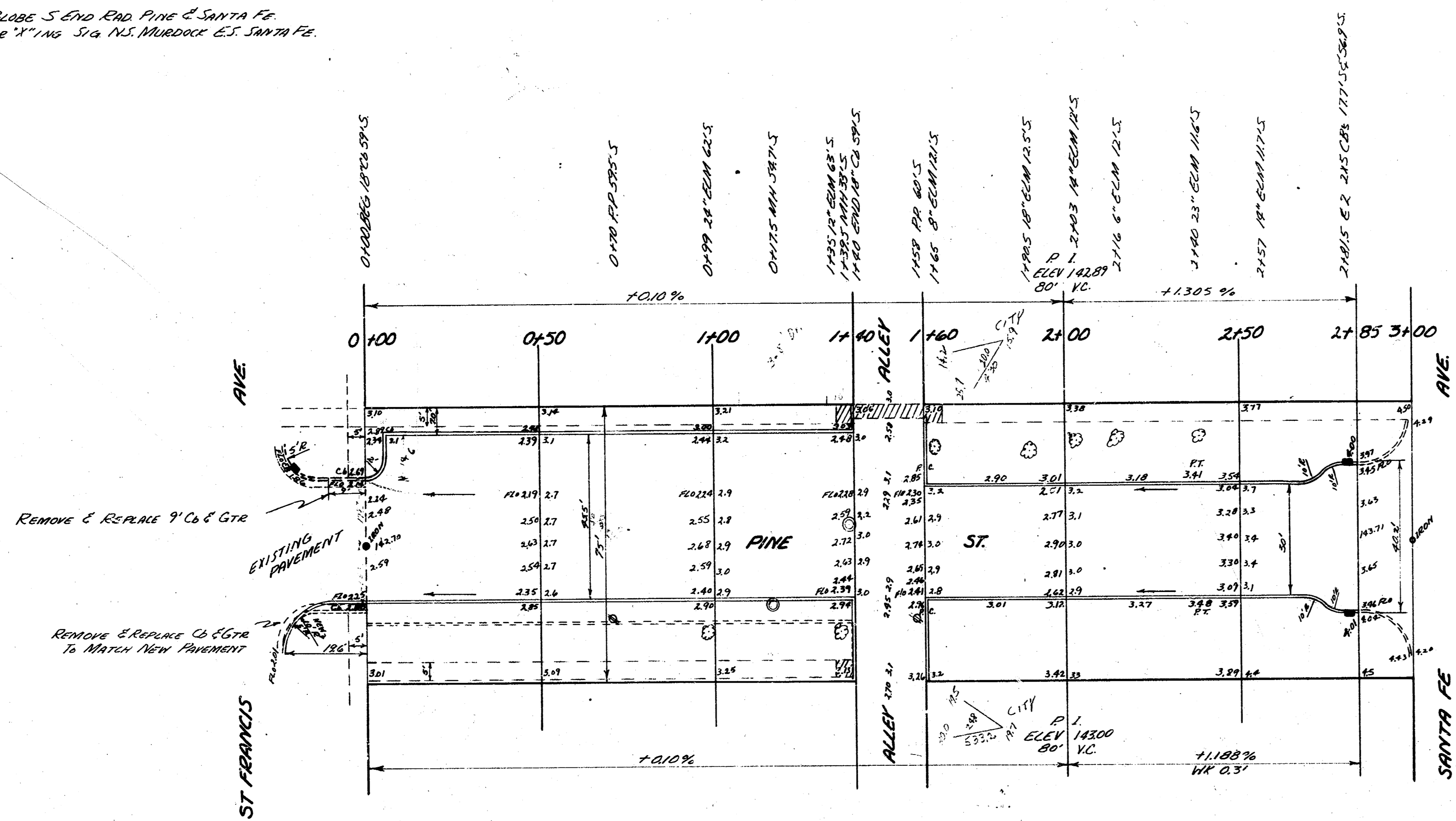

REMOVE & REPLACE 9" C&G GTR

REMOVE & REPLACE 12" C&G GTR
 TO MATCH NEW PAVEMENT

ST FRANCIS

SANTA FE

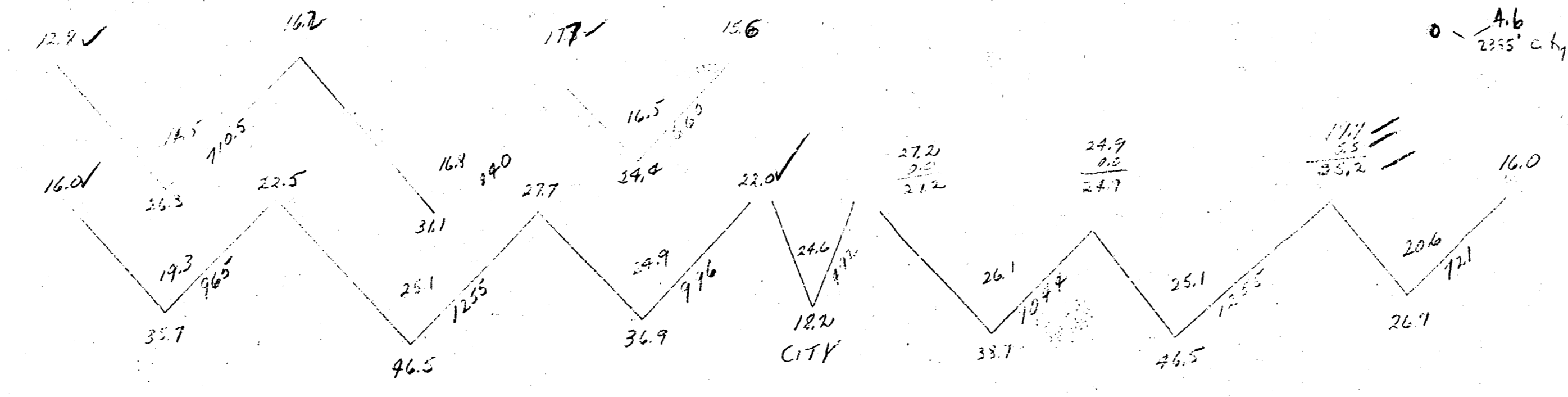

1. M.C.C. BR. 1010 7
 2. 10
 3. 10
 4. 10

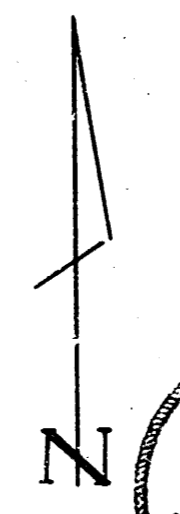

PINE ST.
 EL. ST. FRANCIS TO W. SANTA FE
 30' CONC. & CB.
CITY OF WICHITA KANSAS
 B.E. SMITH CITY ENGINEER
 APRIL 1933 PROJ. NO. C-12-116

5277

1 0 0 0