

B.M. = 1.513 extreme SW cor. stone slab on Woodlawn Village man. on NW cor. Central and Tallyrand No.
 T.P. = 174.00 14" in. Master, Fire Hydr. on NW cor. Plaza Ln. and NL Tallyrand.
 Base Line = West and North 1/2 of Plaza Ln.

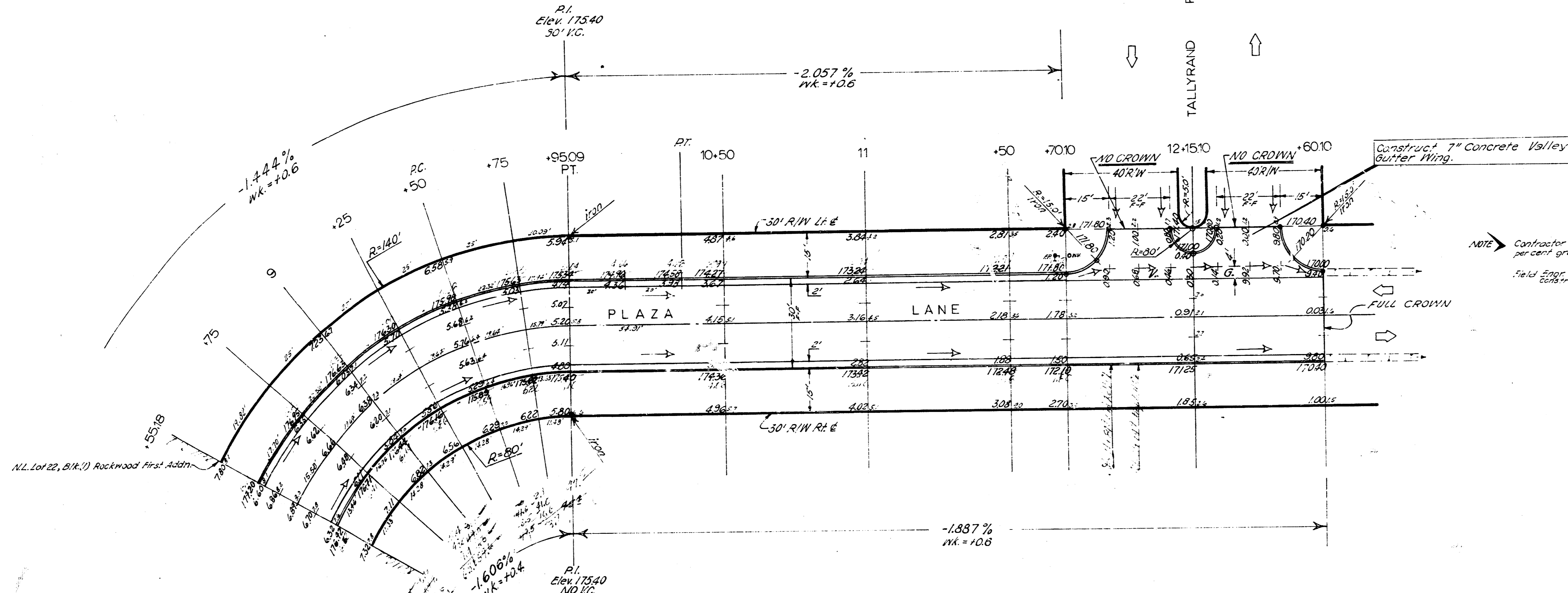
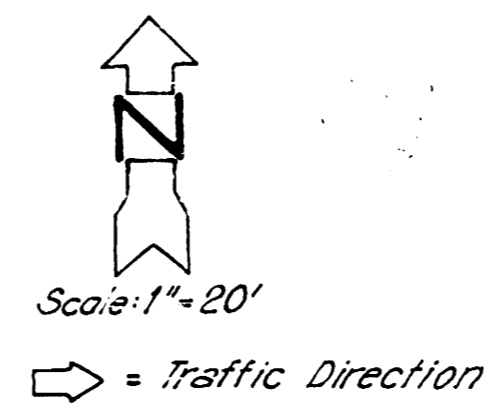

NOTE: Contractor to dig arches east of centerline 100 ft. E.G. + 0.00% percent grade. Field Eng. to cross-section before after construction. 5' or 25' or 50' or 100'.

Curve Data Based on W.I.E. R=140' Δ=90°

Sta	arc	Chord length 3' to 19' 00"	Chord length 19' 00" to 33'	Deflection	Total Deflection
75+45.8	-	-	-	0° 00' 00"	0° 00' 00"
75	19.82'	18.81'	12.31'	4° 03' 21"	4° 03' 21"
9	25'	23.72'	15.52'	5° 06' 56"	9° 10' 17"
25	"	"	"	5° 06' 57"	14° 17' 14"
50	"	"	"	5° 06' 57"	19° 24' 11"
75	25'	23.72'	15.52'	5° 06' 56"	24° 31' 07"
125+09	20.09'	19.07'	12.47'	4° 06' 40"	28° 37' 47"

Deflection per ft. of curve = 12.7167 mins.

EARTHWORK QUANTITIES
 Excavation City
 895.0 173.7
 89.5% 73.1%
 384.5 cu. 730.8 cu.

PLAZA LANE
 NL Co. 22, Blk. 1, Rockwood/Roadin-EL Tallyrand Road
 26'-2'-30" Asphaltic Conc.
City of Wichita, Kansas
 B.E. Smith City Engineer
 Date: June 1962 Design: seal Proj. no. C12-21