

**PLEASANTVIEW CIRCLE**  
**N.L. 18TH STREET NORTH TO & INCLUDING CUL-DE-SAC**

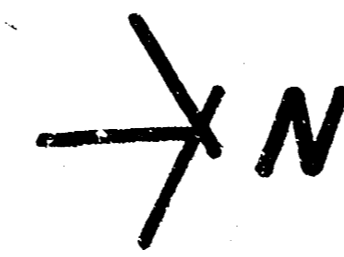

LOCATION MAP  
 1" = 100'

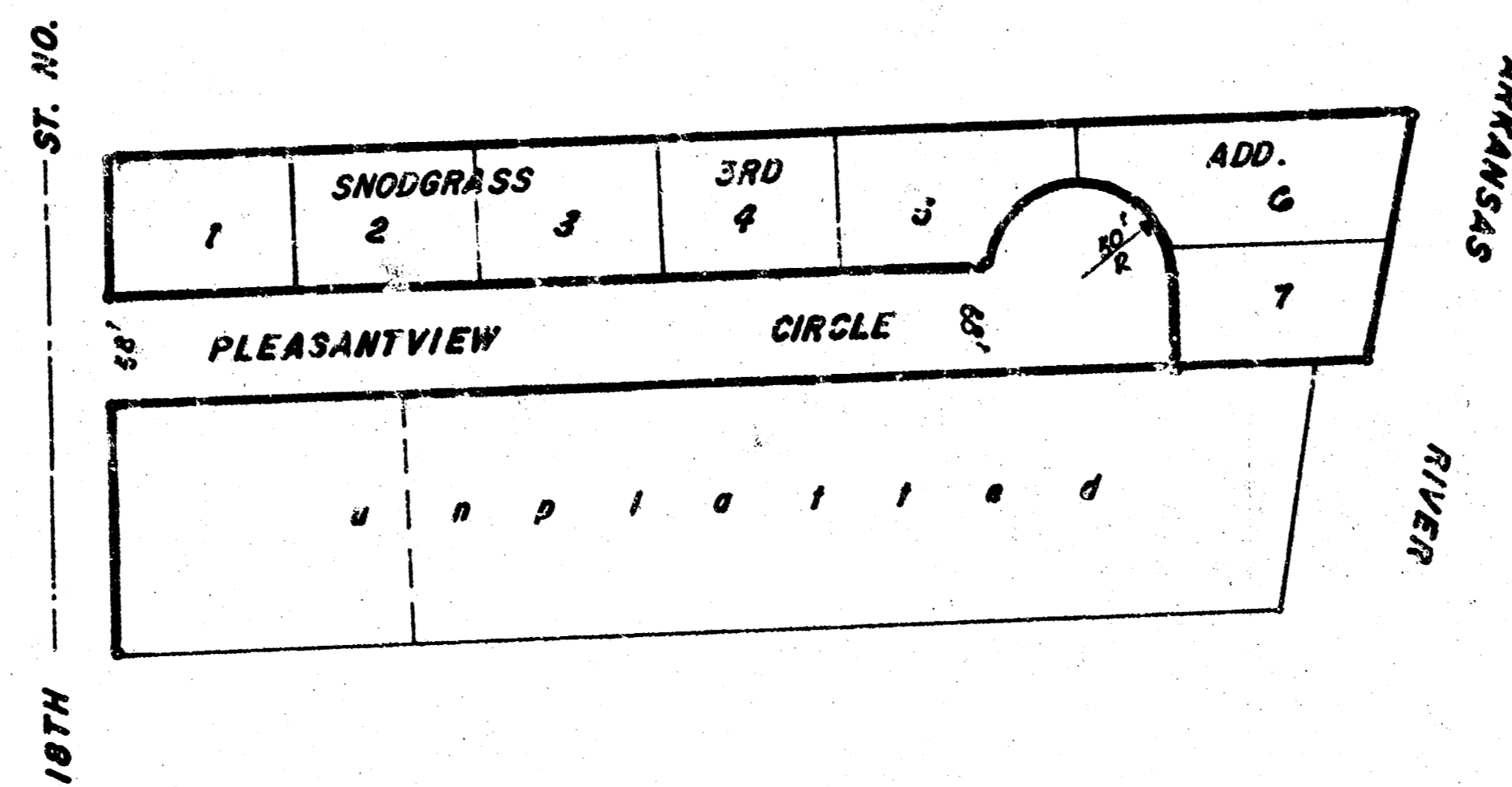

**GENERAL NOTES:**

- (1) CONSTRUCT ROLL-TYPE CURB ON THIS PROJECT. CURBS SHALL BE DEPRESSED THROUGH DRIVES WHEN DRIVES ARE CONSTRUCTED AS A PART OF THIS CONTRACT. NO MORE THAN THIRTY-ONE HUNDRED (3100) SQUARE FEET TO BE CONSTRUCTED WITHIN THIS PROJECT.
- (2) WIDENED CUTTER SECTION OF COMBINED CURB AND CUTTER AT INTERSECTIONS WILL NOT BE PAID FOR DIRECTLY, AND THIS COST SHALL BE CONSIDERED AS SUBSIDIARY TO THE OTHER PAY ITEMS OF WORK.
- (3) MAILBOXES WITHIN THE PROJECT LIMITS SHALL BE REMOVED AND REPLACED BY THE CONTRACTOR AS APPROVED BY THE ENGINEER. CONTRACTOR WILL BE REQUIRED TO MAKE SATISFACTORY PROVISIONS FOR MAIL DELIVERY TO PROPERTIES AFFECTED BY THIS PROJECT DURING CONSTRUCTION.
- (4) CONTRACTOR SHALL GIVE PROPERTY OWNERS ADJUTING THIS PROJECT WHOSE YARDS WILL BE LOWER THAN THE TOP OF THE NEW CURB AN OPPORTUNITY TO UTILIZE EXCESS EXCAVATED MATERIAL FROM THE PROJECT TO REGRADE THEIR YARDS TO DRAIN TO THE NEW PAVEMENT. CONTRACTOR WILL BE REQUIRED TO DUMP AND SPREAD THE EXCESS MATERIAL AS REQUIRED BY THE STANDARD SPECIFICATIONS.
- (5) ANY DRIVEWAY WORK DONE ON PRIVATE PROPERTY SHALL BE AUTHORIZED ON A PROPERLY EXECUTED DRIVEWAY REQUEST FORM.

**CITY OF WICHITA, KANSAS**  
**M.E. LINDEBAK — CITY ENGINEER**  
 PROJECT NUMBER. 472-76-245-80898-000-000-001

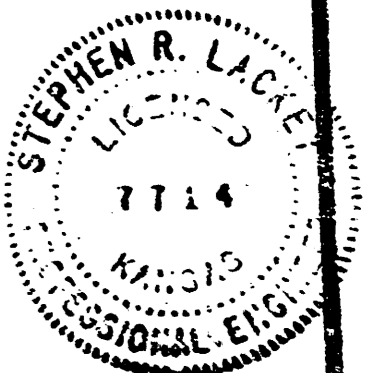

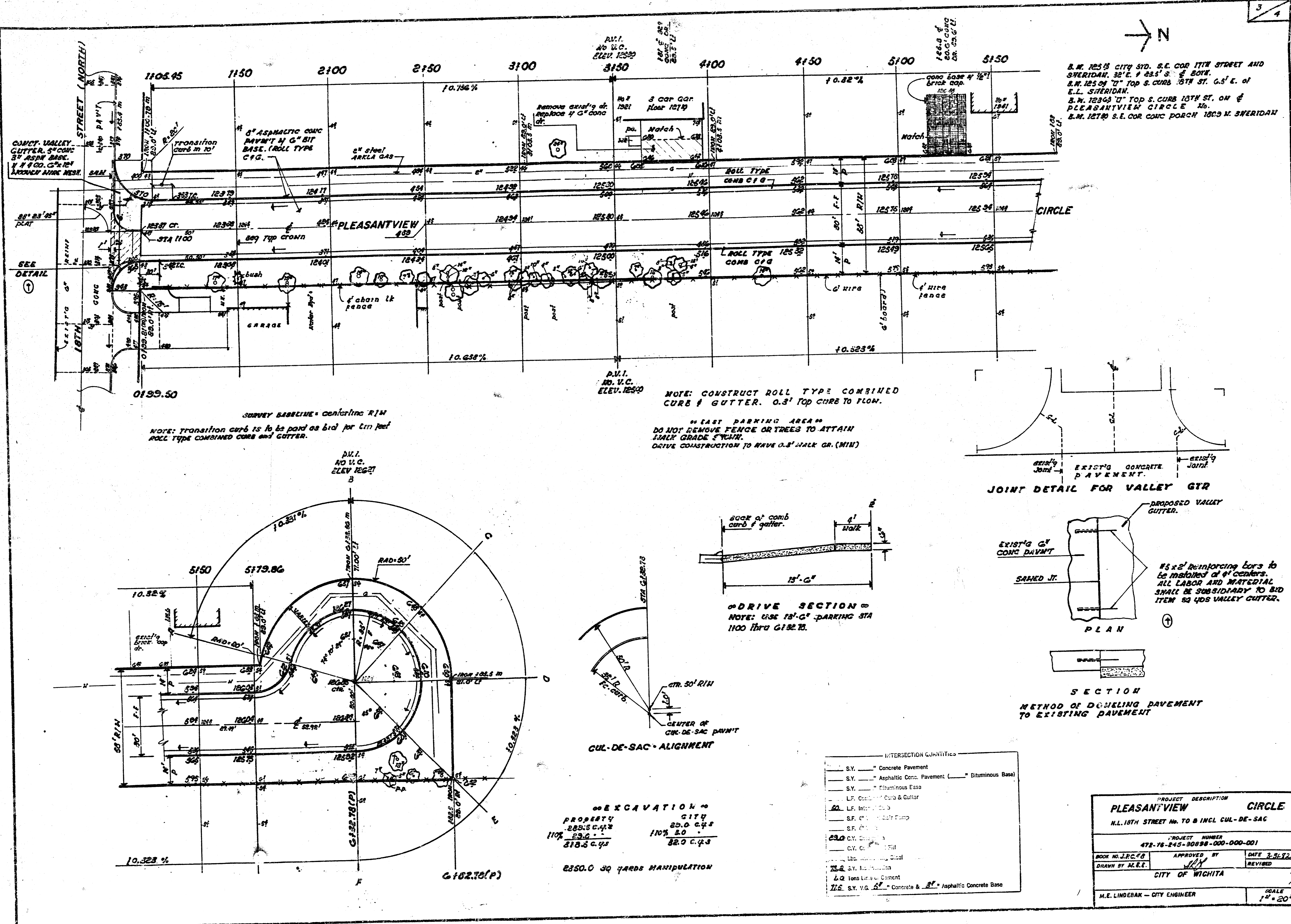

B.M. 12515 CITY STD. S.E. COR 17TH STREET AND SHERIDAN, 32° E. 235' S. 2' 20.4"  
 B.M. 12509 "D" TOP S. CURB 15TH ST. 65' E. of E.L. SHERIDAN.  
 B.M. 12363 "D" TOP S. CURB 15TH ST. ON 6 PLEASANTVIEW CIRCLE 26.  
 B.M. 12780 S.E. COR CONC PORCH 1803 N. SHERIDAN

NOTE: transition curb is to be paid as bid per city spec roll type combined curb and gutter.

NOTE: CONSTRUCT ROLL TYPE COMBINED CURB & GUTTER. 0.3' TOP CURB TO FLOW.

"EAST PARKING AREA"  
 DO NOT REMOVE FENCE OR TREES TO ATTAIN 1% MAX GRADE SYMM.  
 DRIVE CONSTRUCTION TO HAVE 0.5' WALK GR. (MIN)

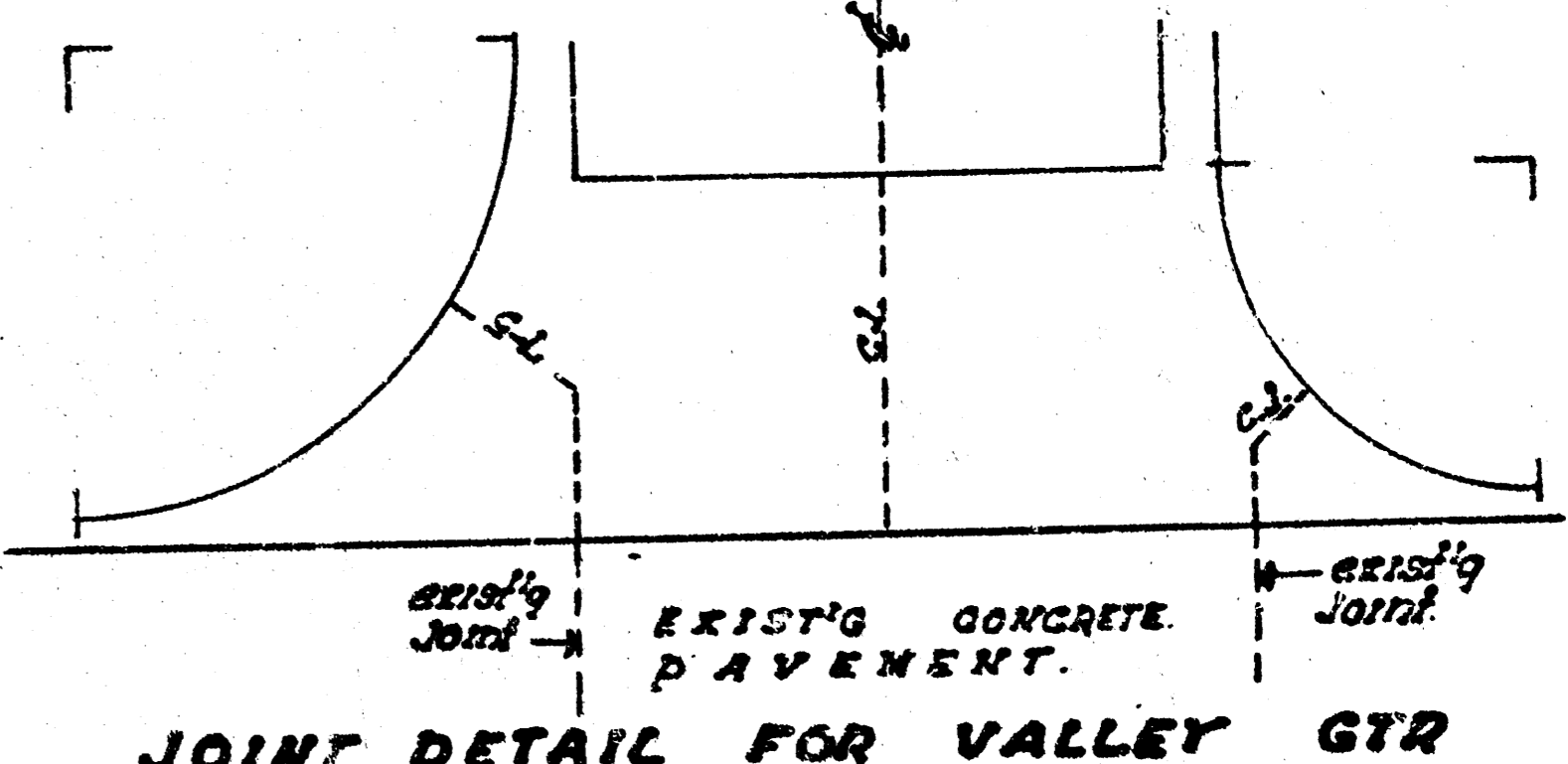

JOINT DETAIL FOR VALLEY GTR

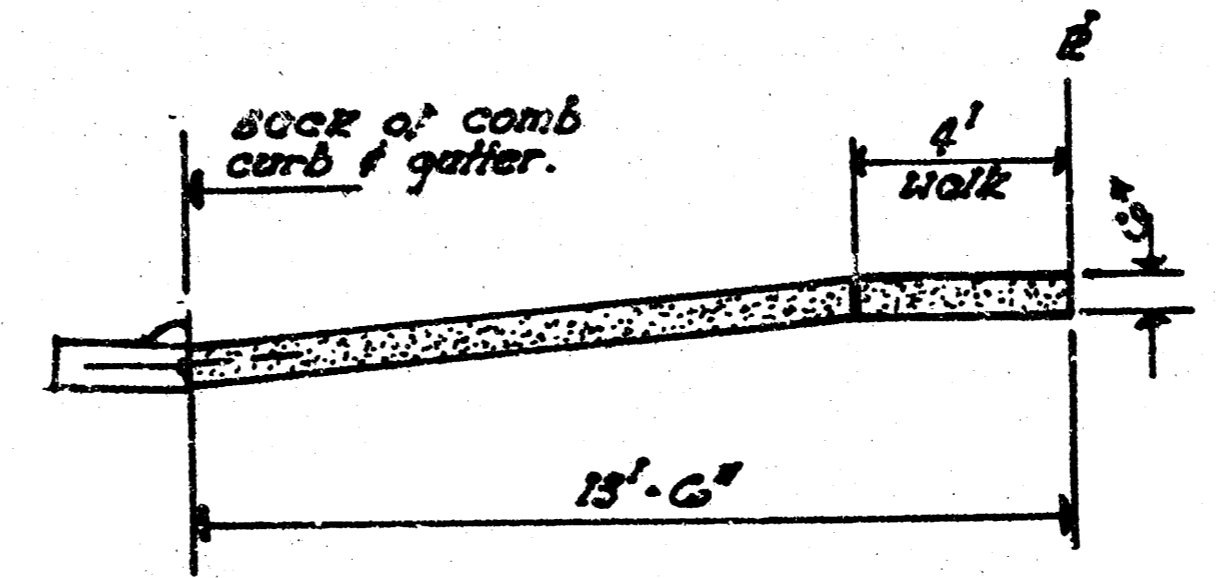

DRIVE SECTION  
 NOTE: USE 13'-6" PAVING STA 1100 THRU 6132.75

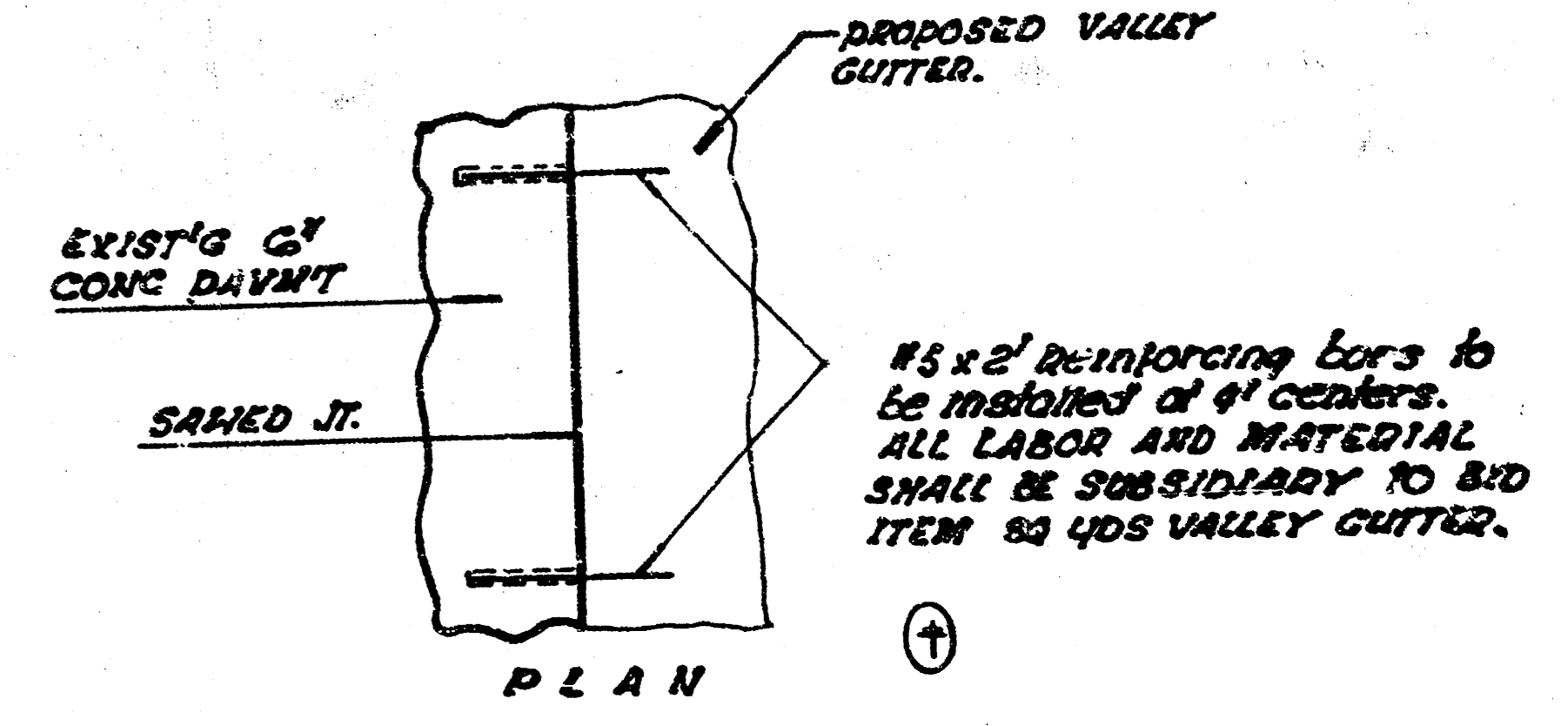

PLAN

SECTION METHOD OF DOING UP PAVEMENT TO EXISTING PAVEMENT

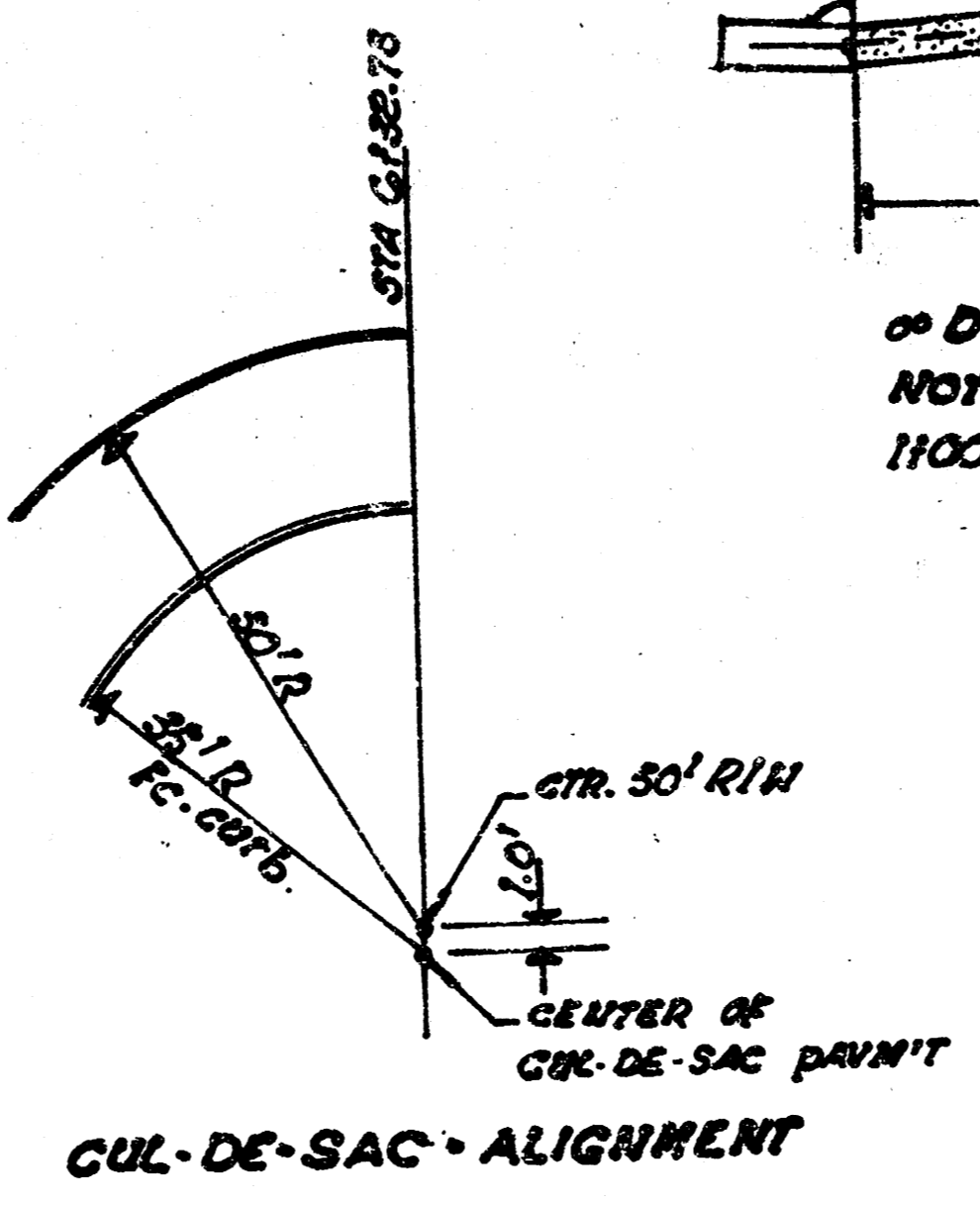
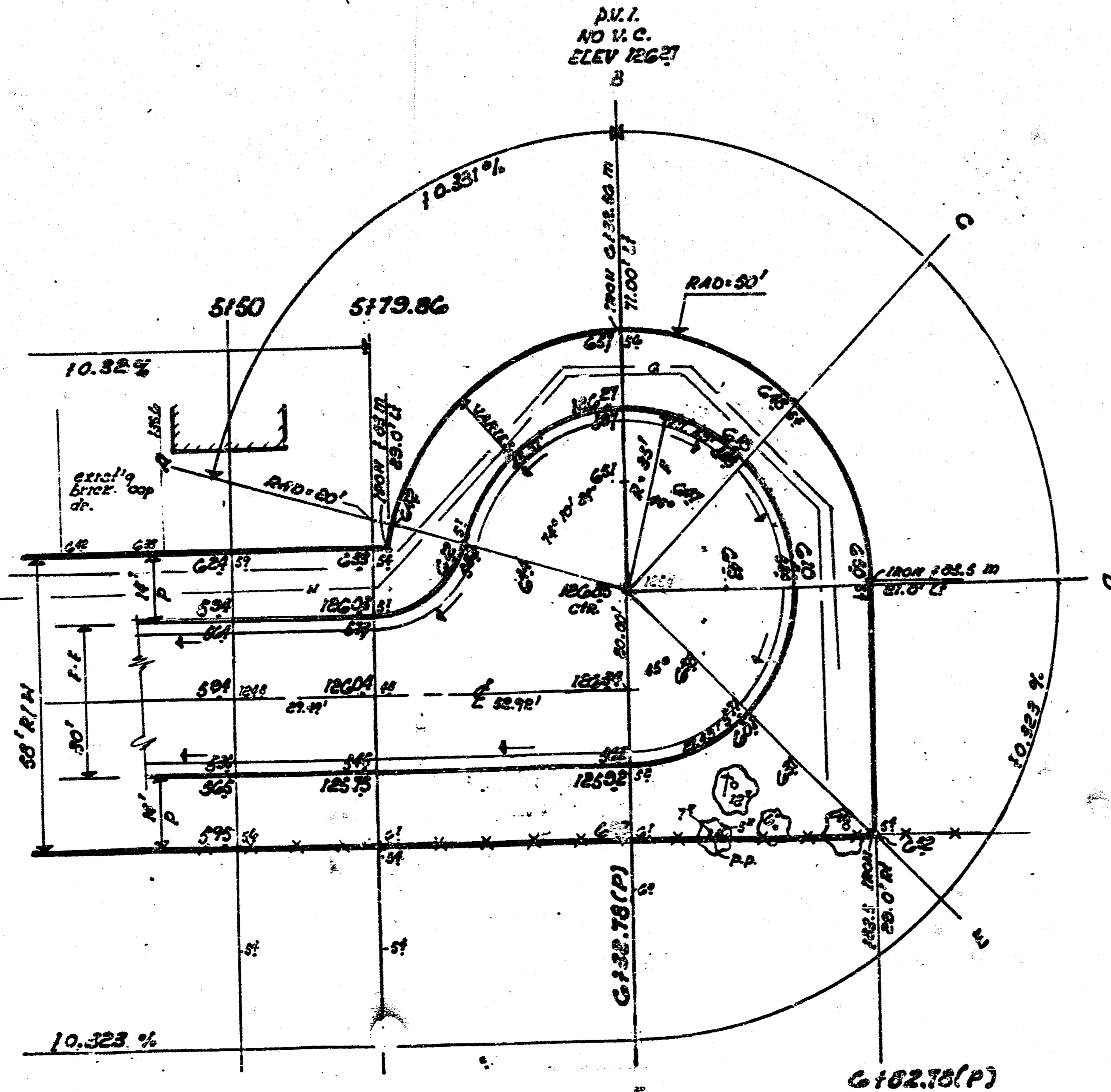

CUL-DE-SAC ALIGNMENT

EXCAVATION  
 PROPERTY 285.5 C.Y.S  
 110% 296.0 C.Y.S  
 215.5 C.Y.S  
 2350.0 30 YARDS MANIPULATION

INTERSECTION QUANTITIES	
5.7	Concrete Pavement
5.7	Asphaltic Conc. Pavement ( 2" Bituminous Base)
5.7	Bituminous Base
5.7	LF. Concrete Curb & Gutter
5.7	LF. Inter. Curb
5.7	S.F. 4" x 4" Manhole
5.7	S.F. 24" x 24" Manhole
5.7	C.Y. Concrete
5.7	C.Y. Cement
5.7	Lib. Manhole
5.7	S.Y. Manhole
5.7	2.0 Tons Lime Cement
11.4	S.Y. V.G. 3" Concrete & 3" Asphaltic Concrete Base

PROJECT DESCRIPTION	
<b>PLEASANTVIEW CIRCLE</b>	
N.L. 18TH STREET No. TO 8 INCL CUL-DE-SAC	
PROJECT NUMBER 472-76-245-30898-000-001	
BOOK NO. J.R.C. 48	APPROVED BY [Signature]
DRAWN BY M.E.E.	DATE 3-28-52
CITY OF WICHITA	
M.E. LINDEBAK - CITY ENGINEER	SCALE 1" = 20'

Survey 22400 M.L.P.C. 4/6  
 Plan 21-5-52  
 E.L.  
 Checked

# TYPICAL 31' PAVEMENT DETAILS

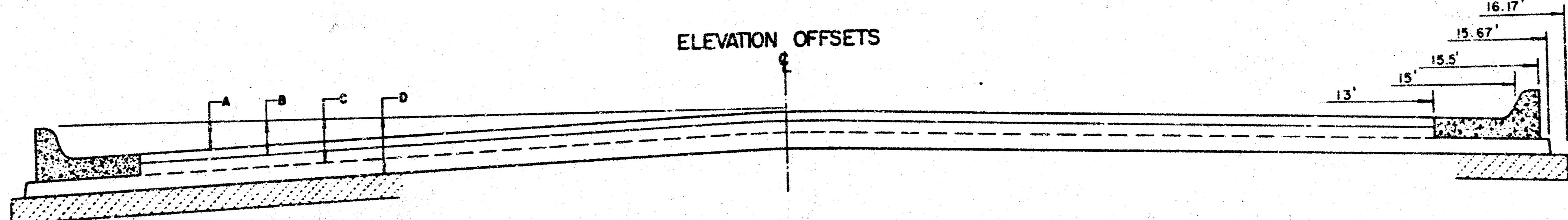
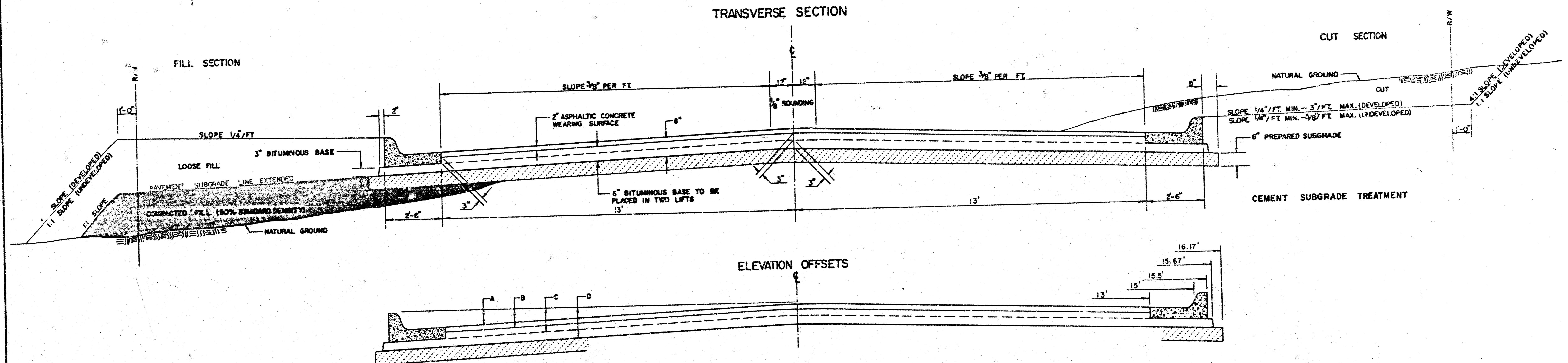

	DISTANCE FROM CENTERLINE (LT. & RT.)												
	0'	2'	4'	6'	7.5'	10'	12'	15'	15.5'	15.67'	16.17'		
TOP OF CURBS TO TOP OF SURFACE LIFT	.10	.14	.21	.27	.32	.39	.46	.49	---	---	---	---	---
TOP OF CURBS TO TOP OF ASPHALTIC CONCRETE WEARING SURFACE	.27	.31	.37	.44	.48	.56	.62	.65	---	---	---	---	---
TOP OF CURBS TO TOP OF LOWER BASE LIFT	.52	.56	.62	.69	.73	.81	.87	.90	.97	.98	.99	---	---
TOP OF CURBS TO TOP OF SUBGRADE	.77	.81	.87	.94	.98	1.06	1.12	1.15	1.22	1.23	1.24	1.25	---

### COMBINED CURB & GUTTER

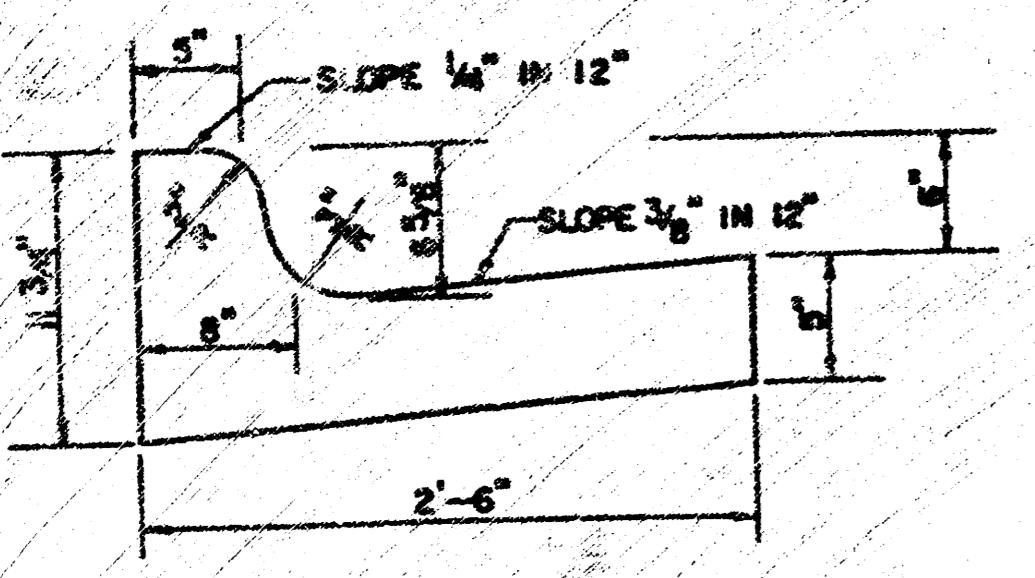

### ROLL TYPE COMBINED CURB & GUTTER

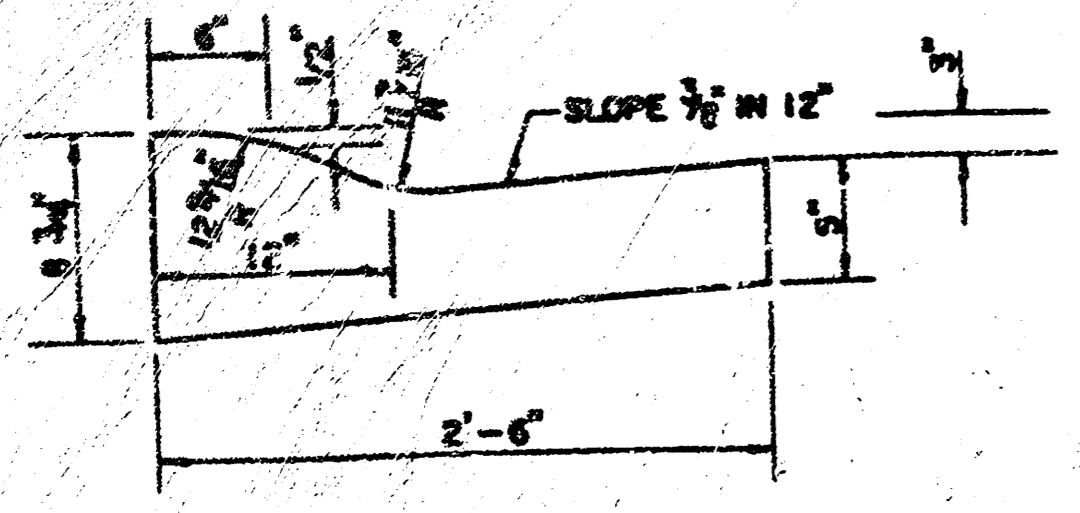

### GENERAL NOTES

- 1) THE ASPHALTIC CONCRETE PAVEMENT BETWEEN THE COMBINED CURB AND GUTTER SHALL BE PAID AS SQUARE YARDS OF 8" ASPHALTIC CONCRETE (6" BITUMINOUS BASE).
- 2) THE BITUMINOUS BASE UNDER AND BEHIND THE COMBINED CURB AND GUTTER SHALL BE PAID AS SQUARE YARDS OF 3" BITUMINOUS BASE.
- 3) A TACK COAT OF EMULSIFIED ASPHALT (SC-1H OR CSS-1H) SHALL BE APPLIED AT AN APPROXIMATE RATE OF 0.05 GALLONS PER SQUARE YARD BETWEEN EACH LIFT OF ASPHALTIC MATERIAL.
- 4) BITUMINOUS BASE AND ASPHALTIC CONCRETE WEARING SURFACE SHALL BE PLACED WITH A LAYDOWN MACHINE HAVING AUTOMATIC CONTROLS FOR LINE AND GRADE.
- 5) CONSTRUCTION JOINTS IN EACH LIFT SHALL BE STAGGERED A MINIMUM DISTANCE OF ONE (1) FOOT FROM JOINTS IN PRECEDING LIFTS AND PLACED SO THAT A JOINT WILL BE CONSTRUCTED ON THE CENTERLINE OF THE TOP LIFT.
- 6) CONTRACTOR TO BID ONLY ONE SUBGRADE TREATMENT ALTERNATE WHEN ALTERNATES ARE PROVIDED IN THE PROPOSAL AND CONTRACT. THE ALTERNATE CHOSEN BY THE SUCCESSFUL BIDDER SHALL BE USED IN CONSTRUCTING THIS PROJECT.

### TRANSVERSE CONSTRUCTION JOINTS

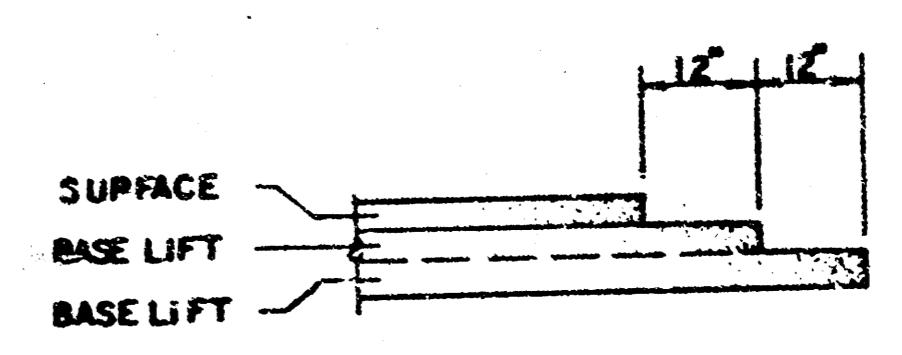

TRANSVERSE CONSTRUCTION JOINTS SHALL BE CONSTRUCTED IN FLEXIBLE BASE PAVEMENTS AT LOCATIONS WHERE PAVEMENT JOINTS EXISTING FLEXIBLE BASE PAVEMENT AS SHOWN BY THE DETAIL. ALL COSTS ASSOCIATED WITH THE CONSTRUCTION OF THE TRANSVERSE JOINT SHALL BE INCLUDED IN THE BID PRICE FOR SQUARE YARDS OF ASPHALTIC CONCRETE (6" BITUMINOUS BASE).

8 INCH RESIDENTIAL ASPHALTIC CONCRETE PAVEMENT WITH 6 INCH BITUMINOUS BASE  
**CITY OF WICHITA, KANSAS**  
 PROJECT NUMBER  
 472-76-245-80898-000-000-001

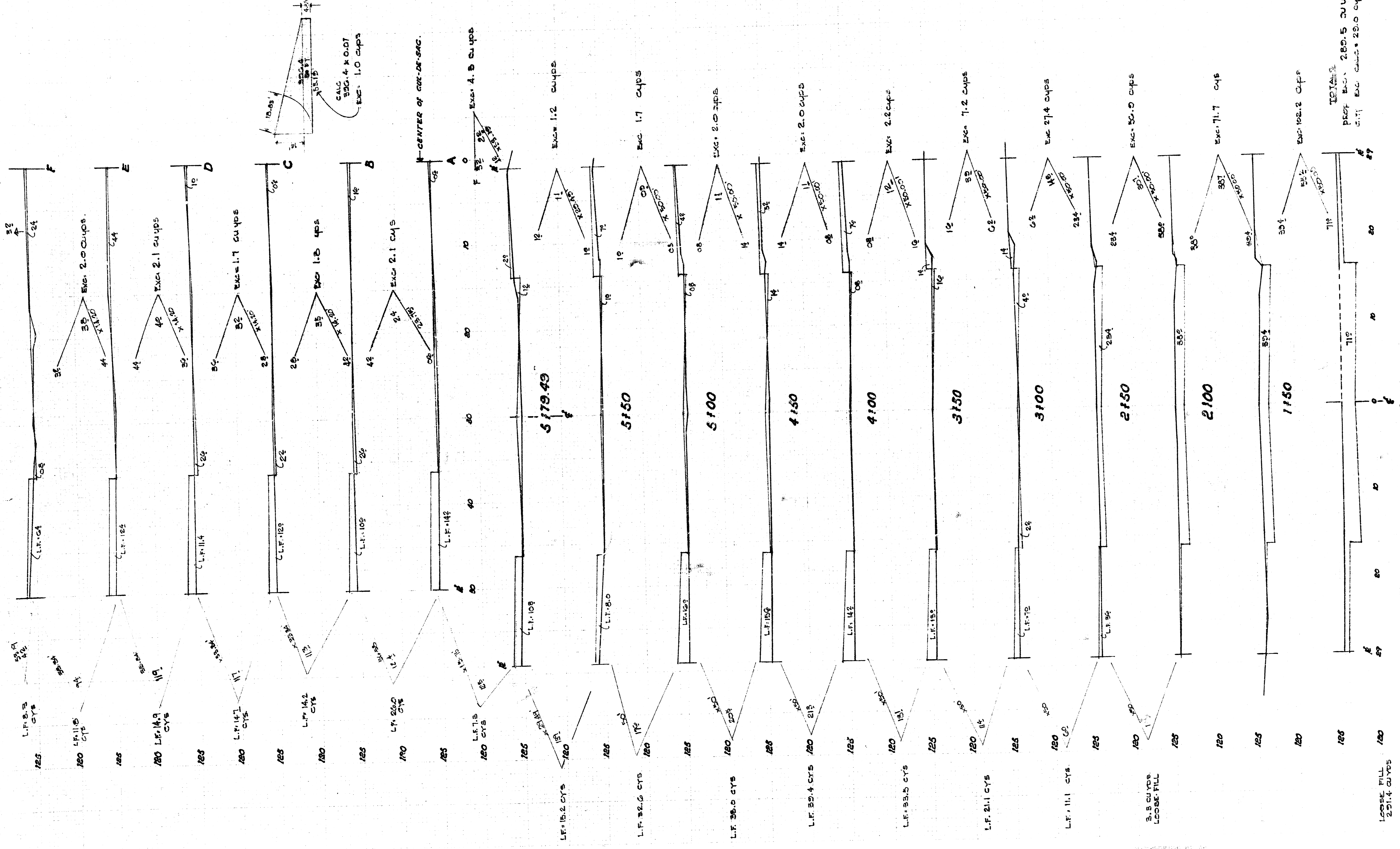

PLEASANTVIEW CIRCLE  
 N.E. 1874 STREET W. TO AND INCL CORNER-SAC

TOTALS  
 PROF. EXC. 280.5 cu yds  
 CITY EXC. 28.0 cu yds