

Sheet No. 1169
 Date: 5/15/68
 City Engineer
 B.E. Smith

Scale: 1"=20'

B.M. 150.93 N.E. corner concrete porch House # 7511 W. 11th Street.

B.M. 149.18 "0" cut top west curb Dunsworth & S.L. Ponderosa.

NOTE:
 Depress curb through driveways.

NOTE:
 Contractor to clear right-of-way and grade parking for proposed sidewalk.
 Sidewalk to be constructed by others.

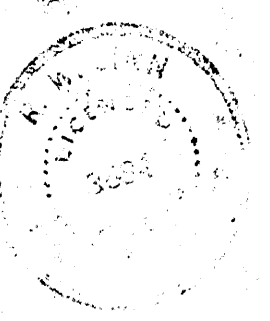
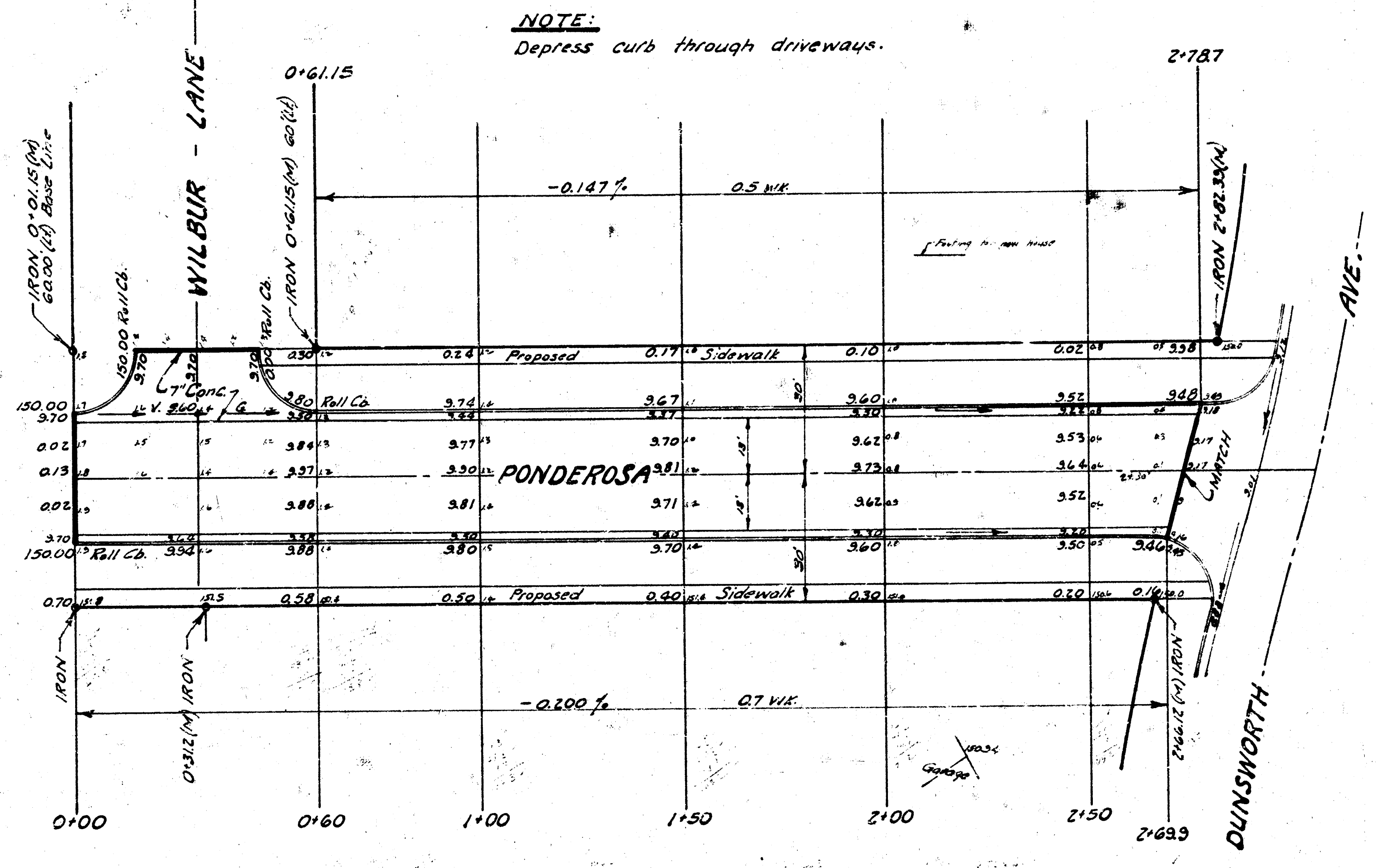

EXCAVATION

PROPERTY	CITY
851 Cu.Yds.	124 Cu.Yds.
+10% 85	12
Totals 336 Cu.Yds.	136 Cu.Yds.

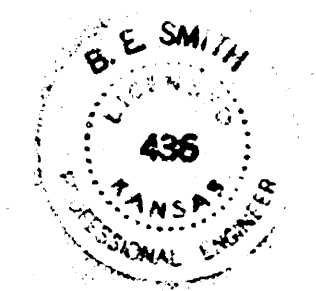
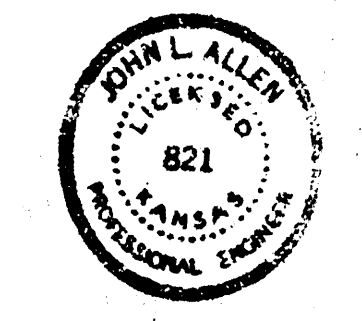

PONDEROSA STREET
 From W.L. WILBUR LANE
 to W.L. DUNSWORTH AVE.
 26-2-30 Asph. Conc.
 B.E. SMITH CITY ENGINEER
 CITY OF WICHITA KANSAS
 Date: MAY 1968
 Project No. C18-38