

Baseline is 95 ft W of \perp Poplar, being 3 ft E. of original W.L. of Poplar.

BM 116.48' Top N.W. cor. Derby sign E. Grove S. E. of alley 180' N. of \perp Central
 BM 117.74' R' in R' curve top cb. E. return S.E. cor. Central - Poplar.
 BM 119.26' R.R. spk. N. face P.P. 22' S. of \perp 3rd E. \mp 75' E. of \perp Poplar South.

TRNGR TO FOLLOW NEW
 ASPH SPEC BOOK IN
 SETTING NEW STREET
 RAMP-TYPE APPROACH

Scale 1" = 20'

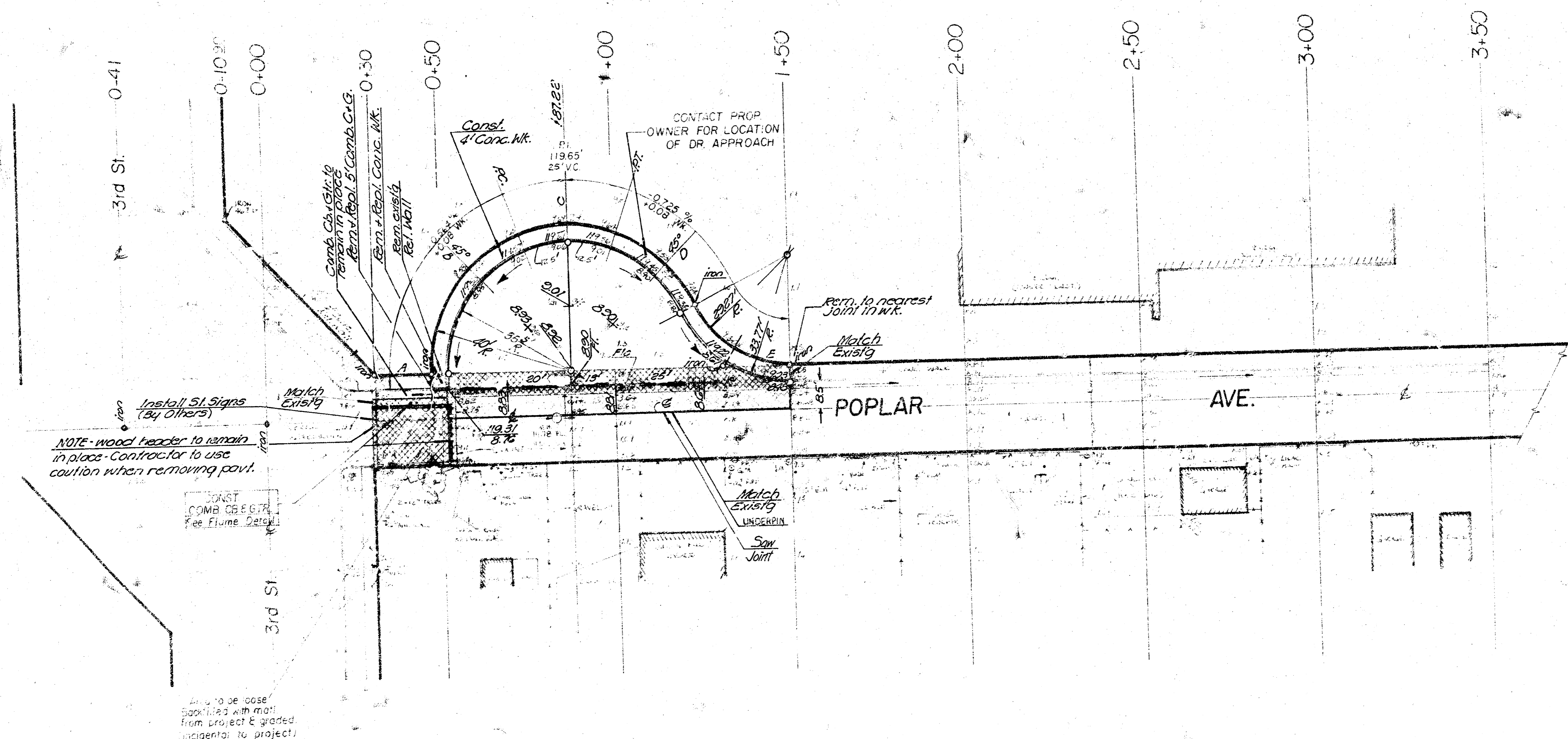

Survey MARKS
 Plan WITTEN
 Exc. " "
 Checked " "

6" conc
 4" int. cb.
 6" Poplar
 Street
 mb. C.G.
 to Existing
 front

= Removal

NOTE: Construction To Allow For
 (1) Drive, 24' Ft. Opening.

EARTHWORK QUANTITIES	
Property	
Excavation	106.6 CY
+10%	10.7 CY
Total	117.3 CY

MANIPULATION	
Property	
	372.3 S.Y.

SUB-GRADE
 TYPE OF SUB-GRADE TREATMENT SHALL BE DETERMINED BY THE FIELD ENGINEER. SUB-GRADE TREATMENT MAY CONSIST OF LIME TREATMENT, CEMENT TREATMENT, SUB-GRADE MODIFICATION, OR ANY COMBINATION OF THESE.

NOTE TO FIELD ENGINEER & CONTRACTOR
 Grade parking and clear right-of-way for proposed sidewalk. Compod fill in sidewalk area. TO BE CONSTRUCTED BY "OTHERS".

POPLAR AVE. CUL-DE-SAC
 NL 3rd ST. AT LOT 1, MARY JANE SULLIVAN ADDT'N
CITY OF WICHITA, KANSAS
 R.W. LINN CITY ENGINEER
 6" CONC. PAVEMENT WITH INT. CB.
 DATE:
 PROJECT NO. // DAKS 574111

FILMED FROM THE BEST AVAILABLE COPY.....