

B.M. 129.43 Fire Hydrant S.E. Corner Redbud & Cardinal
 B.M. 129.64 S.W. Corner Conc. Porch to House at 2938 Columbine
 @ is @ Redbud

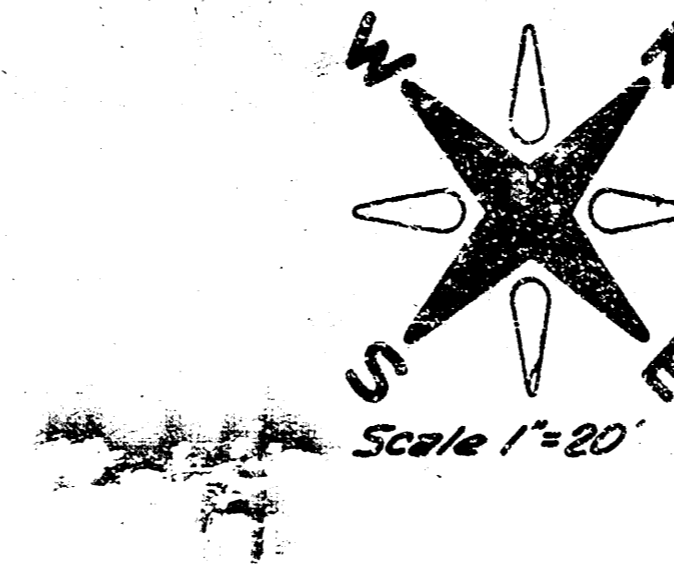

Constr. Roll Type Comb. Cl. & Gr. on this project

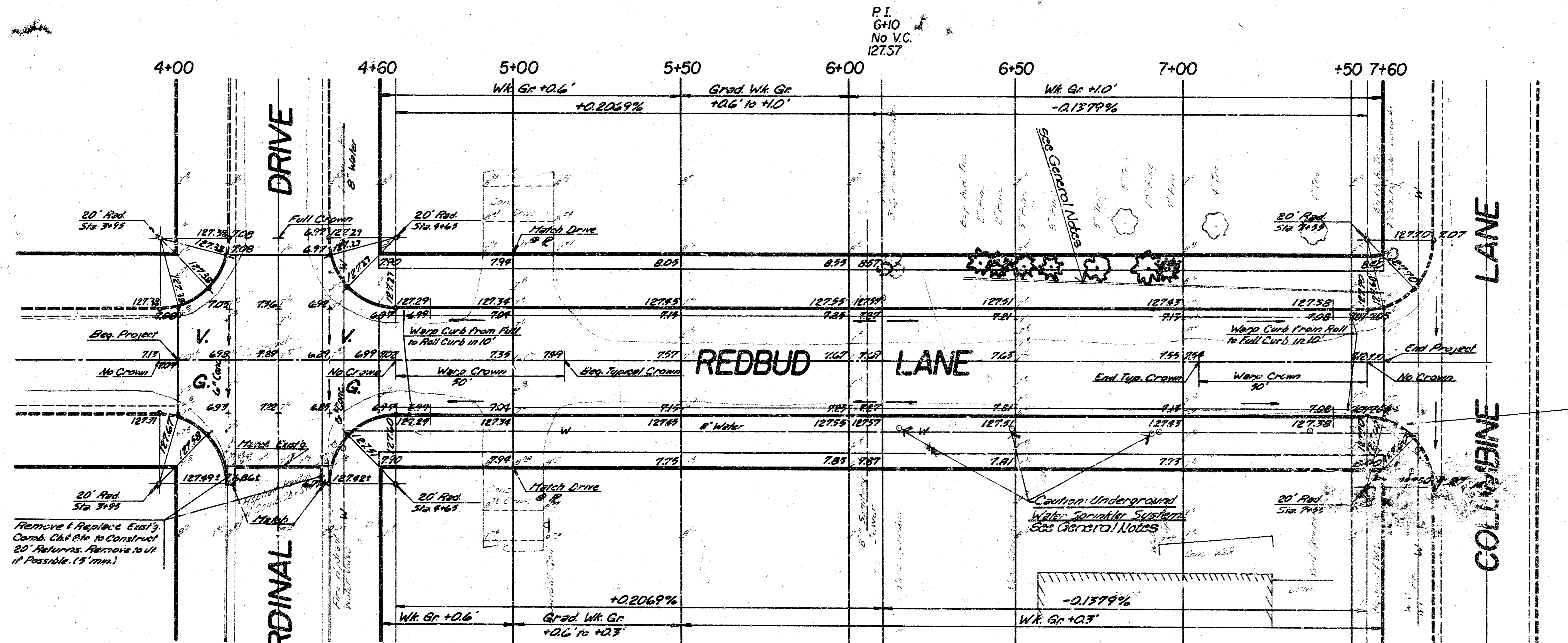

Remove & Replace Existing
 Curbs, Cl. & Gr. to Construct
 20' Returns. Remove to ut
 if Possible. (5 min.)

CARDINAL DRIVE

COLUMBINE LANE

REDBUD LANE

General Notes

1. Any Asphalt Disturbed During Curb & Gutter Removal is to be Replaced. Incidental to Ch. 15th Removal.
2. Treatment Curbs & GUTTER is to be Performed at the Corner Cl. & Gr.
3. Contractor is to Contact Property Owners for Removal of R.R. Ties and Sprinkler System.
4. Trees to be Removed are Marked thus (X) Except that any Tree Which in the Opinion of the Engineer can be Saved Shall be Saved.

EARTHWORK		
	Property	City
Excavation	247.4	92.4
+10%	24.7	9.2
Total	272.1 C.Y.	101.6 C.Y.
Comp. Fill	11.5	0.0
+10%	1.6	
Total	13.1 C.Y.	
Manipulation (calc.)	1100.0 S.Y.	351.6 S.Y.

SUB-GRADE
 TYPE OF SUB-GRADE TREATMENT SHALL BE DETERMINED BY THE FIELD ENGINEER. SUB-GRADE TREATMENT MAY CONSIST OF LIME TREATMENT, CEMENT TREATMENT, SUB-GRADE MODIFICATION, OR ANY COMBINATION OF THESE.

NOTE TO FIELD ENGINEER & CONTRACTOR
 Clear parking & clear right-of-way for proposed excavation. Compact fill in sidewalk areas to be constructed by "OTHERS".

Redbud Lane
 S.L. Cardinal - S.L. Columbine
 DAKS566054
 472 76 245 80018 000 000 001

REDBUD LANE
S.L. CARDINAL - S.L. COLUMBINE
DAKS566054

TYPICAL SECTIONS of 30' ASPHALTIC CONCRETE PAVEMENT

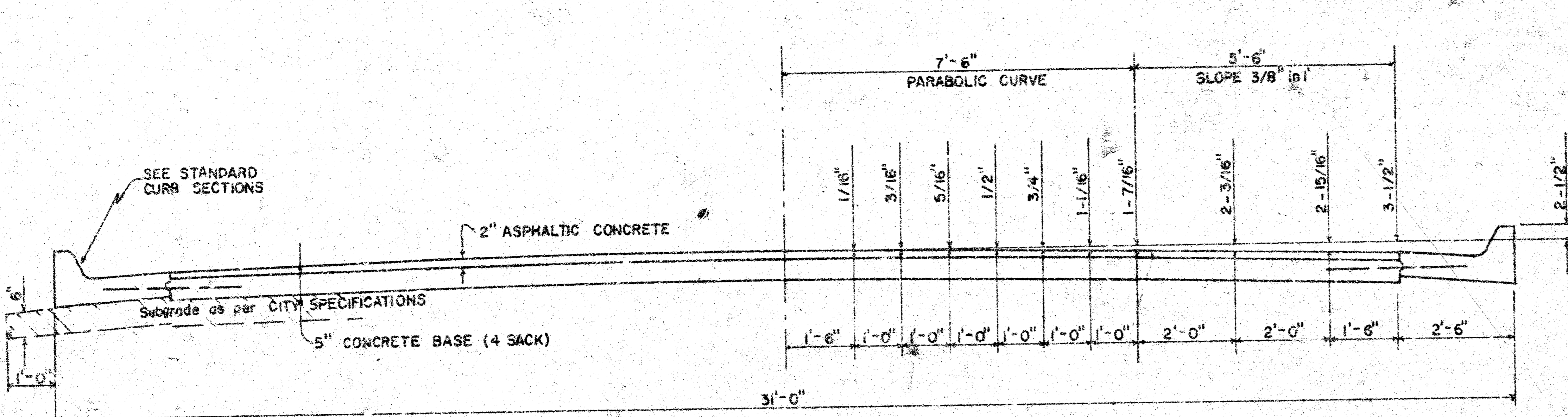

TYPICAL SECTION WITH STANDARD CROWN

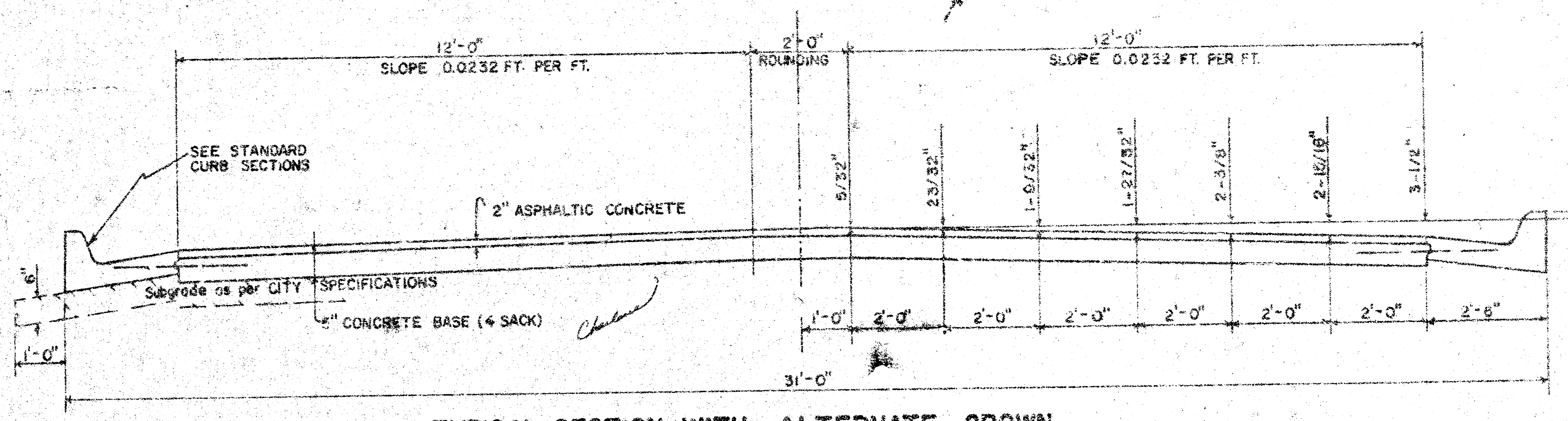

TYPICAL SECTION WITH ALTERNATE CROWN

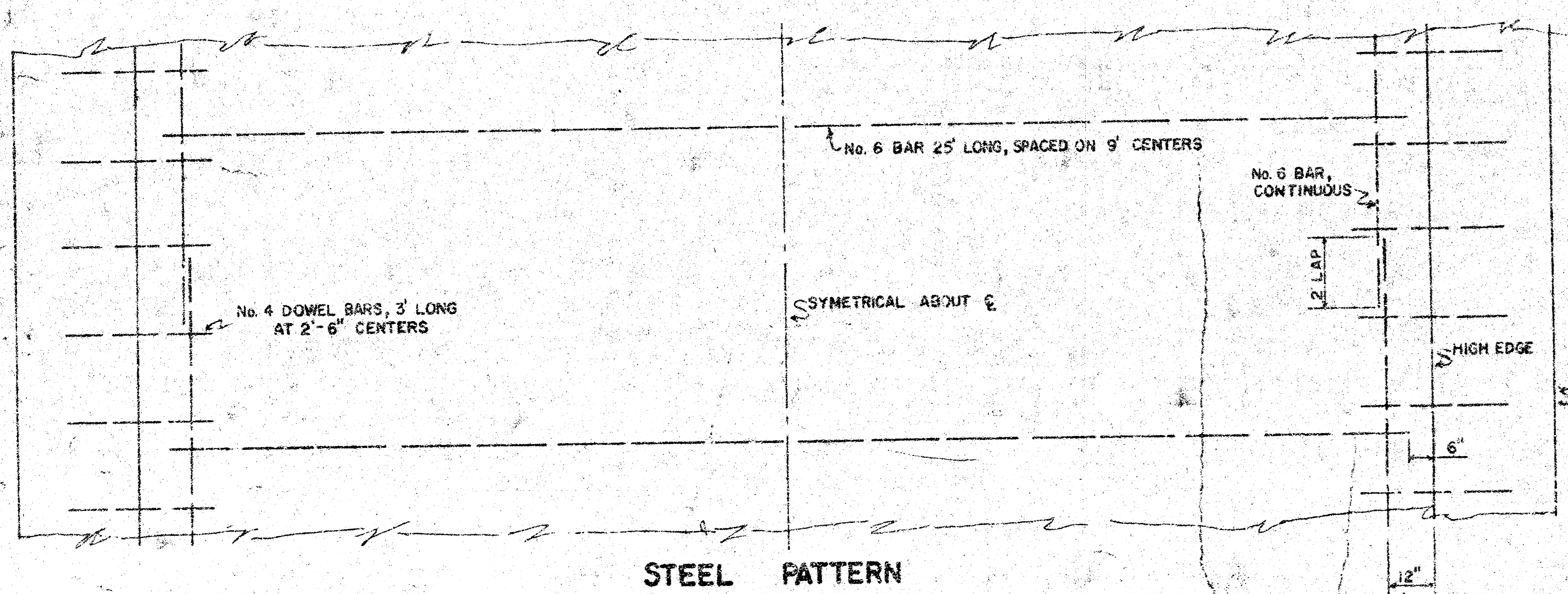

STEEL PATTERN

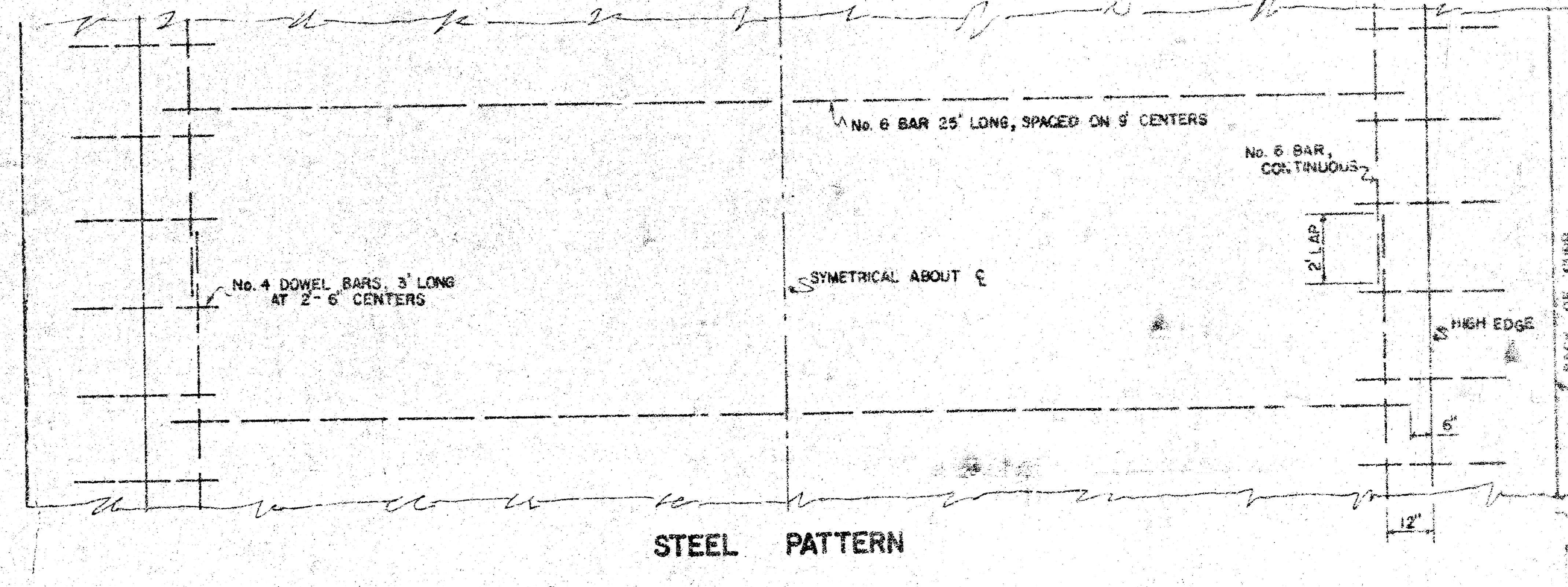

STEEL PATTERN

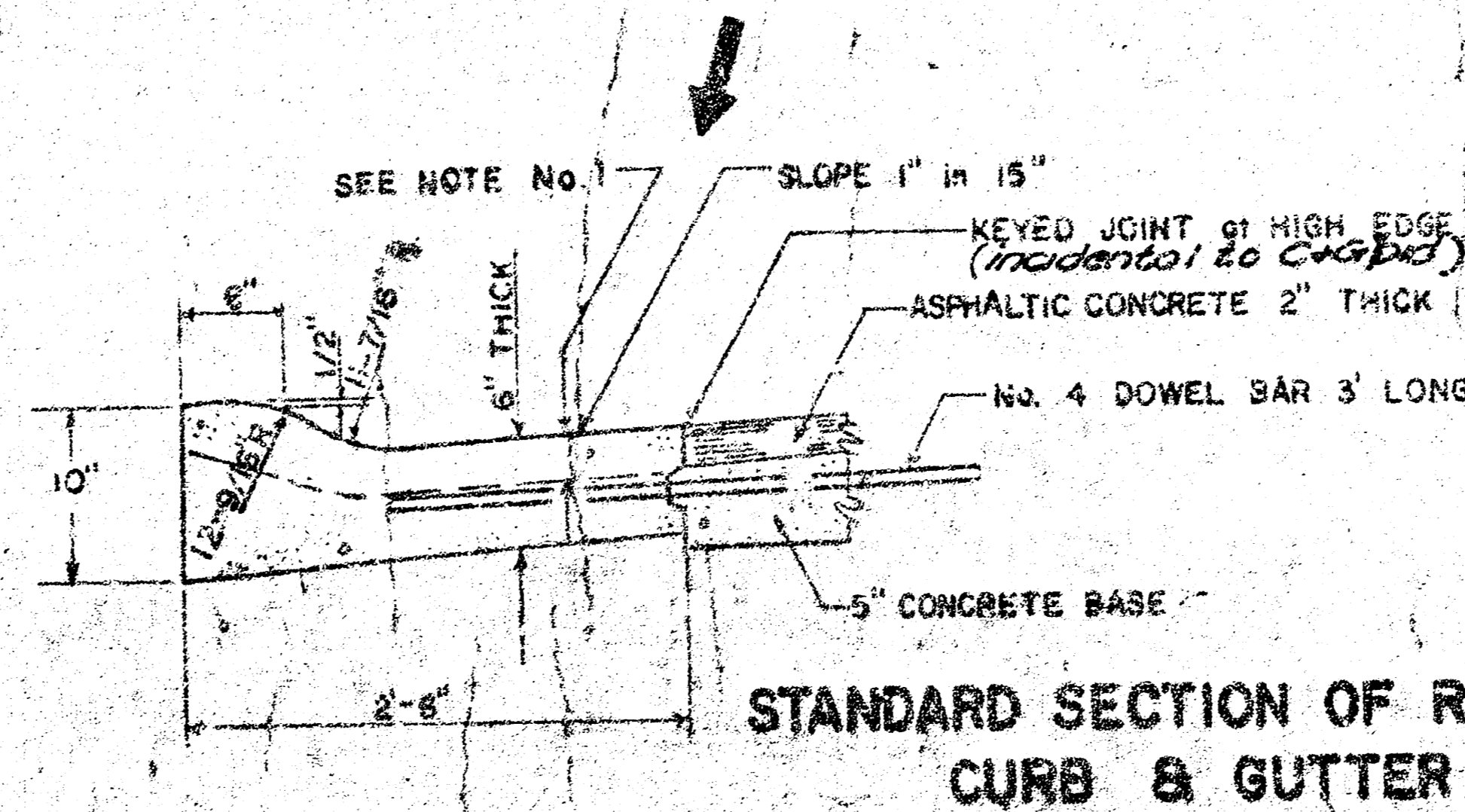
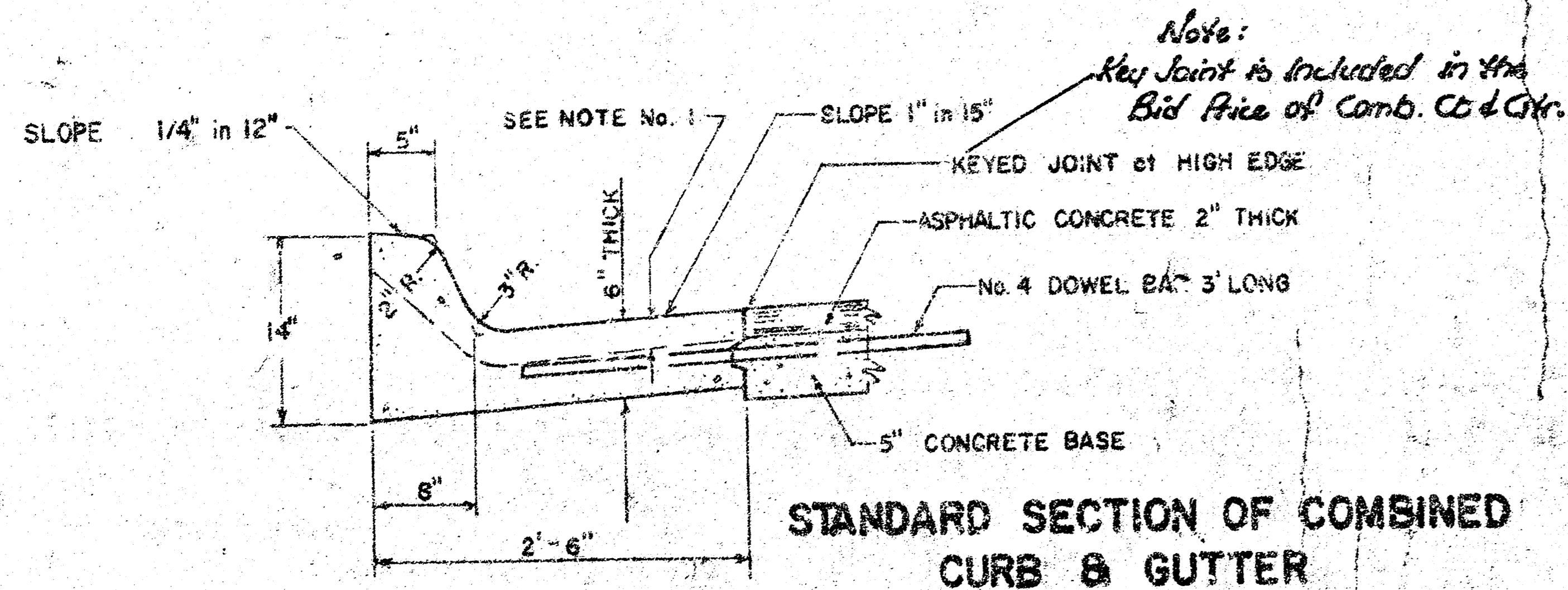

GENERAL NOTES

- CONTRACTION JOINTS MAY BE CONSTRUCTED IN COMBINED CURB AND GUTTER BY SAWING WITH AN APPROVED CONCRETE SAW. THE SAW CUT SHALL EXTEND 2-1/2" BELOW THE SURFACE OF THE GUTTER AND CURB. SAWED CONTRACTION JOINTS SHALL HAVE A MAXIMUM SPACING OF 10' AND BE FILLED WITH A SPECIFIED JOINT FILLER, SUCH THAT THE JOINT IN THE GUTTER SECTION WILL BE COMPLETELY FILLED.

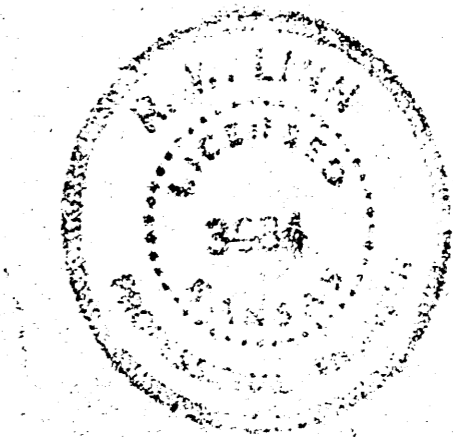

CITY OF WICHITA, KANSAS
 Department of Public Works - Engineering Division
 R.W. Linn, City Engineer
 Date: _____
 Project No. **DAKS566054**
 472 76 245 80018 000 000 000