

B.M. 127.05 2" in E. Riv. Me. U. Co. Wilson, E.L. Richmond  
 B.M. 128.55 2" in E. Riv. Me. E. Co. Richmond, N.L. 24"  
 B.M. 129.79 N.E. Cor. Park # 2603 S.W. Cor. Richmond & Columbine  
 B.M. 126.25 # 60 Spike E. 3. PP. W.S. Richmond & N.L. Benjamin Hills 2nd Addn.  
 B.M. 129.72 Step Bench PP. S. Meridian & E. 24th St.  
 B.M. 129.63 # 60 Spike E. 3. PP. W.S. Richmond 1/2 S. of Manhattan  
 Stationing on E.R.

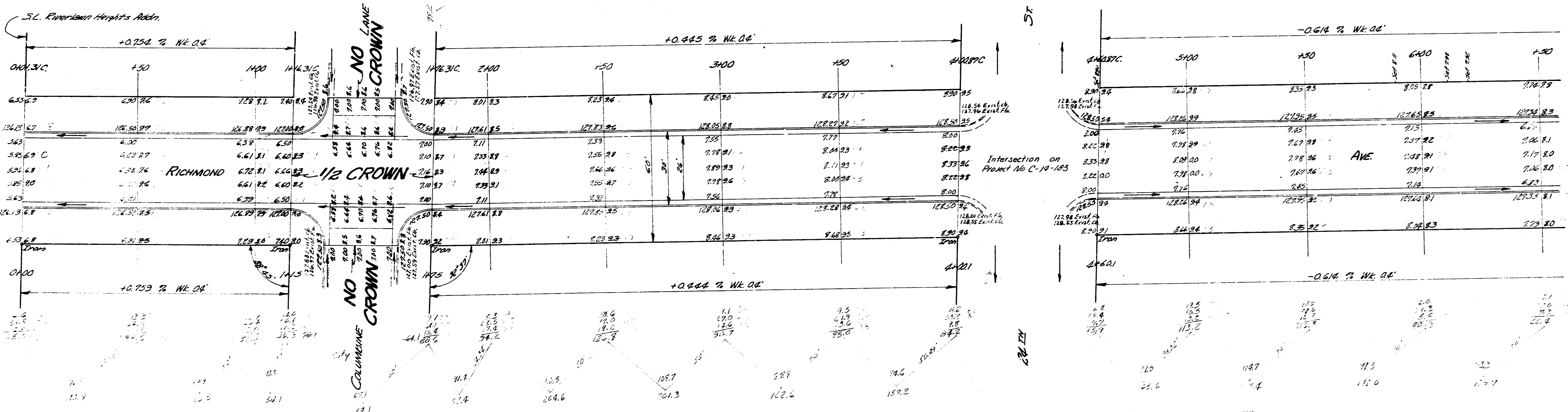

**RICHMOND**  
 S.L. RIVERLAWN HEIGHTS ADDN TO S.L. 25<sup>th</sup>  
 26-2-30 A.C.  
 CITY OF WICHITA KANSAS  
 B. E. SMITH CITY ENGINEER  
 Aug. 1936 Per. No. CM-181

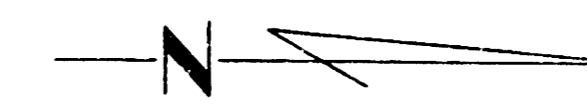
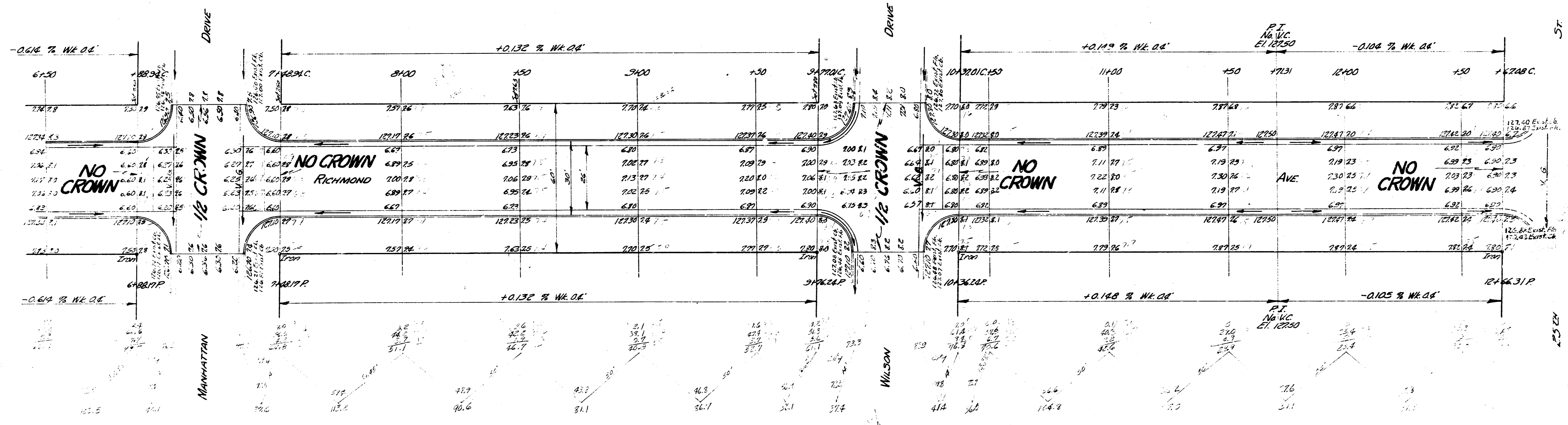
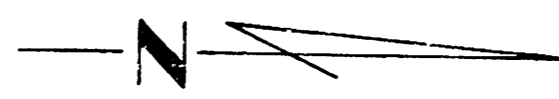

RICHMOND  
Plan No. CH-181  
(6/2)