

B.M. = .2108 SE cor 1st step Ho. NW cor. 15th Meridian
 Stationing on Center Line - Retain 113.1'

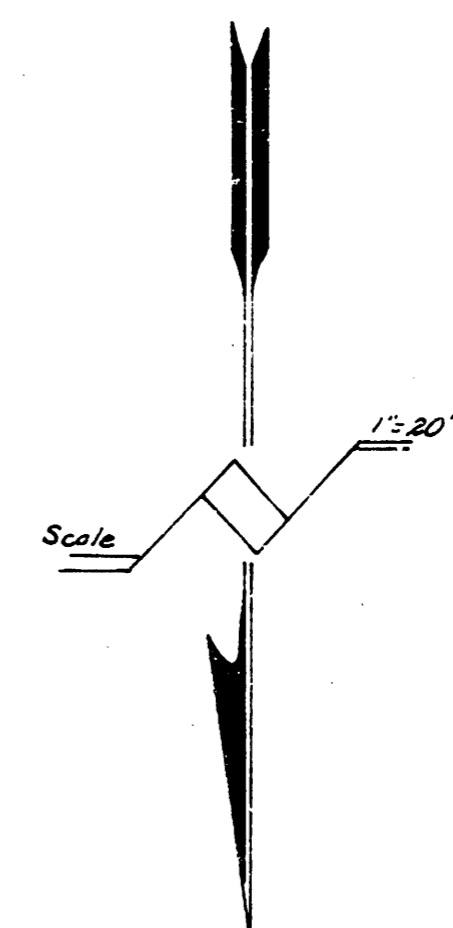
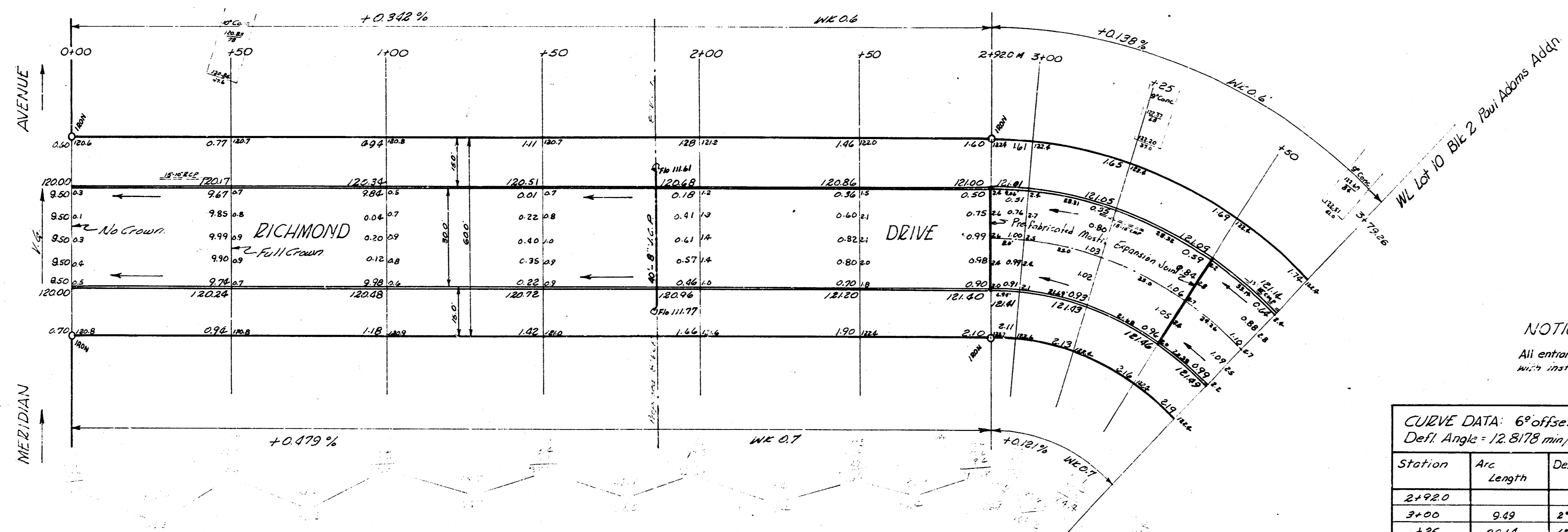

NOTICE TO CONTRACTOR:-
 All entrance pipes are to be disposed of in accordance with instructions of the City Dirt Checker

CURVE DATA: 6' offset W curb - $R=134.1'$ $\Delta=88^{\circ}24'30''$
 Defl Angle = 12.8178 min/frac. Stationing on E.

Station	Arc Length	Deflection Angle	Total Deflection	Chord length 6' offset W.C.	Chord length 6' offset E.C.
2+92.0					
3+00	9.69	2° 01' 38"	2° 01' 38"	9.68	6.52
+25	29.62	6° 19' 55"	8° 21' 33"	29.58	20.32
+50	29.62	6° 19' 55"	14° 41' 28"	29.58	20.32
+79.86	36.69	7° 28' 39"	22° 06' 07"	36.59	23.76
4+00	24.59	5° 15' 11"	27° 21' 18"	24.55	16.96
+25	29.62	6° 19' 55"	33° 41' 13"	29.58	20.32
+50	29.62	6° 19' 55"	40° 01' 08"	29.58	20.32
4+65	19.58	4° 10' 58"	44° 12' 06"	19.56	13.62

RICHMOND DRIVE
 WL Lot 10 B1E2 Paul Adams Addn. to WL Meridian
 30' Conc. #Cb
 CITY OF WICHITA, KANSAS.
 B.E. SMITH CITY ENGINEER
 JULY, 1957 PROJ. NO. C16-203

Survey of
 Plan
 E.C.
 M.G.
 C. H. H. H.