

ROSEBERRY COURT PARKING COURT

SERVING LOTS 21 THROUGH 36, BLOCK J, PLANEVIEW
SUBDIVISION NO. 1

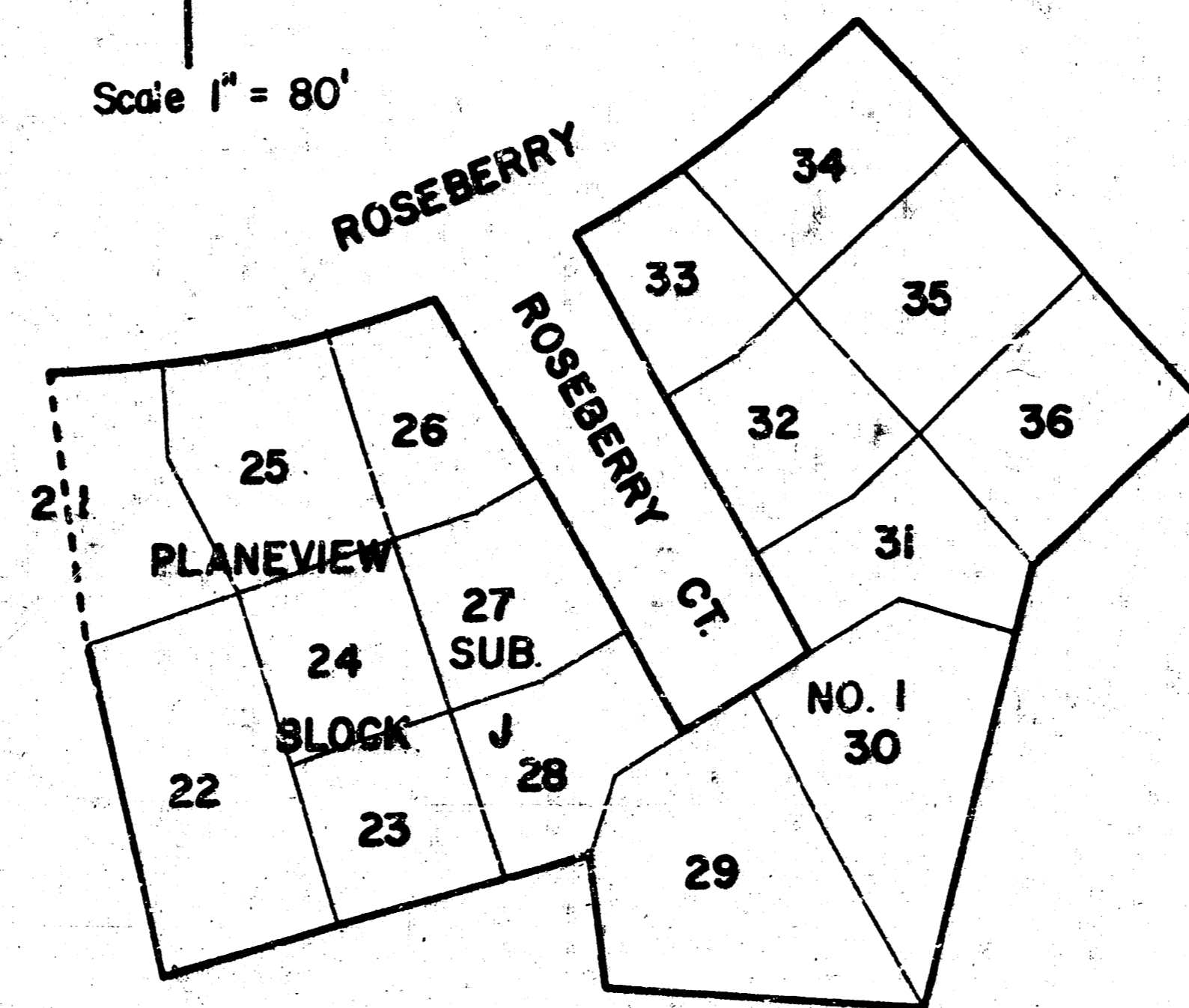

IMPROVEMENT DISTRICT MAP

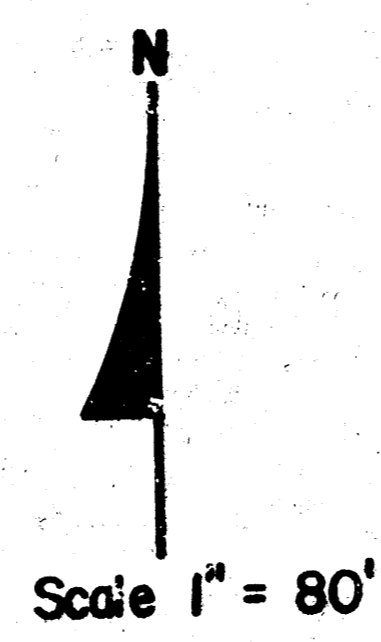
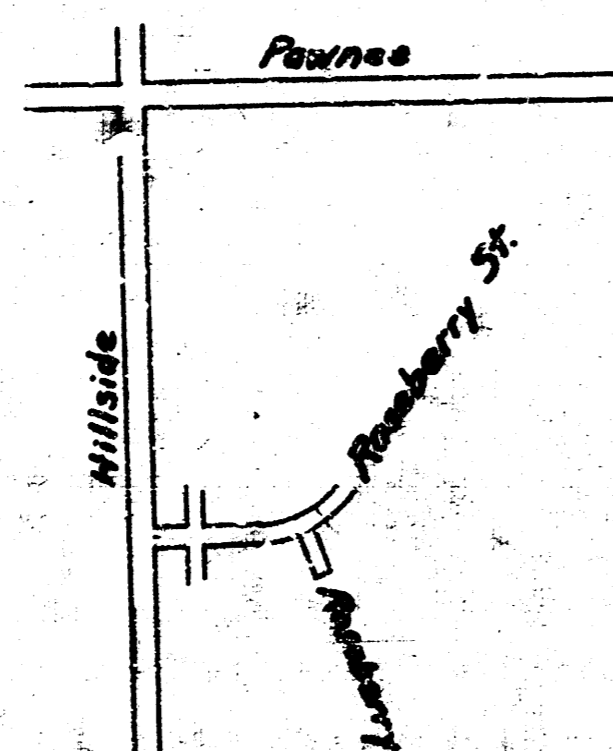
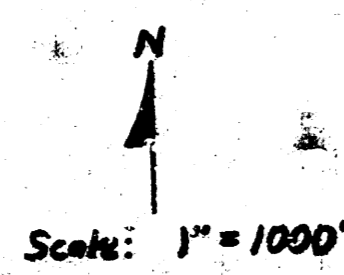

VICINITY MAP

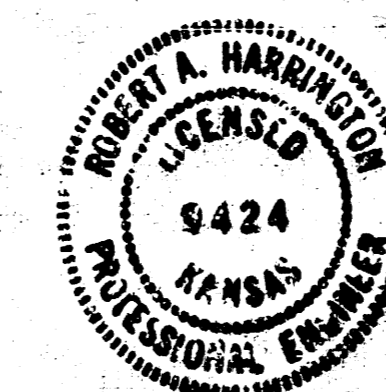

PROJECT NO.	472-76-245-81360-000-000-001
	818-76-245-50209-000-000-001
CITY OF WICHITA	M. E. LINDEBAK CITY ENGINEER
LANDCO ENGINEERING	CONSULTANT ENGINEER

B.M. El. 107.01 S-rim MH at Sta. 1+29, 18' R.
 B.M. El. 105.99 TC E-end Return SE-corner Intersection
 Roseberry St. & Roseberry Court

Scale 1" = 10'

Note:
 Remove & Replace Portions of Exist. E-W Conc. Sidewalk as Directed by Field Engineer in order to provide a smooth Transition to new Sidewalk. Max. longitudinal slope 1" / 100'

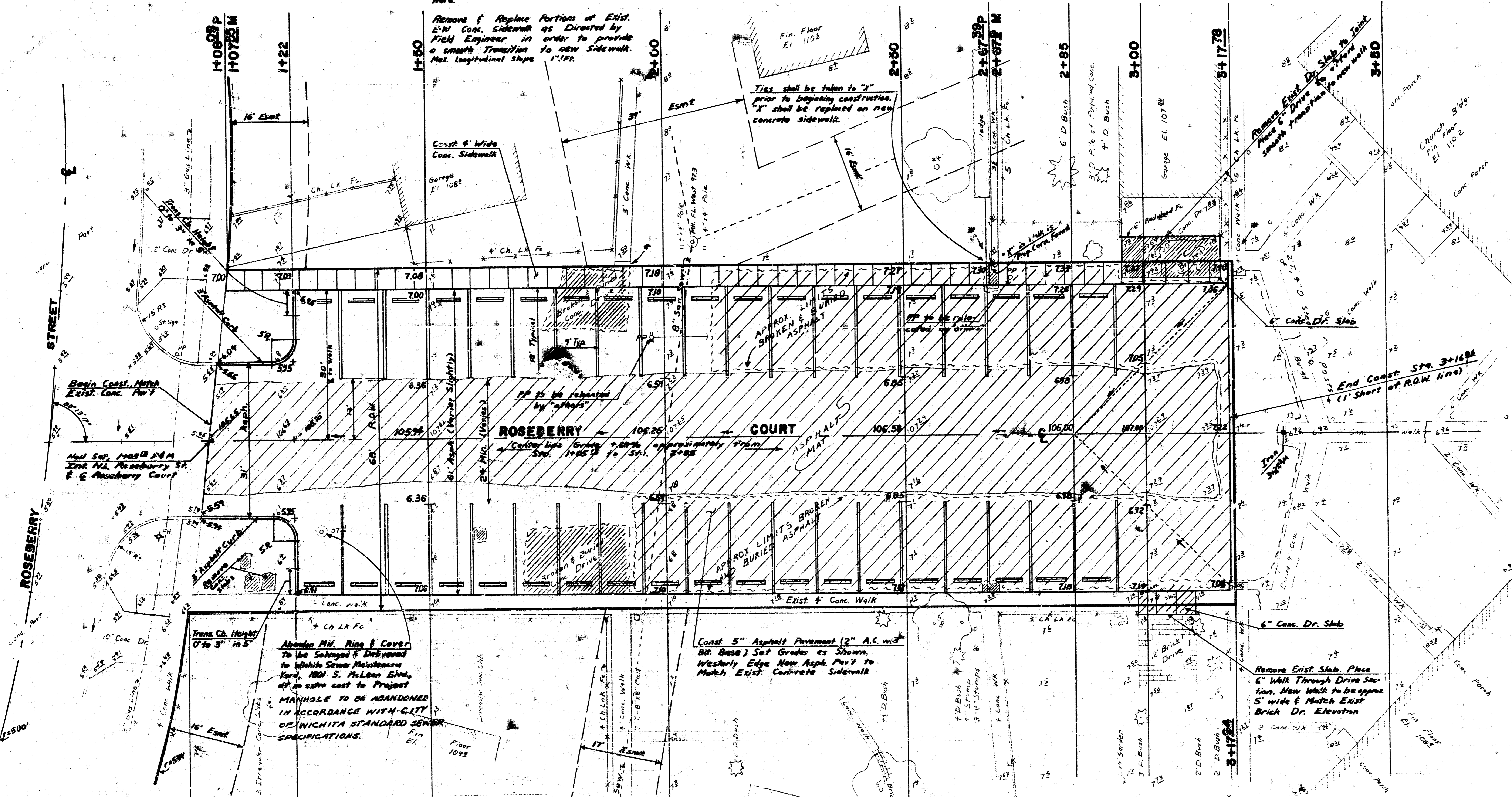

NOTE:
 3" Asphalt Curb Constructed with this Project shall not be paid for Directly, but shall be considered Incidental to the cost of the 5" of 5" Asphalt Pavement placed.

EARTHWORK:

EXCAVATION	316.5 C.Y.	COMPACTED FILL (95%)	227.9 C.Y.
+10%	31.7 C.Y.	+10%	230 C.Y.
TOTAL	348.2 C.Y.	TOTAL	252.9 C.Y.

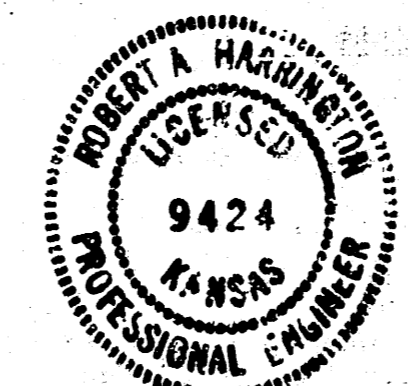

ROSEBERRY COURT PARKING COURT
 Serving Lots 21 through 36 inclusive, Block J, Planview Sub. No. 1
 Project No. 472-76-245-81360-000-000-001
 818-76-245-5C209-000-000-001
 CITY OF WICHITA M. E. LINDEBAK CITY ENGINEER
 LANDCO ENGINEERING CONSULTANT ENGINEER
 BOOK 3TT DRAWN BY RH DATE 6/84

5" ASPHALTIC CONCRETE PAVEMENT w.
3" BITUMINOUS BASE
TYPICAL TRANSVERSE SECTION

Scale 1" = 5'

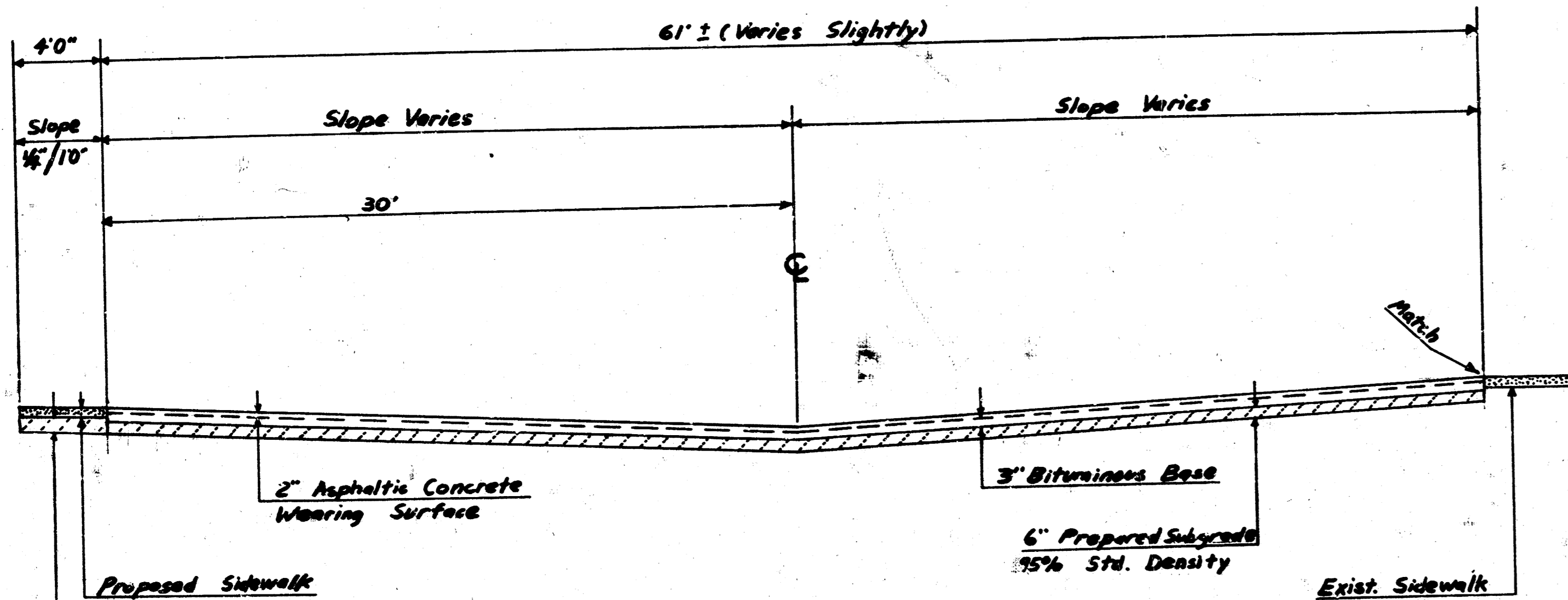

6" Prepared Subgrade
95% Std. Density
(Compaction under walk
is not paid for directly,
but is incidental to
S.F. work)

NOTE:

- 1) A tack coat of emulsified asphalt (SC-1H or CSS-1H) shall be applied at an approximate rate of 0.05 gallons per square yard between each lift of asphaltic material.
- 2) Construction Joints in each lift shall be staggered a minimum of one (1) foot from joints in preceding lifts.

BUMPER BLOCK & PARKING STALL
DETAIL

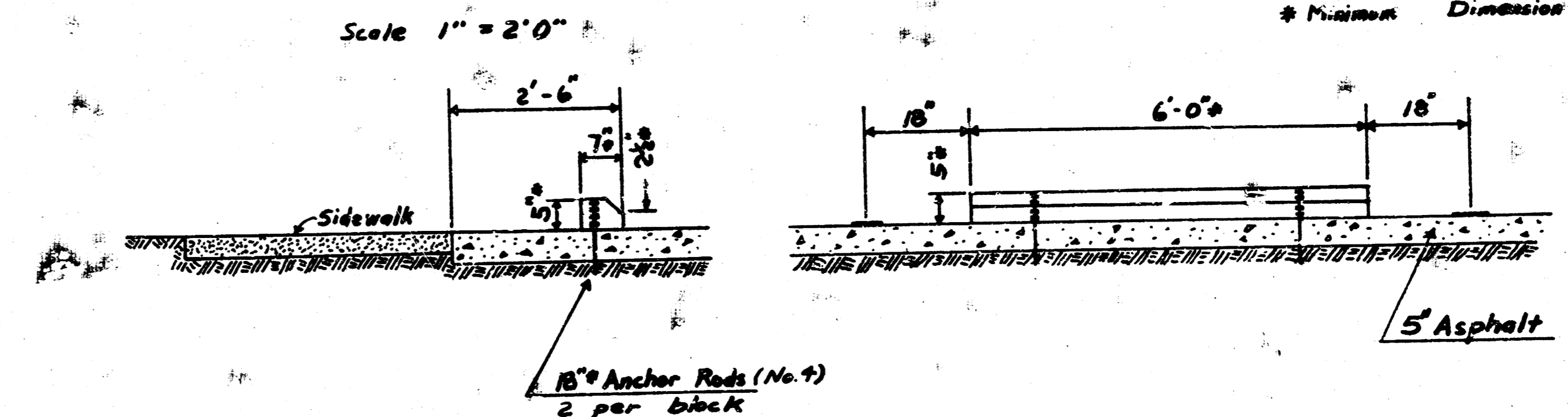

NOTE:

- 1) The Contractor shall install 38 Precast Concrete Bumper Blocks as shown. The Bumper Blocks shall be six-foot in length, seven to eight inches wide at the base, approximately three inches wide at the top, and five to six inches in overall height, with a sloping taper from about center height to the top. Concrete used in manufacture shall be designed for a compressive strength to exceed 3000 psi, and units to be reinforced full length with one or more steel reinforcing rods. The finish shall be smooth, and off-white in color. Each bumper block shall have a hole for steel anchor pins located near each end, of 1/2" or 3/4" diameter.
- 2) Stall Lines shall be painted 6" in width. Paint used shall meet City of Wichita Traffic Operations and Maintenance Division Specification for Heated Rapid Dry Pavement Marking Paint.

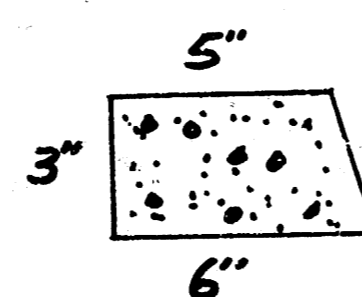
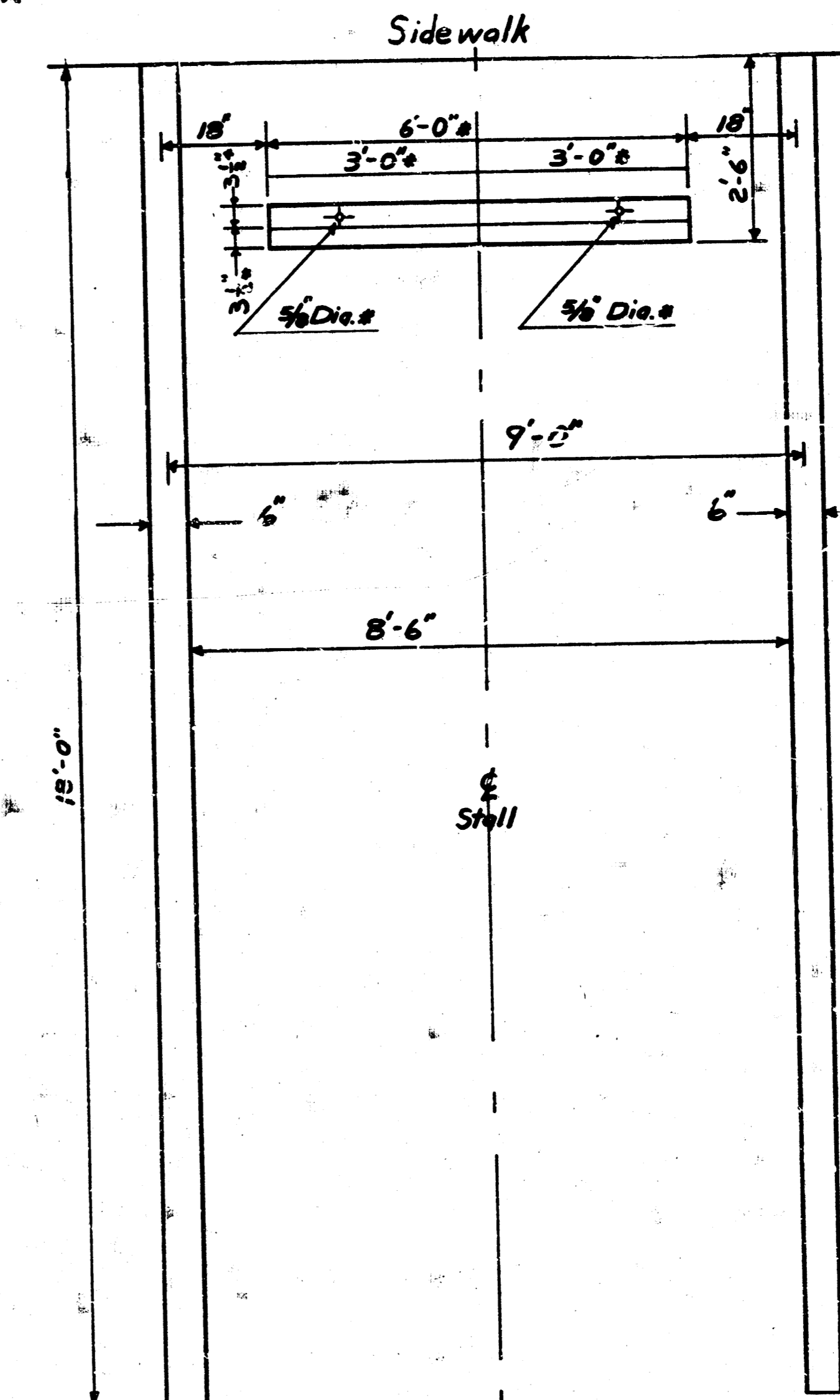

DETAIL: 3" ASPHALT CURB
OTHER SUITABLE CURB SECTION
MAY BE USED WITH PERMISSION
OF FIELD ENGINEER

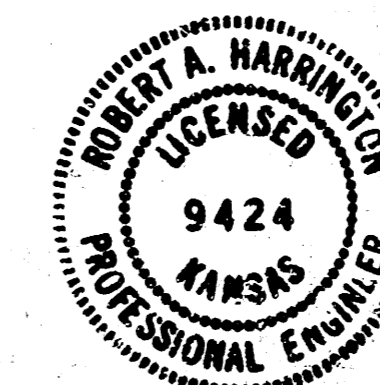

ROSEBERRY COURT PARKING COURT
472-76-245-81360-000-000-001
818-76-245-50209-000-000-001

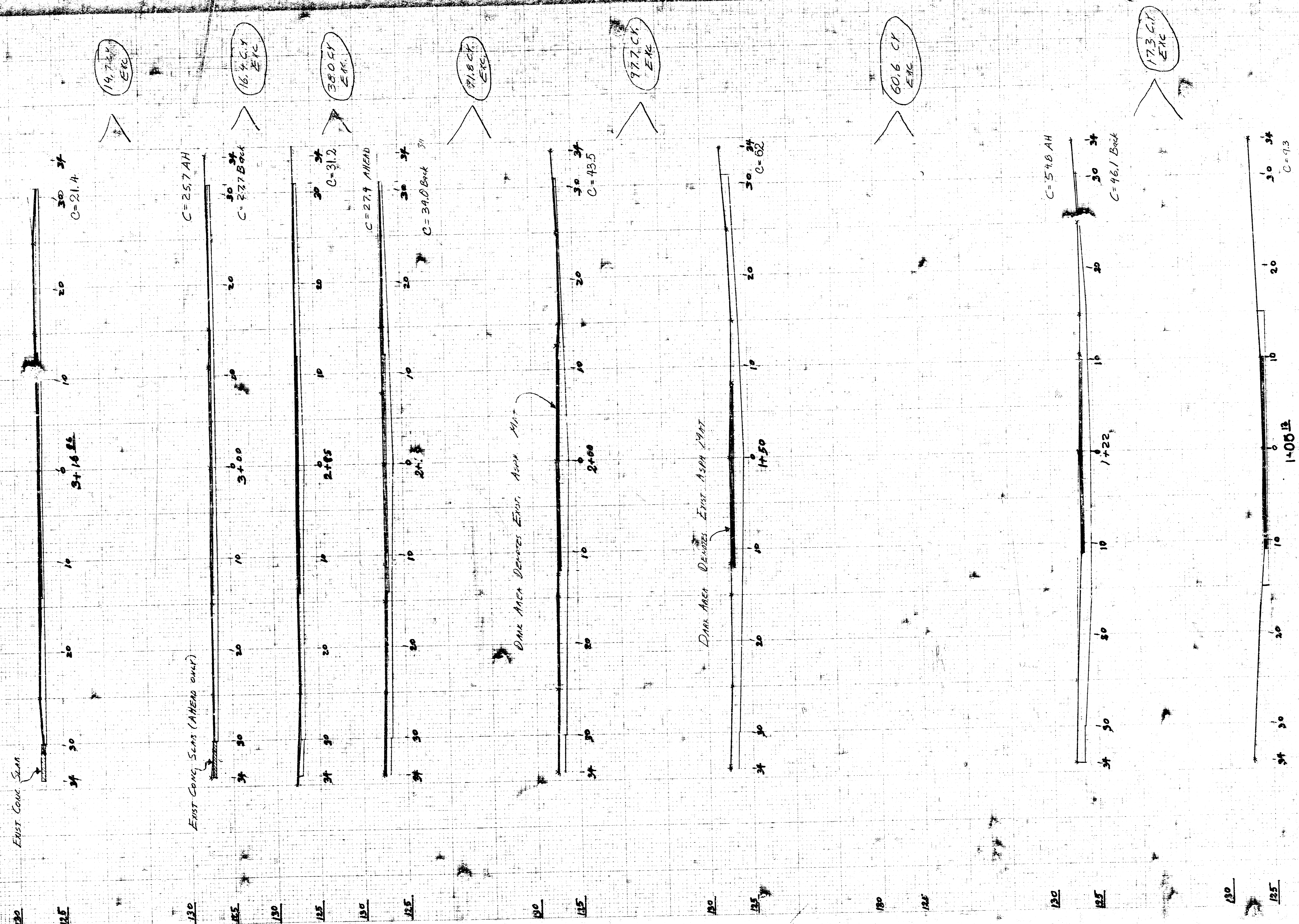

ROSEBEARY COURT
 SEAVING LOTS 21-36, inclusive, Blk. J
 Ploverview Sub. No. 1
 472-76-245-81340-000-001
 810-76-245-50209-000-001

TOTAL ETC.
 316.5 C.Y.

4 8 3 50