

B.M. 11129 "a" on NW cor signal light base, S.E. cor. St. Francis & 2nd St.
 B.M. 11259 "c" in Const on e of walk W., SW cor. St. Francis & 3rd St.

NOTE: Repair existing surface, repair base with 7" concrete; necessary, level up with asphaltic conc. & resurface with 2" asphaltic concrete.

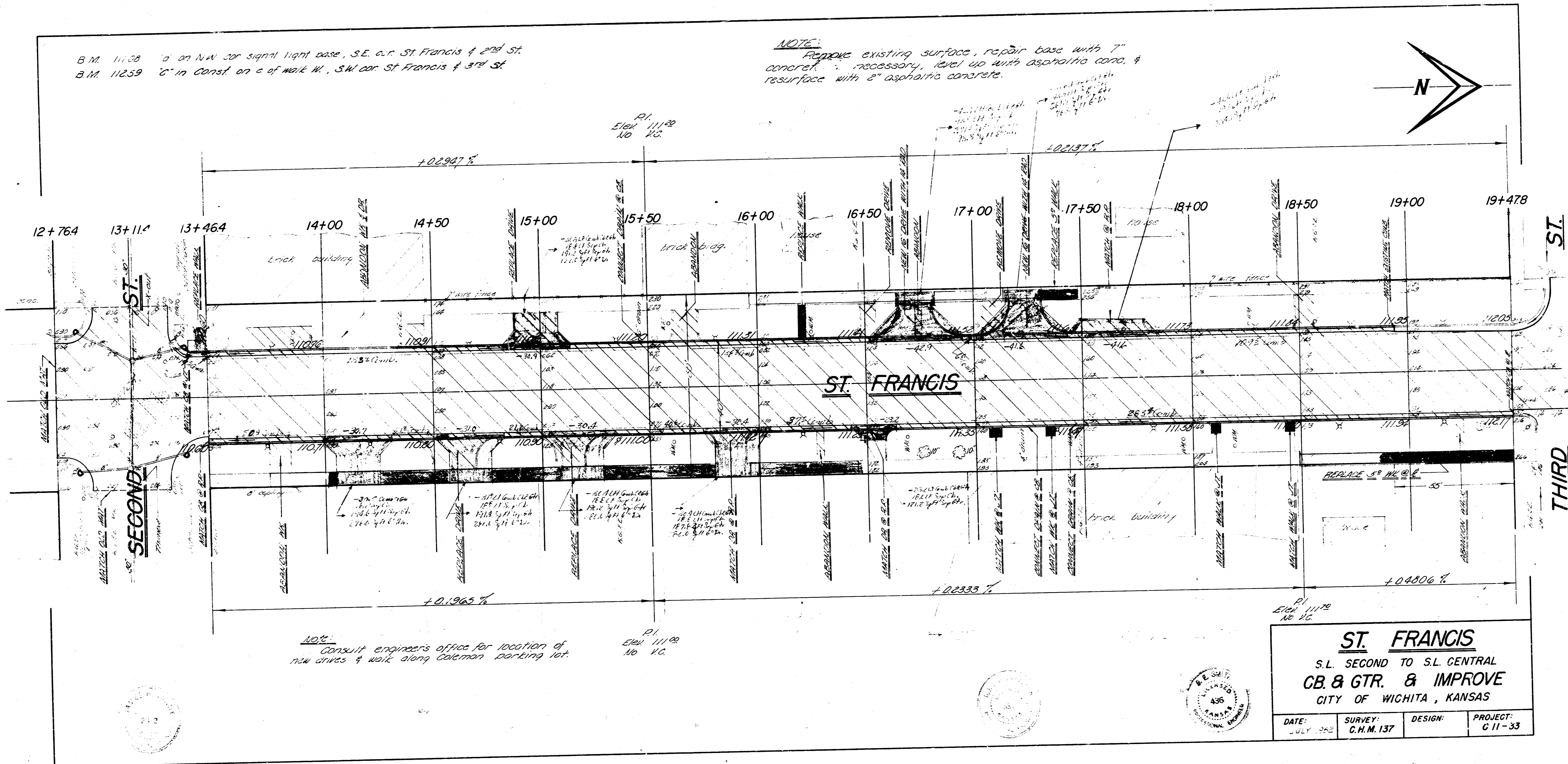
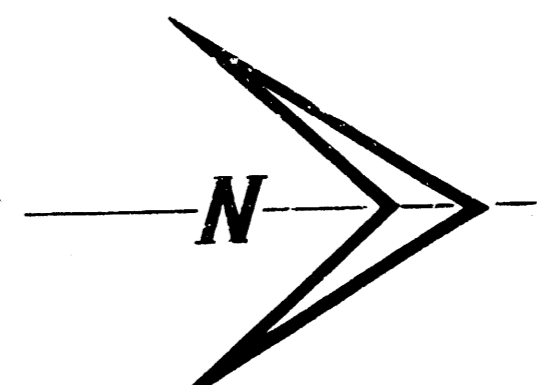

NOTE: Consult engineer's office for location of new drives & walk along Coleman parking lot.

P.I.
 Elev. 111.80
 10' V.C.

P.I.
 Elev. 111.70
 10' V.C.

ST. FRANCIS			
S.L. SECOND TO S.L. CENTRAL			
CB. & GTR. & IMPROVE			
CITY OF WICHITA, KANSAS			
DATE: JULY 1962	SURVEY: C.H.M. 137	DESIGN:	PROJECT: C 11-33

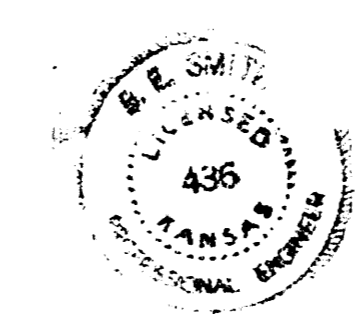

H.M. 11-91 S.E. cor. signal light cor. base, N.E. cor. Central & St. Francis.

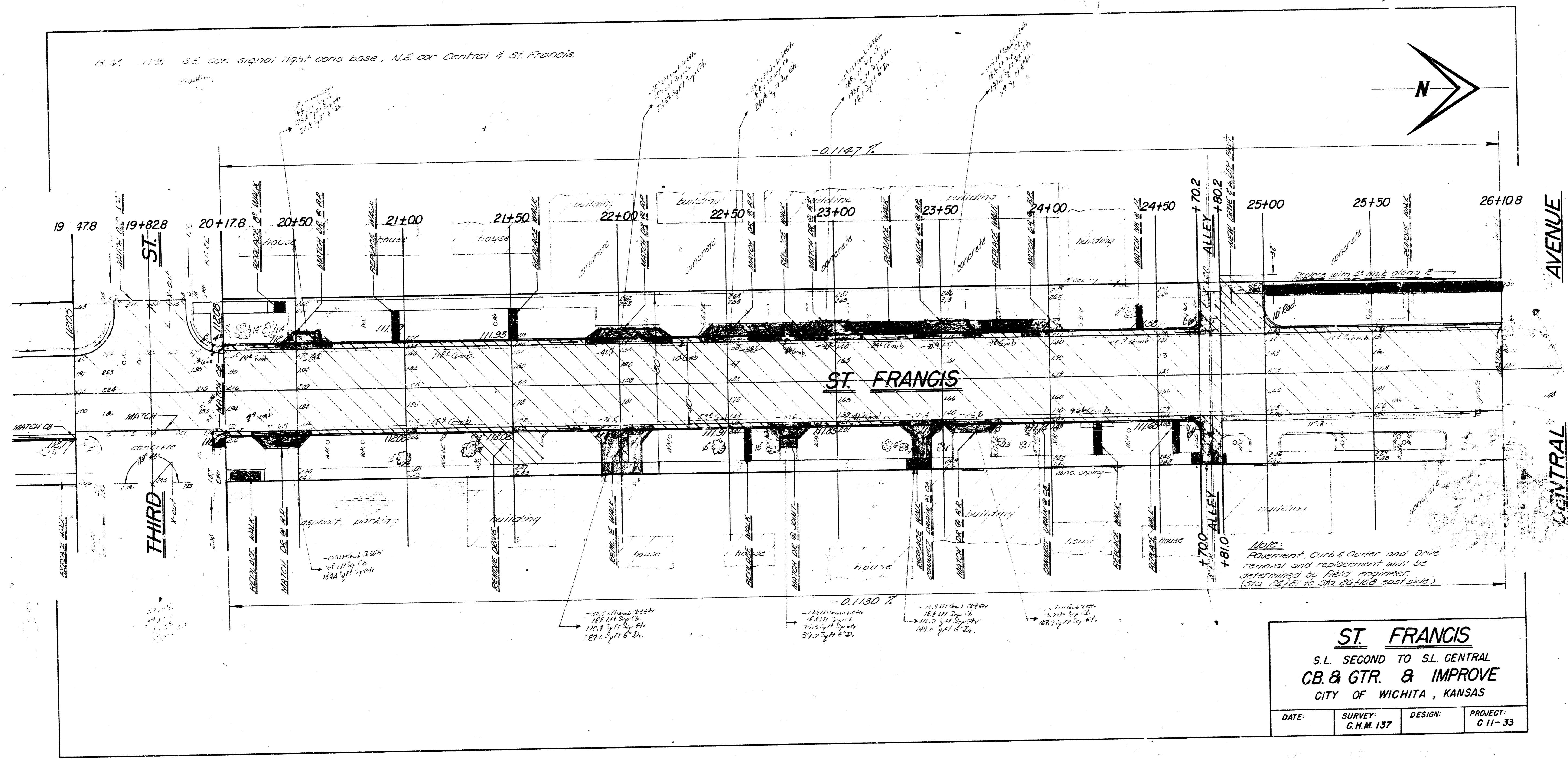
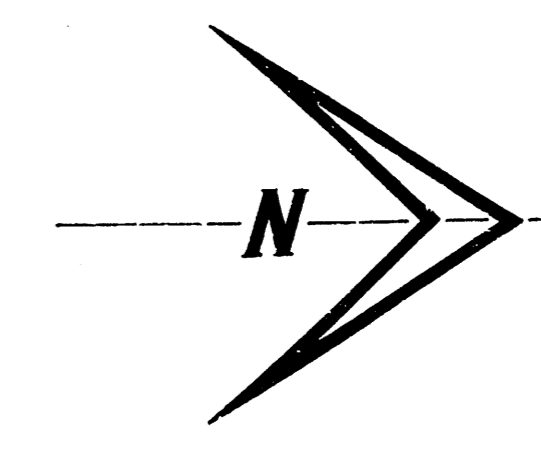

ST. FRANCIS			
S.L. SECOND TO S.L. CENTRAL			
CB. & GTR. & IMPROVE			
CITY OF WICHITA, KANSAS			
DATE:	SURVEY:	DESIGN:	PROJECT:
	C.H.M. 137		C 11-33