

B.M. 11831 NW Cor. Conc. Parch. Ho. # 2459 Newell
 B.M. 11700 Spoke in 36" Elm W.L. Meridian 30' So. 4 St. Louis
 B.M. 11742 SE Cor. Lower Step Ho. # 2400 St. Louis

0.1%
 W to E

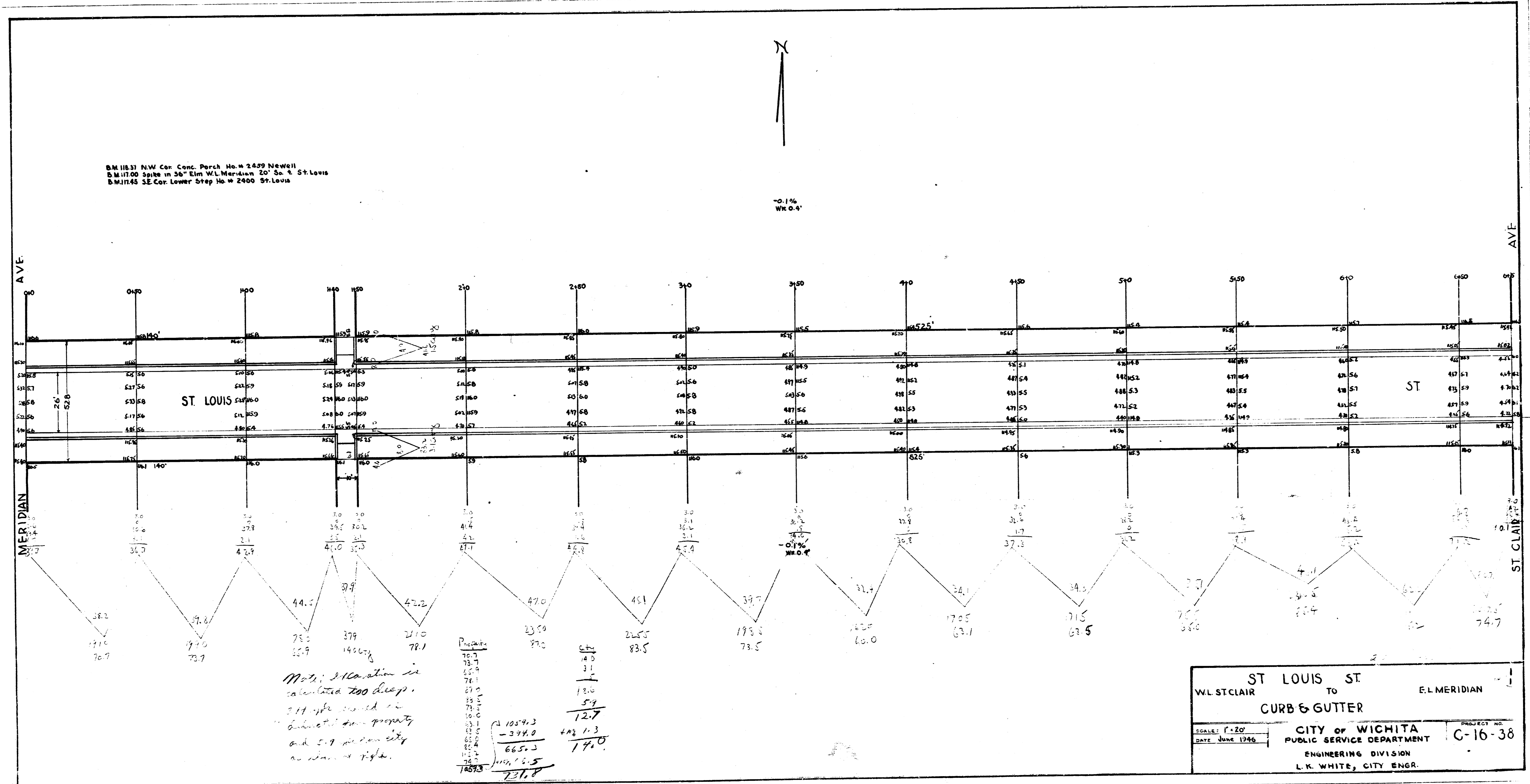

B.M. 11831 NW Cor. Conc. Porch No. W 2459 Newell
 B.M. 11700 Spike in 36" Elm W.L. Meridian 20' So of St. Louis
 B.M. 11745 SE Cor. Lower Step No. W 2400 St. Louis

