

SENECA
S.L. ESTHNER TO N.L. MERTON

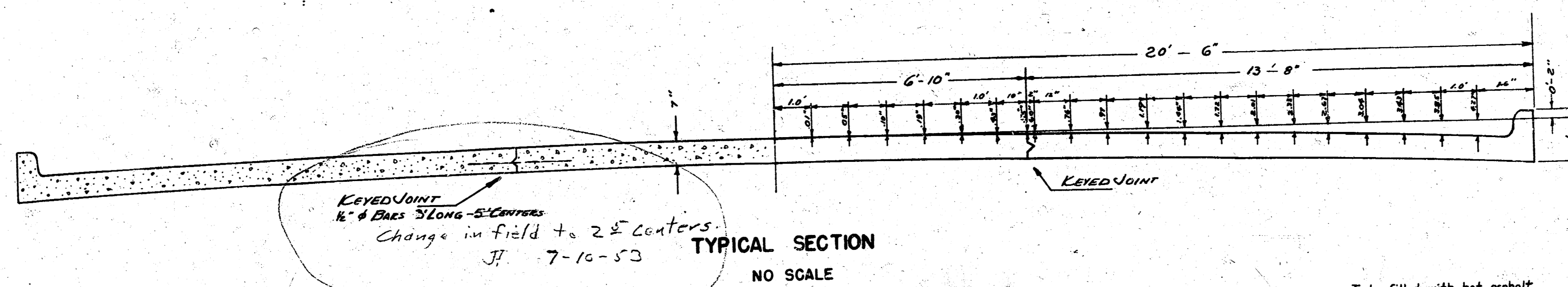

4-3/4" Bars, Equally Spaced to be used in all 3 sections

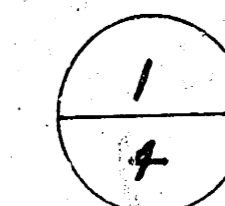
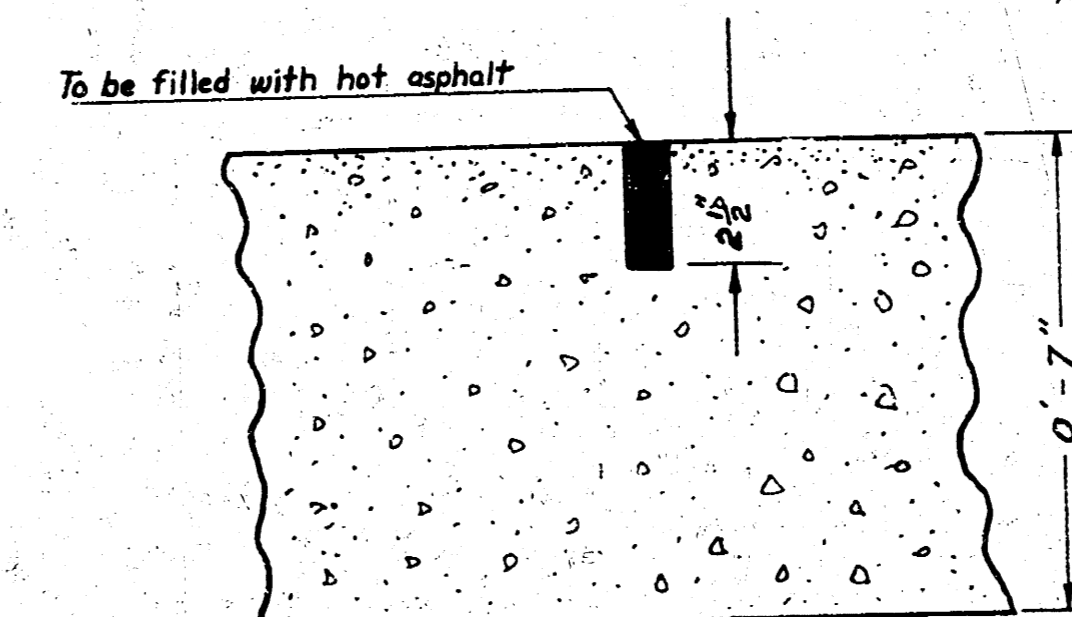
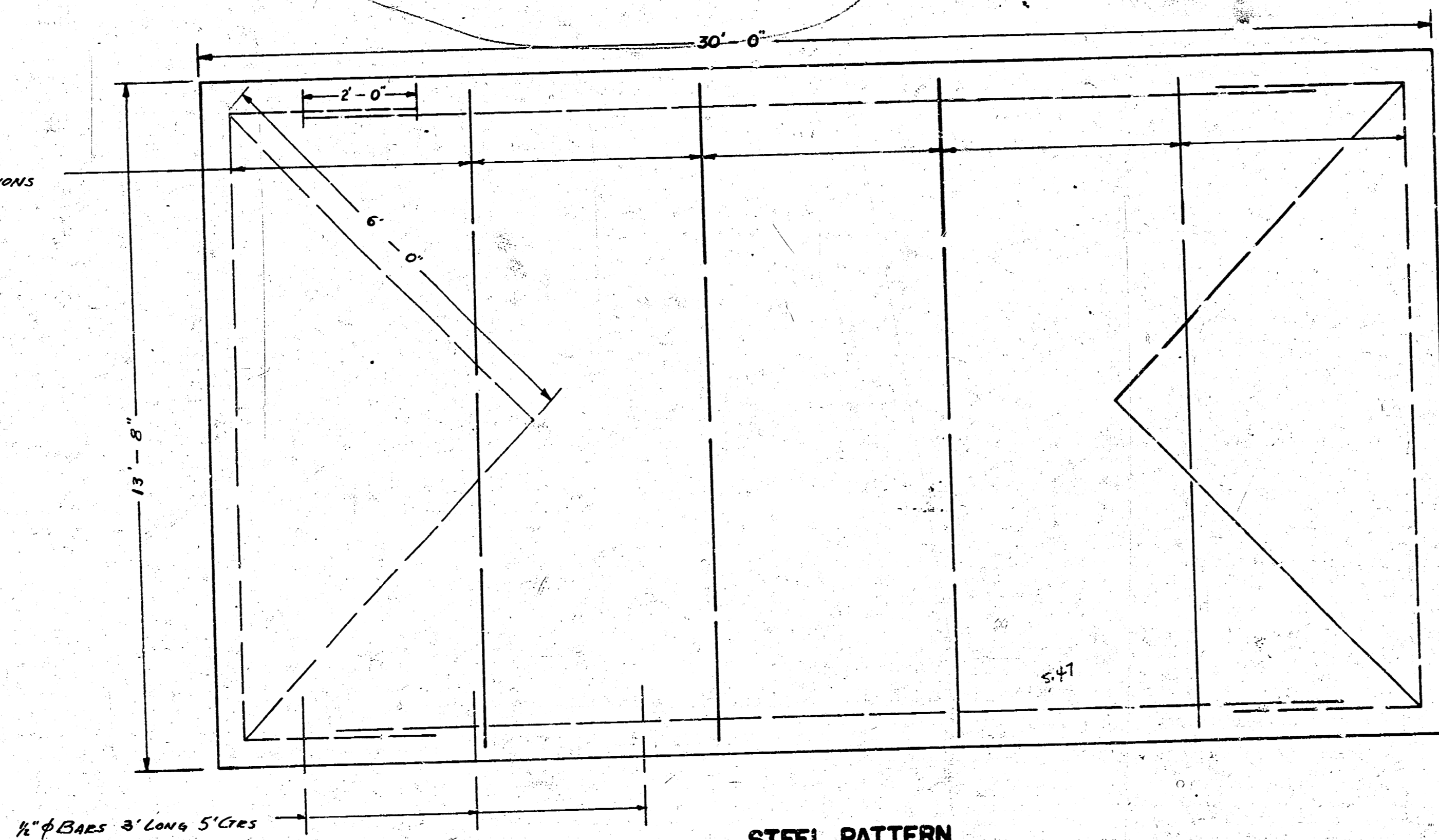

B.M. X 11 S. Co. ESTHNER W.S. SENECA 101.20
 B.M. R. R. SPUR E.S. R66 Pkt SW Co. SENECA 102.87

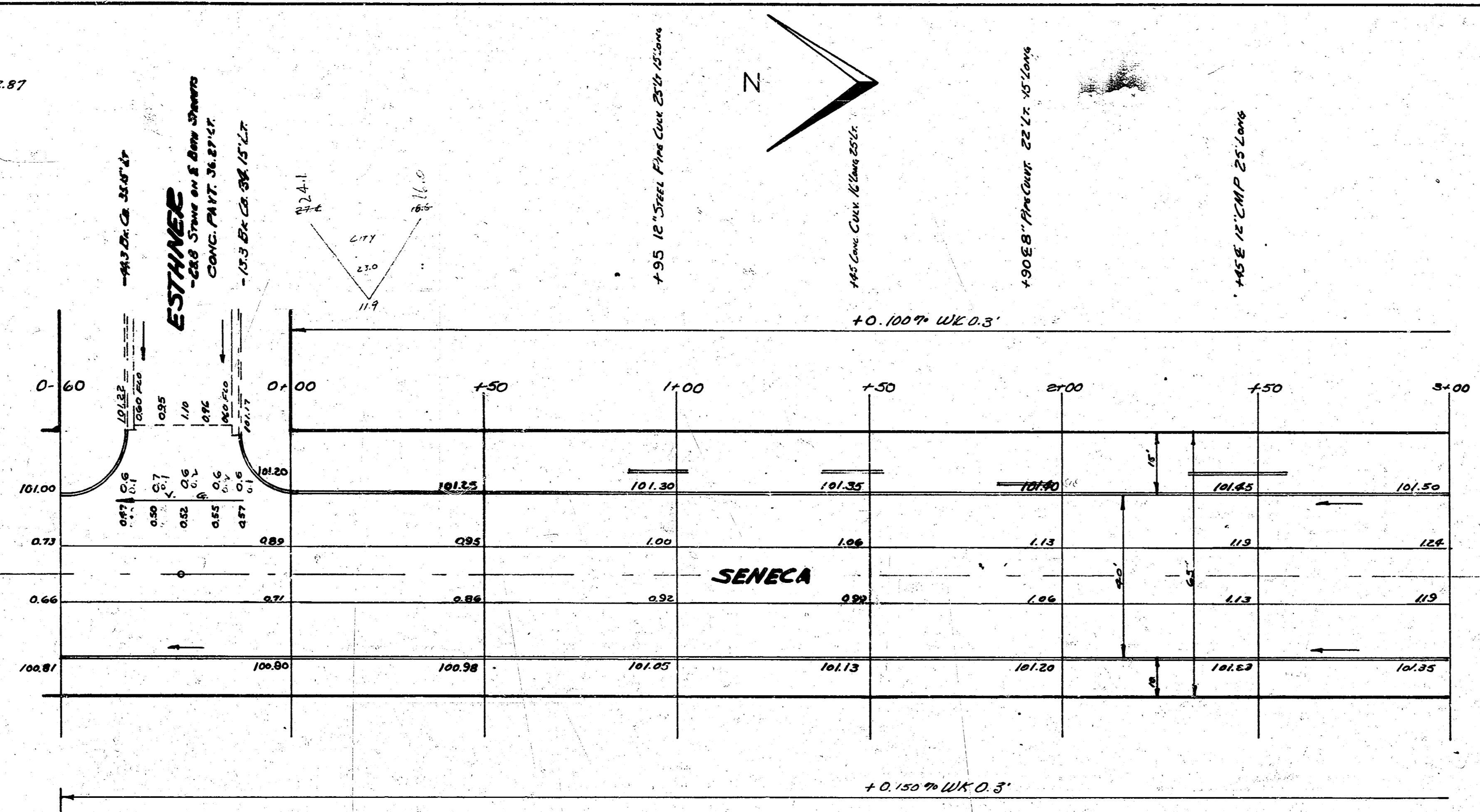

TOTALS

C12-162		CITY	
PROPERTY	FILE	FILE	FILE
9882 yds ²	8804 yds ²	1351 yds ²	498 yds ²

C12-163	
CITY	FILE
272 yds ²	2812 yds ²

NOTE TO FIELD ENGINEER & CONTRACTOR:
 PLACE ENTRANCE CULVERT PIPE ON OWNERS
 PROPERTY THE STREET DEPT. WILL REMOVE
 THIS PIPE AT THE REQUEST OF THE OWNER.

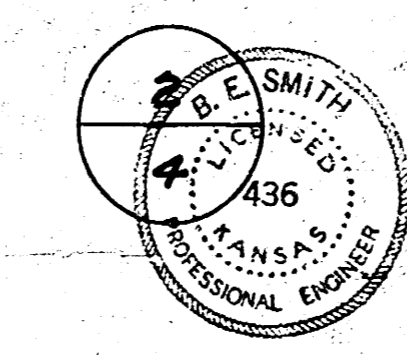

SENECA
 S.L. ESTHNER TO N.L. MERTON
 30' CONC. CURB, WIDEN TO 40'
 CITY OF WICHITA
 L.K. WHITE CITY ENGINEER
 Oct. 1952 Paon C12-162, C12-163

