

B.M. 17136 S.E. COR. CONC. PARCH. NO. 1783 LEXINGTON

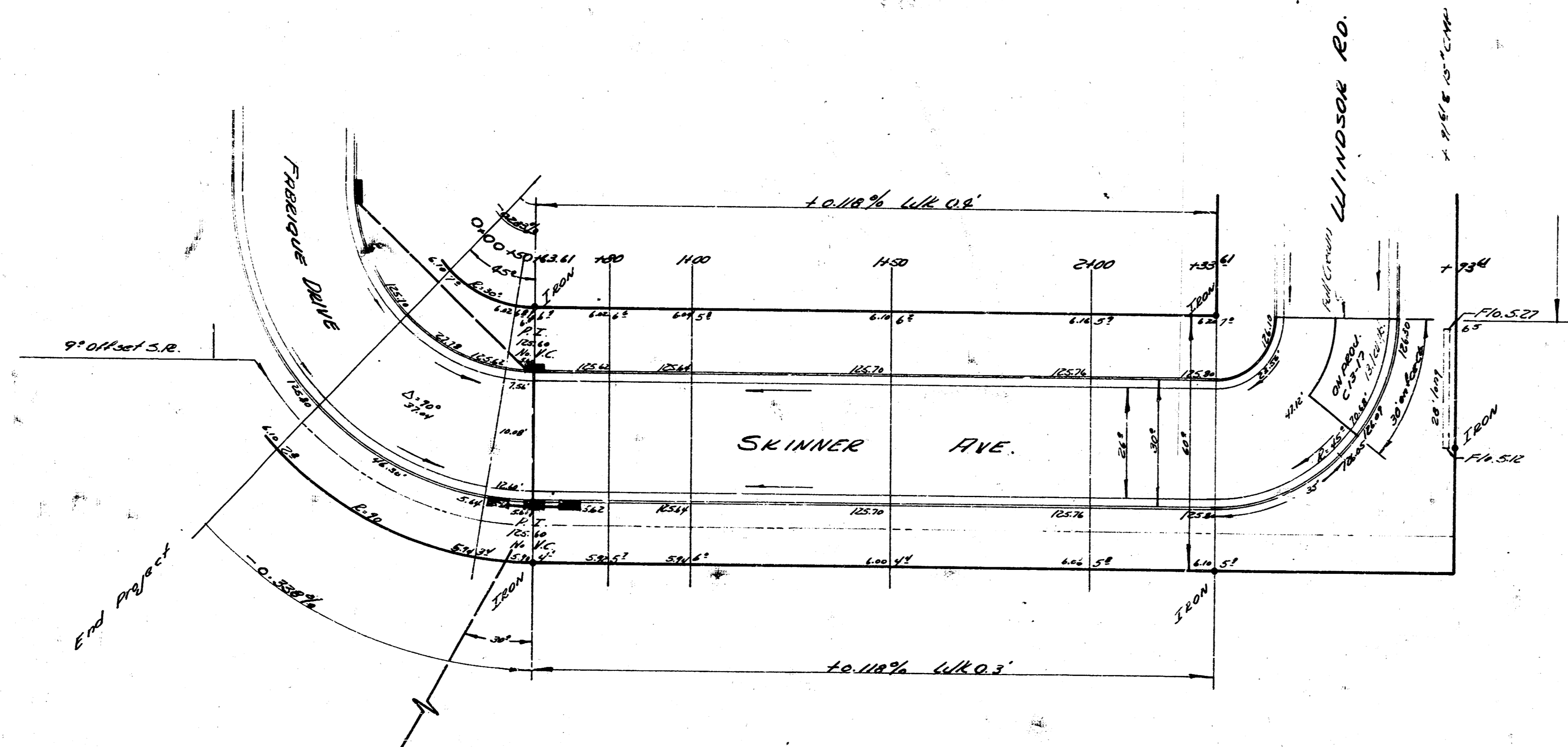

NOTE -
 Stationing on 1" offset from S.R.
 Baseline is 9' offset from S.R.

Surveyed by B. E. Smith
 Plan No. 436
 City of Wichita, Kansas
 B. E. Smith, City Engineer

-Total Excav-

	City	Prop.
110%	643 cu	350.3 cu
	84	35.0
	727 cu	385.3 cu
	448	
	279 cu	

SKINNER N.
 & FABRIQUE TO EL WINDSOR
 26-2-30 RC.
 City of Wichita, Kansas
 B. E. Smith City Engineer
 July 1953 Proj. No. C3-36



1/2

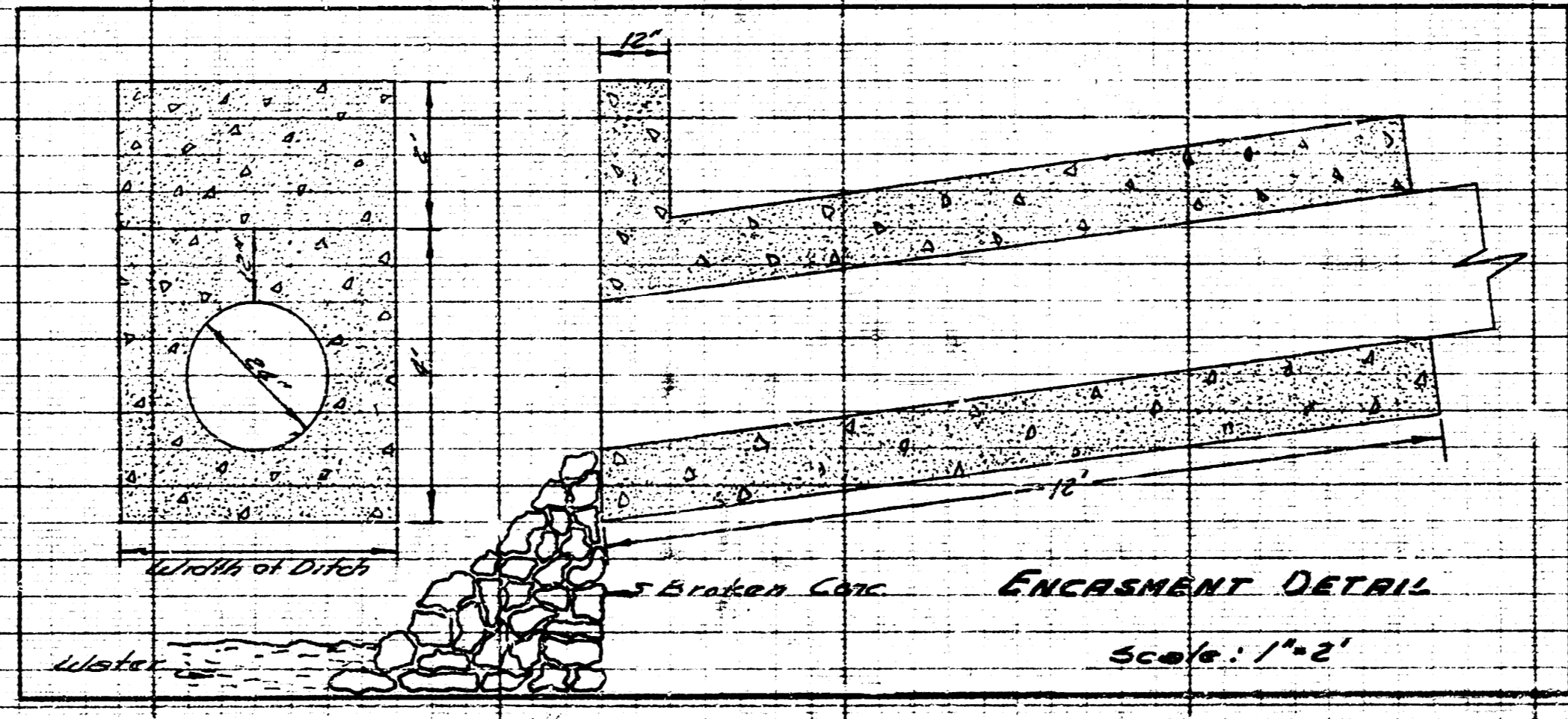
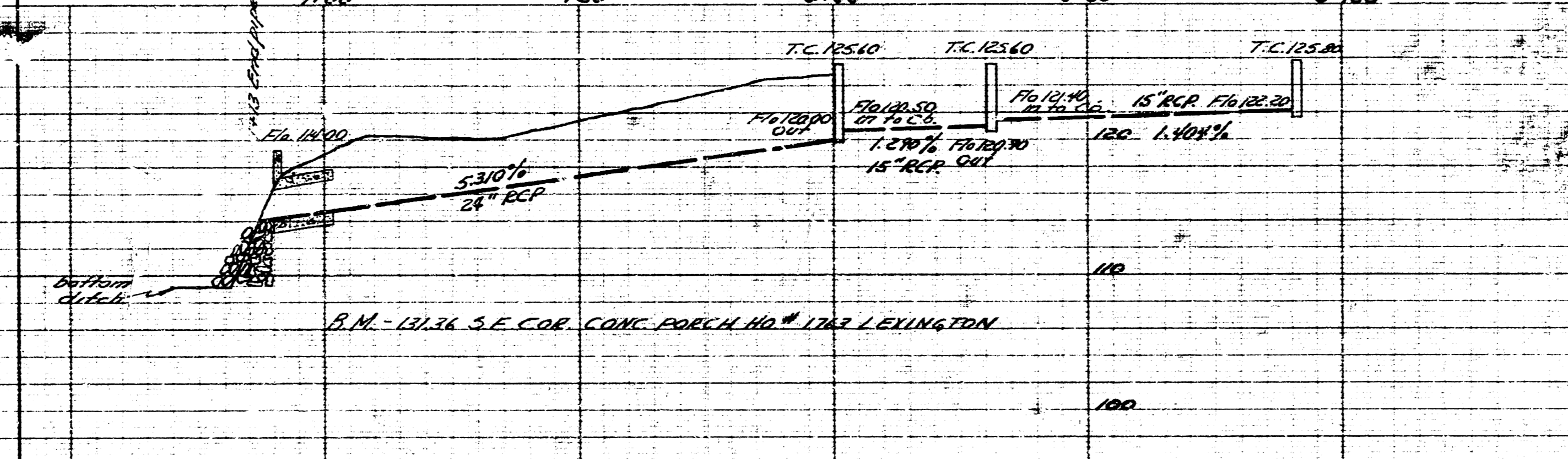
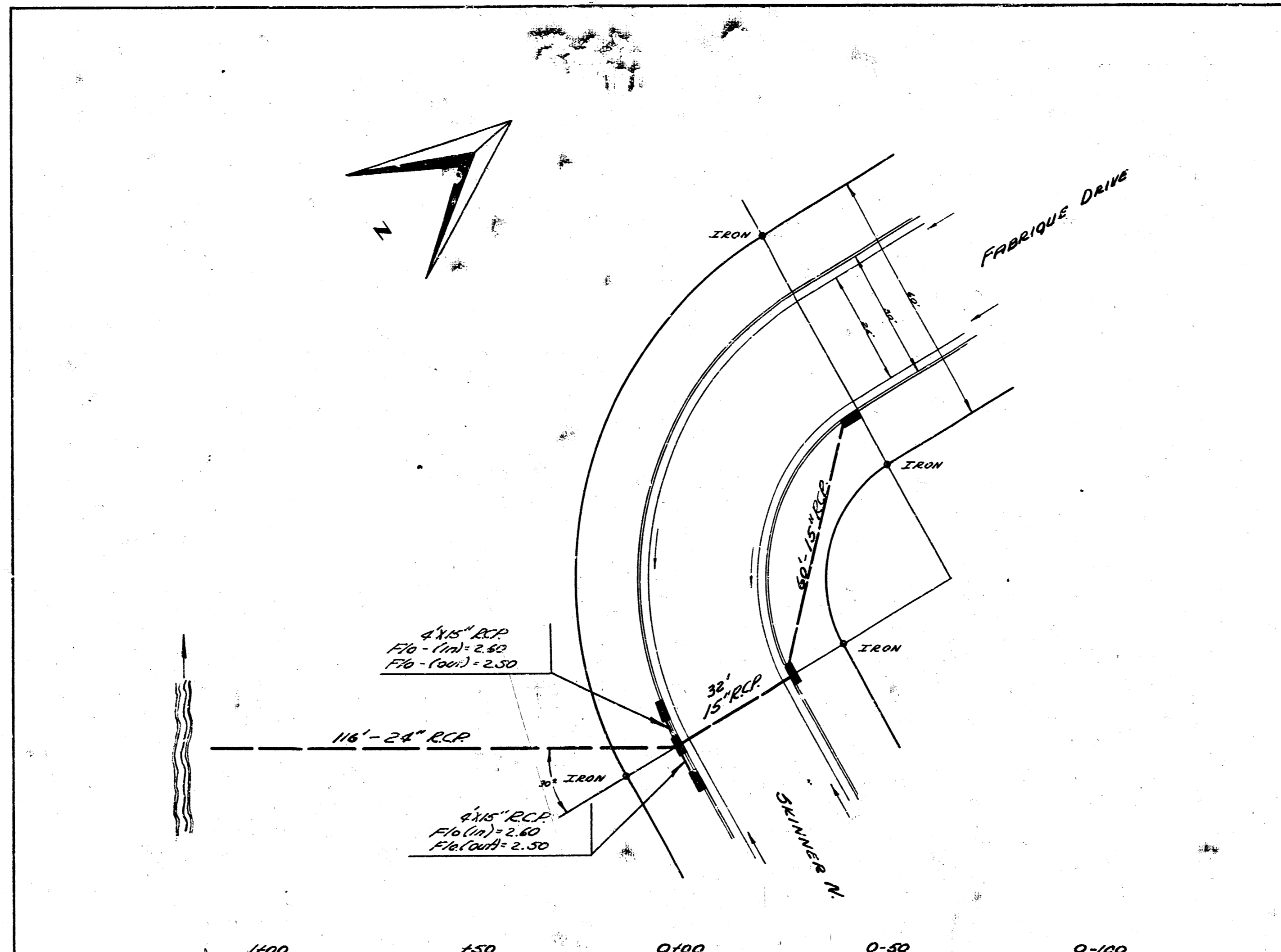

INCIDENTAL DRAINAGE
 PROJ. NO. C13-36