

BOTH SIDES OF SLEEPY HOLLOW
DRIVE FROM E.L. YALE AVENUE TO
W.L. ROOSEVELT AVENUE.
CITY OF WICHITA, KANSAS.

R.W. LINN — CITY ENGINEER. PROJ. NO. DAKS 573019.

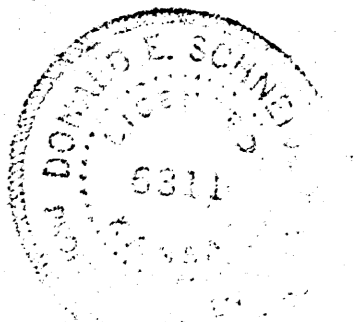

GENERAL NOTES

ROLL CURB IS TO BE CONSTRUCTED ON THIS PROJECT. TRANSITIONS TEN (10) FEET IN LENGTH ARE TO BE USED ADJACENT TO INLETS AND AT LOCATIONS WHERE ROLL CURB IS TO BE WARPED TO MATCH FULL HEIGHT CURBS. TOP OF INLETS ARE TO BE CONSTRUCTED TO FULL HEIGHT CURB ELEVATIONS WHICH IS 0.3 FEET ABOVE THE ROLL CURB ELEVATIONS. TRANSITIONS FROM ROLL CURB TO FULL CURB SHALL BE MEASURED AND PAID FOR AS 15 LIN. FT. OF ROLL CURB. ALL VOIDS BETWEEN EXISTING PAVEMENT AND NEW COMBINED CURB AND GUTTER AS A RESULT OF CONTRACTOR'S CONSTRUCTION OPERATION SHALL BE FILLED WITH CONCRETE TO THE TOP OF THE EXISTING PAVEMENT WITHOUT ADDITIONAL COMPENSATION. A LEVELING COURSE SHALL BE PLACED ON THE EXISTING PAVEMENT SUCH THAT WILL FACILITATE CONSTRUCTION OF A TWO (2) INCH SURFACE COURSE. MATERIAL FOR LEVELING COURSE SHALL BE THE SAME AS THAT SPECIFIED FOR SURFACE COURSE. LEVELING COURSE SHALL BE PAID FOR AT THE PRICE BID PER TON OF ASPHALT. SAWING TO FACILITATE REMOVAL OF EXISTING PAVEMENT, SIDEWALK, AND DRIVE WILL NOT BE PAID FOR DIRECTLY AND SHALL BE CONSIDERED AS INCIDENTAL TO THE OTHER ITEMS OF WORK. FIELD ENGINEER MUST SET OFFSET STAKES FOR NEW CONSTRUCTION USING ALIGNMENT OF EXISTING COMBINED CURB AND GUTTER. CONTRACTOR SHALL NOT REMOVE EXISTING COMBINED CURB AND GUTTER UNTIL OFFSET STAKES HAVE BEEN ESTABLISHED BY THE FIELD ENGINEER. DRIVEWAYS ARE TO BE REMOVED AND REPLACED TO LIMITS DETERMINED BY THE FIELD ENGINEER SUCH THAT THEY CAN BE RECONSTRUCTED TO MATCH NEW STREET PAVEMENT ELEVATIONS.

BM 1. 153.62 4" Cut Top NW Corner Concrete Culvert WS Yale & Sleepy Hollow Dr.
 BM 2. 157.23 4" Rim Thimble N Side Sleepy Hollow Dr. WS Roosevelt.

REMOVE EXISTING WALK TO LIMITS DETERMINED BY ENGINEER. RECONSTRUCT SPECIAL WALK WITH BRICK EDGES TO MATCH REMAINING WALK AND NEW CURB ELEVATIONS. CONSTRUCTION OF THIS TYPE OF WALK SHALL BE MEASURED AND PAID FOR AS SQ. FT. SPECIAL WALK.

REMOVE EXISTING WALK TO LIMITS DETERMINED BY ENGINEER. RECONSTRUCT SPECIAL WALK WITH BRICK EDGES TO MATCH REMAINING WALK AND NEW CURB ELEVATIONS. CONSTRUCTION OF THIS TYPE OF WALK SHALL BE MEASURED AND PAID FOR AS SQ. FT. SPECIAL WALK.

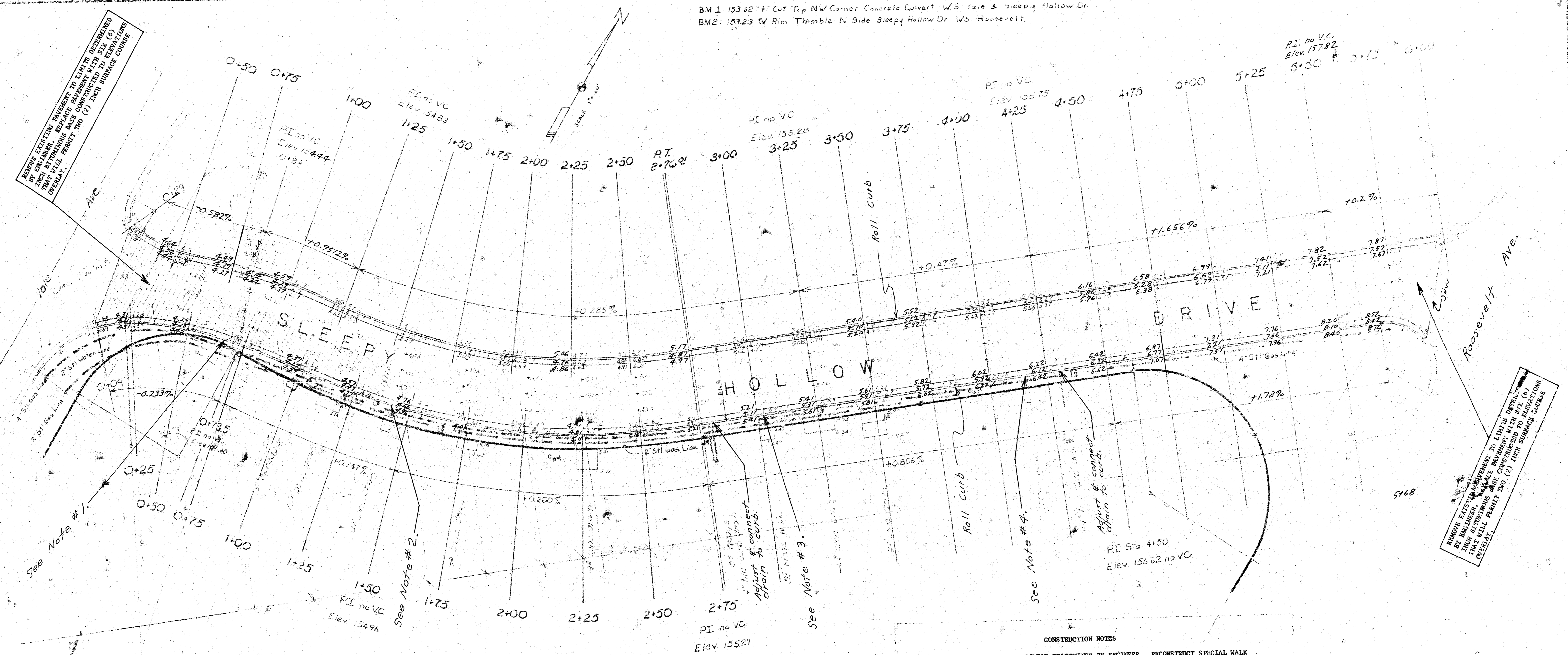

- CONSTRUCTION NOTES
1. REMOVE EXISTING WALK TO LIMITS DETERMINED BY ENGINEER. RECONSTRUCT SPECIAL WALK WITH BRICK EDGES TO MATCH REMAINING WALK AND NEW CURB ELEVATIONS. CONSTRUCTION OF THIS TYPE OF WALK SHALL BE MEASURED AND PAID FOR AS SQ. FT. SPECIAL WALK.
 2. REMOVE BOTTOM STEP AND RETAINING WALL ON EACH SIDE OF STEPS. RECONSTRUCT BOTTOM STEP AND RETAINING WALL TO MATCH REMAINING STEPS AND NEW CURB ELEVATION. RETAINING WALL TO BE RECONSTRUCTED SIMILAR TO EXISTING RETAINING WALL. BOTTOM STEP TO BE RECONSTRUCTED AS WALK HAVING A UNIFORM THICKNESS OF 9" AND WILL BE PAID FOR AT THE PRICE BID PER SQ. FT. 9" WALK. REMOVAL OF BOTTOM STEP SHALL BE MEASURED AND PAID FOR AS SQ. FT. WALK AND DRIVE REMOVED.
 3. REMOVE BOTTOM STEP AND RECONSTRUCT TO MATCH REMAINING STEPS AND NEW CURB ELEVATION. BOTTOM STEP TO BE RECONSTRUCTED AS WALK HAVING A UNIFORM THICKNESS OF 9" AND WILL BE PAID FOR AT THE PRICE BID PER SQ. FT. 9" WALK. REMOVAL OF BOTTOM STEP SHALL BE MEASURED AND PAID FOR AS SQ. FT. WALK AND DRIVE REMOVED.
 4. REMOVE FLAGSTONE WALK TO LIMITS DETERMINED BY ENGINEER. RECONSTRUCT FLAGSTONE WALK TO MATCH REMAINING WALK AND NEW CURB ELEVATIONS. CONSTRUCTION OF THIS TYPE OF WALK SHALL BE MEASURED AND PAID FOR AS SQ. FT. SPECIAL WALK.

S. SIDE SLEEPY HOLLOW DR
 El. Yale to WL Roosevelt
 Curb & Gutter Replacement
 City of Wichita, Kansas
 City Engineer - RW Linn
 Project no DAKS 573019
 Date January 1975