

B.M. 100.21 TIN TRAY F. H. W. N.W. COR. SKINNER & GREEN  
 B.M. 100.76 S. END E.L. ESTELLE N.S. FUNSTON

STATIONING ON E



PROPERTY  
 539.3  
 11074 53.9  
 593.2 CU YDS ETC.

131.8  
 13.2  
 145.0 CU YDS ETC. UNDER 13' WIDENING

GREEN

NO. 21000 17 1/2' 16' 6"  
 NO. 21000 17 1/2' 16' 6"

ADJUST 4 CATCH BASINS

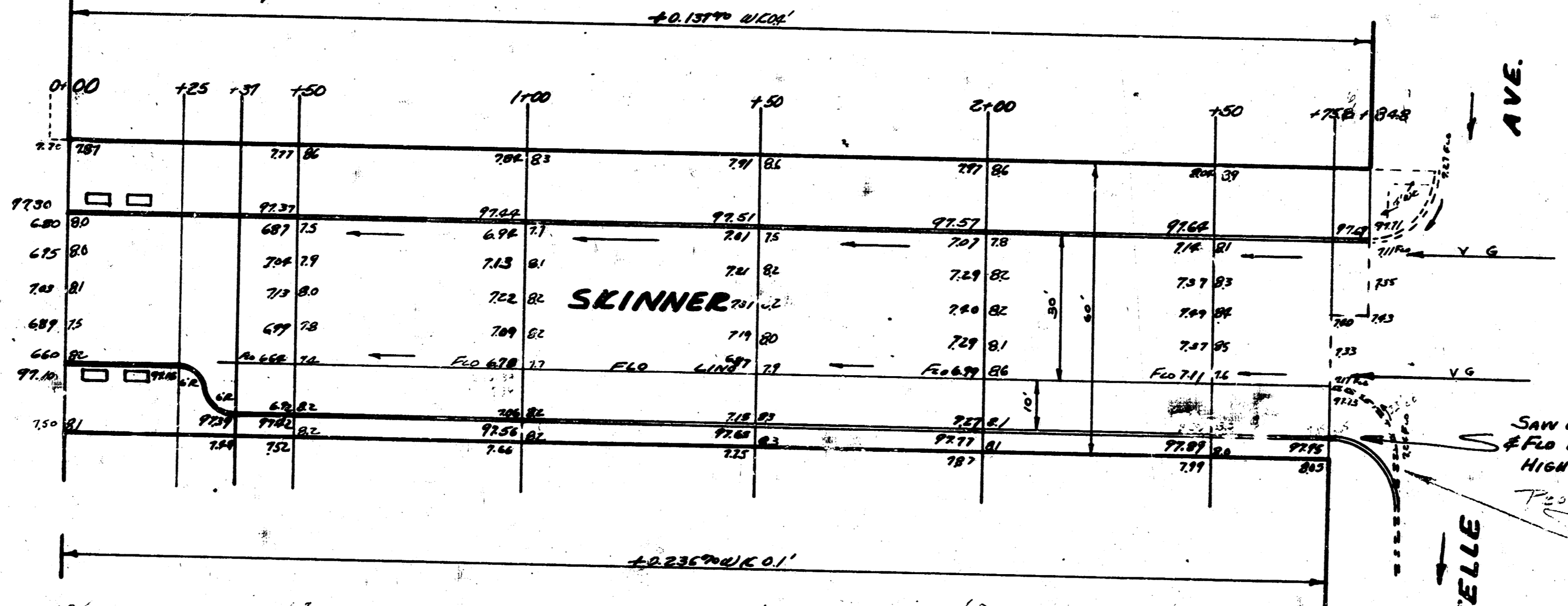

SAW OFF OLD CURB BUT LEAVE GUTTER & FLD INTER. SLOPE NEW PAVE FROM HIGH EDGE DOWN TO OLD FLD LINE PROPERTY CHARGE

School Job

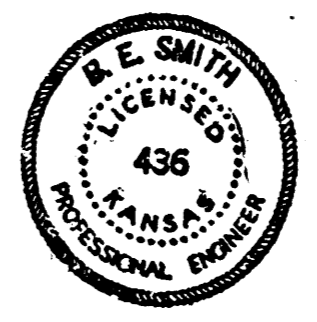
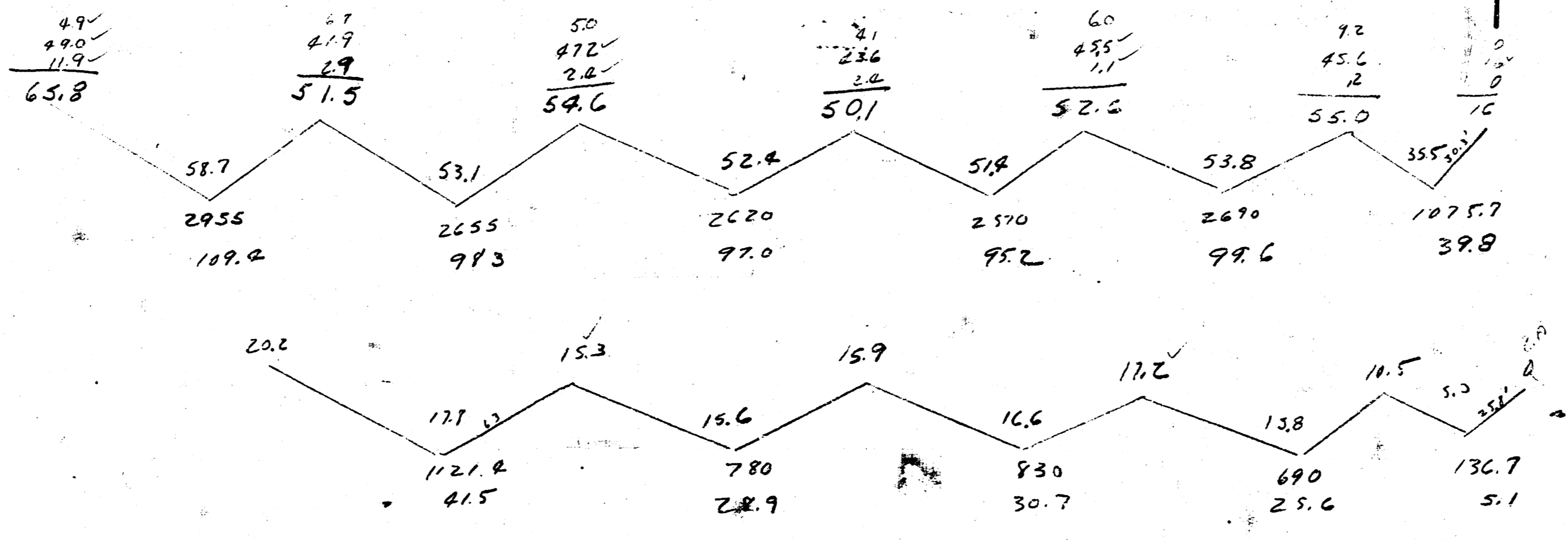

**SKINNER**  
 W.L. ESTELLE TO EL GREEN  
 30' CONC. & CO.  
 CITY OF WICHITA, KANSAS  
 L.K. WHITE CITY ENGINEER  
 JULY 1952 Prod. No. C12-143